

Engine, Caterpillar C15

DESCRIPTION: ENGINE, CAT C15 540 HP TIER 4

SPECIFICATIONS: ENGINE, CAT C15 540 HP TIER 4
TIER 4 ELECTRONIC CONTROL, 540 BHP, 2100 RPM, INDUSTRIAL "C"
SAE #1 FLYWHEEL HSG W/ FLEX PLATE INTERFACE & DUAL 1.3:1 RATIO REPTO "C" DRIVE 24VDC,
LOWER LEFT SIDE MOUNTED 95 AMP ALTERNATOR, PORTED THERMOSTAT BYPASS AUXILLARY
PRESSURE & TEMPERATURE SENSORS AND COOLANT LEVER SENSORS 2.95" LONG FAN DRIVE, &
90° ELBOW ON TURBO; 18" FAN HEIGHT FROM CRANKSHAFT CL.

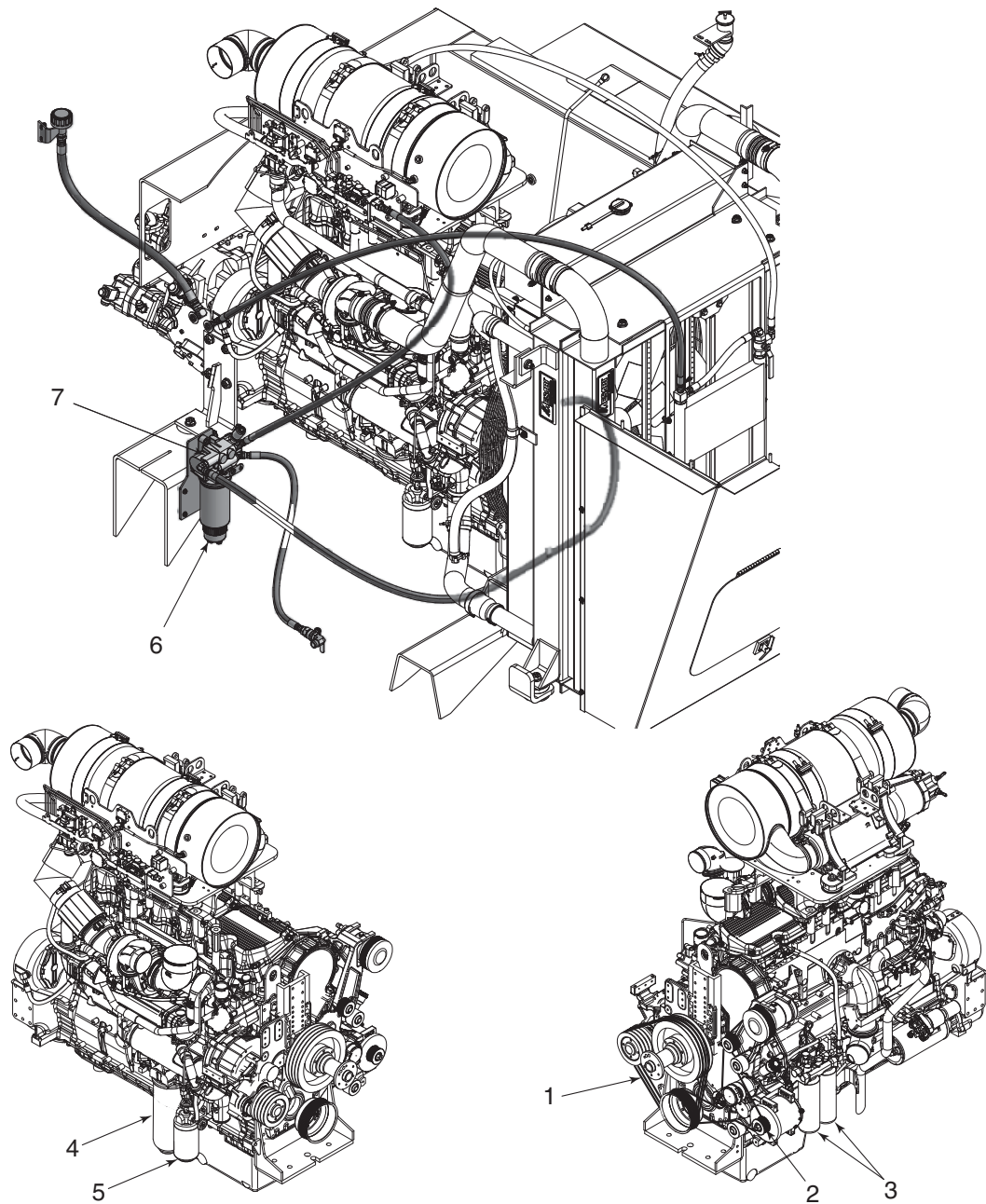

Item	Part No.	Qty	Description	Item	Part No.	Qty	Description
	588709		Engine; 540HP, C15, 2100RPM				
1	590103	1	. Belt, Fan (set of 3)	5	225556	1	. Filter, Cooling
2	590104	1	. Belt, Alternator	6	588188	1	. Primary Element, Fuel
3	587568	2	. Secondary Filter, Fuel	7	590196	1	Kit, Fuel Priming Pump W/Seals
4	587565	1	. Filter, Oil				