

In Case of Fire

1. From the cab, swing open the guard door on the CHECKFIRE 210 Display Module (ICM) and press the red "PUSH TO ACTIVATE" button.

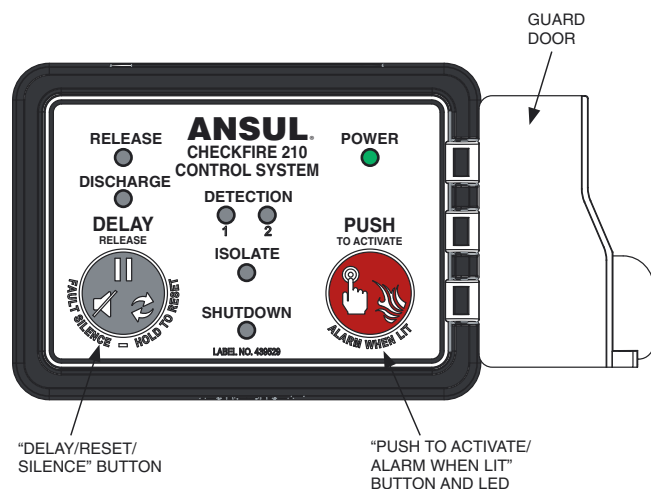

Figure 4-6-1

2. If at ground level, find the actuator on the right side of the machine, near the boarding stairs. Pull the safety pin on the actuator and strike the button.

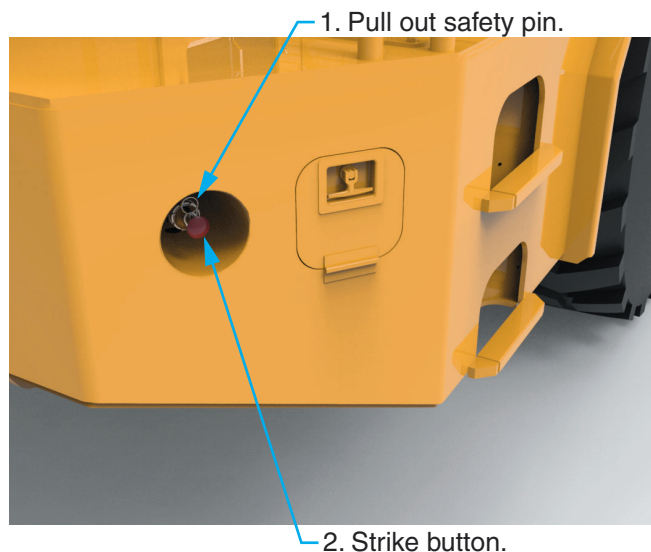

Figure 4-6-2

3. Fire retardant will be released, the engine will shut down, and the batteries will be disconnected from the electrical system.
4. LEAVE THE VEHICLE. Call the Fire Department and/or service personnel as soon as possible. After the system has discharged, watch carefully for flare ups and spot fires while maintaining a safe distance.
5. Stay clear of the vehicle until it has cooled completely.



WARNING

After a fire, hydraulic and coolant hoses are an extreme hazard.

Stay away from the machine until it has cooled completely.

The hoses containing these very hot, pressurized fluids may have been damaged by the fire and could burst at any time, causing serious burns or other injuries.

6. Any time the system is discharged, it must be refilled and recharged before resuming operation. Only Ansul representatives are authorized to refill/recharge the fire suppression system.

IMPORTANT! Each unit is equipped with two actuators. One is located in the operator's cab to the right of the operator's seat in front of the door. The other is located on the chassis by the right hand access stairs, near ground level. This way, the system may be actuated by either the operator or by ground personnel.

NOTE: Some models are equipped with a fire detection system that will automatically discharge the system in the event of a fire.



WARNING

Inspect for and remove all combustible materials from the engine area before starting the machine and periodically throughout the work shift as required. These materials build up in tight corners and are highly combustible.

INTENTIONALLY LEFT BLANK