

Jack Locations

Carefully follow these instructions and warnings to help prevent personal injury or damage to your Logstacker:

1. Park on firm level surface and lower the empty carriage to ground.
2. Engage parking brake and remove key from key switch. Tag key switch "DO NOT START" and follow your company's Lockout Procedure to ensure that the engine is not inadvertently started.
3. Make sure oscillation blocks (see Figure 5-6-1) are in the locked position to prevent the bogie from oscillating when Logstacker is being raised.
4. Block wheel on opposite side of wheel to be raised.
5. Use jacks in locations illustrated in Figure 5-6-2. Use pads (anti slip material) that are minimum 4" x 4" in size between jacks and Logstacker to prevent damage.

REAR

Use two jacks when raising rear of Logstacker and raise entire rear end. Each jack should be capable of lifting at least 20% of machine's weight or 32,600 lbs (14,787 kg). Place jacks where illustrated in Figure 5-6-2. Raise the chassis so the tires are approximately 4" off the ground.

FRONT (raise entire front end)

Use two jacks when raising front of Logstacker and raise entire front end. Each jack should be capable of lifting at least 40% of machine's total weight or 65,200 lbs (29,574 kg). Place jacks where illustrated in Figure 5-6-2. Raise the chassis so tires are approximately 4" off the ground.

FRONT (raise one side only)

Use one jack when raising one side of the front end of Logstacker. The jack should be capable of lifting at least 40% of machine's total weight or 65,200 lbs (29,574 kg). Place jack where illustrated in Figure 5-6-2. Raise the chassis so the front tire(s) is approximately 4" off the ground while keeping the rear tires on the ground.

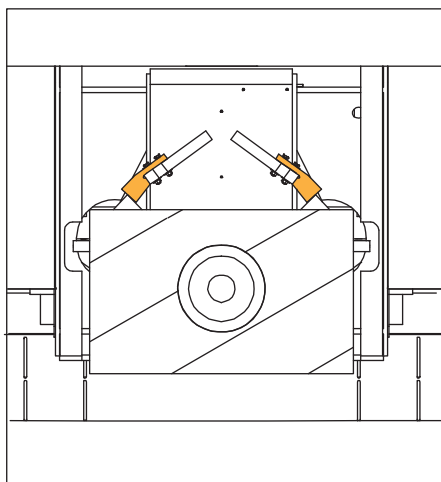

Oscillation blocks in locked position.

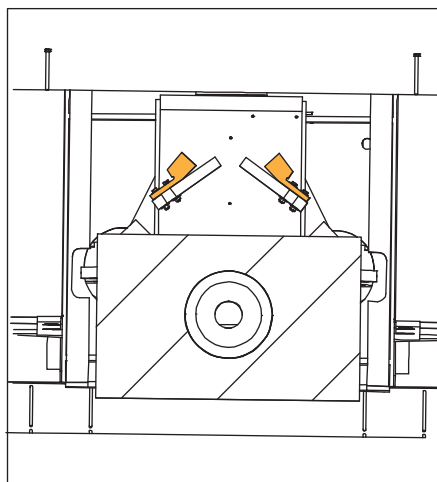

Oscillation blocks in unlocked position.

Figure 5-6-1 Oscillation Blocks

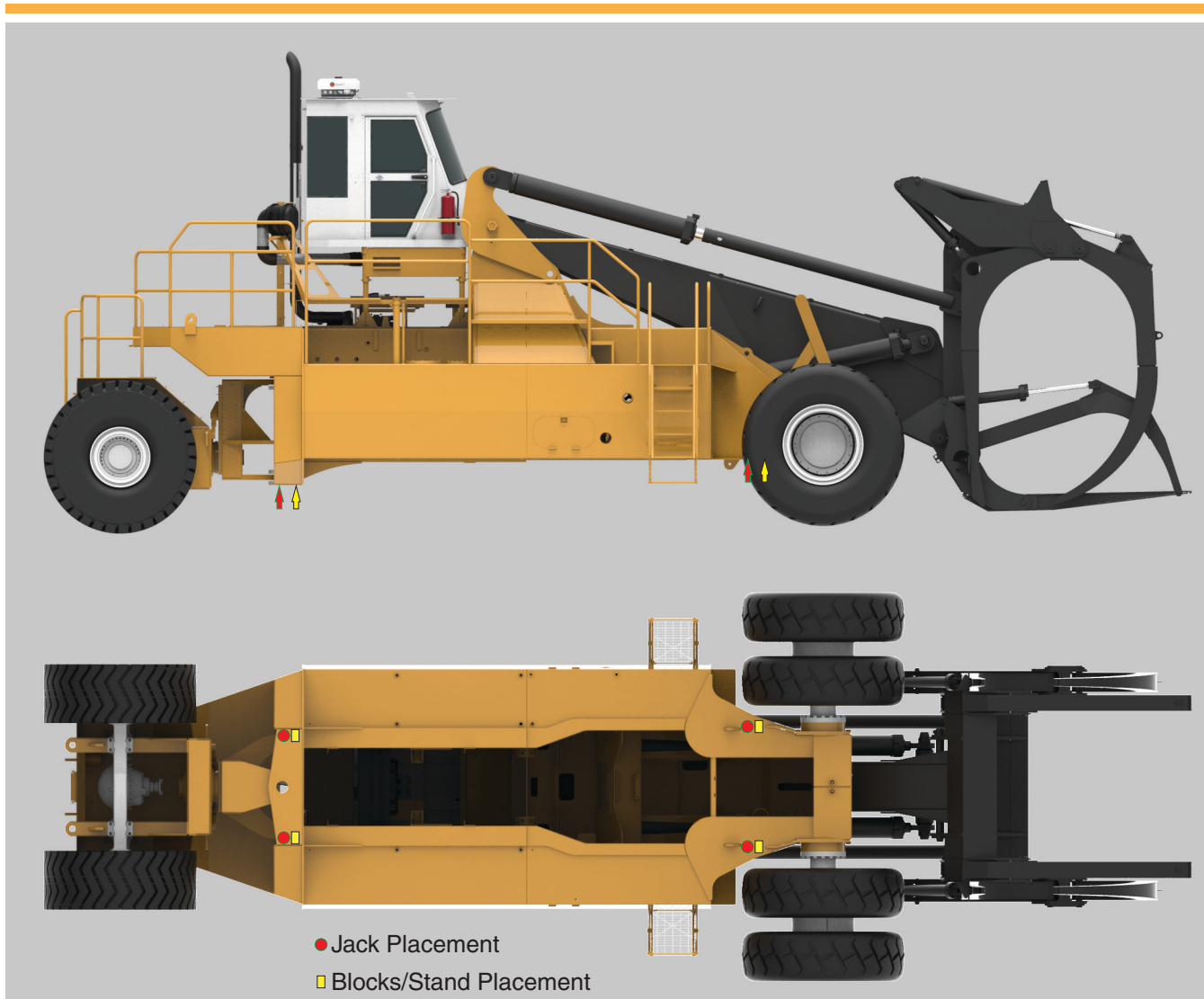

Figure 5-6-2 Jacking Locations, L4100F

6. Place jack stand(s) as required. The jack stand(s) must be capable of holding entire weight of machine, or 163,000 lbs (73,934 kg). Use pads (anti slip material) that are minimum 4" x 4" in size between jack stand(s) and Logstacker to prevent damage.



WARNING

Never rely on a jack or any lifting device to hold the weight of the Logstacker. Always use jack stands capable of holding the entire weight of the machine.



WARNING

Do not let any person on or under the Logstacker while the machine is on a jack or any lifting device.

Please call Allied Systems service department with any questions (503-625-2560).