

### General

A machine that receives regular care from its operators and mechanics generally rewards them with decreased downtime and greater reliability. With the help of the information in this section, you should be able to maintain your Logstacker at top operating efficiency. The maintenance and lubrication procedures given here can be performed with a minimum amount of shop tools.

#### Safety Precautions

Before performing any maintenance or lubrication, review the following safety procedures. They're intended for your protection.

##### 1. Read This Manual

Be sure you understand the procedures outlined in this manual before attempting to carry them out. Pay particular attention to any safety warnings presented. If you have any questions, don't hesitate to ask your Wagner dealer.

##### 2. Perform Maintenance on Level Ground

The machine should be on level ground and clear of traffic lanes whenever possible. The parking brake should be set and the wheels blocked.

##### 3. Remove Loads

The machine should be unloaded, with the carriage resting on the ground, or with the boom on a boom rest.



## WARNING

**Never rely on the hydraulic system to support any part of the machine during maintenance or lubrication. NEVER stand under a component that is supported only by the hydraulic system. Make sure it is resting on its mechanical stops or safety stands. If necessary, support components with appropriate safety stands.**

##### 4. Stop the Engine

Before performing any maintenance or lubrication remove the key from the switch, tag the key switch "DO NOT START" and follow your company's Lockout Procedure to ensure that the engine is not inadvertently started.

##### 5. Battery Disconnect Switch

Always set the Battery Disconnect switch to "OFF" before performing any welding. The Battery Disconnect Switch is located on the right side of the machine (See Figure 5-1-1). Turn the switch counterclockwise to disconnect the batteries.

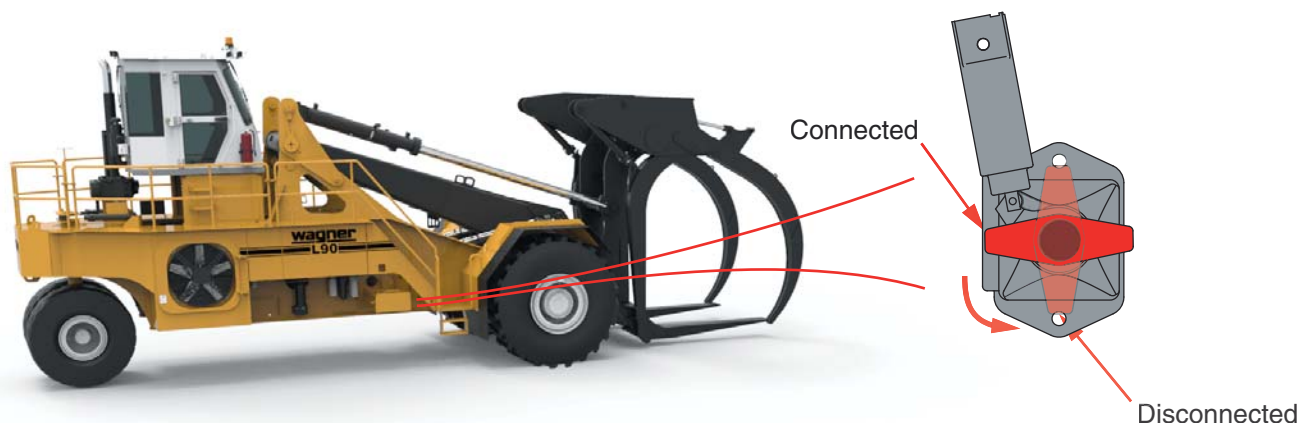

Figure 5-1-1 Battery Disconnect Switch Location

---

6. **Use Safe Ladders / Scaffolding**

Due to the height of the upper lube points, it is essential to personnel safety that safe ladders, personnel lifts and / or scaffolding be used while servicing. These areas can be dangerously slick under conditions of rain, frost or oil smears.

7. **Welding**

Before performing any welding, always perform the following to prevent severe damage to the Logstacker's electrical system:

- Set Battery Disconnect Switch to OFF located on the left side of the machine (See Figure 5-1-1).
- Disconnect ECM (Electronic Control Module). The ECM connector is located on the engine, right side of Logstacker (See Figure 5-1-2).
- Ensure electronics are properly isolated.
- Place the welding ground strap as close as possible the point on the frame being welded.

For questions or concerns, please contact your local dealer or Allied Systems Company Service Department at (503) 625-2560.

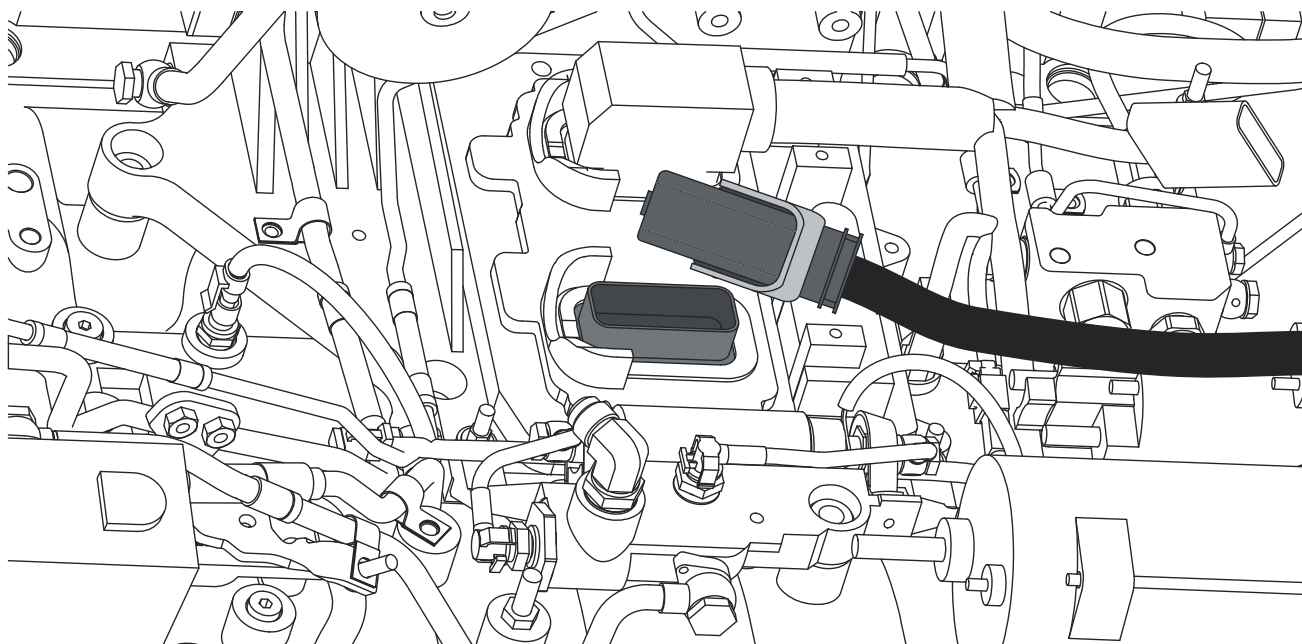

Figure 5-1-2 Disconnect ECM(Electronic Control Module)