

## Steering Column and Pedals

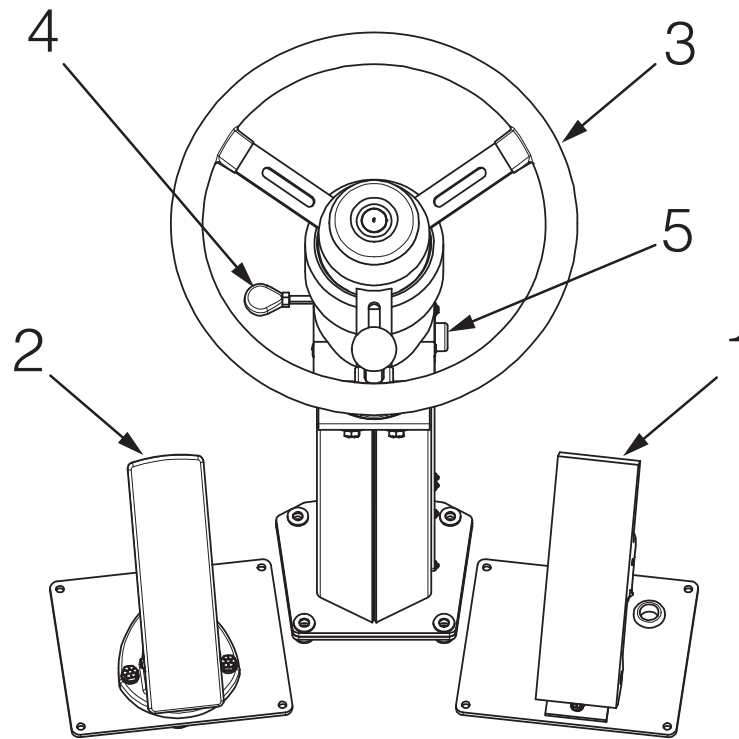

Figure 2-6-1 Steering Wheel and Pedals

- 1. Accelerator Pedal**  
Foot-controlled engine accelerator pedal.
- 2. Brake Pedal**  
Will also declutch the engine if the declutch control is engaged.
- 3. Steering Wheel and Column**  
Center button will sound the machine horn.
- 4. Tilt/Telescope Column**  
To tilt wheel, pull up on the lever to release the lock. To move the telescopic wheel in or out, push down on the lever to release the lock.
- 5. Key Switch Start**  
The key switch (located on steering column) is used to start and stop the engine and to turn the accessories on and off. This is a four position switch: ACC, OFF, RUN and START. When turning the key clockwise from the center, or OFF position, the first position to the right is RUN. The second is START. The START position is spring loaded, and will return the key to the RUN position when released. ACC is to the left of OFF: this position is used for accessories operation only.



### **WARNING**

Verify that the position of the Parking Brake Switch is set to the “Applied” position before turning on the key.

### **NOTICE**

To prevent damage to the starting motor, do not engage the starting motor for more than 30 seconds. Wait 2 minutes between each attempt to start.

---

**INTENTIONALLY LEFT BLANK**