

FIGURE 1

SERVICE INSTRUCTIONS

For Brake Valves: 592201

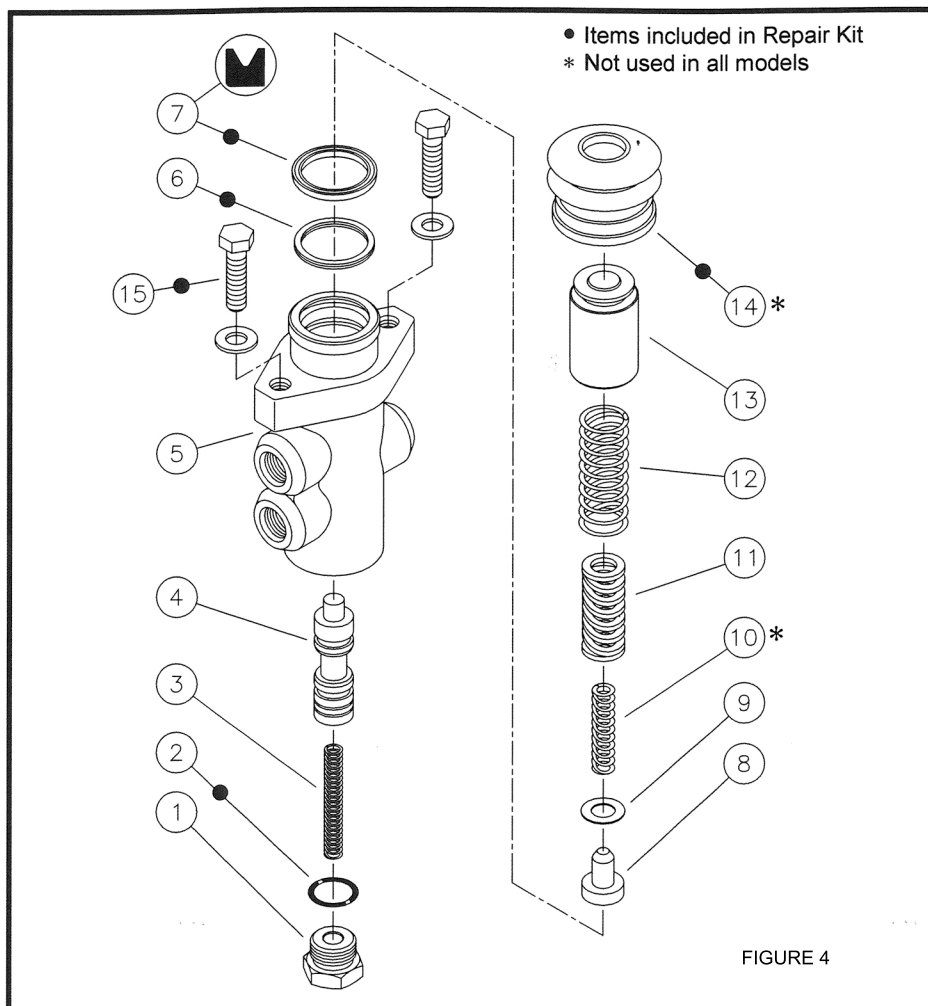

FIGURE 4

DISASSEMBLY

(Refer to Figures 1 and 4)

NOTE

Housing (5) and the spool (4) are manufactured as a matched set. This set (Housing & Spool) should not be intermixed with other parts.

1. Remove boot (14) from piston (13) and housing (5). Not all models use boot (14).
2. Remove piston (13), springs (12, 11 & 10), shim(s) (9) and retainer assembly (8) from housing (5). Not all models use spring (10). **NOTE: Be aware of the number of shim(s) being removed from housing.**
3. Carefully remove cup (7) and seal (6) from housing (5) bore. **NOTE: Be careful not to scratch or mar housing bore.**
4. Remove end plug (1) and spring (3) from housing (5). Remove o-ring (2) from end plug (1).
5. Carefully remove spool (4) from end plug (1) end of housing (5). **NOTE: Be careful not to damage spool or housing bore.**

ASSEMBLY

(Refer to Figures 1 and 4)

LUBRICATE ALL RUBBER COMPONENTS FROM REPAIR KIT WITH CLEAN TYPE FLUID USED IN THE SYSTEM.

1. Clean all parts thoroughly before assembling.
2. Lubricate spool (4) with clean system fluid and carefully slide into plug (1) end of housing (5) bore. Note direction of spool (4). **NOTE: Spool must slide freely into bore. If either part is damaged, a new valve assembly may be required.**
3. Install new o-ring (2) on end plug (1).
4. Install spring (3) and end plug (1) into housing (5). Torque 47.5-54.2 N·m (35-40 lb·ft).
5. Carefully install new cup (7) and new seal (6) into housing (5) bore.

Note direction and order of cup and seal. **NOTE: Be careful not to scratch or mar housing bore.**

6. Install springs (10, 11 & 12), shim(s) (9) and retainer assembly (8) in piston (13). Not all models use spring (10). Be sure to install the same number of shim(s) as were removed.
7. Carefully install piston (13) assembly into housing (5) bore.
8. Install new boot (14) on housing (5) and piston (13).
9. When reinstalling pedal actuated valve use new hex cap screws (15), 5/16-18UNC SAE grade 8. Torque cap screws 24.4-29.8 N·m (18-22 lb·ft). **NOTE: Not all repair kits include new cap screws (15).**

NOTE

After service, the valve must develop pressure of 69.0 +/- 3.5 bar (1000 +/- 50 PSI). Shim(s) (9) are used to obtain the correct pressure setting. Contact Allied Systems service dept if brake pressure setting is not able to be obtained.