

Return Filter Service

Return Filters

Service Interval: Quarterly, every 500 hours, or when the indicator dictates, whichever occurs first.

The return filters are accessed from the deck. See Figure 1. The indicator for the return filters is shown in Figure 2. See the parts manual for your machine for the specific location.

Allow the machine to warm up. If, after the hydraulic oil is warm, the plunger on the indicator is in the red zone, both filter elements must be changed before returning the machine to work, even if prior to the quarterly/500 hour interval.

The differential pressure indicator in Figure 2 indicates the elements are in working condition. As the elements collect contamination, the indicator plunger will rise into the red zone, indicating that the elements must be replaced.

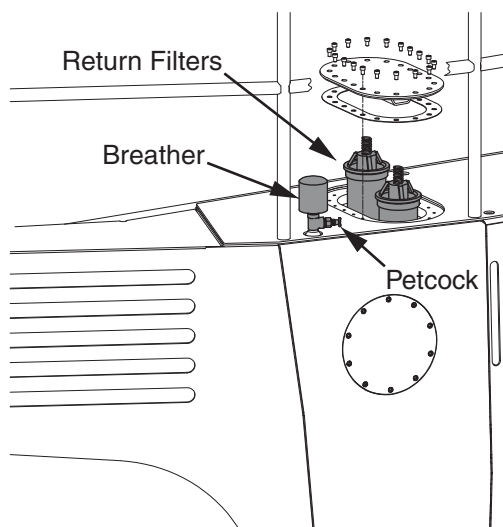

Figure 1 Return Filters (model L60 shown)



Figure 2 Differential Pressure Indicator

Replacing the Filter Elements

1. Shut down the machine and vent captive pressure by opening the petcock at the breather. See Figure 1.
2. Clean cover plate and surrounding area.
3. Remove cover plate and gasket.
4. Remove in-tank filter assemblies.
5. Remove the bypass spring assembly (see Figure 3).
6. Remove contaminated cartridge with a twisting motion.
 - a. Discard disposable element.
 - b. Wash sleeve in non-caustic solvent. Compressed air can be used to prevent damage to the element during cleaning.

Before Installing Cartridge

1. Clean magnetic core (insert assembly) with a lint free cloth.
2. Check all seals and tank cover gasket and replace if necessary.

To Assemble and Install New or Cleaned Cartridge

1. Lubricate all seals
2. Insert new element into clean sleeve.
3. Assemble insert assembly and cartridge.

Note: For ease of mounting, hold the cartridge away from the magnetic core until the stud is through the hole in the bottom of the cartridge. Then slide the cartridge up to securely seat with the top of the bridge of the insert assembly.

4. Install bypass spring assembly or non-bypass plate (tighten until snug).
5. Reinstall in-tank return filter into housing (make sure the top spring is secure).
6. Reinstall cover. Torque cover nuts (see 80-1057 Torque Specification Chart).
7. Close the petcock.

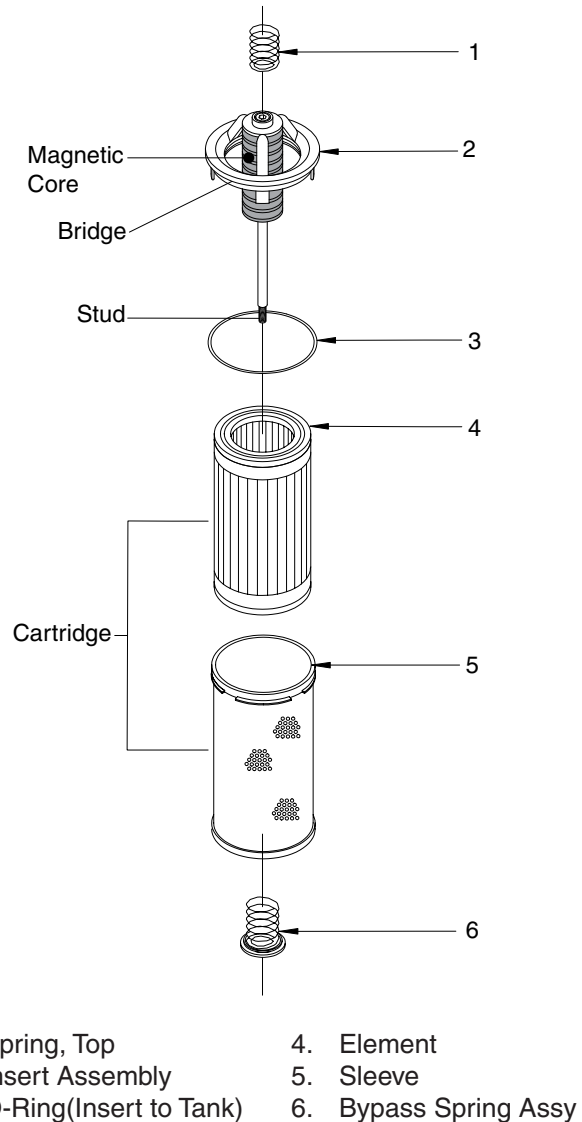

Figure 3 Return Filter Assembly