

Hoist & Tilt Valve

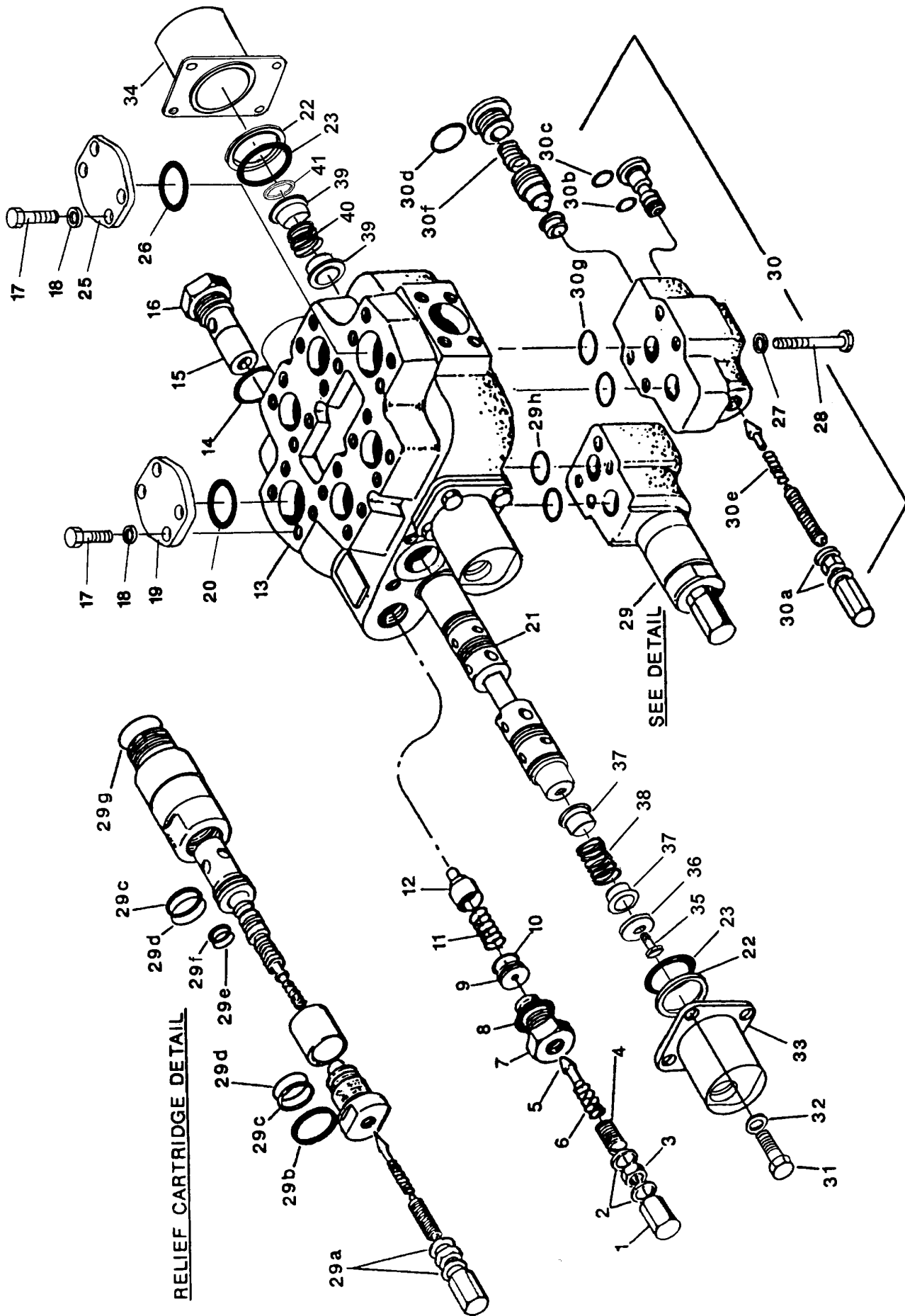

RELIEF CARTRIDGE DETAIL

SEE DETAIL

Hoist & Tilt Valve

Item	Part No.	Qty	Description	Item	Part No.	Qty	Description
	229439		Hoist & Tilt Valve				
1	222217	1	. Nut	29b	*a -----	1	. . . O-Ring
2	205742	2	. Washer	29c	*a -----	2	. . . Backup Ring
3	203701	1	. Jam Nut	29d	*a -----	2	. . . O-Ring
4	201337	1	. Adjusting Screw	29e	*a -----	1	. . . O-Ring
5	225287	1	. Relief Poppet	29f	*a -----	1	. . . Backup Ring
6	200547	1	. Spring	29g	*a -----	1	. . . O-Ring
7	225288	1	. Cap	29h	*a -----	2	. . . O-Ring
8	203727	1	. O-Ring	30	225303	2	. Overload Asm
9	225289	1	. Seat	30a	*b -----	2	. . Washer
10	222168	1	. O-Ring	30b	*b -----	1	. . O-Ring
11	233719	1	. Spring	30c	*b -----	1	. . O-Ring
12	225292	1	. Plunger	30d	*b -----	1	. . O-Ring
13	NSS	1	. Valve Body	30e	*b -----	1	. . Spring
14	203727	1	. O-Ring	30f	*b -----	1	. . Spring
15	225293	1	. Seat	30g	*b -----	2	. . O-Ring
16	225294	1	. Cap	31	233724	16	. Capscrew
17	233720	8	. Capscrew	32	203702	16	. Lockwasher
18	203705	8	. Lockwasher	33	233725	2	. End Cap Assembly
19	203799	1	. Flange Cover	34	233726	2	. End Cap Assembly
20	203728	1	. O-Ring	35	-----	1	. Capscrew
21	NSS	2	. Spool	36	244150	1	. Spacer
22	233721	4	. Retainer	37	200549	2	. Spring Retainer
23	203736	4	. O-Ring	38	244152	1	. Spring
25	203800	1	. Flange Cover	39	244144	2	. Spring Retainer
26	233722	1	. O-Ring	40	244153	1	. Spring
27	203703	16	. Lockwasher	41	244151	1	. Spacer
28	233723	16	. Capscrew				
29	225300	2	. Anti-Cavitation Valve Assembly	NSS	Not Sold Separately		
29	225301	1	. . Relief Cartridge (See Detail)	*a	225316 Service Kit		
29a	-----	2	. . . Washer	*b	225317 Service Kit		