

Long Reach Pulp Bale Clamps

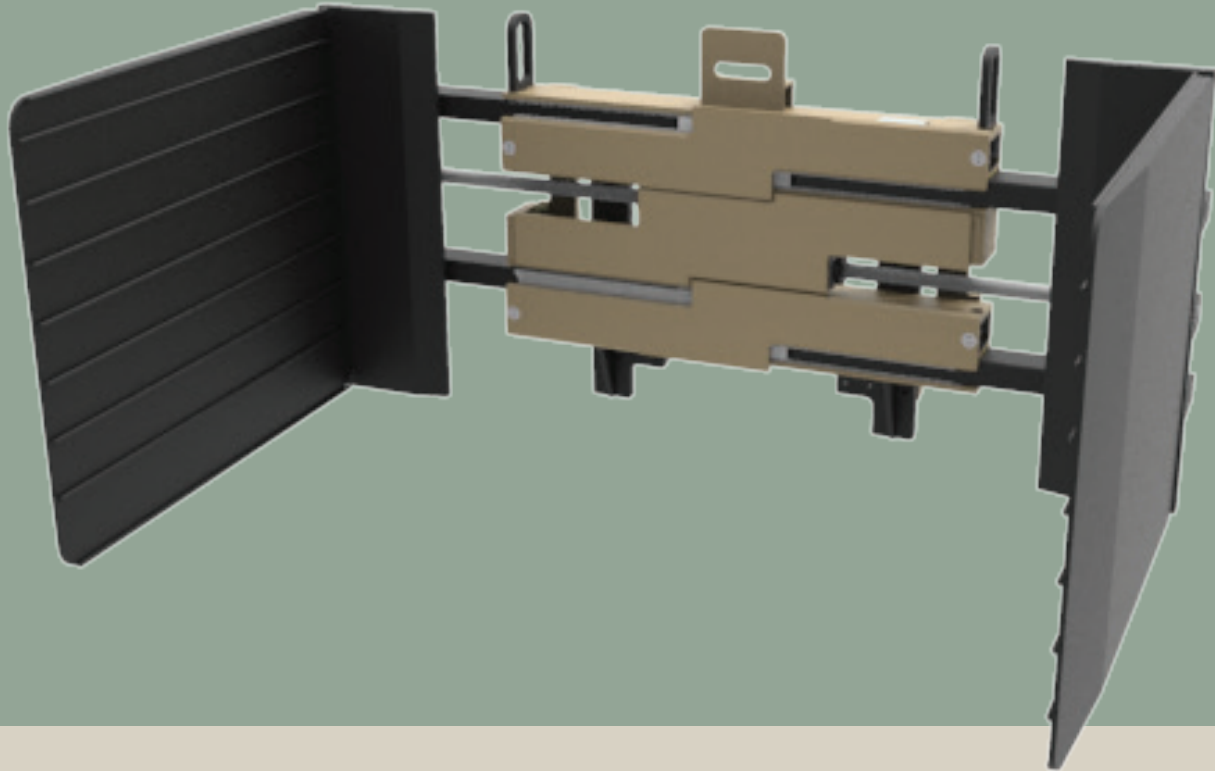

Steel construction for strength and durability

The Long Reach pulp bale clamp features a heavy-duty steel body designed for a long life in the most rugged applications.

Clean, grease-free handling - no lubrication required

Long Reach uses polymer wear strips, so these clamps do not require lubrication. The wear strips are easily field-replaceable.

Thin arm design for easier entry between stacks

Put productivity up front, with a Long Reach pulp bale clamp.

LCP/NSQ Pulp Bale Clamps

Clean, grease-free handling – no lubrication required
 Internal sideshift for maneuverability
 Thin arm design for easier entry between stacks

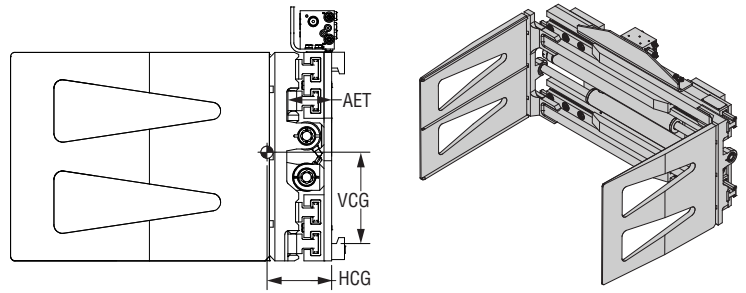

Sideshifting Pulp Bale Clamps, 2 Functions

Model Number	Capacity lb @ L.C.	Opening Range (in)	Body Width (in)	Arm Size H x L (in)	Lost Load AET (in)	HCG (in)	VCG (in)	Mounting Class	Weight (lb)			
LCP-44NS-P1827	4,400 lb @ 24"	22.8–77.1	41	18 x 27	5.0	7.0	9.8	II or III	851			
LCP-44NS-P1848		22.3–76.6		18 x 48	5.0	13.8	9.5		1,150			
LCP-44NS-P4824		22.8–77.1		48 x 24	5.0	9.8	17.0		997			
LCP-4CNS-P1827		22.8–84.1		18 x 27	5.0	6.5	9.7		939			
LCP-4CNS-P1848	5,500 lb @ 24"	22.3–83.6	48	18 x 48	5.0	13.0	9.6	II or III	1,237			
LCP-4CNS-P4824		22.8–84.1		48 x 24	5.0	9.3	16.5		1,085			
LCP-55NS-P1827		22.8–76.5		18 x 27	5.5	6.4	9.8		985			
LCP-55NS-P1848		22.3–76.0		18 x 48	5.5	12.6	9.6		III	1,282		
LCP-55NS-P4824	7,500 lb @ 35"	22.8–76.5	48	48 x 24	5.5	9.0	16.2	III	1,130			
LCP-5CNS-P1827		22.8–83.5		18 x 27	5.5	6.0	9.8		1,095			
LCP-5CNS-P1848		22.3–83.0		18 x 48	5.5	11.8	9.6		1,393			
LCP-5CNS-P4824		22.8–83.5		48 x 24	5.5	8.4	15.6		1,241			
NSQ-75NS-P1540	8,800 lb @ 35"	22–74	50	15 x 40	9.6 ¹	8.8	11.6	III	1,875			
NSQ-75NS-P1548				15 x 48	9.6 ¹	12.3	10.8		2,095			
NSQ-7ANS-P1540				22–90	62	15 x 40	9.6 ¹		9.6	11.3	III	2,175
NSQ-7ANS-P1548						15 x 48	9.6 ¹		11.4	11.3	2,395	
NSQ-88NS-P2048	11,000 lb @ 35"	22–76	50	20 x 48	9.6 ¹	14.2	12.5	IV	2,685			
NSQ-88NS-P2055				20 x 55	9.6 ¹	16.6	11.9		2,850			
NSQ-8ANS-P2048				22–90	62	20 x 48	9.6 ¹		12.8	12.6	IV	3,050
NSQ-8ANS-P2055						20 x 55	9.6 ¹		14.0	11.8		3,230
NSQ-11NS-P2048	17,000 lb @ 35"	25–84	52	20 x 48	10.3 ¹	11.3	13.6	IV	3,060			
NSQ-11NS-P2055				20 x 55	10.3 ¹	13.1	12.9		3,125			
NSQ-11NS-P4848				25–91	58	48 x 48	10.3 ¹		15.0	15.8	IV	3,678
NSQ-11NS-P4856						48 x 56	10.3 ¹		19.4	17.4		4,875
NSQ-1ANS-P2048	20,000 lb @ 35"	34–110	64	20 x 48	10.3 ¹	10.5	13.6	IV	3,425			
NSQ-1ANS-P2055				20 x 55	10.3 ¹	11.7	13.0		3,505			
NSQ-17NS-P2055				24–120	96	20 x 55	Consult Factory		Consult Factory	Consult Factory	Pin	4,895
NSQ-17NS-P2063						20 x 63	Consult Factory		Consult Factory	Consult Factory		5,050
NSQ-20NS-P3055	28–158	125	125	30 x 55	Consult Factory	Consult Factory	Consult Factory	Pin	6,850			
NSQ-20NS-P3063				30 x 63	Consult Factory	Consult Factory	Consult Factory		7,080			

¹ NSQ AET measured to heel.

Recommended Hydraulic Supply

Model Number	Flow (gpm)	Max psi
LCP-44NS/5CNS	7–10	2,500
NSQ-75NS/1ANS	9–15	2,250
NSQ-17NS/20NS	15–18	2,250

Hydraulic flow less than minimum may reduce operating speed and/or cause irregular arm movement. Higher flow may result in heat build-up, erratic operation and shortened hydraulic system life.

Choose Long Reach for serviceability, value, and custom design

Multi-Pallet Handlers
 Fork Positioners
 Integral Carriages
 Paper Roll Clamps
 Lateral Clamps

Carton Clamps
 Push-Pulls
 Rotators
 Custom Design

21433 SW Oregon Street
 Sherwood, Oregon 97140-9799 USA
 Toll free: (800) 285-7000
 Phone: (503) 625-2560
 Fax: (503) 625-7269
 Email: marketing@alliedsystems.com
 www.alliedsystems.com/Longreach

LONG REACH[®]
 A Division of Allied Systems Company