

Lever Housing Repair Instructions

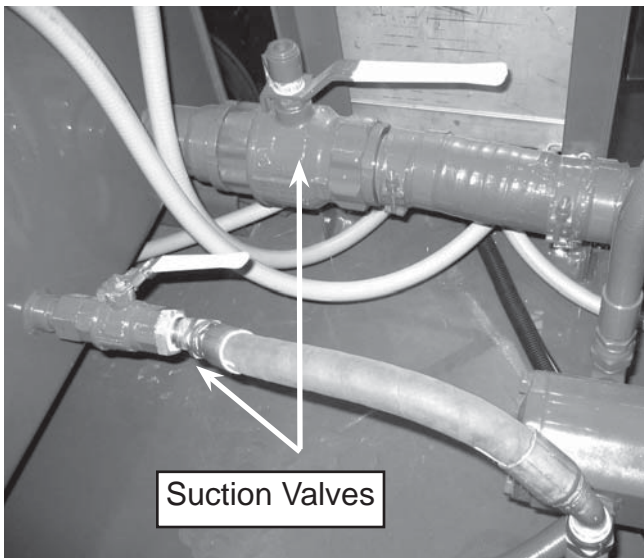

Figure - 1 Suction Valve

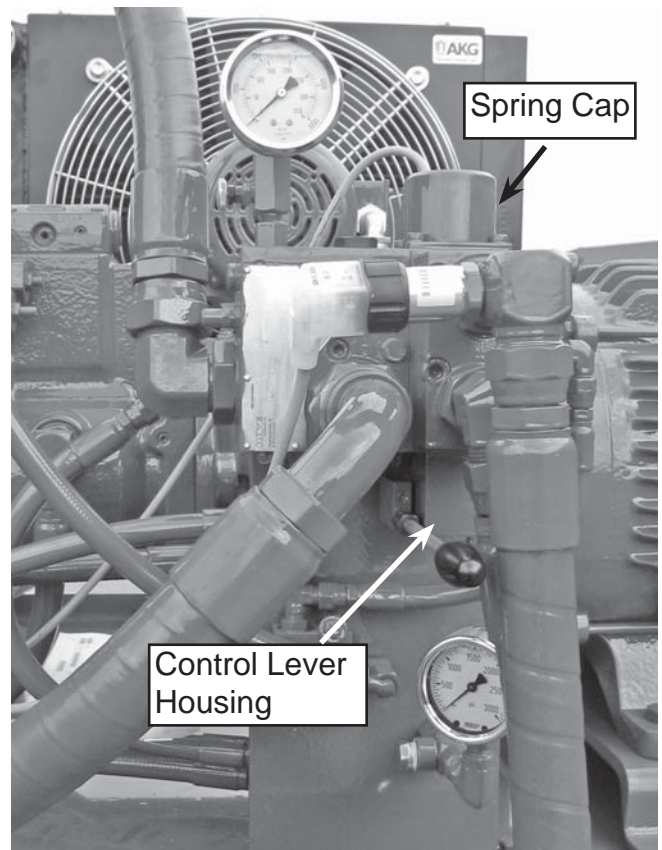

Figure - 2 253976 Directional Valve

Important: Remove any dirt and debris before disassembling directional valve to prevent contamination to hydraulic system. Plug or cap any open ports or hoses while repairing the directional valve.

Instructions:

- 1) Close suction valves (see Figure 1).
- 2) Remove coil (Item #20 on page 2) – 3 bolts.
- 3) Remove spring cap (Item #14 on page 2) – 4 bolts.
- 4) Remove spring retainer assembly – metric allen wrench (Items #8-13 on page 2) (keep assembly together as it comes off).
- 5) Remove handle block (Item #1 on page 2) – 4 bolts.

6) Pull handle assembly/spool far enough out of valve section the get to the spool clip (see Figure 4 page 2).

7) Un-clip spool from block, remove pin (see Figure 4 page 2).

8) Clip spool to new block, make sure the large O-Ring is in the O-Ring plate, it must seal the end of the valve section when new handle block is installed. You will see how it is oriented upon removal of old handle block.

9) Reinstall new handle block, spring retainer assembly, spring cap, coil.

10) Connect all hoses or wiring that might have been disconnected.

CAUTION: OPEN SUCTION VALVES BEFORE TURNING ON WATER EXTRACTOR.

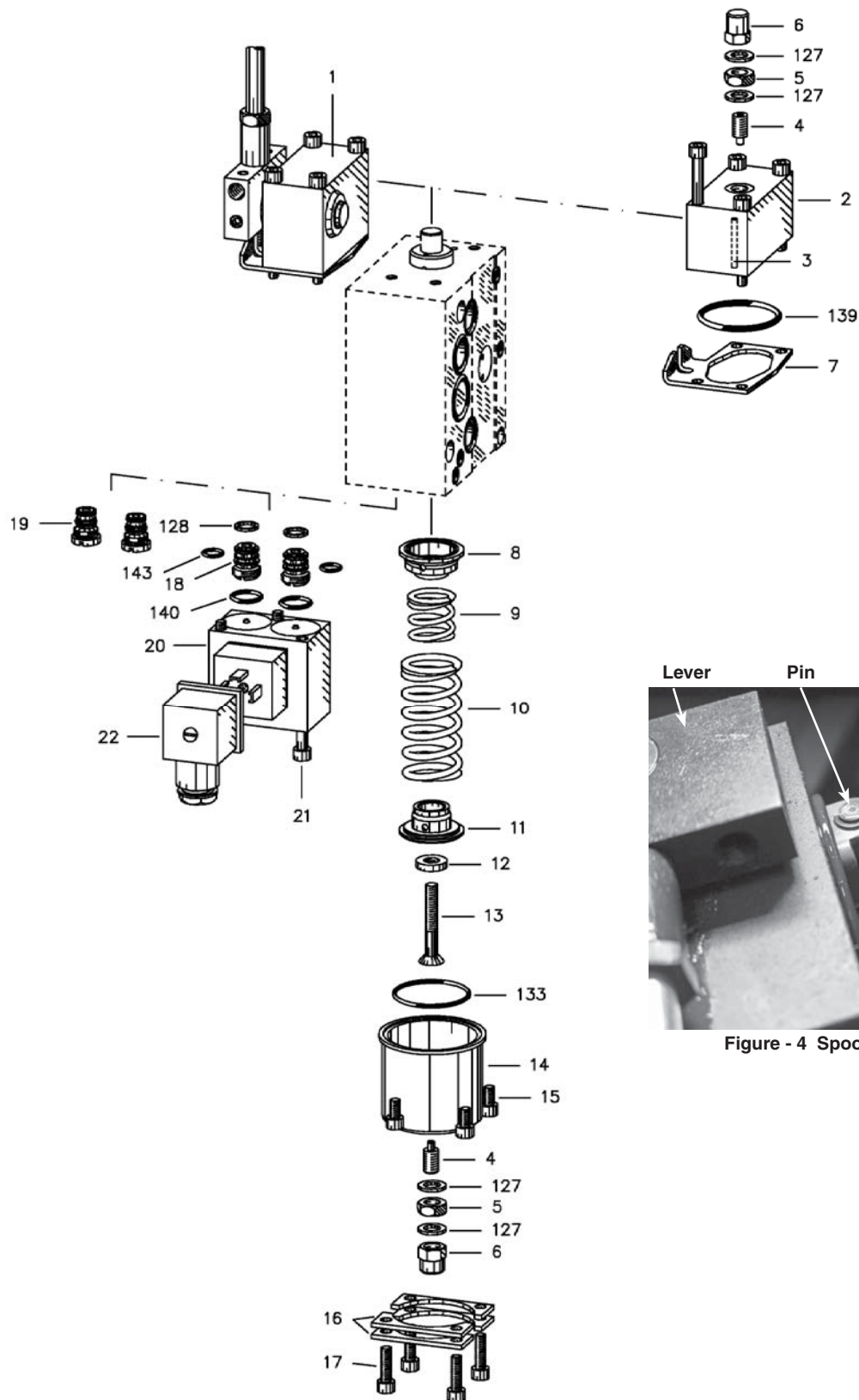

Figure - 3 Valve Section

Figure - 4 Spool Clip and Pin