

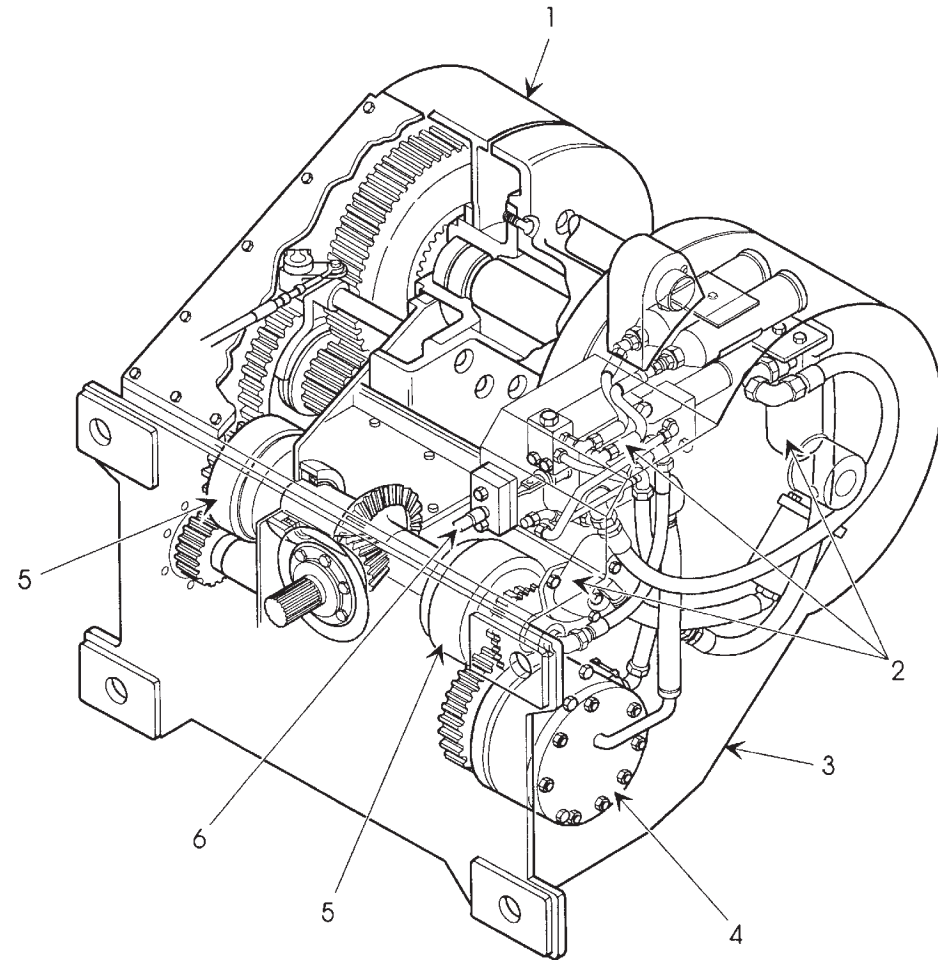

ALLIED WINCHES FOR: CATERPILLAR TRACTORS



W6F/W8L/W12E shown. (Other models have similar features.)

Features

1. **FLUSH DRUM**
Drum flush with frame to reduce line wear from side pulls.
2. **SELF CONTAINED HYDRAULICS (SCH)**
Valve, pump, filter and hydraulic lines are inside winch for long component life and simplified winch installation.
3. **HEAVY DUTY FRAME**
Protects, and allows easy access to internal components.
4. **OIL BRAKE**
Spring applied, multiple-disc hydraulically released and oil cooled for long life. No heat fade. Eliminates routine adjustments.
5. **MULTI-DISC CLUTCH**
Hydraulically applied clutch is automatically synchronized with the oil brake for smooth winch line control.
6. **SINGLE LEVER CONTROL**
Connected to single spool control valve for excellent line control regardless of application.

Options

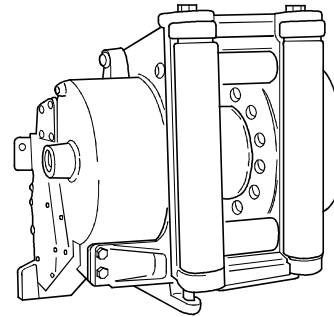

FAIRLEAD
Permits maximum line pull from all angles.

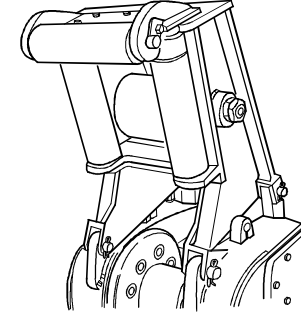

ARCH
Permits maximum line pull from angles and lifts load off ground for ease of skidding.

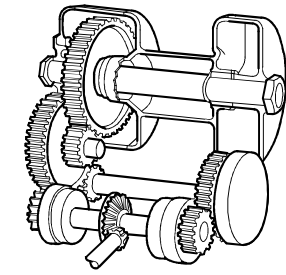

SLOW GEAR RATIO
For precise line speed control and increased line pull capacity.

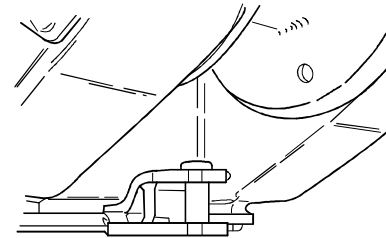

DRAWBAR
For pulling. Optional on H4A, W3C. Standard on W5C, W6F, W6G, W8L and W12E.

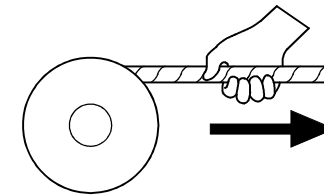

FREESPOOL
Disconnects drum from gearing drag to allow cable to be easily pulled out by hand. Standard on W3C, W5C, W6F and W6G.

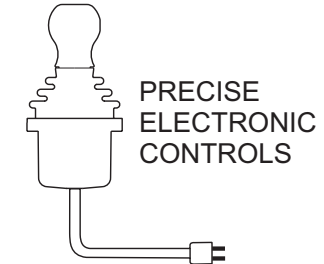

PRECISE ELECTRONIC CONTROLS
ELECTRONIC CONTROLS
Simplified winch installation: only one wire harness needed to connect to control joystick. Provides unparalleled line speed control.

Parts and Service Support

Our parts depot carries a large parts inventory to support your dealer. Orders are generally filled within 24 hours from our depot to the dealer. Contact your tractor dealer for your winch parts and service.

Allied Systems
COMPANY

WINCH DIVISION

21433 SW OREGON STREET
SHERWOOD, OREGON 97140-9799, U.S.A.
TELEPHONE: (503) 625-2560
FAX: (503) 625-7269 • (503) 625-5132
E-MAIL: marketing@alliedsystems.com
<http://www.alliedsystems.com>

ALLIED WINCHES FOR CATERPILLAR TRACTORS

TRACTOR MODEL	D3,4,5G	D5N	D6N	D6N	D6G	527	D6R D6R II	D7R D7R II	D7G	D8R D8R II	D8R D8R II	D8T,583T 587T	D9T	D10T		
WINCH MODEL	H4A	W5C	W5C	W6G	W6F	W6F	W6G	W8L	W8L	W8L	W12E	W12E	W12E	W12E		
STANDARD GEAR RATIO	83/1	66/1	100/1	45/1	55/1	55/1	45/1	50/1	47/1	94/1	150/1	150/1	150/1	150/1		
S T A N D A R D D	BARE DRUM	Maximum Line Pull (pounds)*	31900	69200	69200	89800	89800	89800	108700	113000	113000	138800	138800	138800	138800	
		Line Speed @	104 fpm	85 fpm	57 fpm	133 fpm	123 fpm	133 fpm	129 fpm	125 fpm	122 fpm	85 fpm	58 fpm	58 fpm	50 fpm	54 fpm
		Typical Working Load of (pounds)	10000	10000	15000	20000	20000	20000	20000	40000	40000	60000	80000	80000	80000	90000
A R D D	FULL DRUM	Maximum Line Pull (pounds)	18300	54800	69200	49700	60000	57600	64900	75000	80000	138800	138800	138800	138800	
		Line Speed @	113 fpm	149 fpm	102 fpm	185 fpm	176 fpm	190 fpm	198 fpm	126 fpm	135 fpm	110 fpm	82 fpm	82 fpm	75 fpm	82 fpm
		Typical Working Load of (pounds)	10000	10000	15000	20000	20000	20000	20000	40000	40000	60000	80000	80000	80000	90000
		Maximum Line Speed	207 fpm	318 fpm	112 fpm	284 fpm	260 fpm	260 fpm	270 fpm	281 fpm	270 fpm	146 fpm	102 fpm	102 fpm	87 fpm	91 fpm

MAXIMUM LINE SPEED BARE DRUM @ THIS GEAR RATIO	56/1	66/1	72/1	83/1	94/1	100/1	103/1	116/1	125/1	153/1
56/1										
66/1			90 fpm							
72/1										
83/1				85 fpm		77 fpm	81 fpm			
94/1								91 fpm	89 fpm	
100/1		59 fpm								
103/1				68 fpm	54 fpm	62 fpm	65 fpm			
116/1	85 fpm									
125/1								74 fpm	67 fpm	
153/1					46 fpm			44 fpm		

DIMENSIONAL DATA	A	B	C	D	E	F	G
Ground to highest point	45 in.	48 in.	53 in.	56 in.	55 in.	61 in.	61 in.
Ground to drum center	34 in.	36 in.	41 in.	42 in.	41 in.	47 in.	47 in.
Ground to drawbar center	20 in.	20 in.	25 in.	23 in.	22 in.	28 in.	28 in.
Tractor face to end of winch	32 in.	40 in.	40 in.	47 in.	33 in.	41 in.	49 in.
Tractor face to drum center	24 in.	31 in.	31 in.	37 in.	23 in.	30 in.	38 in.
Tractor face to drawbar center	23 in.	27 in.	27 in.	35 in.	22 in.	29 in.	37 in.
Winch max. width (not shown)	29 in.	32 in.	32 in.	38 in.	40 in.	40 in.	38 in.

WEIGHTS	Winch, approx. w/o cable	Fairlead	Drawbar	Integral Arch
	1680 lbs.	310 lbs.	30 lbs.	420 lbs.
	2100 lbs.	400 lbs.	w/winch	875 lbs.
	2100 lbs.	400 lbs.	w/winch	875 lbs.
	3230 lbs.	800 lbs.	w/winch	1015 lbs.
	2800 lbs.	750 lbs.	w/winch	1015 lbs.
	3100 lbs.	750 lbs.	w/winch	1015 lbs.
	3350 lbs.	800 lbs.	w/winch	1015 lbs.
	3500 lbs.	800 lbs.	w/winch	
	2950 lbs.	800 lbs.	w/winch	
	3500 lbs.	800 lbs.	w/winch	
	6100 lbs.	1230 lbs.	w/winch	
	6100 lbs.	1230 lbs.	w/winch	
	6100 lbs.	1230 lbs.	w/winch	
	8330 lbs.	w/winch	w/winch	

WINCH CABLE CAPACITY	Winch Model	Barrel Diameter	CABLE DIAMETER						FERRULE			* Maximum line pull is the lesser of the maximum line pull that the tractor will develop with the standard gear ratio or the breaking strength for the maximum recommended cable for that winch model.	
			1/2 in.	5/8 in.	1 1/8 in.	3/4 in.	7/8 in.	1 in.	1 1/4 in.	Name	Length		Diameter
(Shaded option not available)	H4A	8.00 in.	422 ft.	277 ft.		195 ft.					Bantam	2 in.	1 1/2 in.
	W5C	8.56 in.		423 ft.		298 ft.	215 ft.				Light	2 1/4 in.	2 in.
	W6F/G	10.00 in.				399 ft.	287 ft.	223 ft.			Light	2 1/4 in.	2 in.
	W8L	12.00 in.				220 ft.		354 ft.	275 ft.		Junior	2 3/8 in.	2 1/4 in.
	W12E	14.00 in.				228 ft.			285 ft.	181 ft.	Junior	2 3/8 in.	2 1/4 in.

Notes:

Allied Systems Company reserves the right to change and/or improve specifications and performance at its own discretion without prior notice. Check with dealer for latest data.

