

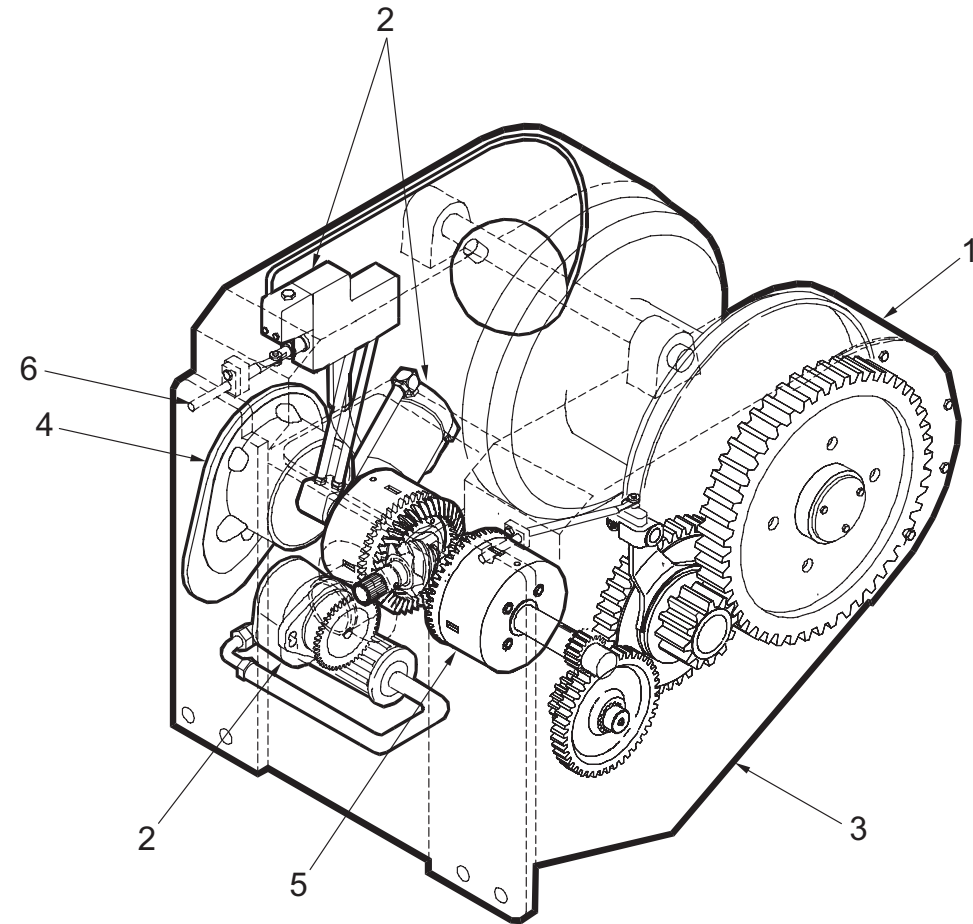

# ALLIED WINCHES FOR: CASE DOZERS



W5C shown. (Other models have similar features.)

## Features

- |  |   |
|--|---|
| <p><b>1. FLUSH DRUM</b><br/>Drum flush with frame to reduce line wear from side pulls.</p> <p><b>2. SELF CONTAINED HYDRAULICS (SCH)</b><br/>Valve, pump, filter and hydraulic lines are inside winch for long component life and simplified winch installation.</p> <p><b>3. HEAVY DUTY FRAME</b><br/>Protects, and allows easy access to internal components.</p> | <p><b>4. OIL BRAKE</b><br/>Spring applied, multiple-disc hydraulically released and oil cooled for long life. No heat fade. Eliminates routine adjustments.</p> <p><b>5. MULTI-DISC CLUTCH</b><br/>Hydraulically applied clutch is automatically synchronized with the oil brake for smooth winch line control.</p> <p><b>6. SINGLE LEVER CONTROL</b><br/>Connected to single spool control valve for excellent line control regardless of application.</p> |
|--|---|

## Options

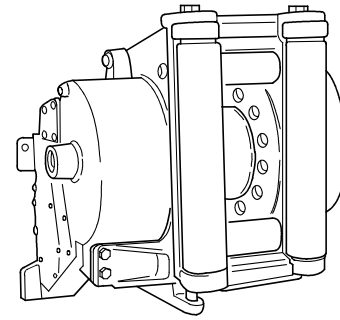

**FAIRLEAD**  
Permits maximum line pull from all angles.

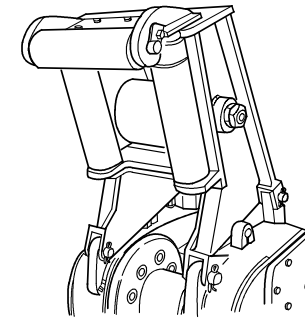

**ARCH**  
Permits maximum line pull from angles and lifts load off ground for ease of skidding.

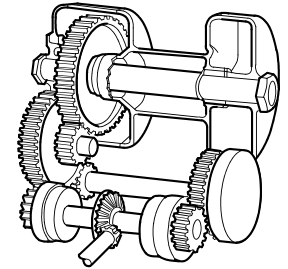

**SLOW GEAR RATIO**  
For precise line speed control and increased line pull capacity.

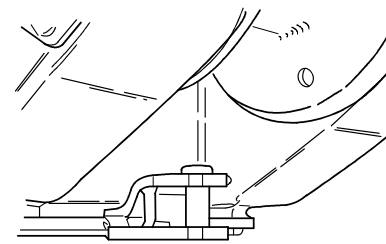

**DRAWBAR**  
For pulling. Optional on W3C and H4A. Standard on W5C and W6G.

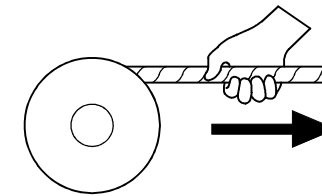

**FREESPOOL**  
Disconnects drum from gearing drag to allow wire rope to be easily pulled out by hand. Standard on W3C, H4A, W5C and W6G.

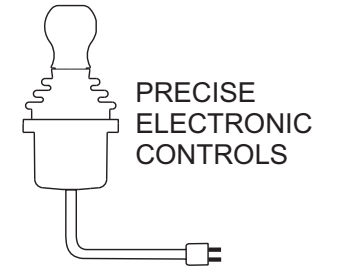

**PRECISE ELECTRONIC CONTROLS**  
**ELECTRONIC CONTROLS**  
Simplified winch installation: only one wire harness needed to connect to control joystick. Provides unparallelled line speed control.

## Parts and Service Support

Our parts depot carries a large parts inventory to support your dealer. Orders are generally filled within 24 hours from our depot to the dealer. Contact your dozer dealer for your winch parts and service.

# Allied Systems

COMPANY

## WINCH DIVISION

21433 SW OREGON STREET  
SHERWOOD, OREGON 97140-9799, USA  
PHONE: (503) 625-2560  
FAX: (503) 625-7269 • (503) 625-5132  
marketing@alliedsystems.com  
www.alliedsystems.com

# ALLIED WINCHES FOR CASE DOZERS

DOZER MODEL	650L	650K	750-850K	750-850L	1150H Hi-range   Lo-range	1150K	1650K	1650L		1850K		
<b>WINCH MODEL</b>	H4AH	W3C	W3C	W3C	W5C	W5C	W5C	W5C	W6G	W6G		
WINCH TYPE: Hydraulic or Power Take-Off:	HYD	PTO	PTO	PTO	PTO	PTO	PTO	PTO	PTO	PTO		
STANDARD GEAR RATIO	83/1	61/1	61/1	61/1	63/1	66/1	66/1	66/1	83/1	83/1		
<b>BARE DRUM</b>	Maximum Line Pull (pounds)**	34,000	34,800	40,300	51,200	69,200	69,200	66,700	69,200	69,200	83,900	88,800
	Approximate Line Speed @ Typical Working Load of (pounds)	94 fpm	85 fpm	85 fpm	71 fpm	79 fpm	57 fpm	84 fpm	70 fpm	82 fpm	75 fpm	56 fpm
	Maximum Line Speed	94 fpm	91 fpm	91 fpm	71 fpm	100 fpm	72 fpm	88 fpm	85 fpm	82 fpm	75 fpm	75 fpm
<b>FULL DRUM</b>	Maximum Line Pull (pounds)**	19,000	19,900	23,100	31,000	54,600	69,200	36,000	69,200	42,600	45,400	88,800
	Approximate Line Speed @ Typical Working Load of (pounds)	125 fpm	89 fpm	136 fpm	124 fpm	75 fpm	83 fpm	132 fpm	98 fpm	152 fpm	123 fpm	101 fpm
	Maximum Line Speed	169 fpm	158 fpm	158 fpm	124 fpm	186 fpm	134 fpm	163 fpm	158 fpm	152 fpm	140 fpm	139 fpm

MAXIMUM LINE SPEED BARE DRUM USING OPTIONAL GEAR RATIO	Shaded ratios not available for this model	45/1	56/1	100/1 (95/1 - 1150H ONLY)	103/1	153/1							
												139 fpm	140 fpm
												112 fpm	111 fpm
												61 fpm	60 fpm
												41 fpm	41 fpm

DIMENSIONAL DATA See illustrations	A	Ground to highest point	46 in.	42 in.	42 in.	42 in.	49 in.	49 in.	48 in.	48 in.	47 in.	51 in.	57 in.
	B	Ground to drum center	35 in.	31 in.	31 in.	31 in.	36 in.	36 in.	35 in.	35 in.	34 in.	37 in.	43 in.
	C	Ground to drawbar center	21 in.	15 in.	15 in.	15 in.	20 in.	20 in.	19 in.	19 in.	18 in.	18 in.	24 in.
	D	Dozer face to end of winch	35 in.	36 in.	36 in.	36 in.	35 in.	35 in.	35 in.	36 in.	35 in.	40 in.	40 in.
	E	Dozer face to drum center	27 in.	27 in.	27 in.	27 in.	26 in.	26 in.	26 in.	27 in.	25 in.	30 in.	29 in.
	F	Dozer face to drawbar center	25 in.	28 in.	28 in.	28 in.	22 in.	22 in.	22 in.	23 in.	22 in.	29 in.	28 in.
	G	Winch max. width (not shown)	31 in.	28 in.	28 in.	28 in.	32 in.	32 in.	32 in.	32 in.	32 in.	38 in.	38 in.

SHIPPING WEIGHTS Shaded options not available	Winch, approx. w/o wire rope	1680 lbs.	1530 lbs.	1530 lbs.	1530 lbs.	2100 lbs.	2100 lbs.	2100 lbs.	2100 lbs.	2100 lbs.	2900 lbs.	2900 lbs.
	Fairlead	310 lbs.	310 lbs.	310 lbs.	310 lbs.	450 lbs.	450 lbs.	450 lbs.	450 lbs.	450 lbs.	875 lbs.	875 lbs.
	Drawbar	30 lbs.	55 lbs.	55 lbs.	55 lbs.	w/winch	w/winch	w/winch	w/winch	w/winch	w/winch	w/winch
	Integral Arch	420 lbs.	420 lbs.	420 lbs.	420 lbs.	875 lbs.	875 lbs.	875 lbs.	875 lbs.	875 lbs.	1100 lbs.	1100 lbs.

WIRE ROPE CAPACITY Shaded sizes not available Capacity per SAE J1158	WINCH MODEL	Barrel Diameter	WIRE ROPE DIAMETER					FERRULE (Swaged Drum Type)		
			1/2 in.	5/8 in.	3/4 in.	7/8 in.	1 in.	Name	Length	Diameter
		H4A	8.00 in.	422 ft.	277 ft.	195 ft.		Bantam	2 in.	1 1/2 in.
		W3C	8.00 in.	354 ft.	232 ft.	164 ft.		Bantam	2 in.	1 1/2 in.
		W5C	8.56 in.		423 ft.	298 ft.	215 ft.	Light	2 1/4 in.	2 in.
	W6G	10.00 in.			376 ft.	271 ft.	210 ft.	Light	2 1/4 in.	2 in.

**Notes:**

\*\*Maximum line pull is the lesser of the maximum line pull that the dozer will develop with the standard gear ratio or the breaking strength for the maximum recommended wire rope for that winch model.

Allied Systems Company reserves the right to change and/or improve specifications and performance at its own discretion without prior notice. Check with dealer for latest data.

