

W400 Series Skidder Winches

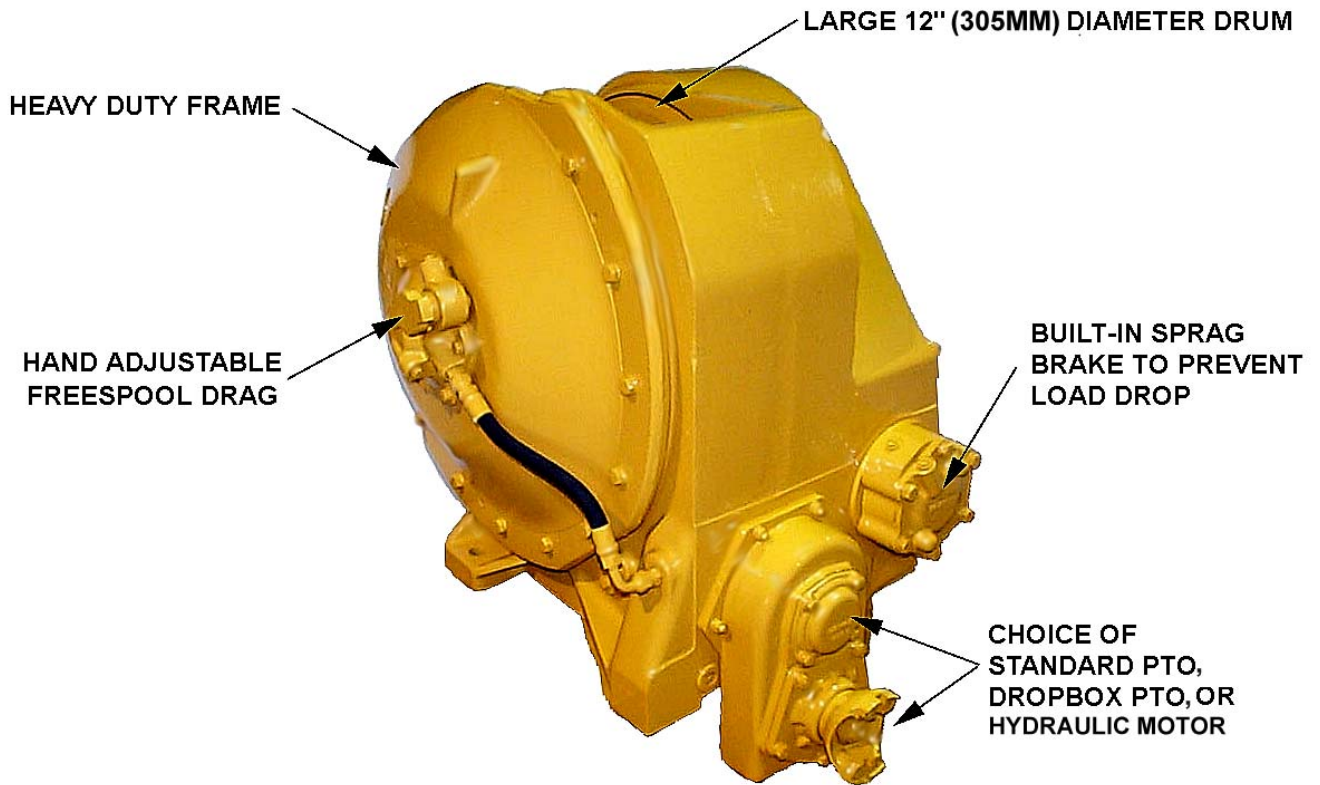

Features



WD400 WITH DROPBOX SHOWN

Specifications

Rotation
 Input..... Clockwise or Counterclockwise
 Drum.....Over-winding

Input Flange
 Mechanics 4C or 5C for PTO Drive
 SAE "C" for Hydraulic Motor Drive (3000 psi)

Input Location
 W400/WH400 Series.....5.25" [133.4 mm] Above Mounting Pads
 WD400 Series0.047" [1.19 mm] Above Mounting Pads

Oil
 Capacity (Normal Operation at Fill Level Plug)4 Gallons
 [15.1 liters]
 (Long Term Storage to the Breather).....9 Gallons
 [34.1 liters]
 Supply.... Regulated Pressure Valve 240-270 psi [16.9-19 kgf/cm²]

Control Valve (PTO, Sold separately)
 Remote Mounted, Hydraulic 3-Position (HOLD/LINE-IN/FREESPOOL)
 Spring Loaded to HOLD Position with Overriding Detent in FREE-
 SPOOL Position.

Maximum Line Pull Capacity (Bare Drum)
 Up to 40,000 lbs [18,180 kg]

Drum Size and Capacities
 Barrel Diameter12.0" [305 mm]
 Barrel Width.....7.79" [200 mm]
 Capacity with 3/4" [19.1 mm] Wire Rope.....215 ft. [65.5 m]
 Capacity with 7/8" [22.2 mm] Wire Rope.....160 ft. [48.8 m]
 Capacity with 1" [25.4 mm] Wire Rope.....92 ft. [28 m]
 Ferrule2.00" X Ø1.50" [50.8 mm X Ø38.1 mm]
2.25" X Ø2.00" [57.2 mm X Ø50.8 mm]

Winch Ratio
 Model W410/WD410/WH41021.65:1
 Model W411/WD411/WH41124.88:1
 Model WD41227.45:1
 Model WD413.....36.97:1

Dry Weight
 W400 Series 1,150 lbs [520 kg]
 WD400 Series 1,200 lbs [544 kg]
 WH400 Series 1,200 lbs [544 kg]

W400, WD400 & WH400



Dimensions

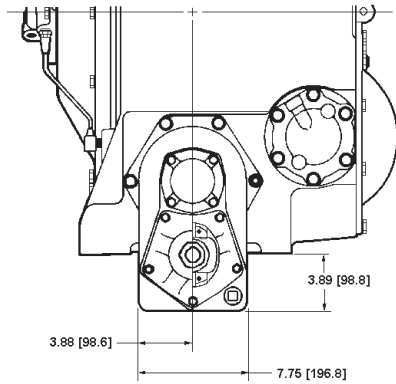

FRONT VIEW WD400 MODEL

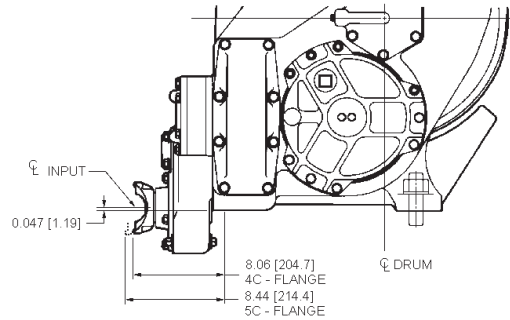

SIDE VIEW WD400 MODEL

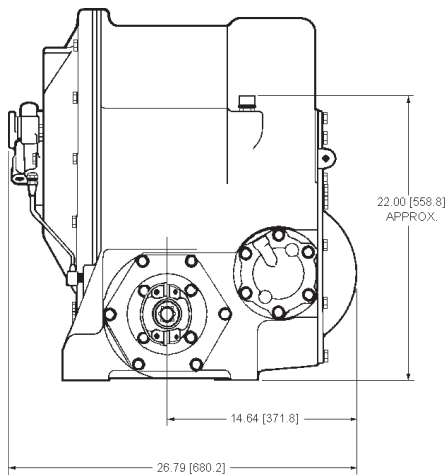

FRONT VIEW W400 MODEL

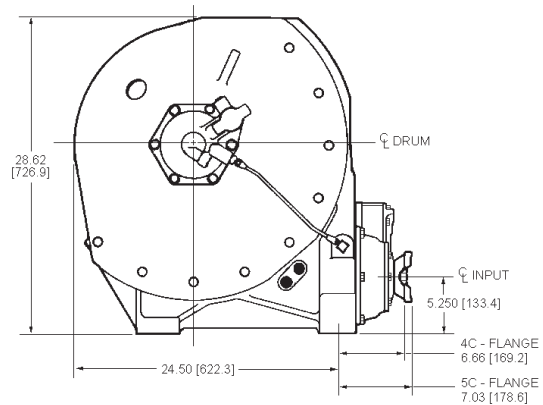

SIDE VIEW W400 MODEL

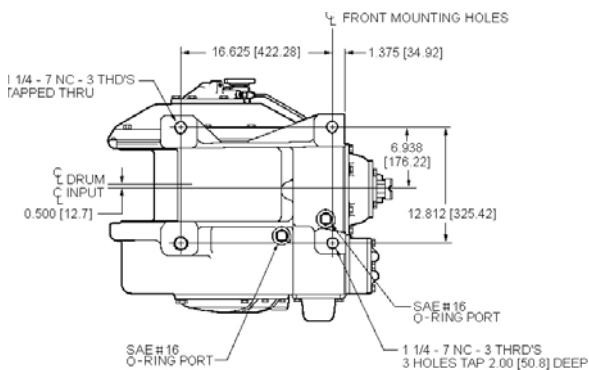

BOTTOM VIEW W400 MODEL

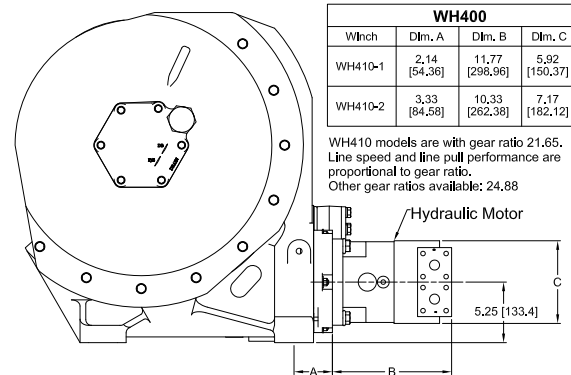

SIDE VIEW WH400 MODEL

WH400			
Winch	Dim. A	Dim. B	Dim. C
WH410-1	2.14 [54.36]	11.77 [298.96]	5.92 [150.37]
WH410-2	3.33 [84.58]	10.33 [262.38]	7.17 [182.12]

WH410 models are with gear ratio 21.65. Line speed and line pull performance are proportional to gear ratio. Other gear ratios available: 24.88

Options

- Input Rotation
- Input Flange Size
- Input Drop Box
- Gear Ratio
- Hydraulic Motor Drive
- Freespool Drag Brake

Allied Systems
COMPANY

WINCH DIVISION

21433 SW OREGON STREET
SHERWOOD, OREGON 97140-9799, U.S.A.
TELEPHONE: (503) 625-2560
FAX: (503) 625-7269 (503) 625-5132
E-MAIL: marketing@alliedsystems.com
WEBSITE: www.alliedsystems.com