

Cab Assembly, Standard

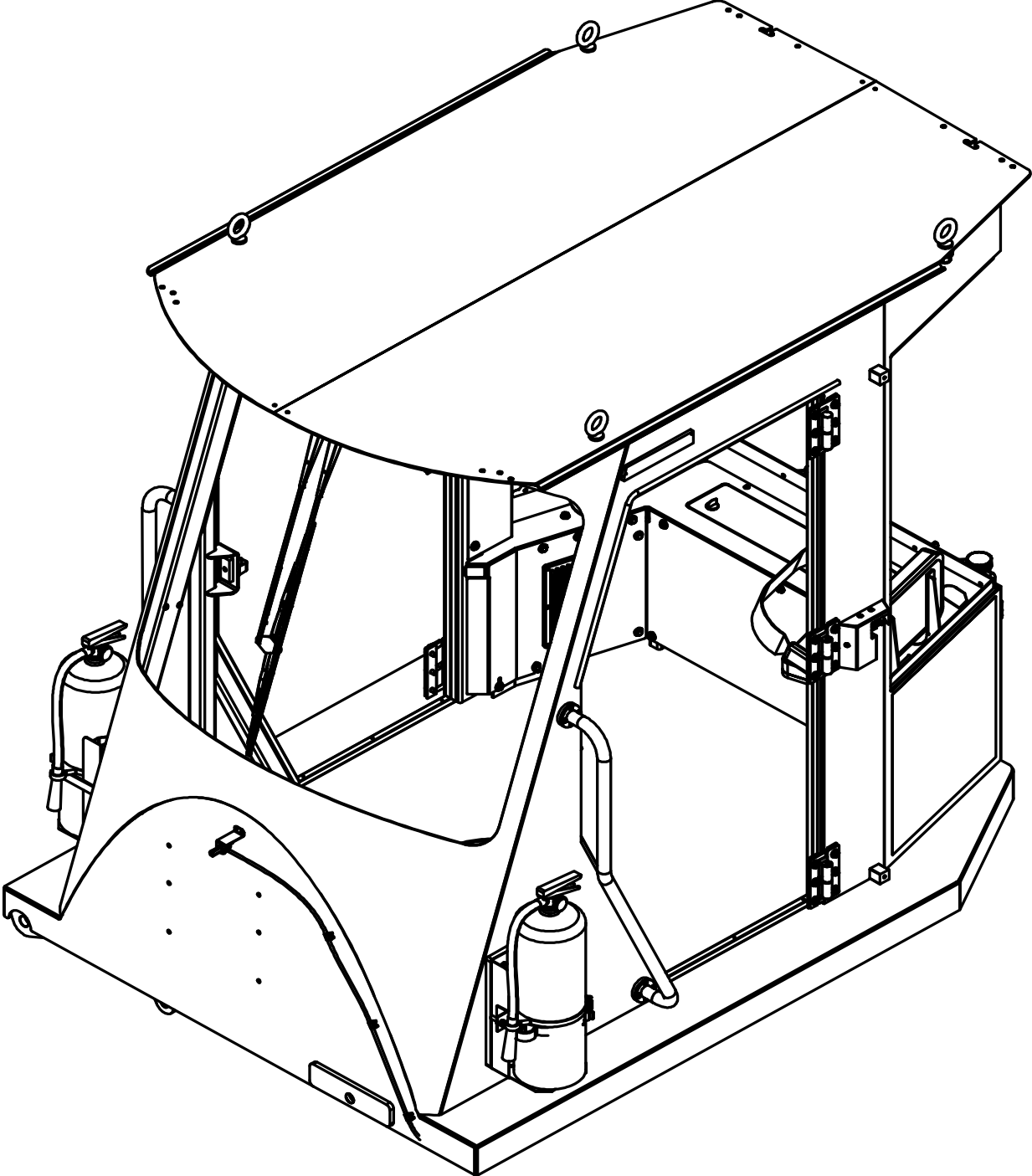

Cab Assembly, Standard

Item	Part No.	Qty	Description	Item	Part No.	Qty	Description
600979 Cab Assembly, Standard							
1	*a 597860	1	. Cab	106	00103340	45	. Washer
2	*a*b 600135	1	. Installation, Window	109	201598	47	. Capscrew
4	590618	1	. Cover Plate	119	Y25G-0414	8	. Capscrew
7	258712	2	. Pin, Striker	126	R13801807	4	. Cpscrew
8	258713	2	. Guard, Striker	129	*a 598508	1	. Installation, Insulation
9	590619	1	. Cover Plate	130	*a 596486	1	. Installation, Insulation
12	587033	2	. Shaft, Stand-Off	131	296418W	4	. Washer
16	259262	4	. Jam Nut	134	R13803026	6	. Clip, Insulated
17	259263	8	. Machine Screw	135	222761	1	. Sealer
18	259264	8	. Nut, Esna	136	594720	1	. Kit, Hose
19	296148W	8	. Capscrew	136.1	234245-36	1	. . Hose
20	320152W	8	. Washer	136.2	234245-152	1	. . Hose
21	587034	2	. Jam Nut	141	242601	30	. Cable Tie (Black)
22	590724	2	. Motor, Wiper	144	593346	30	. Mount, Adhesive Back
23	258773	1	. Arm Assembly, Wiper	145	593629	1	. Stud
24	258774	2	. Blade Assembly, Wiper	147	593658	1	. Spring, Ext
25	258434	4	. Spacer	148	258668	2	. Vent, Louvered
27	587119	1	. Arm Assembly, Wiper	149	R13805587	12	. Screw
31	249776	2	. Nozzle, Jet, Single	151	00103339	2	. Washer
35	*a 586558	3	. Hinge, Door Assembly	152	00103341	4	. Washer
36	*a 586560	3	. Hinge, Door Assembly	153	R13812212	4	. Washer
37	586583	12	. Pad, Hinge	154	596368	2	. Hook, Coat
38	Y25G-0408	16	. Capscrew	155	246037	A/R	. Threadlock
40	2301055W	10'	. Trim	156	R13810989	10	. Capscrew
41	258919	2	. Housing, Bearing	157	595326	7	. Mount, Tack
42	258920	2	. Lever, Clamp	158	230839	1	. Connector, Cord
43	258921	4	. Washer, Thrust	159	212052	2	. Fire Extinguisher
44	258922	2	. Shaft, Flanged	160	212209	2	. Bracket, Mounting
45	258923	2	. Latch, LH Rotary	161	162572W	12	. Capscrew
47	258925	1	. Spring, Ext	162	597926	1	. Plate, Beauty Panel
48	258926	4	. Clevis	163	597996	1	. Plate, LH Side Cover
49	258928	1	. Stud	164	597997	1	. Plate, RH Side Cover
50	586559	2	. Plate, Arm	165	590235	2	. Plate, Mounting
51	593626	1	. Latch, Holdback	166	598059	1	. Plate, Mounting Bracket
52	593340	1	. Plate, RH Holdback Cover	167	598058	1	. Plate, Mounting Bracket
53	593628	1	. Plate, LH Cover	168	605356	6	. Machine Screw
54	593339	1	. Holdback Latch, RH	169	596495	6	. Machine Screw
56	R6515575	2	. Clamp	170	587608	1	. Decal, Trans Operation
57	*a 598275	2	. Bottle, Washer	171	557341	1	. Decal, Warning Read Ops Manual
58	215774	2	. Mirror, Convex	172	592855	1	. Decal, Wheel Nuts
59	526939	2	. Bracket	173	504204	1	. Decal, Caution Do Not Reverse
66	597922	1	. Plate, Panel Rear	174	587028	1	. Nameplate, Load Capacity
67	596468	1	. Plate, Panel Rear - RH	175	1321665W	1	. Decal, Warning
68	596467	1	. Plate, Panel Rear - LH	176	223061	1	. Decal, Warning, Voltage
69	590698	1	. Weldment, Panel - Front	177	586693	1	. Nameplate
72	597904	1	. Cover, Storage Comp	178	593905	2	. Decal, Logger W/Log
73	258860	2	. Cam Latch Assembly	179	R13810992	4	. Capscrew
90	15113W	12	. Locknut	180	*a 601086	1	. Trainers Seat
91	221763W	34	. Washer	181	Y25G-0512	6	. Capscrew
92	Y25G-0406	8	. Capscrew	182	R13802914	10	. Washer
94	R13803445	2	. Locknut	184	Y25G-0508	2	. Capscrew
95	596491	2	. Machine Screw	185	605725	2	. Tap Bar, Striker Mt
101	224120W	4	. Capscrew	186	606114	2	. Plate, Mounting
103	R13811034	36	. Capscrew	187	R13811190	2	. Locknut
105	221767W	48	. Washer				

*a See Separate Coverage

*b Not Illustrated

NOTES:

- 2: ITEM 73 (CAM LATCH ARM) MAY HAVE TO BE SHORTENED SLIGHTLY FOR CLEAR SWEEP.
- 3: TRAINERS SEAT CAN BE INSTALLED ON EITHER THE LH OR RH SIDE OF THE CAB IN THE SAME MANNER. LH IS DEFAULT FOR SCREEN VISIBILITY.
- 4: WIPER BLADE IS OFFSET, POSITION LONG END UP TO PREVENT BOTTOM FROM TRAVELING OFF THE BOTTOM OF THE FRONT WINDOW.
- 5: DOOR CLEARANCE SHOULD BE UNIFORM ALL THE WAY AROUND; APPROXIMATE CLEARANCE IS 0.13". INSTALL LOWER 2 HINGES AND POSITION DOOR WITHIN OPENING AS NOTED. INSTALL TOP HINGE TO LOCK DOOR ASSEMBLY ONTO CAB. APPLY NEVER SEIZE AND TORQUE TO 27 FT-LBS MAX.
- 6: USE ITEM 21 (NUT) TO SECURE ITEMS 43 (WASHER) & 44 (SHAFT) IN ITEM 41 (HOUSING). ITEM 43 (WASHER) HAS A GREY SIDE, AND A SILVER SIDE. THE GREY SIDE IS THE THRUST FACE, AND SHOULD BE AGAINST THE SURFACE OF ITEM 41 (HOUSING) ON BOTH SIDES OF ITEM 41 (HOUSING). DO NOT OVERTIGHTEN, SHAFT SHOULD ROTATE WITH SLIGHT RESISTANCE TO MOTION. TIGHTEN ITEM 12 (SHAFT) AGAINST ITEM 21 (NUT). APPLY BLUE 242 LOC-TITE TO ITEMS 12 & 44
- 7: ITEM 42 (LEVER) CAN BE INSTALLED AFTER ITEMS 4 & 9 (RH & LH COVERS) HAVE BEEN INSTALLED.
- 8: BLACK HARDWARE USED IN SOME LOCATIONS IN AN ATTEMPT TO MAKE ALL VISIBLE HARDWARE INSIDE OF CAB BLACK.
- 9: ** APPLY ITEM 135 TO ALL OPENINGS AND GAPS ASSOCIATED WITH GROMMETS AND OTHER PASS THROUGH INTO THE CAB THROUGH THE ROOF & CAB SIDES.
- 10: USE ITEM 184 AS NEEDED NEAR CORNERS OF PRESSURIZING TANK BRACKET OR CAB ASSEMBLY

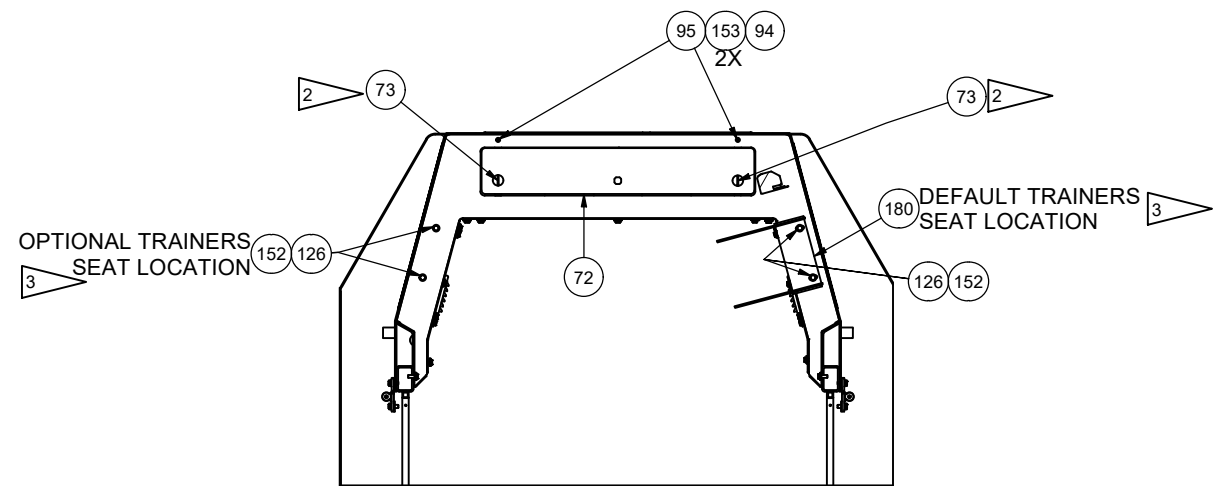
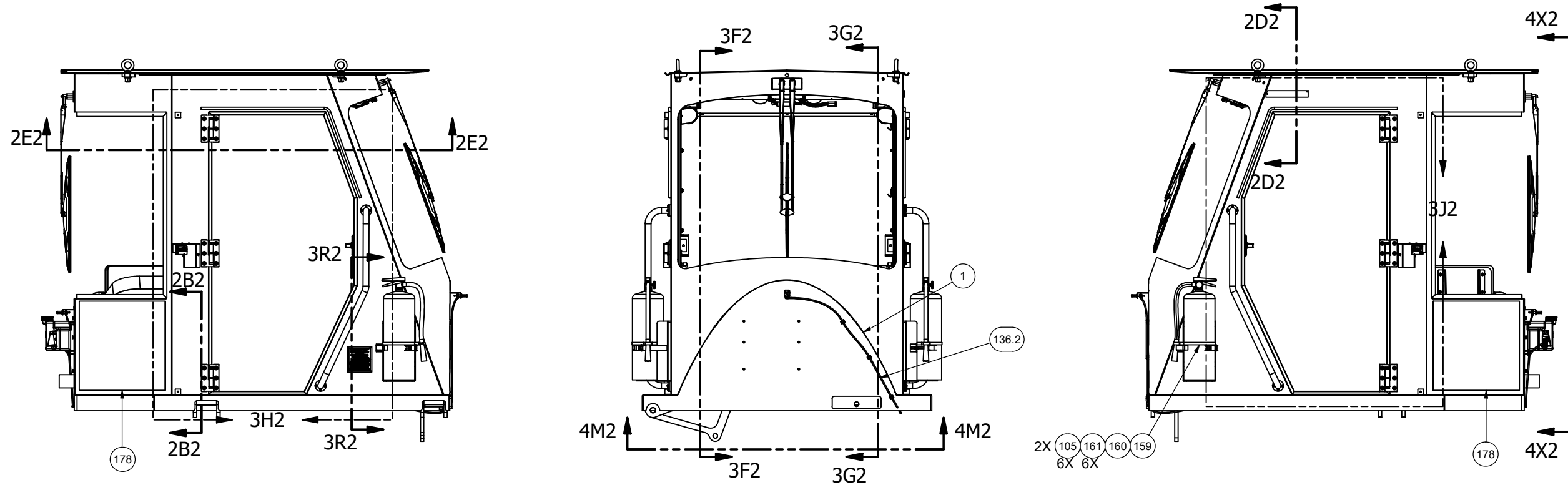

SECTION 2A2-2A2

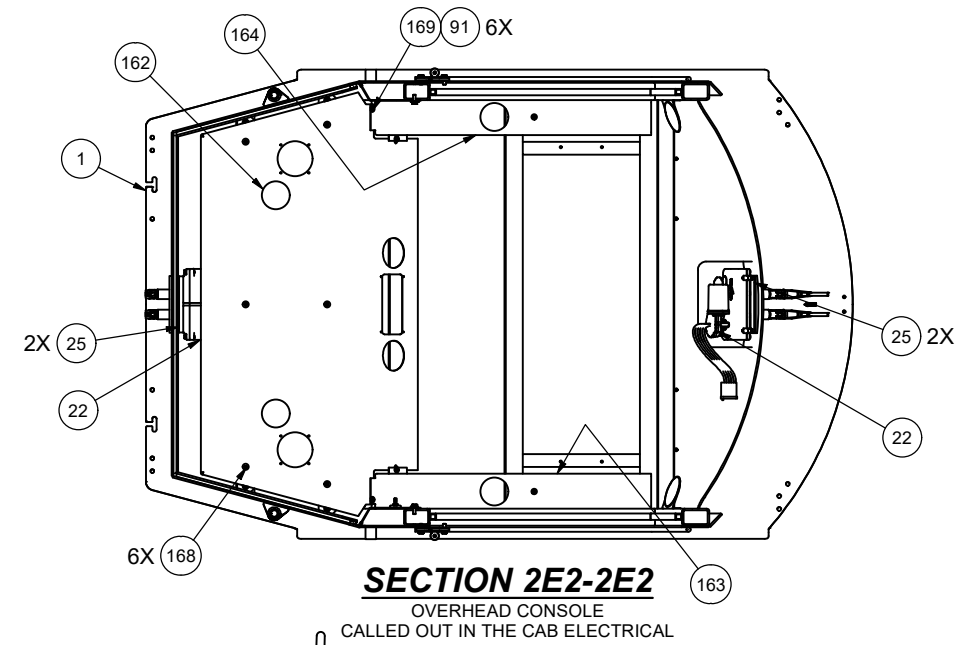

SECTION 2E2-2E2

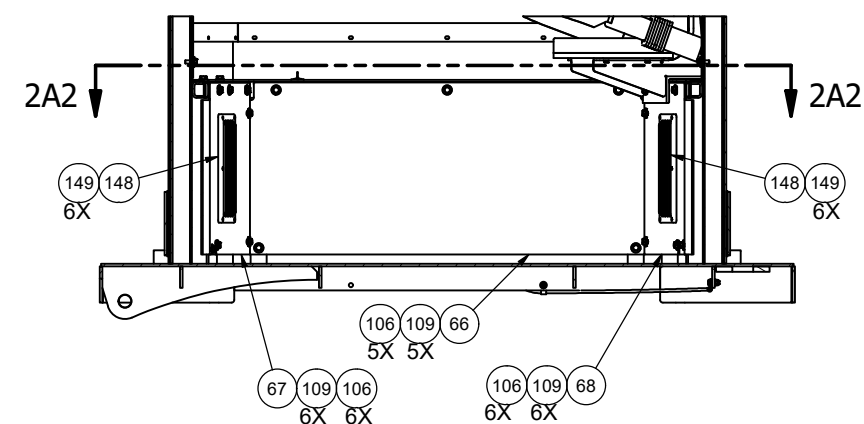

SECTION 2B2-2B2

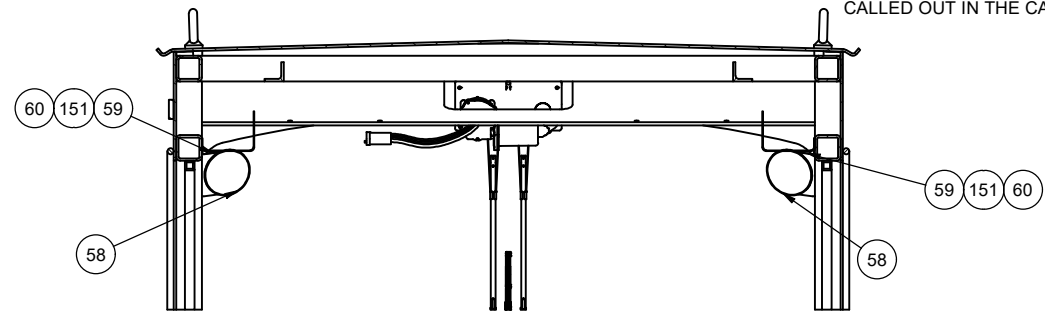

SECTION 2D2-2D2

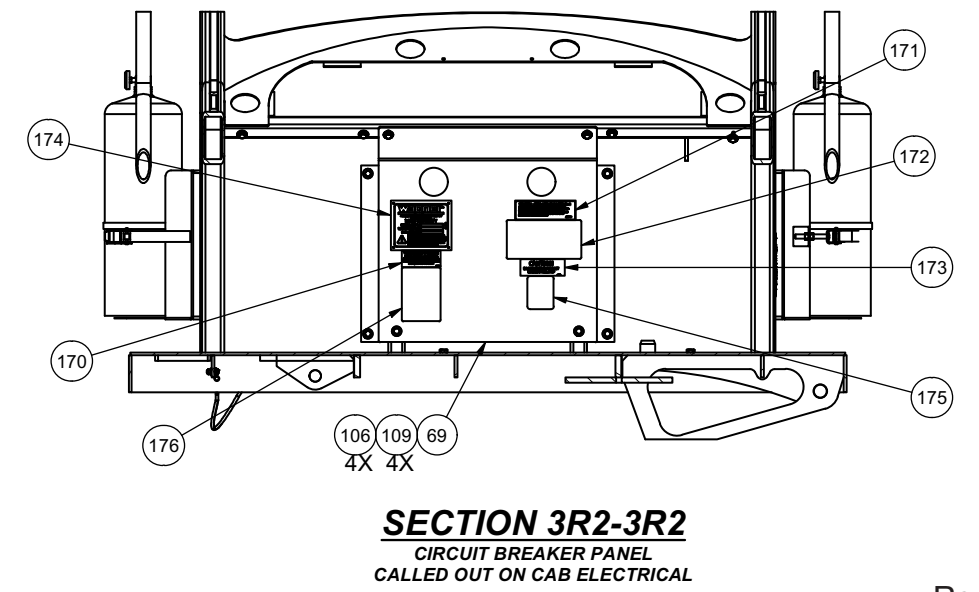
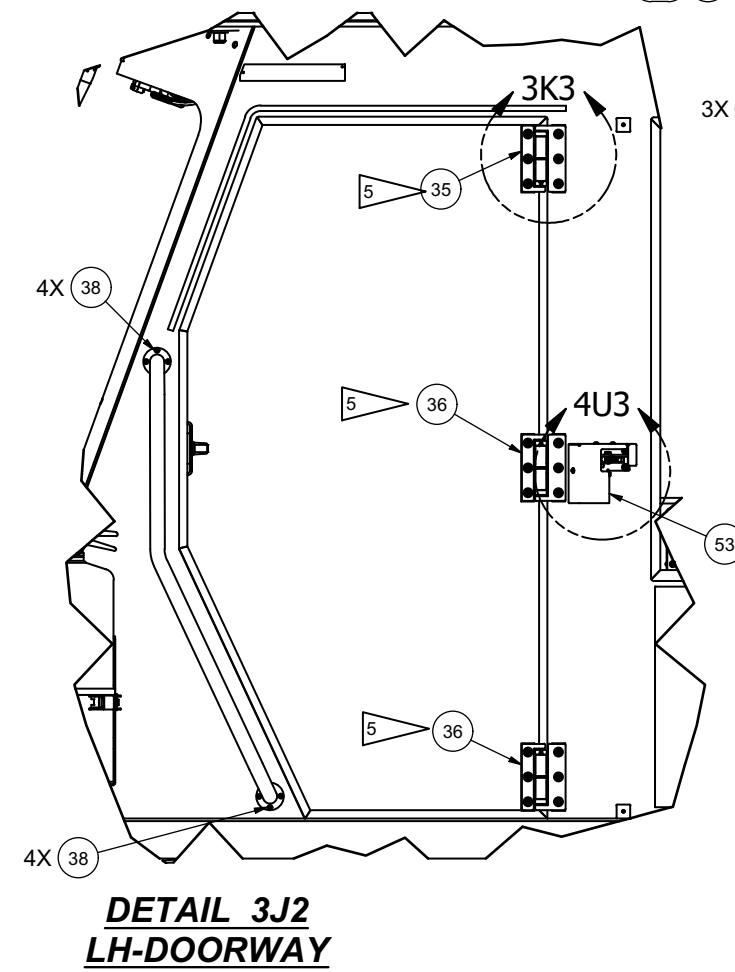
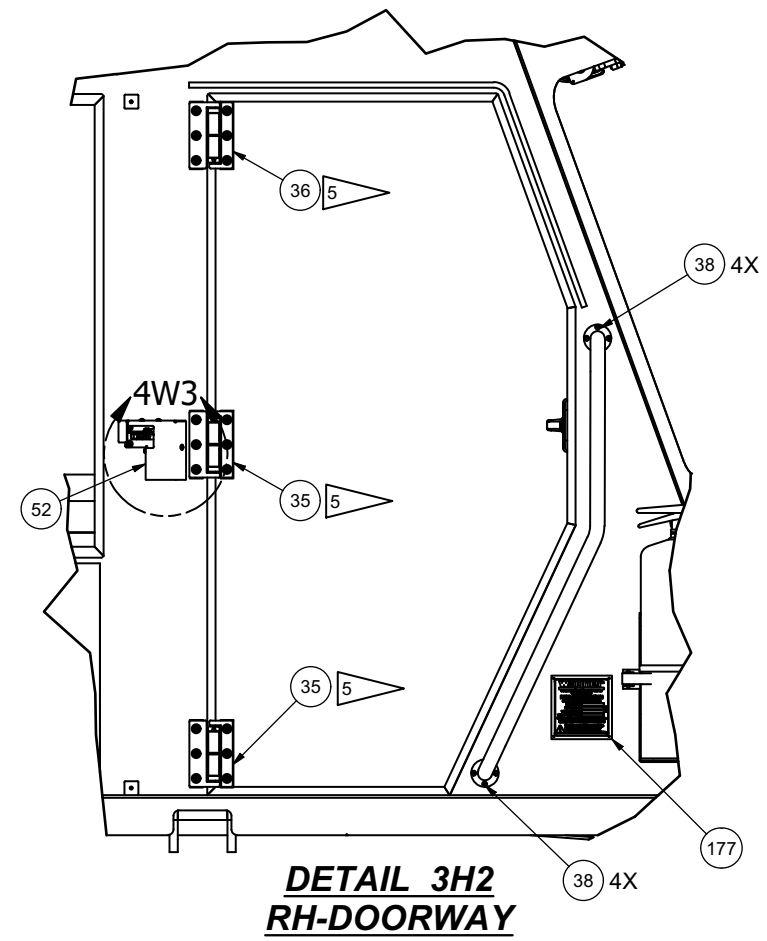
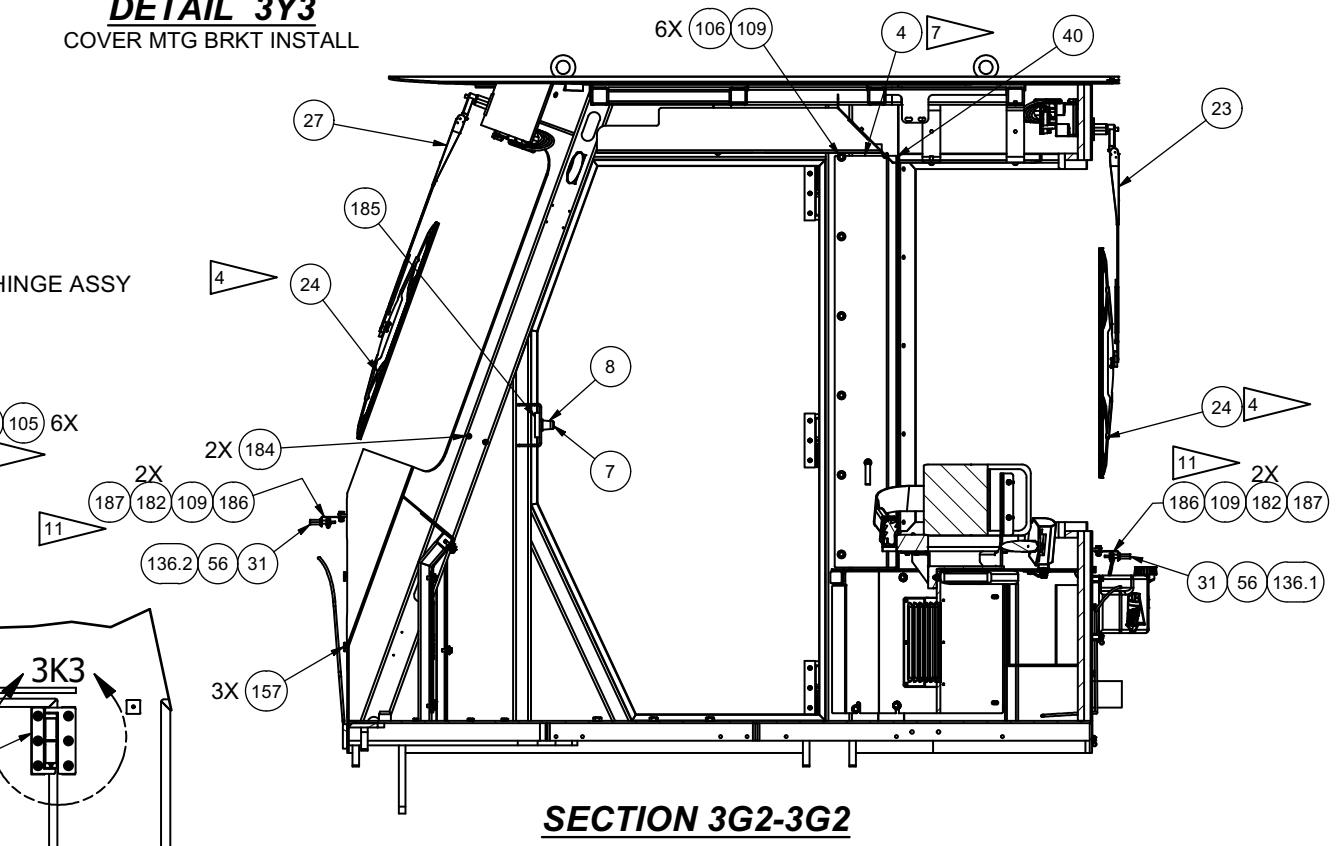
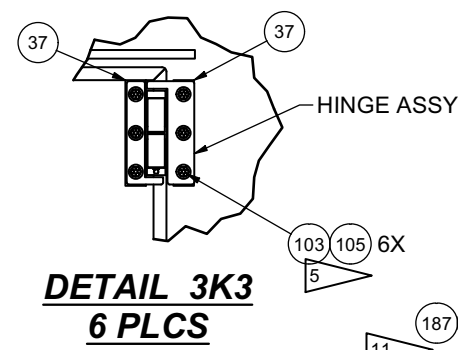
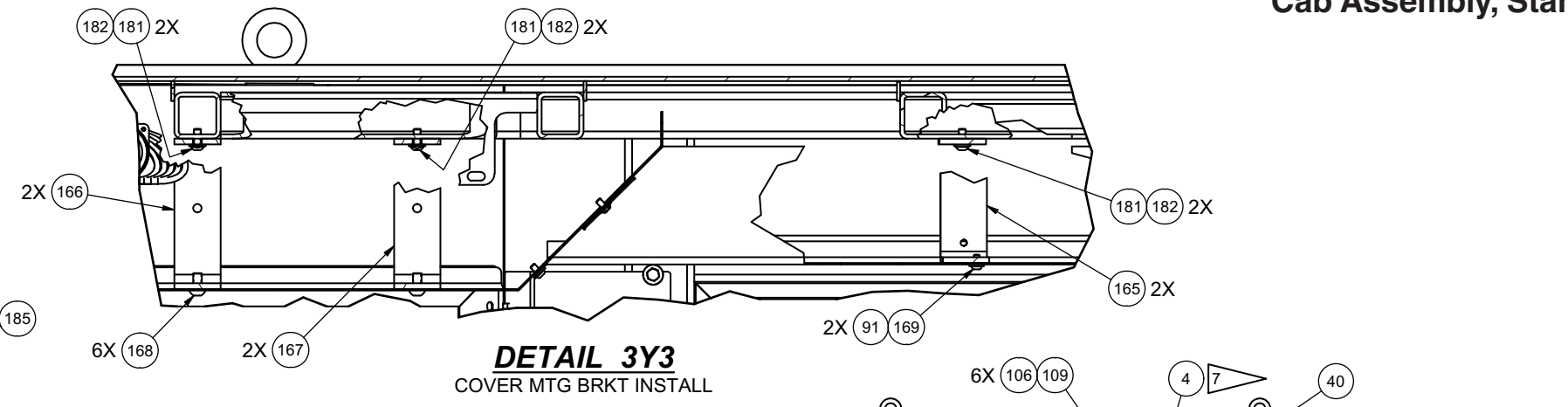
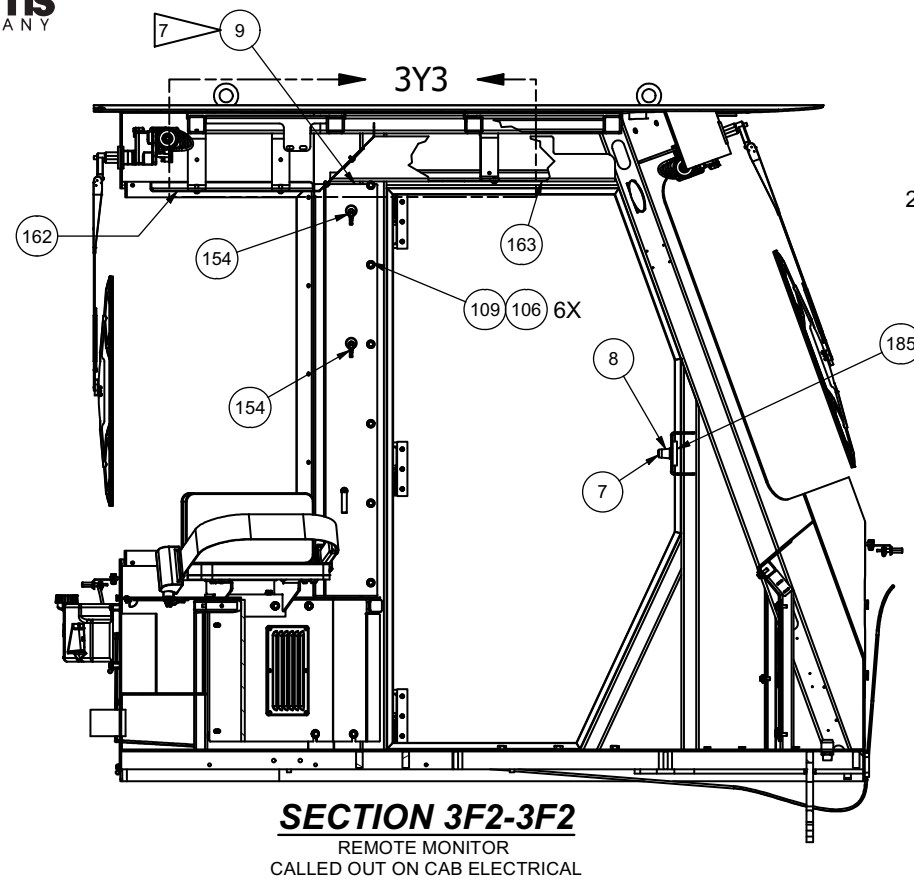

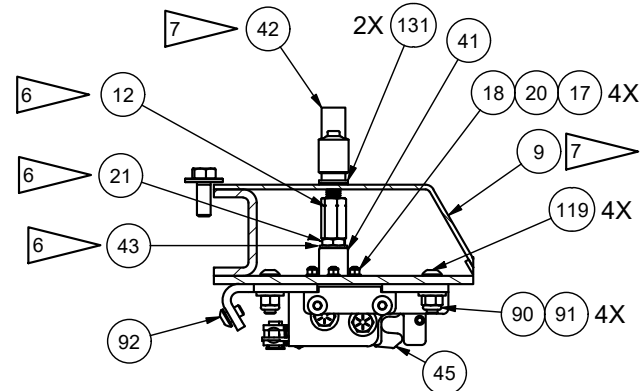

SECTION 4T4-4T4

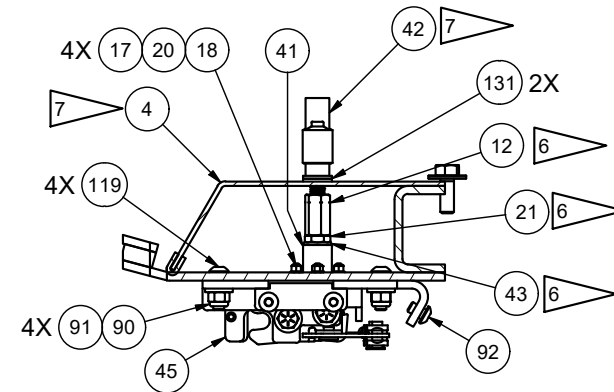

SECTION 4V4-4V4

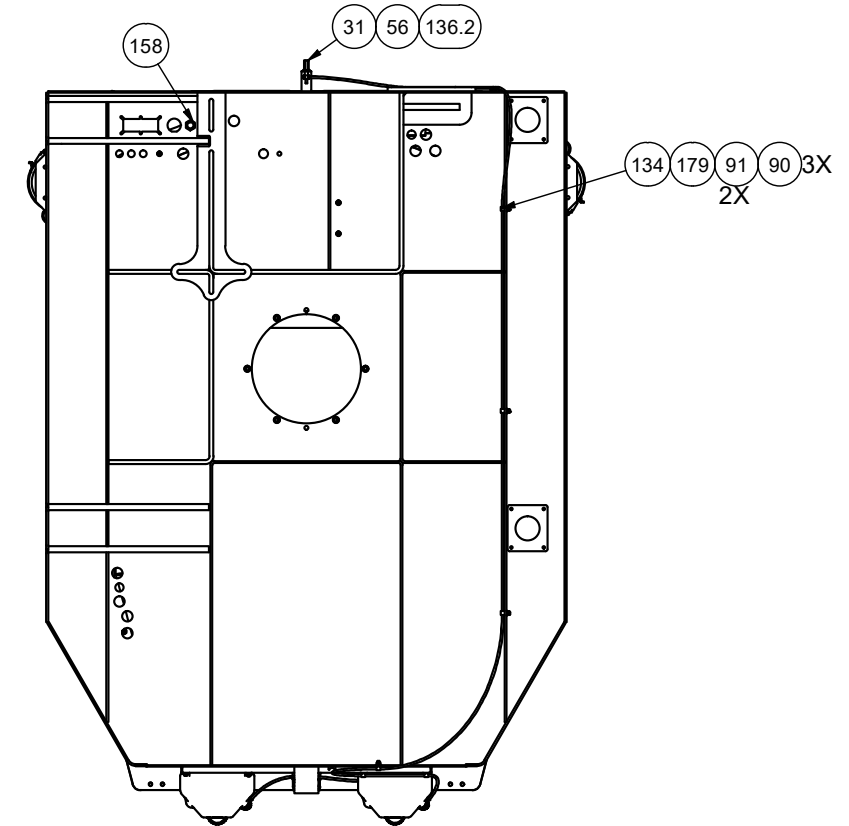

VIEW 4M2-4M2

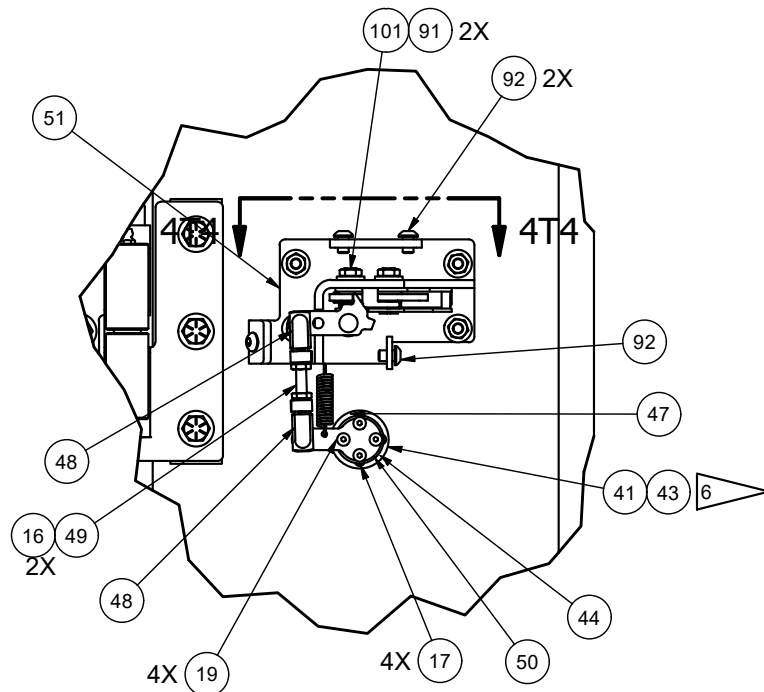

DETAIL 4U3
LH SIDE

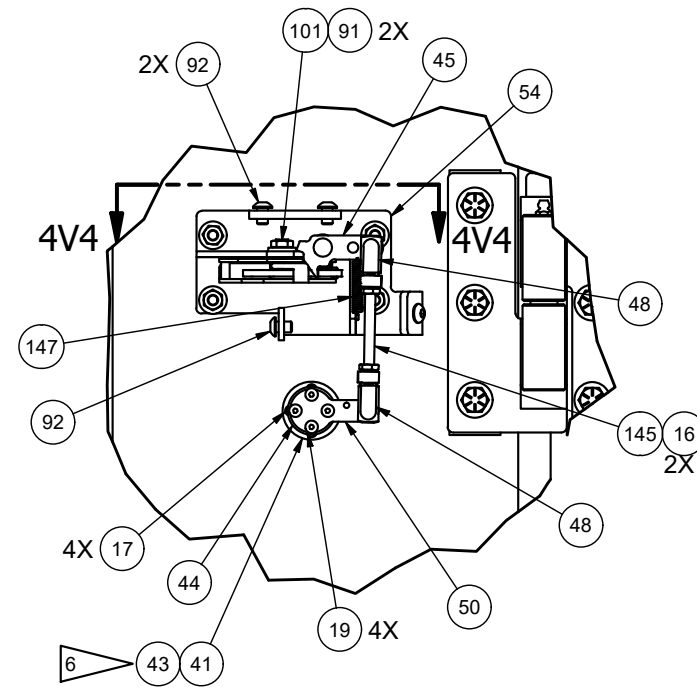

DETAIL 4W3
RH SIDE

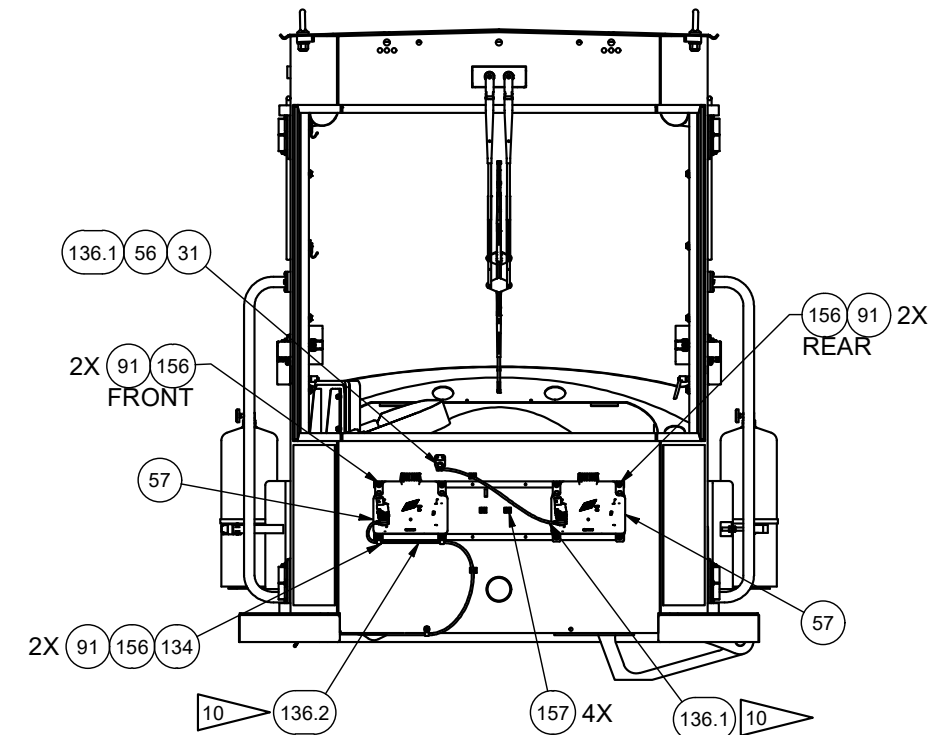

VIEW 4X2-4X2