

Power Unit, Scania T4

Power Unit, Scania T4

Item	Part No.	Qty	Description	Item	Part No.	Qty	Description
	600941		Power Unit, Scania T4	83	R13811054	6	. Capscrew
1	* 600961	1	. Power Unit Assembly	84	221532W	10	. Capscrew
2	601360	2	. Engine Mount	85	221563W	8	. Capscrew
3	234497	6	. Vibration Dampener	86	219975	8	. Capscrew
4	578361	12	. Washer	87	221569W	6	. Capscrew
5	601361	1	. Evap Mount	88	Y17C-1272	10	. Capscrew
6	601362	1	. Screw Mount	90	293628W	6	. Capscrew
7	601363	1	. Exhaust Clamp	91	221763W	36	. Washer
8	208241	1	. Clamp	92	R13802914	38	. Washer
9	254793	1	. Exhaust Stack	93	R13811432	32	. Washer
10	250644	1	. Exhaust Stack	94	221771W	30	. Washer
11	601364	1	. Exhaust Weldment (SS)	95	221777W	20	. Washer
12	601365	1	. Exhaust Weldment (SS)	96	221703W	8	. Hex Nut
13	601366	1	. Exhaust Weldment (SS)	97	41494	4	. Stud
14	601368	1	. Exhaust Weldment (SS)	98	221705W	8	. Hex Nut
15	601369	1	. Bracket, Air Filter Mount	99	R13811190	35	. Locknut
16	* 600155	1	. Air Cleaner	100	R13805167	10	. Locknut
17	226793	1	. Elbow, Air Intake	101	223587	8	. Locknut
18	228425	1	. Elbow	102	R13811196	10	. Locknut
19	YDHA 8212-15.50	1	. Tube	103	595832	1	. Loctite
20	259035	1	. T-Bolt Clamp	105	15113W	18	. Locknut
21	224199	1	. T-Bolt Clamp	106	595326	1	. Mount, Tack
22	210788	1	. T-Bolt Clamp	107	249329	5	. Cable Tie
23	226792	1	. T-Bolt Clamp	110	231251	2	. Clamp
24	601377	1	. Tube, CAC	120	231296	15	. Clamp
25	601379	1	. Tube, CAC	121	231250	16	. Clamp
26	243488	4	. Connector	122	588316	1	. Clamp, Hydra-Zorb
27	243489	8	. Clamp	123	218642	1	. T-Bolt Clamp
28	601380	2	. Tube, Radiator	124	601980	1	. Air Shroud
29	601381	2	. Reducer, Rad Hose	125	603942	1	. Air Intake Shroud Gasket
30	219321	2	. T-Bolt Clamp	127	18496W	8	. Capscrew
31	225369	6	. T-Bolt Clamp	128	18515W	16	. Washer
32	601382	1	. Bracket, Filter Mount	130	601988	4	. Bumper
33	600891	1	. Breather	131	75748	4	. Stud
34	601981	1	. Fitting, High Temp	132	259839	8	. Gasket
35	591648	1	. Ball Valve	133	602576	1	. Strainer, Y
36	603669	1	. Fitting	134	209417	1	. Fitting
37	209166	1	. Fitting	135	603670	1	. Fitting
39	R13807521	1	. Fitting	136	602709	2	. Cover Plate
40	601864	3	. Fitting, High Temp	137	R13801782	4	. Capscrew
41	231412	1	. Ball Valve	139	604034	1	. Exhaust Blanket
42	22387	1	. Fitting	140	604035	1	. Exhaust Blanket
43	209757	1	. Fitting	141	604036	1	. Exhaust Blanket
44	601383	2	. Fitting, High Temp	142	604037	1	. Exhaust Pipe Blanket
45	601445	2	. Fitting, High Temp	143	604213	1	. Exhaust Blanket
49	209409	1	. Fitting	144	603916	1	. T-Handle
50	209848	1	. Hose End, Code A/Fitting	145	604058	1	. Access Cover
52	201431	4	. Hose Clamp	146	604060	1	. Vent Screen
53	241844	1	. Fitting, Bulkhead	147	604214	1	. Heat Shield
54	208136	1	. Indicator	148	604215	1	. Fan Hole Cover
55	208137	1	. Fitting, Filter Indicator	149	604216	1	. Fan Mount
56	209790	1	. Fitting	150	Y17C-0616	4	. Capscrew
57	209511	3	. Fitting	151	230776	6	. Capscrew
58	601777	0	. Exhaust Bellows (SS)	152	221767W	10	. Washer
59	225132	1	. Fitting	199	601415	1	. Kit, Hose
60	603999	1	. Vent Fan	199.1	211791-19	1	.. Hose, Radiator
61	MNT0050025	4	. Knotter Fan Shroud Mount	199.2	211791-65	1	.. Hose, Radiator
62	239419W	1	. Grommet	199.3	259356-72	1	.. Hose, Heater
70	604053	1	. Scania Hood	199.5	259356-90	1	.. Hose, Heater
71	601385	1	. LH Hood Door	199.6	209843-36	1	.. Hose, Push On
72	601386	1	. RH Hood Door	199.7	R12380	1	.. Hose Assembly
73	604047	1	. LH Access Panel	199.8	601411	1	.. Hose Assembly, Fuel
74	604048	1	. RH Access Panel	199.9	601412	1	.. Hose Assembly, Fuel
75	601979	4	. Gas Spring	199.10	601413	1	.. Hose Assembly, Fuel
76	590052	4	. Stop, Door	199.11	601414	1	.. Hose Assembly, Fuel
77	602578	6	. Knob, Hand	199.12	595490	1	.. Hose Assembly, Fuel
80	R13810993	14	. Capscrew	199.13	600568	1	.. Hose Assembly, Fuel
81	R13811014	16	. Capscrew	199.14	242687-72	2	.. Sleeve, Fire
82	R13806527	3	. Capscrew				

*See Separate Coverage

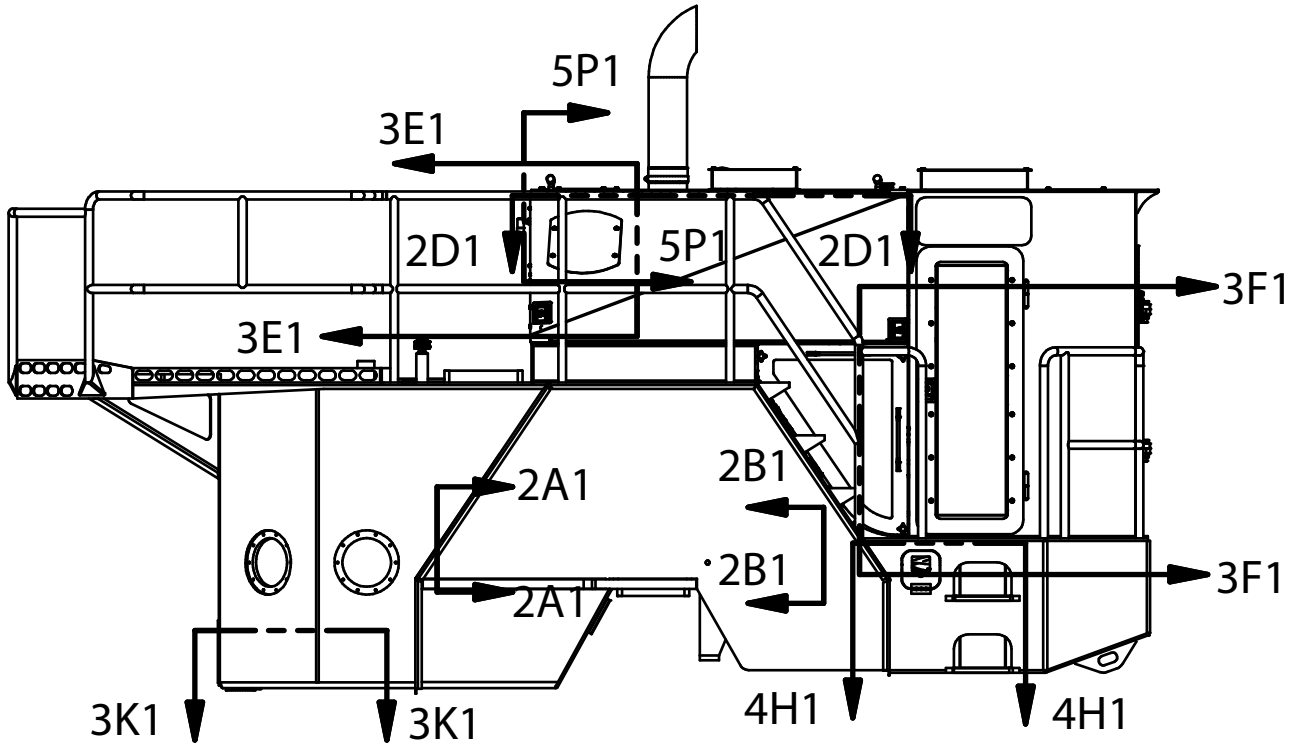
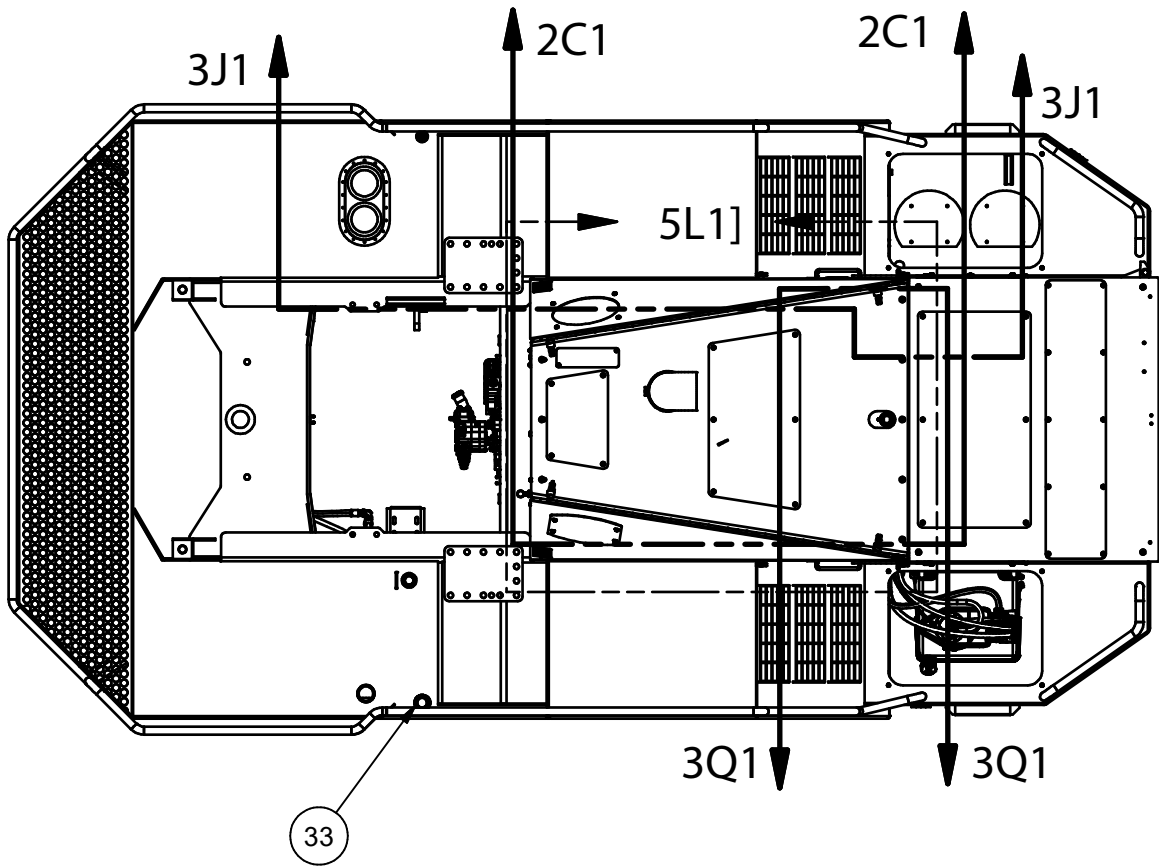
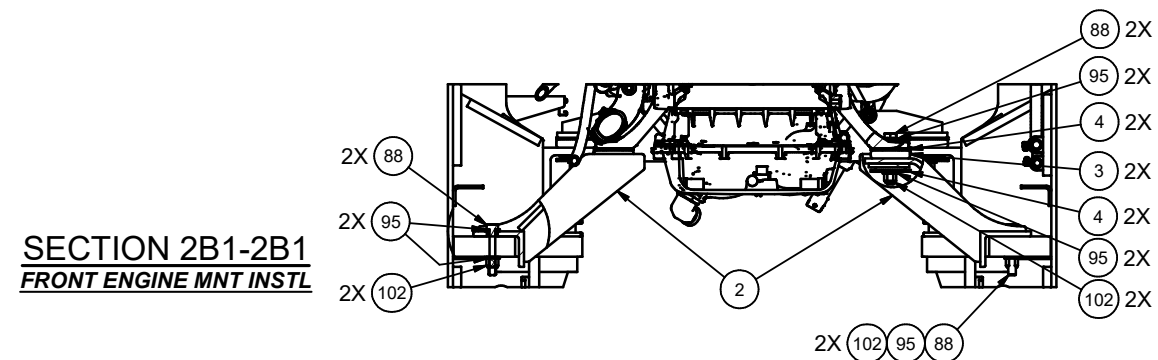
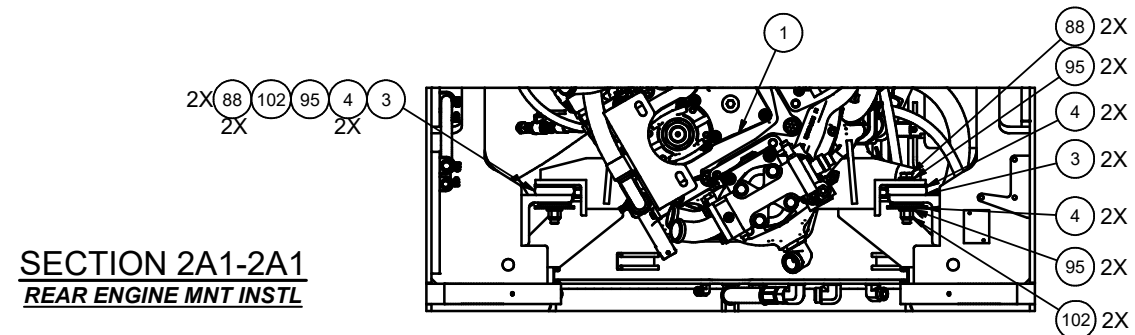
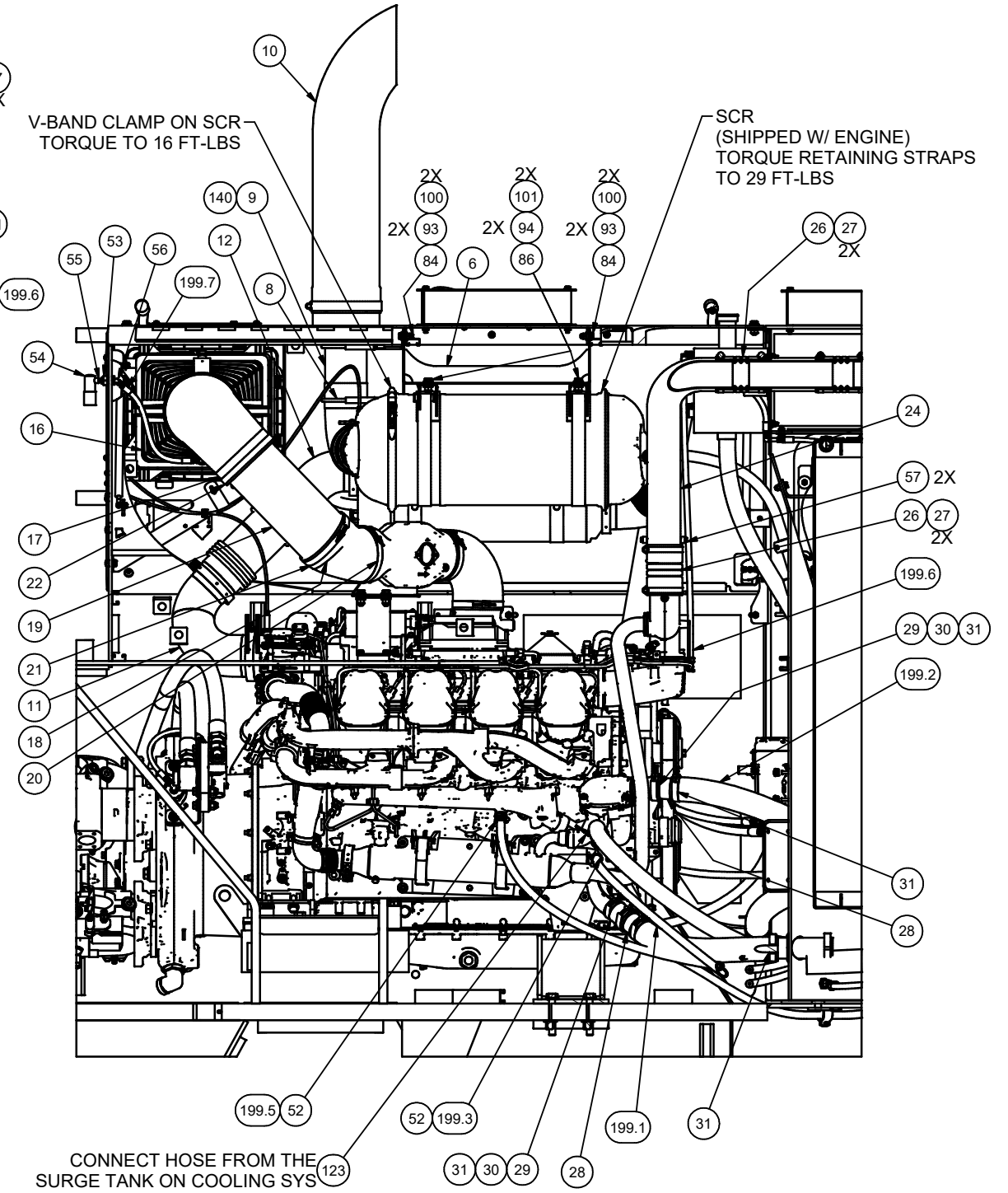
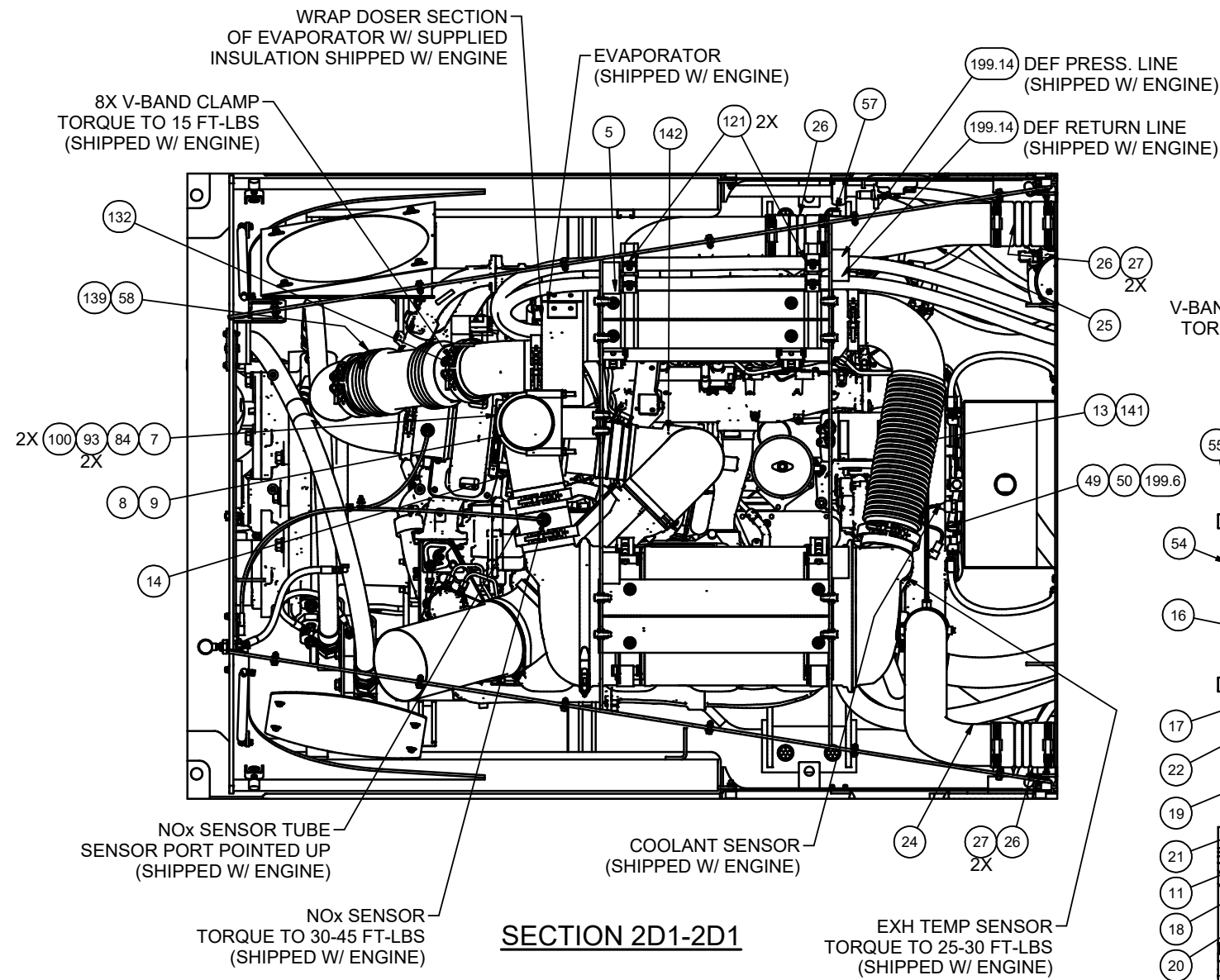



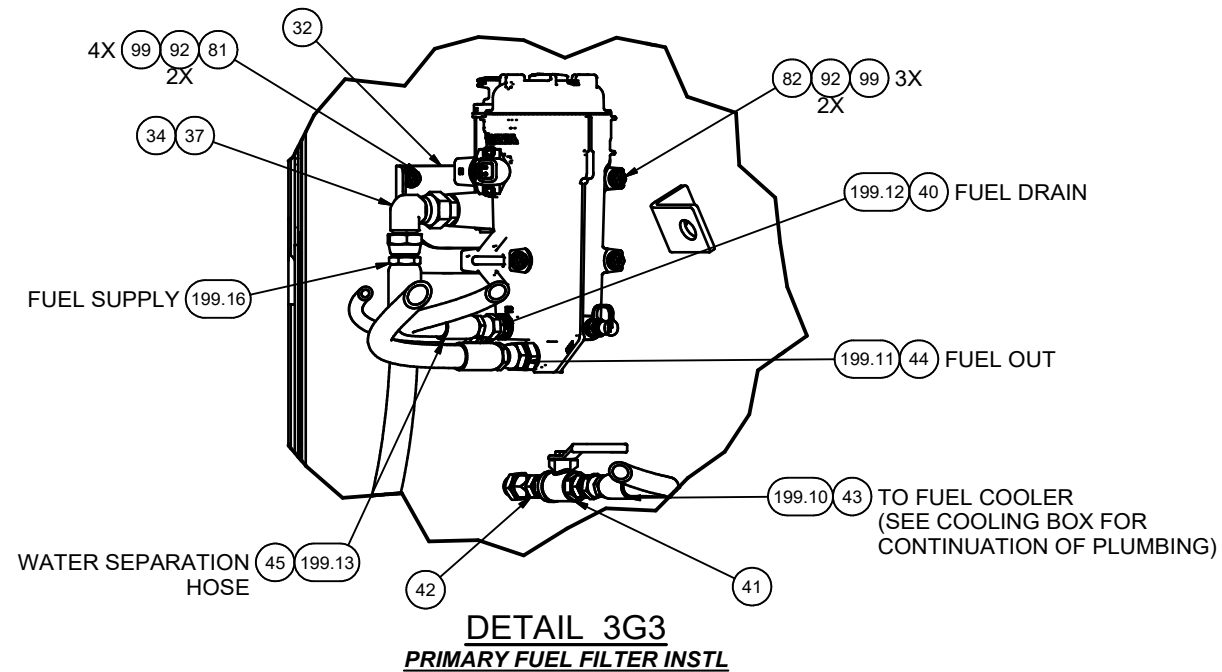
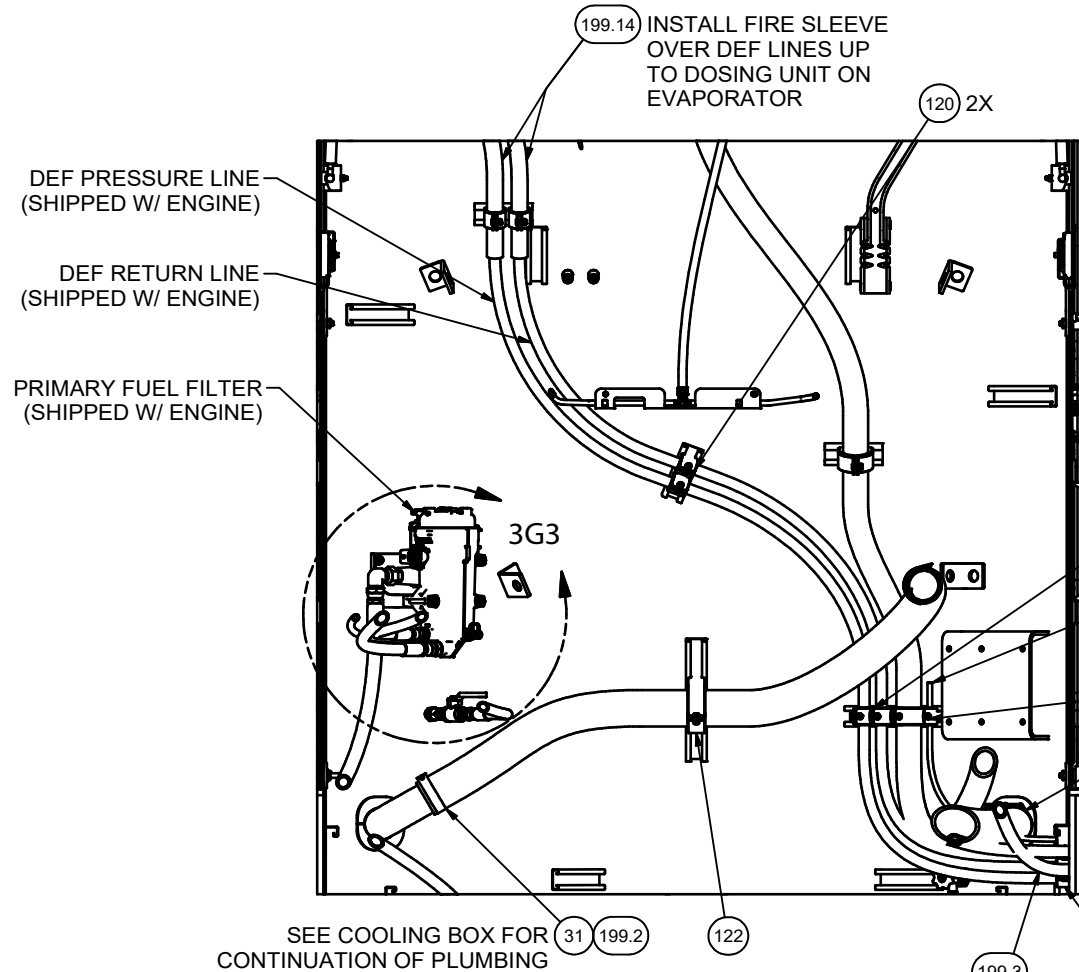
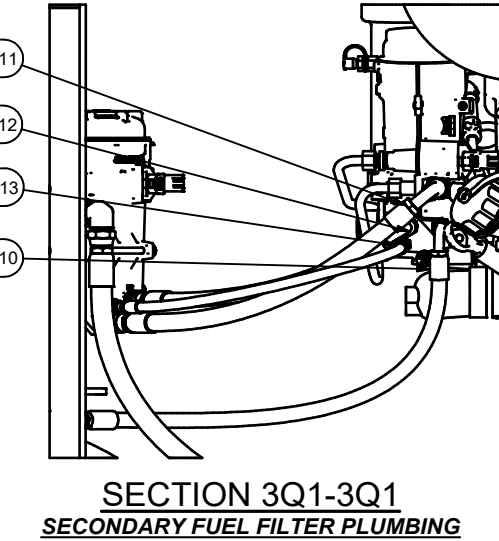
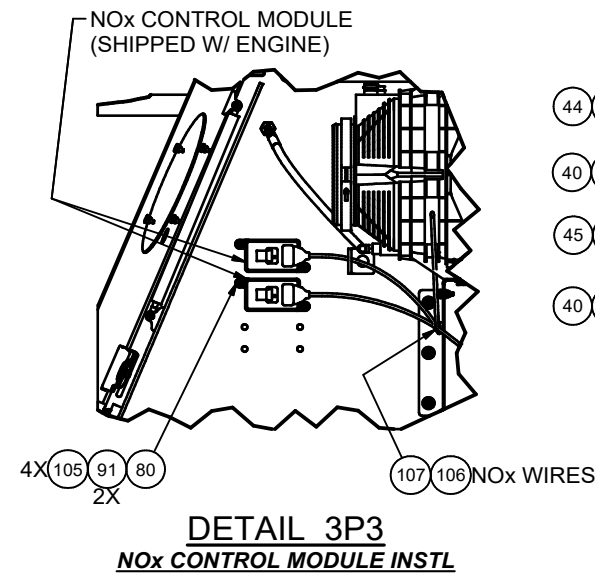
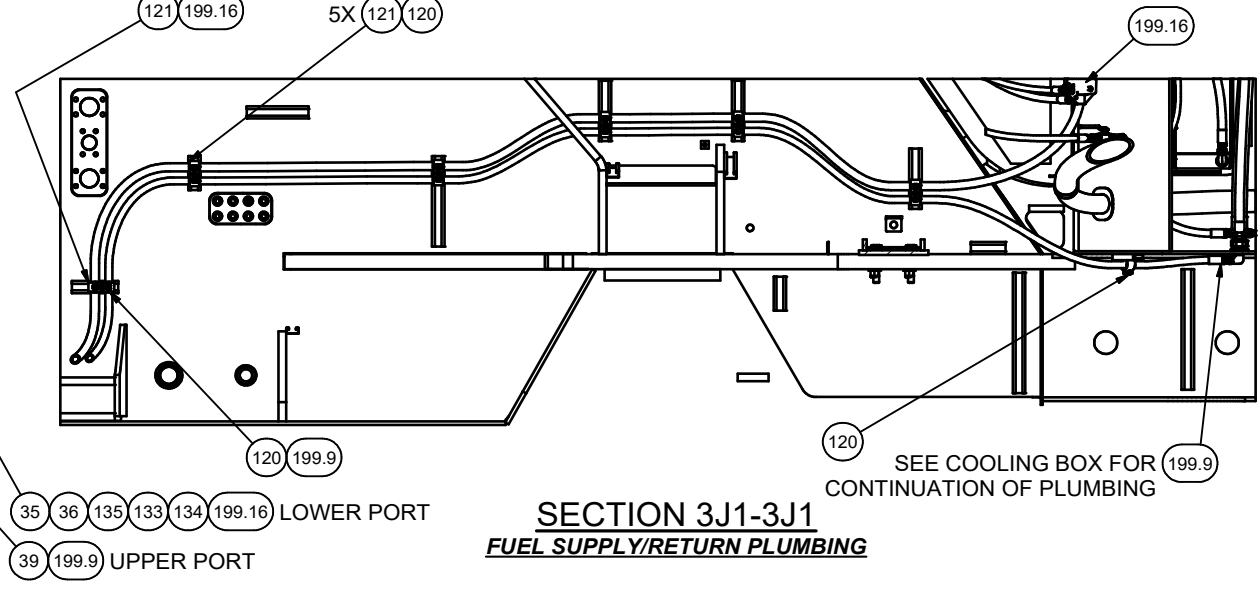
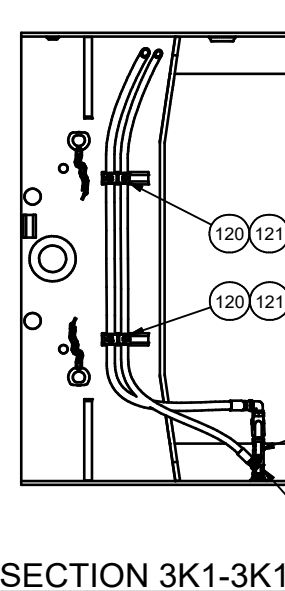
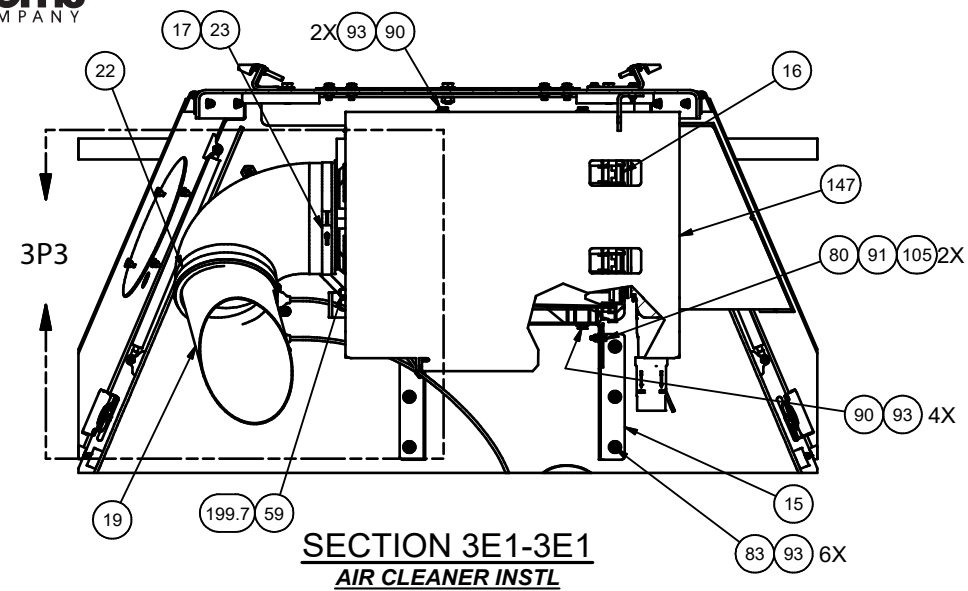

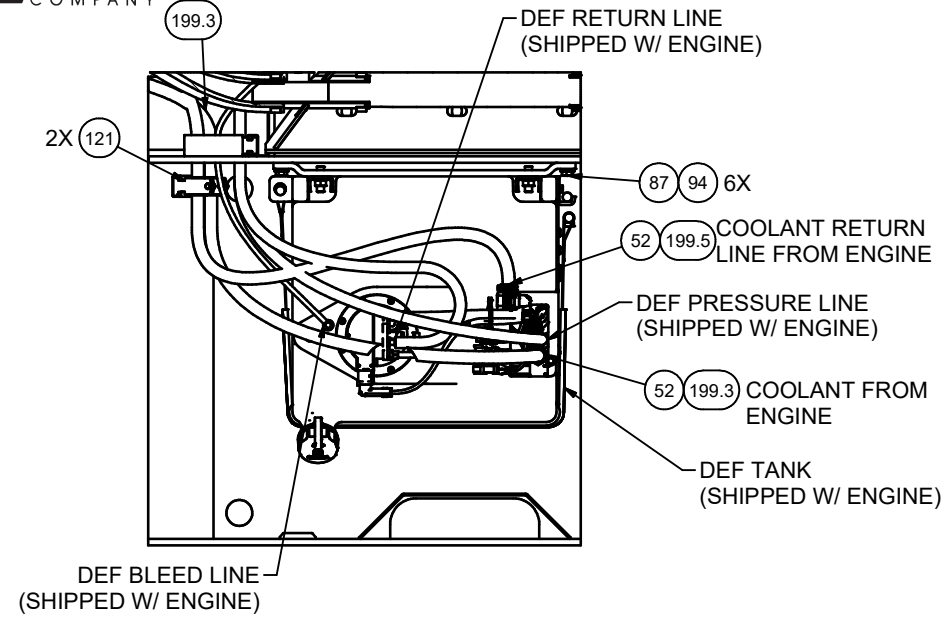

SECTION 4H1-4H1
DEF TANK INSTALLATION

System overview of mechanics

The illustration provides an overview of the component parts of the SCR system.

Item	Component	Supplied from the factory	Fitted by fitter
1	Evaporator with reductant doser ¹	X	X
2	Pressure hose for reductant	X	X
3	Coolant hose for heating the reductant tank and pump		X
4	Coolant valve	X	
5	Reductant return hose	X	X
6	Reductant tank	X	X
7	Coolant hose, return from heating the tank and pump		X
8	NOx sensor in exhaust brake housing/exhaust pipe downstream of the turbocharger with control unit ²	X	
9	Oxidation catalytic converter ³	X	X ⁴
10	Exhaust gas temperature sensor	X	X
11	SCR catalytic converter	X	X
12	NOx sensor on the SCR catalytic converter outlet side with control unit	X	X

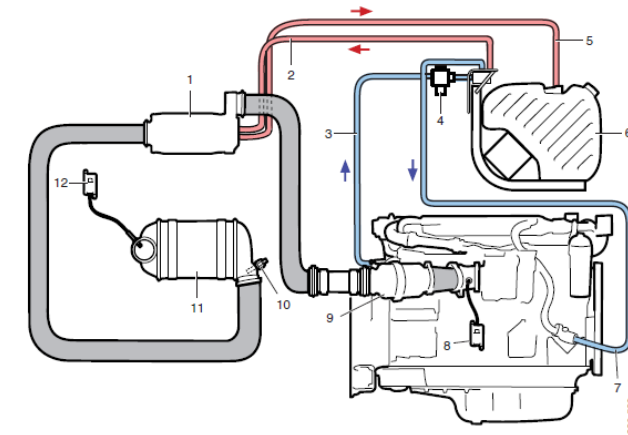

1. Hydrolysis catalytic converter is used for DC16 Stage III B/Tier 4i.
2. Stage IV/Tier 4f only.
3. Stage IV/Tier 4f only. Not DC13 085A and DC16.
4. Customer option.

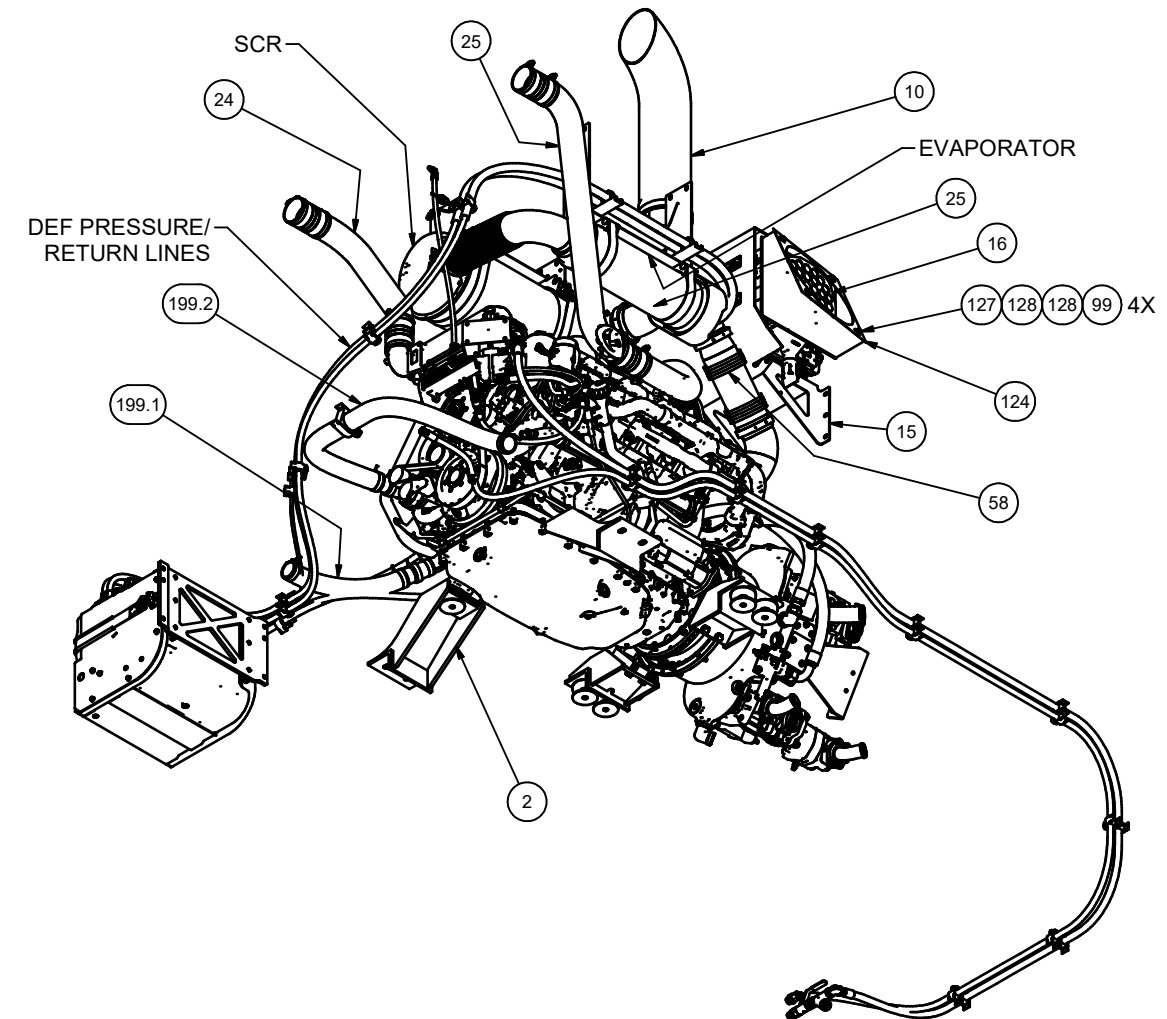
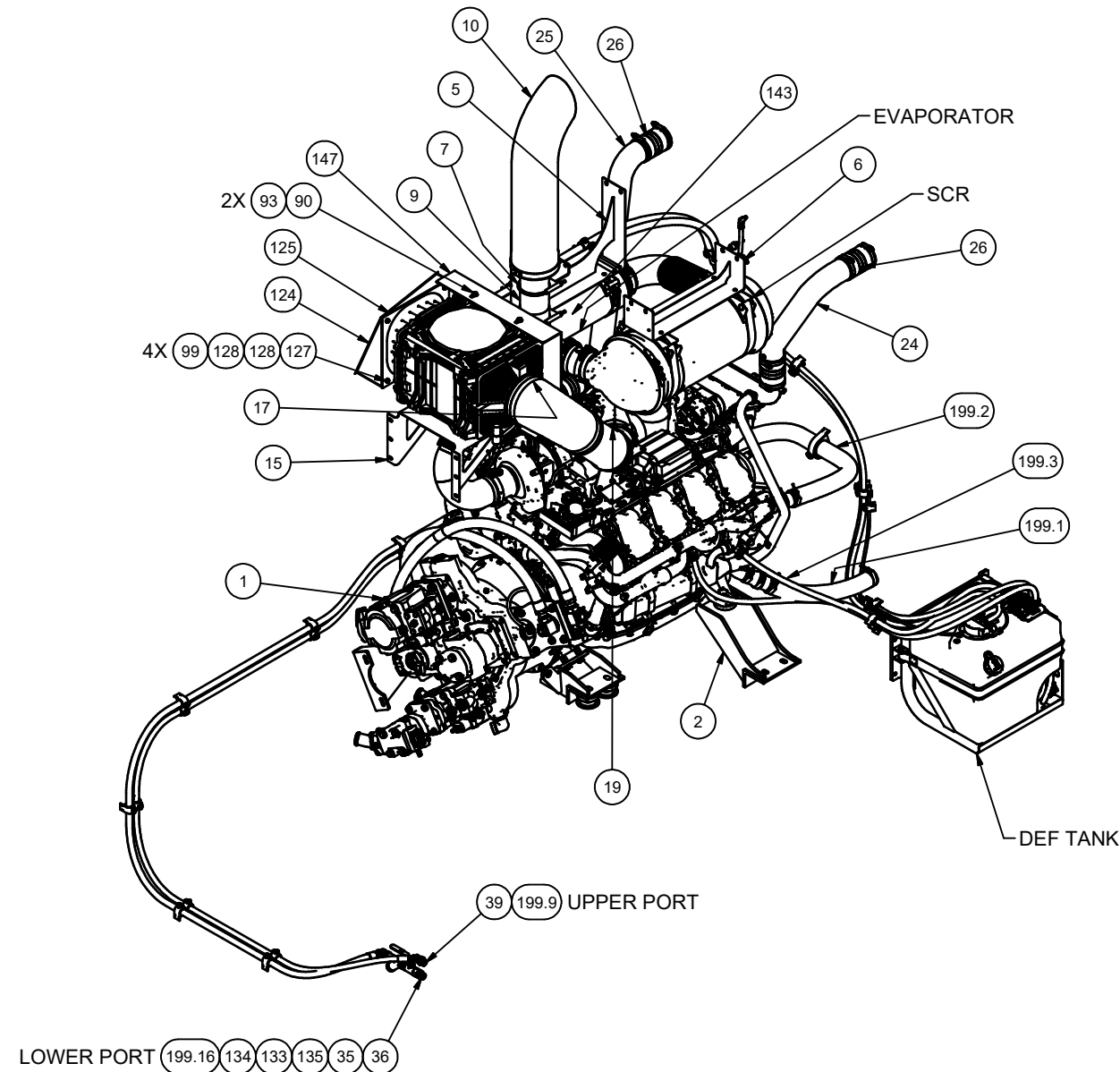

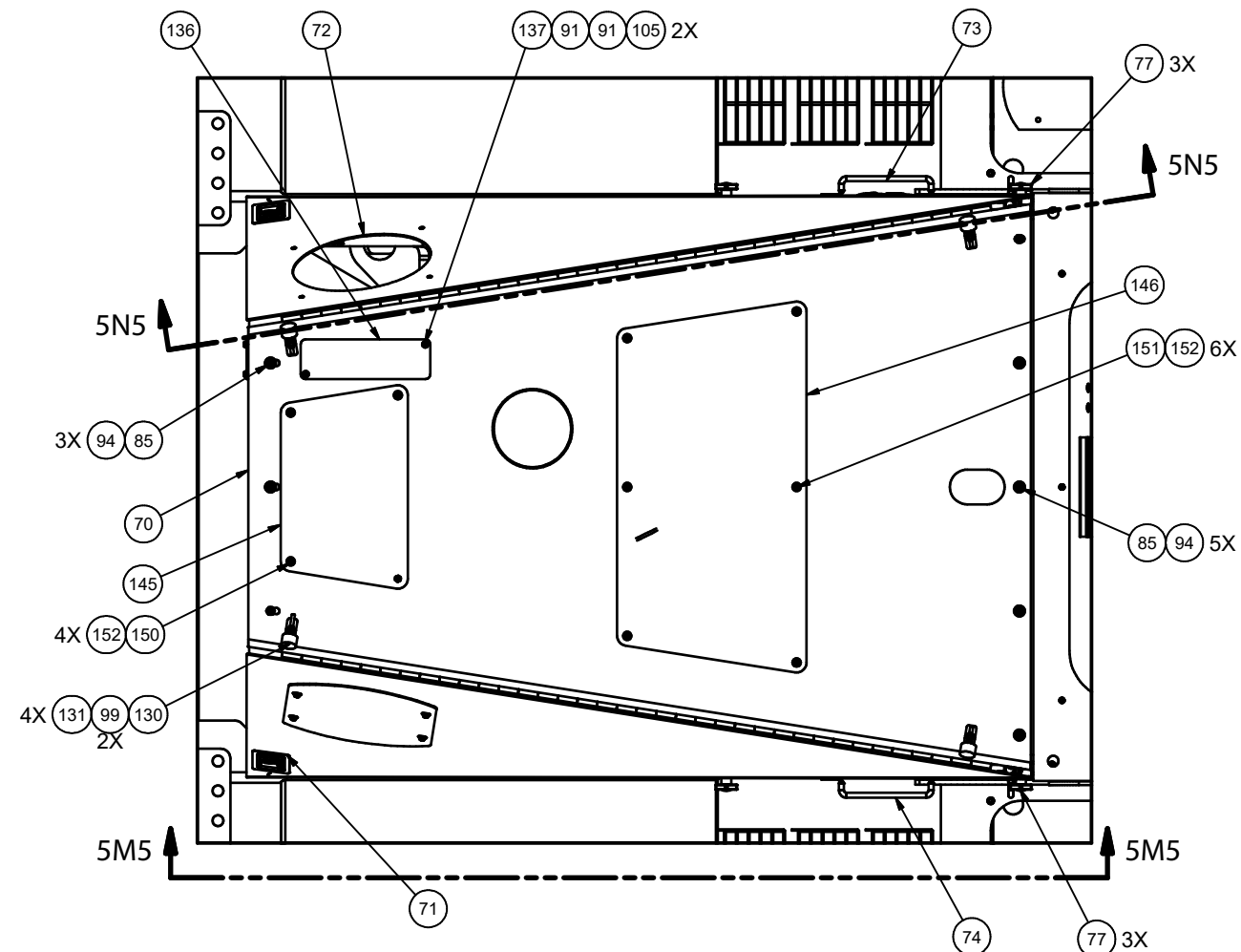

DETAIL 5L1
HOOD/PANEL INSTL

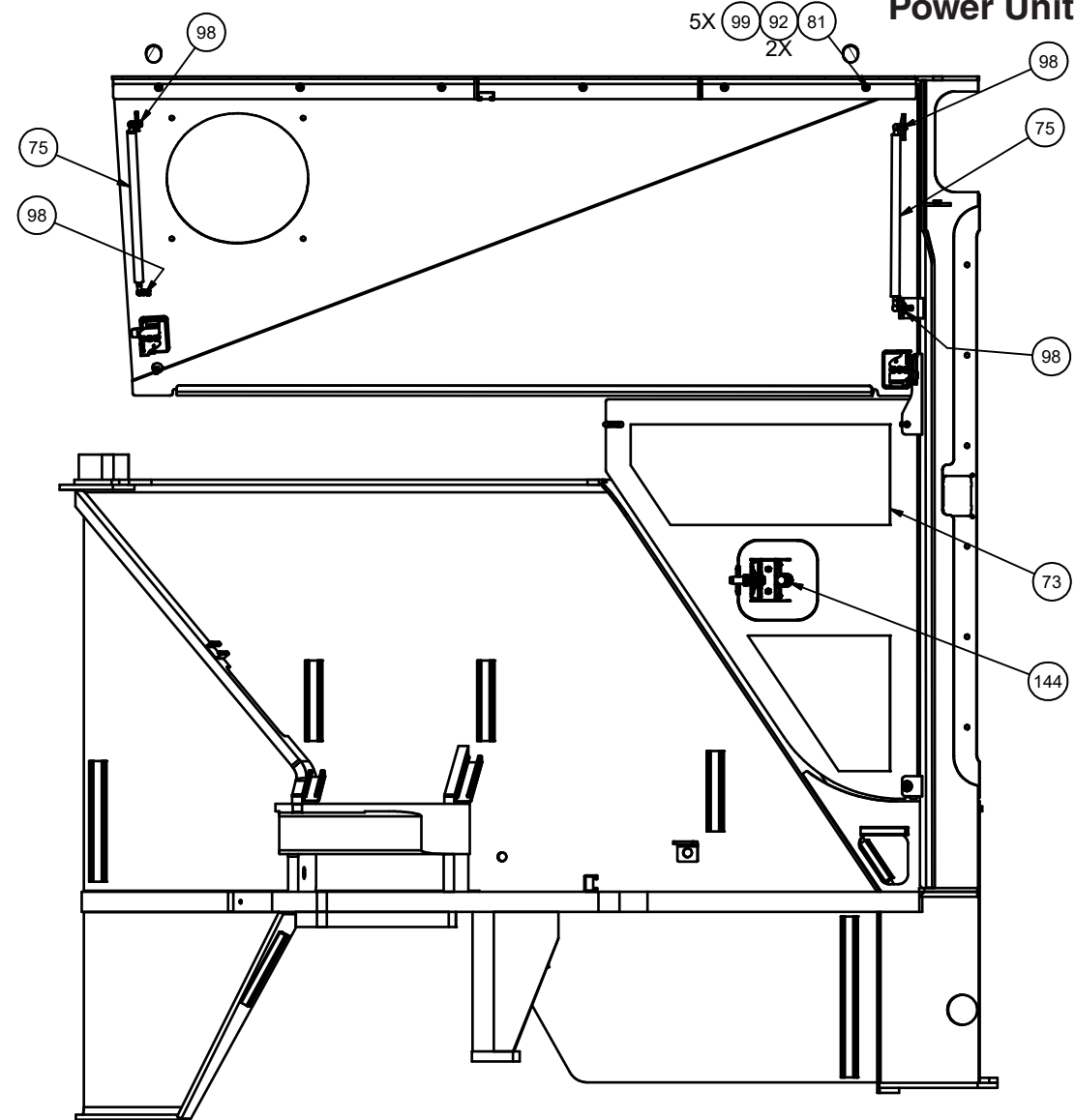

SECTION 5N5-5N5
TYP BOTH SIDES

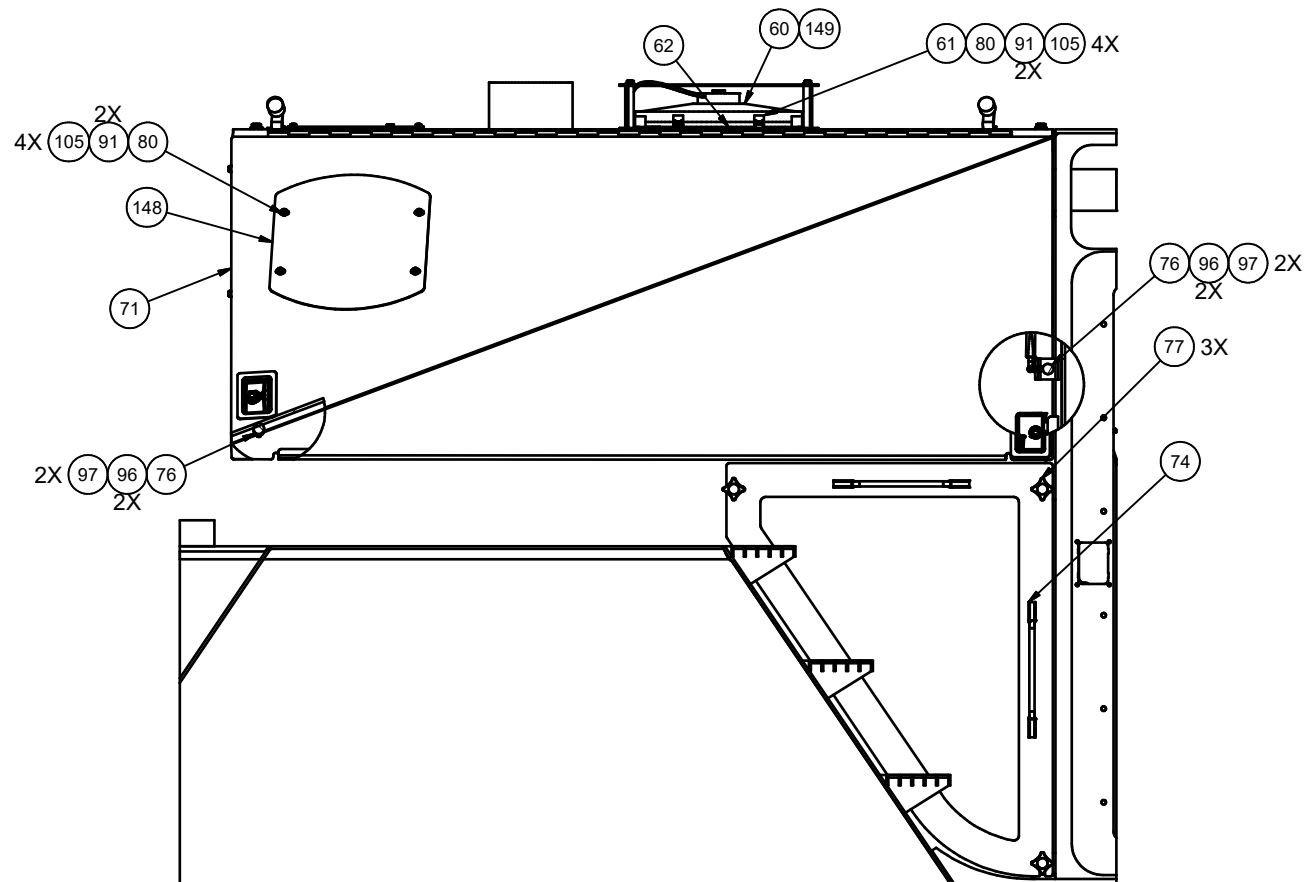

VIEW 5M5-5M5

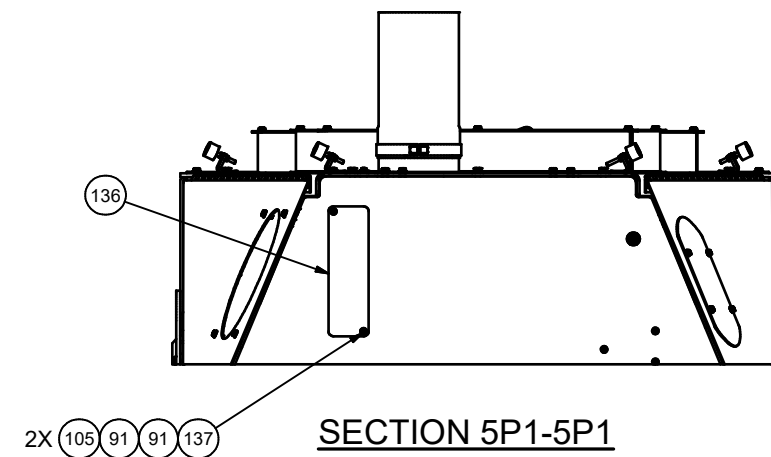

SECTION 5P1-5P1