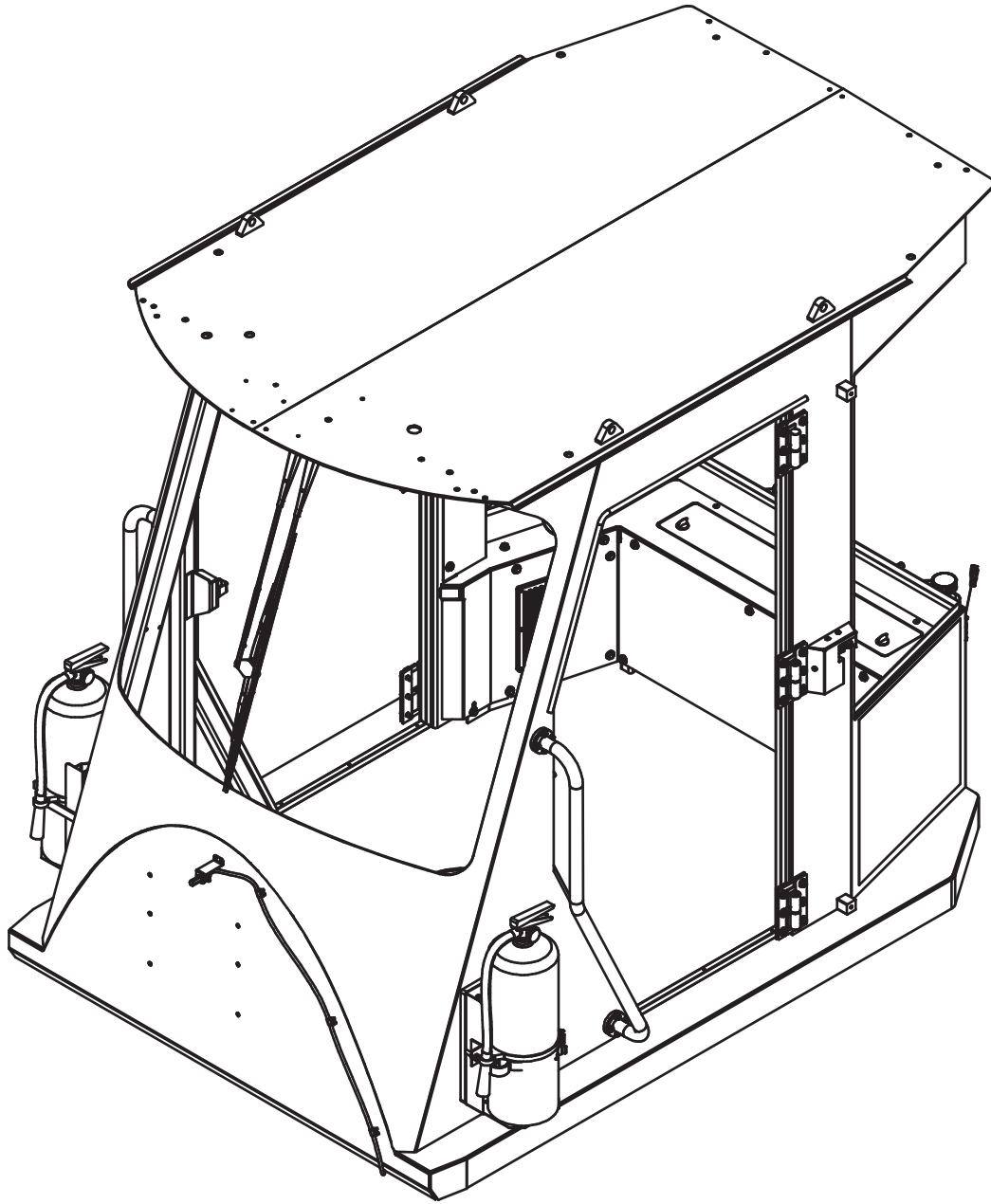

Cab Assembly

Cab Assembly

Item	Part No.	Qty	Description	Item	Part No.	Qty	Description
	599705		Cab Assembly				
1	597860	1	. Cab	92	Y25G-0406	12	. Capscrew
1.1	586994	1	. Grab Bar, LH	94	R13803445	2	. Locknut
1.2	586995	1	. Grab Bar, RH	95	596491	2	. Machine Screw
2	* 596442	1	. Installation, Window	101	224120W	4	. Capscrew
4	590618	1	. Cover Plate	103	R13811034	36	. Capscrew
6	596572	1	. Wire Loom - Cab	105	221767W	54	. Washer
7	258712	2	. Pin, Striker	106	00103340	43	. Washer
8	258713	2	. Guard, Striker	109	201598	43	. Capscrew
9	590619	1	. Cover Plate	119	Y25G-0414	8	. Capscrew
12	587033	2	. Shaft, Stand-Off	126	R13801807	4	. Capscrew
16	259262	4	. Jam Nut	129	* 598508	1	. Installation, Insulation, Cowl Floor
17	259263	8	. Machine Screw	130	* 596486	1	. Installation, Insulation
18	259264	8	. Nut, Esna	131	296418W	4	. Washer
19	296148W	8	. Capscrew	134	R13803026	4	. Clip, Insulated
20	320152W	8	. Washer	135	222761	1	. Sealer
21	587034	2	. Jam Nut	136	594720	1	. Kit, Hose
22	590724	2	. Motor, Wiper	136.1	234245-36	1	. Hose, Bulk
23	258773	1	. Arm Assembly, Wiper	136.2	234245-152	1	. Hose, Bulk
24	258774	2	. Blade Assembly, Wiper	141	242601	30	. Cable Tie
25	258434	4	. Spacer	143	598746	2	. Wire Harness
27	587119	1	. Arm Assembly, Wiper	144	593346	30	. Mount, Blk
31	249776	2	. Nozzle, Jet, Single	145	593629	1	. Stud
35	* 586558	3	. Hinge Assembly, Upper LH	147	593658	1	. Spring, Ext
36	* 586560	3	. Hinge Assembly, LH Door	148	258668	2	. Vent, Louvered
37	586583	12	. Pad, Hinge	149	R13805587	12	. Screw
38	R13810990	16	. Capscrew	151	00103339	2	. Washer
40	2301055W	10 FT	. Trim	152	00103341	4	. Washer
41	258919	2	. Housing, Bearing	153	R13812212	4	. Washer
42	258920	2	. Lever, Clamp	154	596368	2	. Hook, Coat
43	258921	4	. Washer, Thrust	155	246037	1 A/R	. Threadlock
44	258922	2	. Shaft, Flanged	156	R13810989	8	. Capscrew
45	258923	2	. Latch, LH Rotary	157	595326	3	. Mount, Tack
47	258925	1	. Spring, Ext	158	230839	1	. Connector, Cord
48	258926	4	. Clevis	159	212052	2	. Fire Extinguisher
49	258928	1	. Stud	160	212209	2	. Bracket, Mounting
50	586559	2	. Plate, Arm	161	162572W	12	. Capscrew
51	593626	1	. Latch, Holdback	162	597926	1	. Plate, Beauty Panel
52	593340	1	. Plate, RH Holdback Cover	163	597996	1	. Plate, LH Side Cover
53	593628	1	. Plate, LH Cover	164	597997	1	. Plate, RH Side Cover
54	593339	1	. Holdback Latch, RH	165	590235	2	. Plate, Mounting
56	R6515575	2	. Clamp	166	598059	1	. Plate, Mounting Bracket
57	* 598275	2	. Bottle, Washer	167	598058	1	. Plate, Mounting Bracket
58	215774	2	. Mirror, Convex	168	R13812831	6	. Capscrew
59	526939	2	. Bracket	169	Y25G-0410	2	. Capscrew
60	596495	2	. Machine Screw	170	587608	1	. Decal, Trans Operation
66	597922	1	. Plate, Panel Rear	171	557341	1	. Decal, Warning
67	596468	1	. Plate, Panel Rear - RH	172	592855	1	. Decal, Wheel Nuts
68	596467	1	. Plate, Panel Rear - LH	173	504204	1	. Decal, Caution Do Not Reverse
69	590698	1	. Panel, Front	174	587028	1	. Nameplate, Load Capacity
72	597904	1	. Cover, Storage Comp	175	1321665W	1	. Decal, Warning
73	258860	2	. Cam Latch Assembly	176	223061	1	. Decal, Warning Voltage
90	R13811189	8	. Locknut	177	586693	1	. Nameplate
91	221763W	42	. Washer	178	593905	2	. Decal, Logger W/Log

* See Separate Coverage

Cab Assembly



NOTES:

- 1.
2. ITEM 73 (CAM LATCH ARM) MAY HAVE TO BE SHORTENED SLIGHTLY FOR CLEAR SWEEP.
3. (OPTIONAL TRAINING SEAT) CAN BE INSTALLED ON EITHER THE LH OR RH SIDE OF THE CAB IN THE SAME MANNER.
4. WIPER BLADE IS OFFSET, POSITION LONG END UP TO PREVENT BOTTOM FROM TRAVELING OFF THE BOTTOM OF THE FRONT WINDOW.
5. DOOR CLEARANCE SHOULD BE UNIFORM ALL THE WAY AROUND; APPROXIMATE CLEARANCE IS 0.13". INSTALL LOWER 2 HINGES AND POSITION DOOR WITHIN OPENING AS NOTED. INSTALL TOP HINGE TO LOCK DOOR ASSEMBLY ONTO CAB. APPLY NEVER SEIZE AND TORQUE TO 27 FT-LBS MAX.
6. USE ITEM 21 (NUT) TO SECURE ITEMS 43 (WASHER) & 44 (SHAFT) IN ITEM 41 (HOUSING). ITEM 43 (WASHER) HAS A GREY SIDE, AND A SILVER SIDE. THE GREY SIDE IS THE THRUST FACE, AND SHOULD BE AGAINST THE SURFACE OF ITEM 41 (HOUSING) ON BOTH SIDES OF ITEM 41 (HOUSING). DO NOT OVERTIGHTEN. SHAFT SHOULD ROTATE WITH SLIGHT RESISTANCE TO MOTION. TIGHTEN ITEM 12 (SHAFT) AGAINST ITEM 21 (NUT). APPLY BLUE 242 LOC-TITE TO ITEMS 12 & 44
7. ITEM 42 (LEVER) CAN BE INSTALLED AFTER ITEMS 4 & 9 (RH & LH COVERS) HAVE BEEN INSTALLED.
- 8.
9. IF ADJUSTMENT REQUIRED, USE FENDER WASHERS TO ADJUST SO THAT THE CUSHION IS SLIGHTLY COMPRESSED 1/8" - 1/4" WITH THE DOOR IN THE LOCKED BACK POSITION.
- 10.
11. ANTENNA OF ITEM 138 MOUNTS TO TOP OF CAB. ROUTE CABLE THROUGH VINYL CLAMP, THROUGH HOLE IN CAB ROOF, THROUGH HOLE IN CAB FRONT, DOWN LEFT SIDE CABLE CHANNEL. WHEN ROUTING CABLE ALLOW TO DROOP SLIGHTLY BELOW CAB ENTERANCE TO REVENT WATER FROM FOLLOWING WIRES INTO CAB.
- 12.
13. BLACK HARDWARE USED IN SOME LOCATIONS IN AN ATTEMPT TO MAKE ALL VISIBLE HARDWARE INSIDE OF CAB BLACK.
14. ** APPLY ITEM 135 TO ALL OPENINGS AND GAPS ASSOCIATED WITH GROMMETS AND OTHER PASS THROUGHS INTO THE CAB THROUGH THE ROOF & CAB SIDES.
15. ITEM NOT SHOWN: ITEM 2, ITEM 6, ITEM 129, ITEM 130, ITEM 141, ITEM 144.

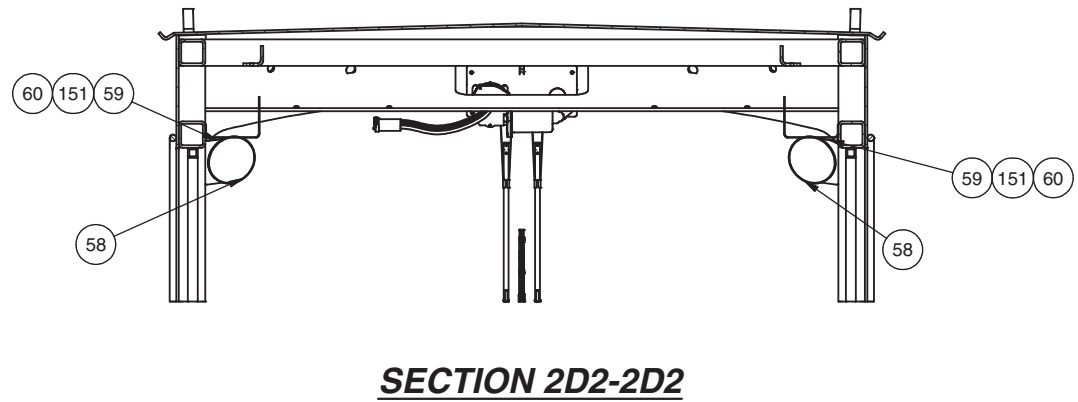
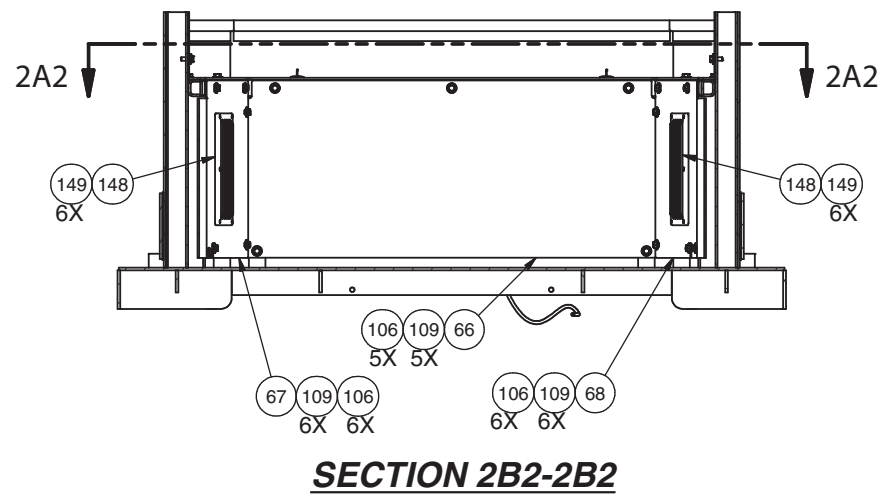
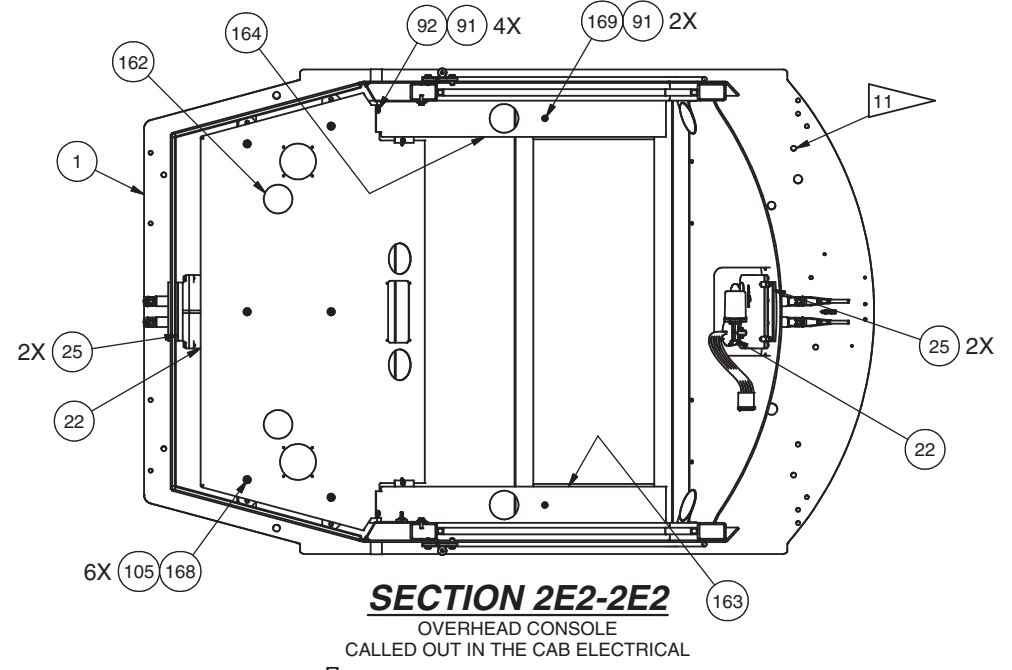
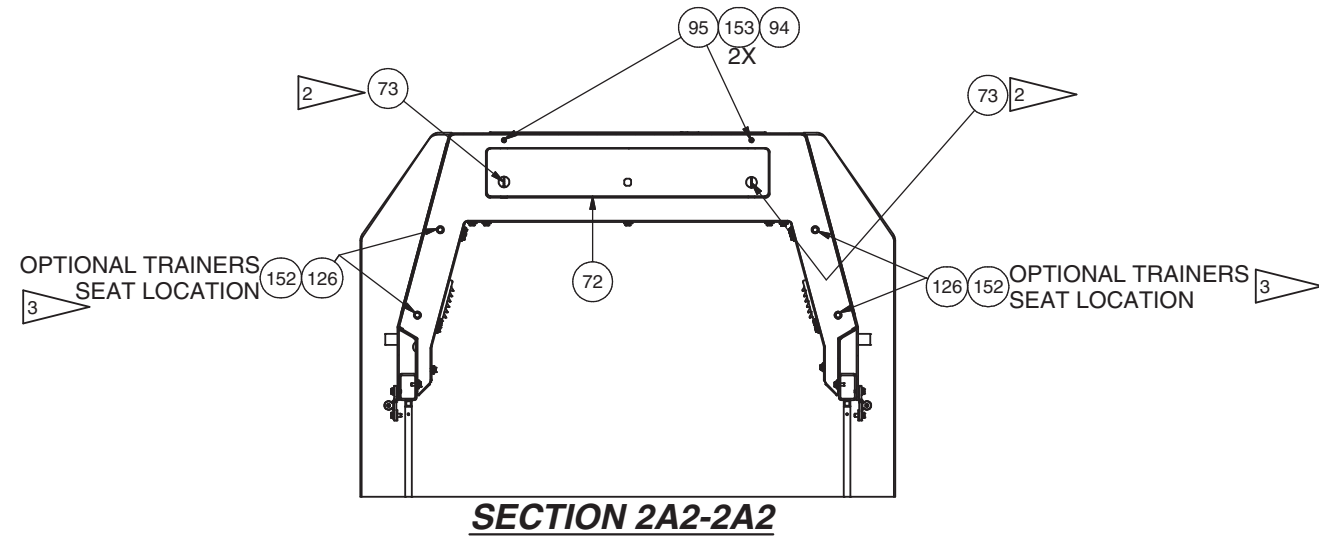
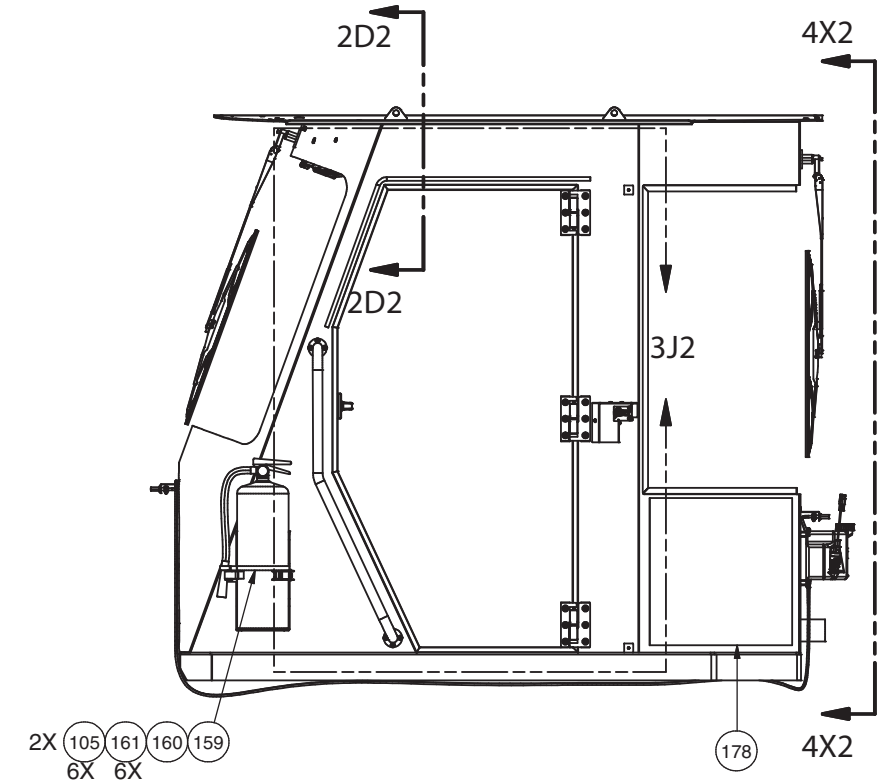
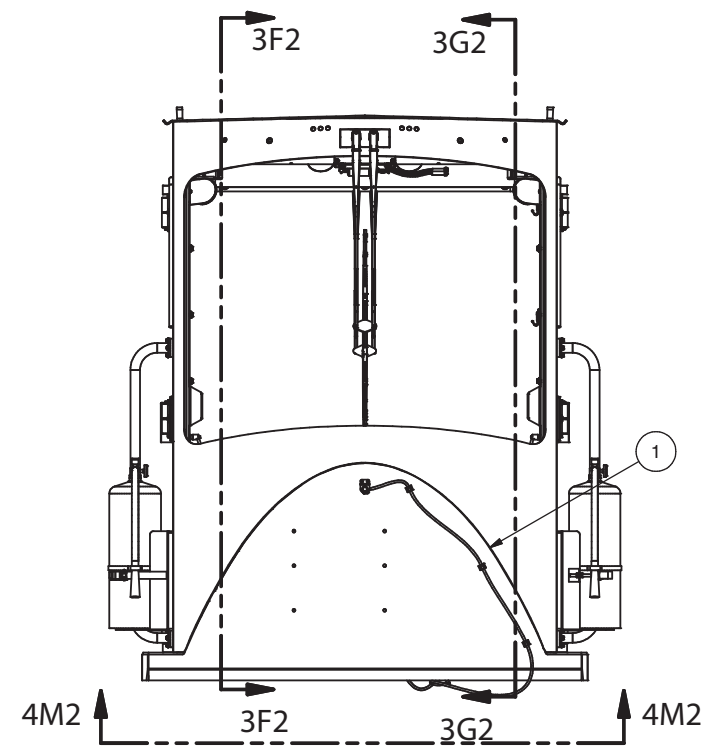
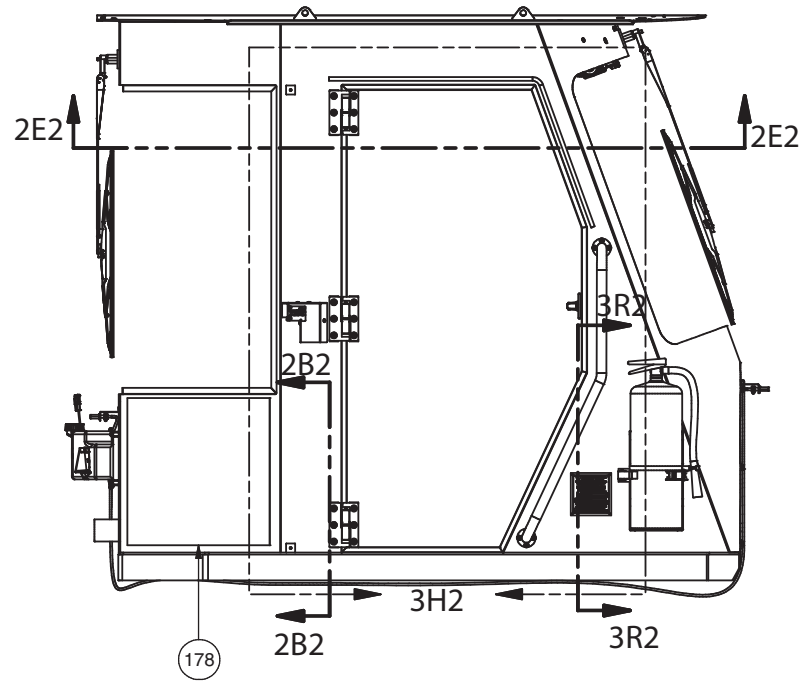

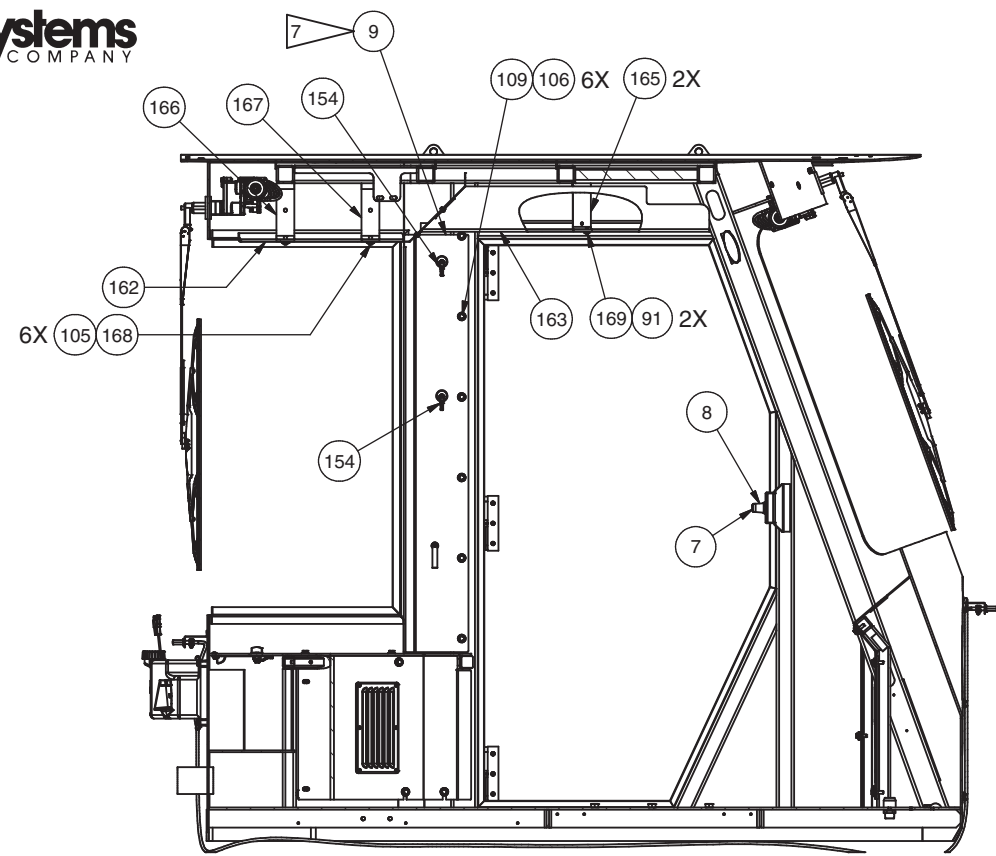

SECTION 3F2-3F2
REMOTE MONITOR
CALLED OUT ON CAB ELECTRICAL

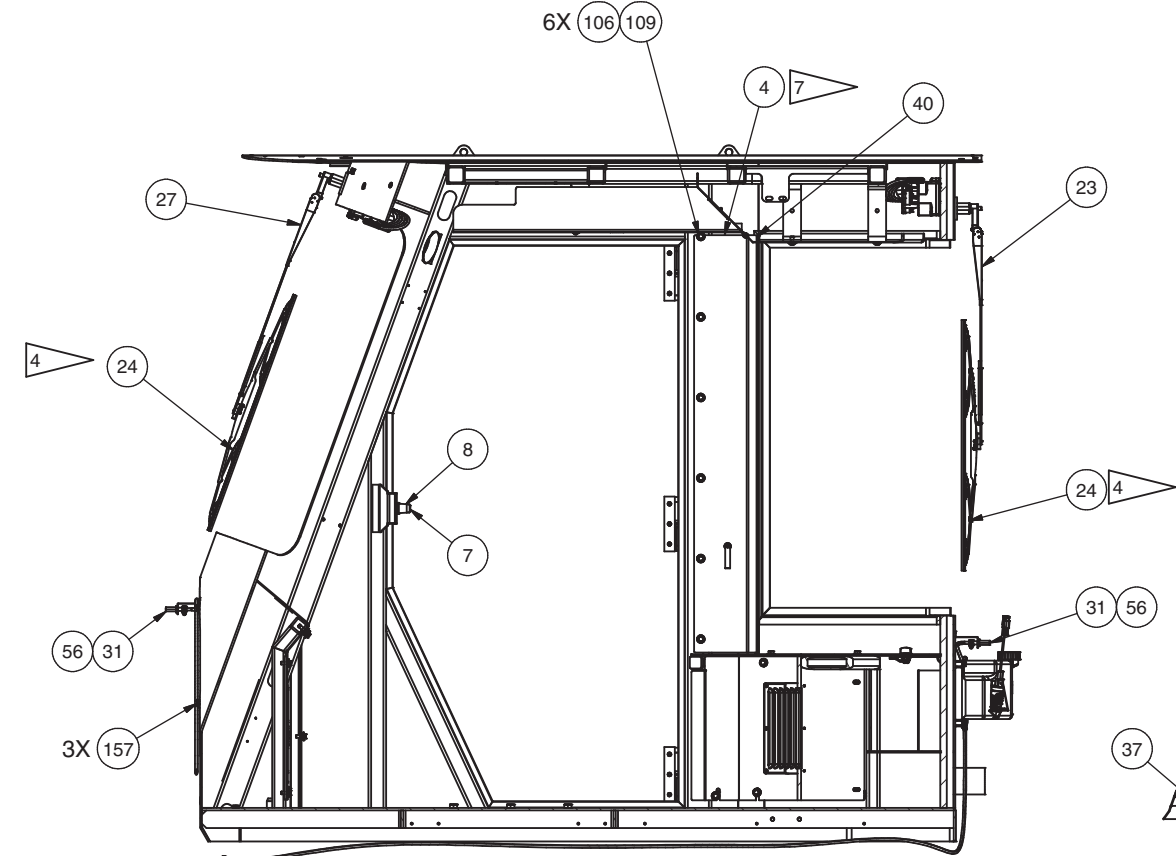

SECTION 3G2-3G2

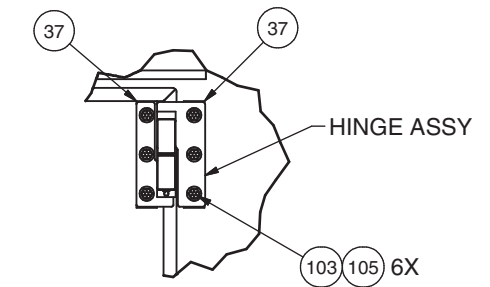

DETAIL 3K3
6 PLCS

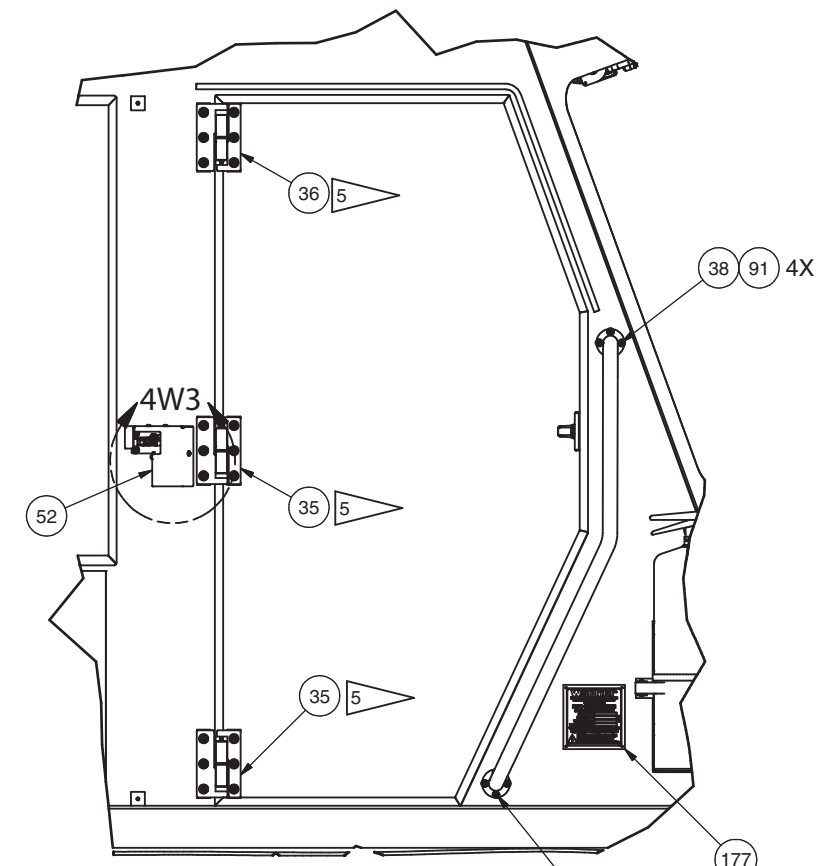

DETAIL 3H2
RH-DOORWAY

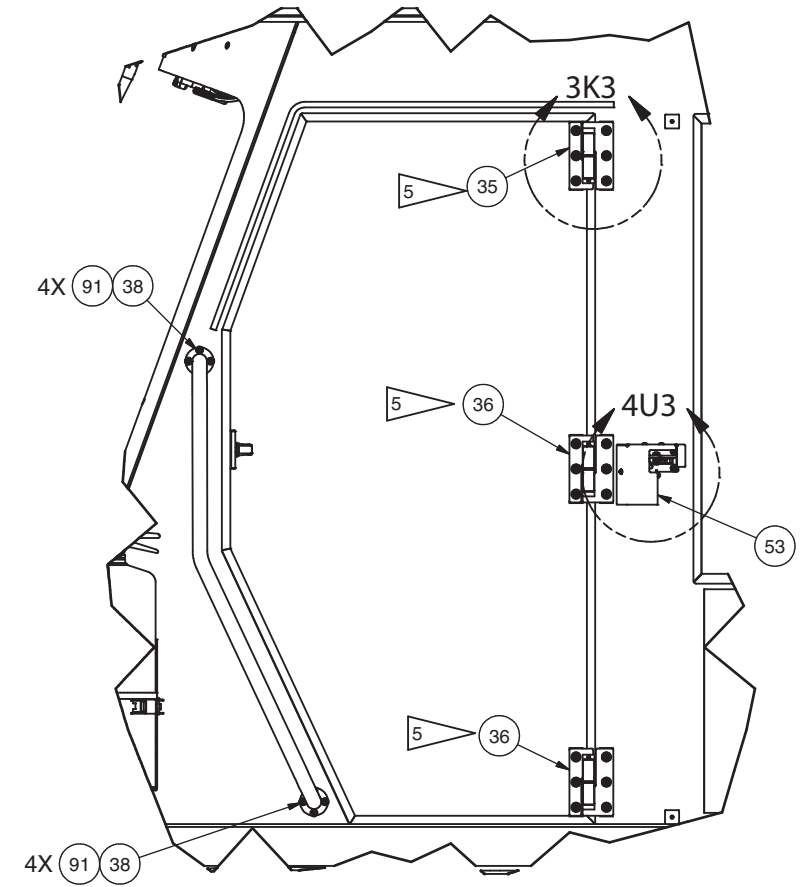

DETAIL 3J2
LH-DOORWAY

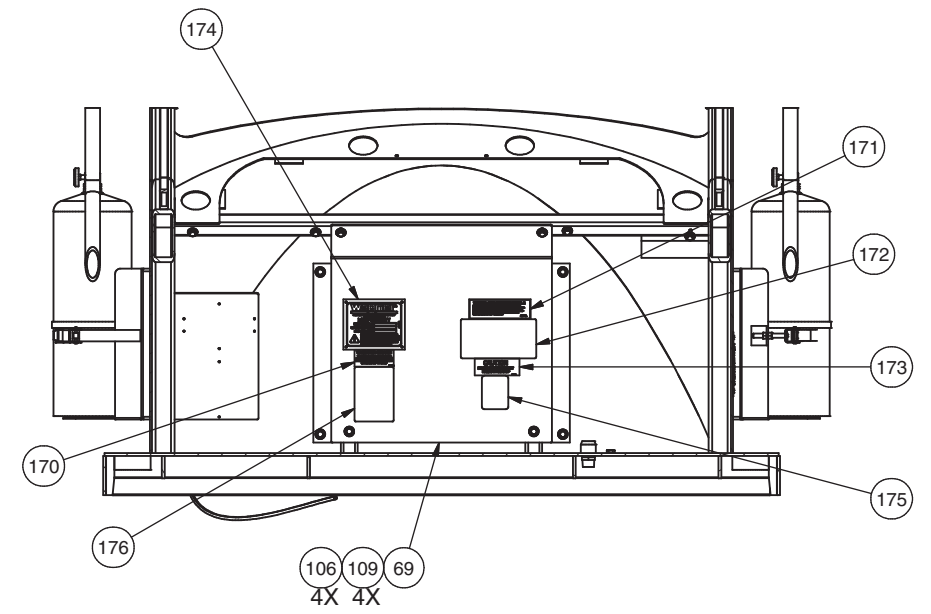

SECTION 3R2-3R2
CIRCUIT BREAKER PANEL
CALLED OUT ON CAB ELECTRICAL

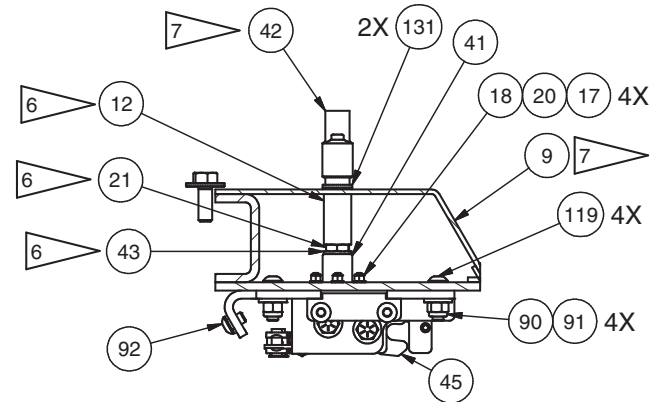

SECTION 4T4-4T4

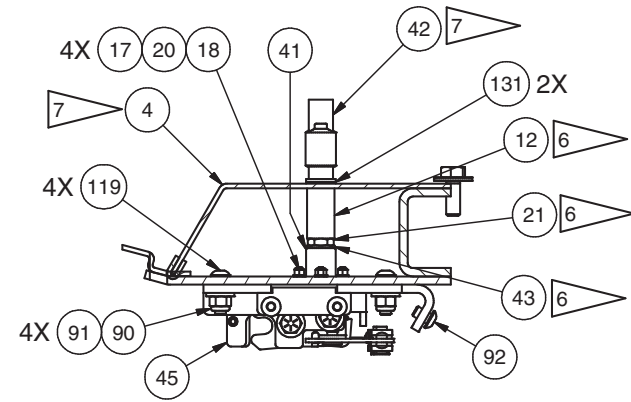

SECTION 4V4-4V4

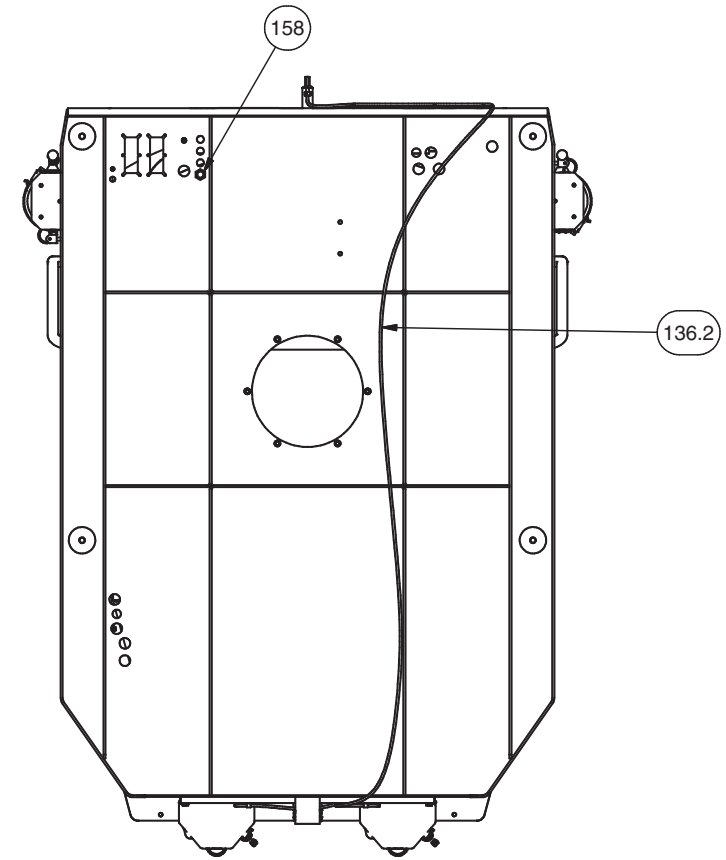

VIEW 4M2-4M2

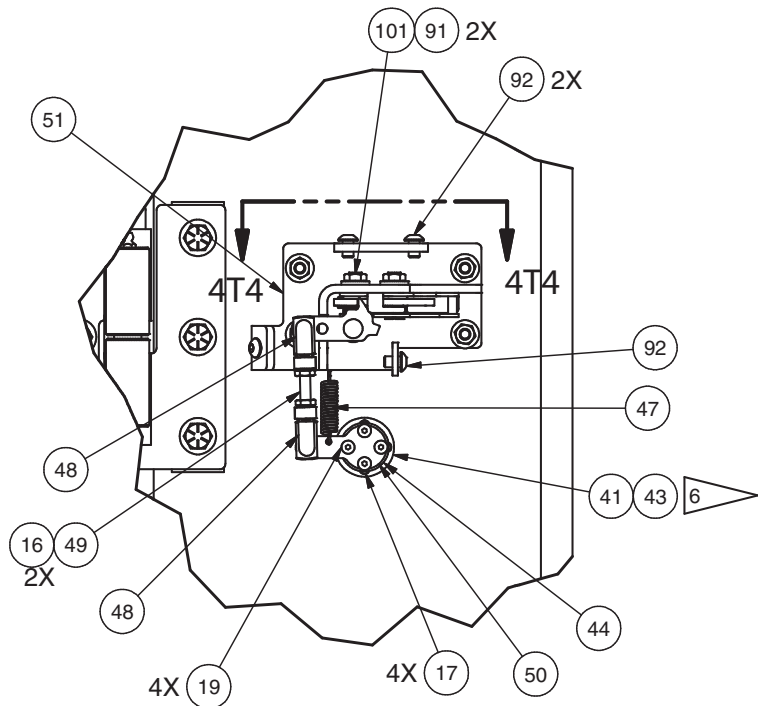

DETAIL 4U3
LH SIDE

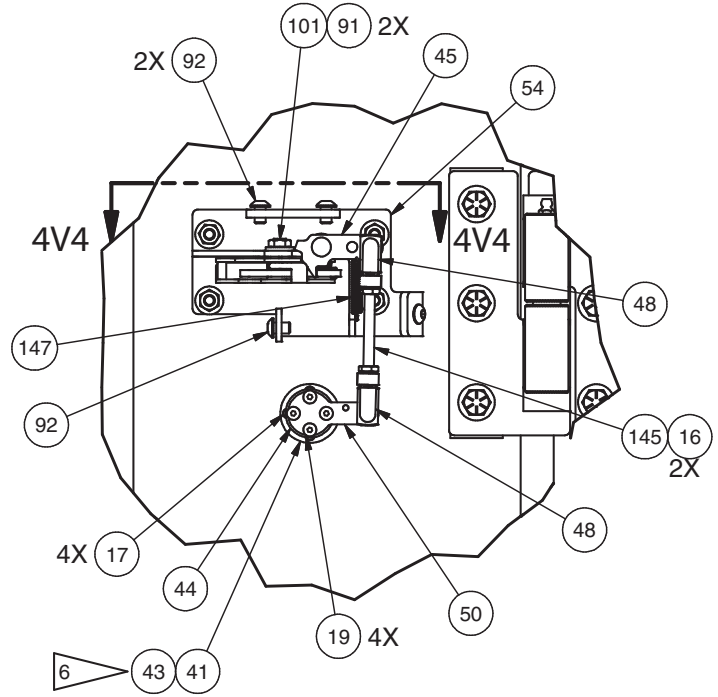

DETAIL 4W3
RH SIDE

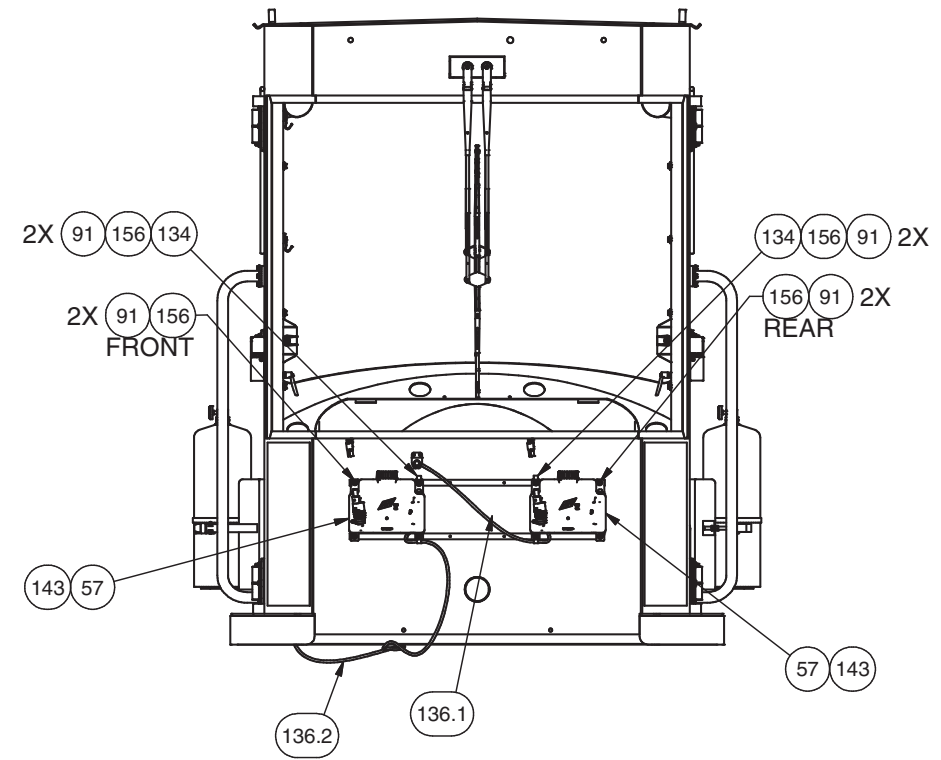

VIEW 4X2-4X2