

Power Unit Assembly

Power Unit Assembly

Item	Part No.	Qty	Description	Item	Part No.	Qty	Description
	598964		Power Unit Assembly				
1	* 596989	1	. Engine	61	180959W	12	. Capscrew
2	* 600046	1	. Converter	62	598183	2	. Check Valve
3	* 257099	1	. Kit, Flexplate	63	598184	2	. Plate, Check Valve Seal
4	597830	2	. Pump, Var Piston	64	598185	2	. Plate, Check Valve Insert
5	597831	1	. Pump, Var Piston	65	225328	4	. Clamp Half
6	597833	1	. Pump, Gear	66	203446	4	. O-Ring
7	597832	1	. Pump, Gear Tandem	67	221771W	35	. Washer
8	257167	8	. Capscrew	68	R13811084	8	. Capscrew
9	591769	1	. Compressor, A/C	69	245921	1	. Spacer, O-Ring
10	Y09C-M08100	4	. Capscrew	70	209536	2	. Clamp Half
11	R13811432	20	. Washer	71	209512	2	. Fitting
12	580504	2	. Engine Mount, Rear	72	R13811060	4	. Capscrew
13	234497	2	. Vibration Dampener	73	252712	1	. Spacer, O-Ring
14	578361	4	. Washer	74	203519	2	. O-Ring
15	Y17C-1272	2	. Capscrew	75	209538	2	. Clamp Half
16	R13811196	2	. Locknut	76	R13801850	4	. Capscrew
17	221777W	16	. Washer	77	505499	3	. Gasket
18	Y17C-1028	10	. Capscrew	78	221569W	6	. Capscrew
19	234271	10	. Washer	79	245757	6	. Stud
20	598060	1	. Engine Mount, Front	80	221711W	6	. Hex Nut
23	293645W	1	. Capscrew	81	Y17C-1232	12	. Capscrew
24	* 228640	1	. Regulator, Converter Bypass	82	252864	4	. Capscrew
25	598119	1	. Plate, Mount	83	302402W	4	. Locknut
26	224069	2	. Fitting	84	R13801834	12	. Capscrew
27	248819	2	. Fitting	85	598213	3	. Gasket, Pump
28	R233598	1	. Breather, 1-Way	86	598120	1	. Plate, Mount
29	222155	1	. Fitting	87	247072	3	. Fitting
30	R13808111	1	. Clip, Insulated	88	237008	2	. Shutoff Valve
31	587673	1	. Coupler, Diagnostic	89	209506	2	. Fitting
32	598180	2	. Fitting	91	236805	8	. Capscrew
33	598855	1	. Fitting	97	228924	1	. Terminal, Ring
34	598182	1	. Fitting	100	228922	1	. Terminal, Ring
35	R833251	3	. Fitting	101	596102	8.4 FT	. Cable, Welding
36	234192	1	. Fitting	102	R13808094	8	. Clip, Insulated
37	R833133	1	. Fitting	105	296420W	8	. Washer
38	598034	1	. Fitting	110	598153	3	. Transducer
41	598122	2	. Fitting	112	598178	2	. Fitting
42	243591	1	. Fitting	113	598179	2	. Fitting
43	12663	1	. Fitting	114	598181	1	. Fitting
44	211705	2	. Fitting	115	598235	1	. Fitting
45	23390	4	. Kit, Split Flange	116	209511	1	. Fitting
	203523	1	. O-Ring	117	221563W	2	. Capscrew
	209539	2	. Clamp Half	118	221499W	4	. Capscrew
46	R833281	1	. Fitting	119	243553	1	. Fitting
47	598123	1	. Pipe	120	246908	1	. Sensor, Temp
48	594043	1	. Fitting	122	245043	1	. Hose End
49	237329	1	. Fitting	123	599393	1	. Fitting
50	243149	1	. Fitting,	124	209415	1	. Fitting
51	211693	1	. Fitting	125	209572	1	. Fitting
52	598124	2	. Fitting	126	248624	1	. Fitting
53	R14040	8	. Coupler, Male	127	231439	3	. Fitting
54	218815	1	. Fitting	199	598130	1	. Kit, Hose
55	231826	3	. Fitting	199.1	598126	1	. Hose Assembly
57	598125	3	. Manifold, Gauge	199.2	599641	1	. Hose Assembly
58	203443	6	. O-Ring	199.3	598128	1	. Hose Assembly
59	209535	6	. Clamp Half	199.4	598129	1	. Hose Assembly
60	221767W	16	. Washer				

* See Separate Coverage

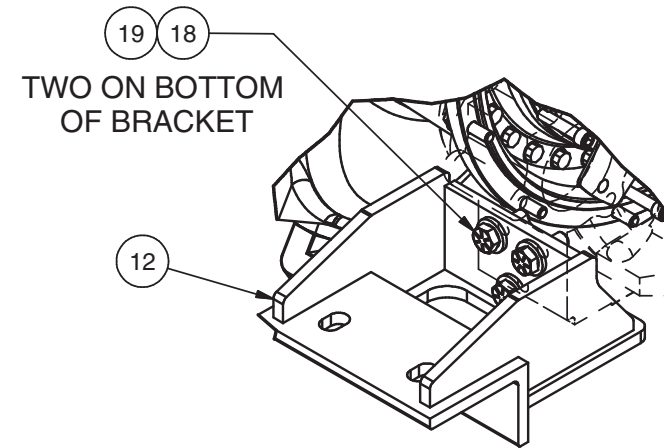
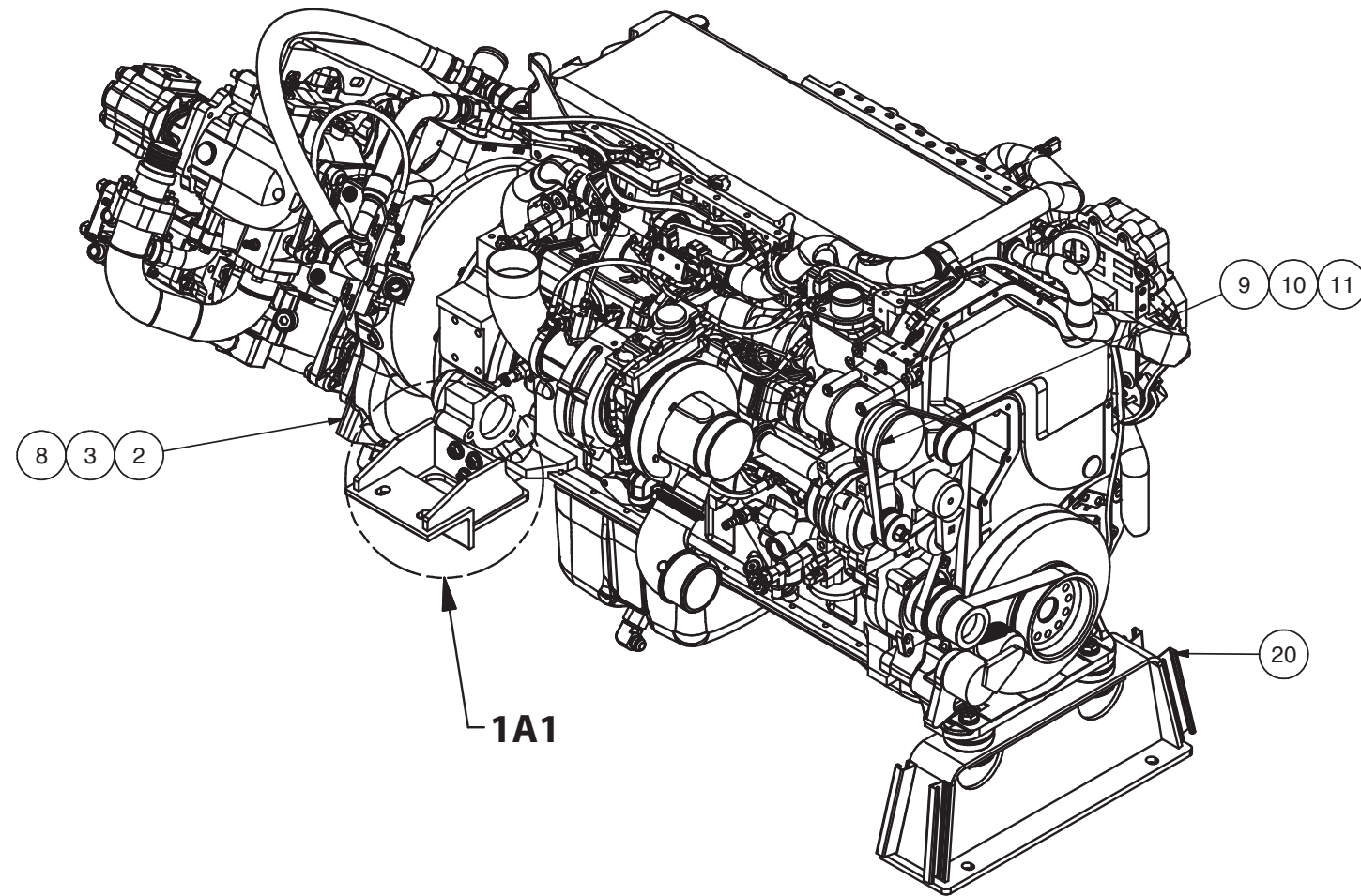

DETAIL 1A1
TYP BOTH SIDES

NOTES:

- 1 ▷ LOOSEN CLAMP AND RE-ORIENTATE TURBO AS DIMENSIONED. SEE DOCS TAB FOR TURBOCHARGER COMPRESSOR HOUSING REORIENTATION PROCEDURE (CEB00200).
- 2 ▷ DIPSTICK LOCATED ON OPPOSITE OF ENGINE AS SUPPLIED BY MFG. RELOCATE TO RH SIDE OF ENGINE AS SHOWN.
- 3 ▷ CHECK VALVE MUST BE INSTALLED IN THE ORIENTATION THAT ALLOWS FLOW OUT OF THE OUTLET PORT OF THE RH AND LH IMPLEMENT PUMPS.
- 4. PLUG ALL HYDRAULIC PORTS THAT ARE OPEN TO THE ENVIRONMENT TO PREVENT CONTAMINATION IN THE HYDRAULIC SYSTEM.
- 5. REMOTE FILTER COMPONENTS WILL BE INSTALLED AT THE POWER UNIT INSTALLATION LEVEL.

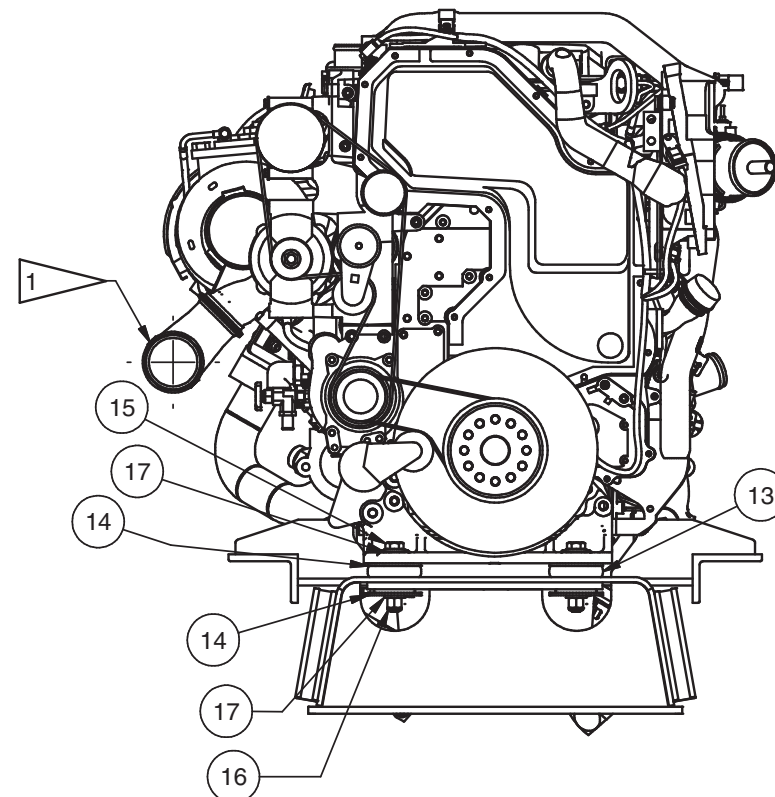

97 FROM ALTERNATOR TO
STARTER & BATTERY
(-) TERMINAL

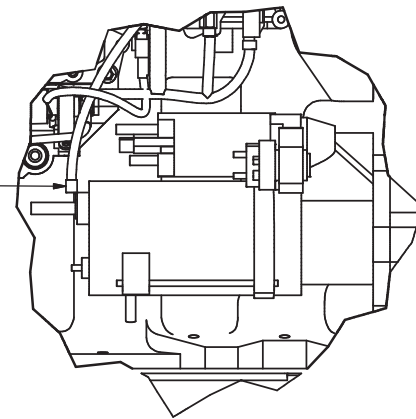

DETAIL 2B2
ALTERNATOR & STARTER (-) LUG

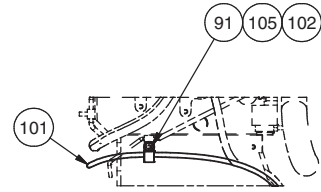

SECTION 2C2-2C2
ITEMS REMOVED FOR CLARITY

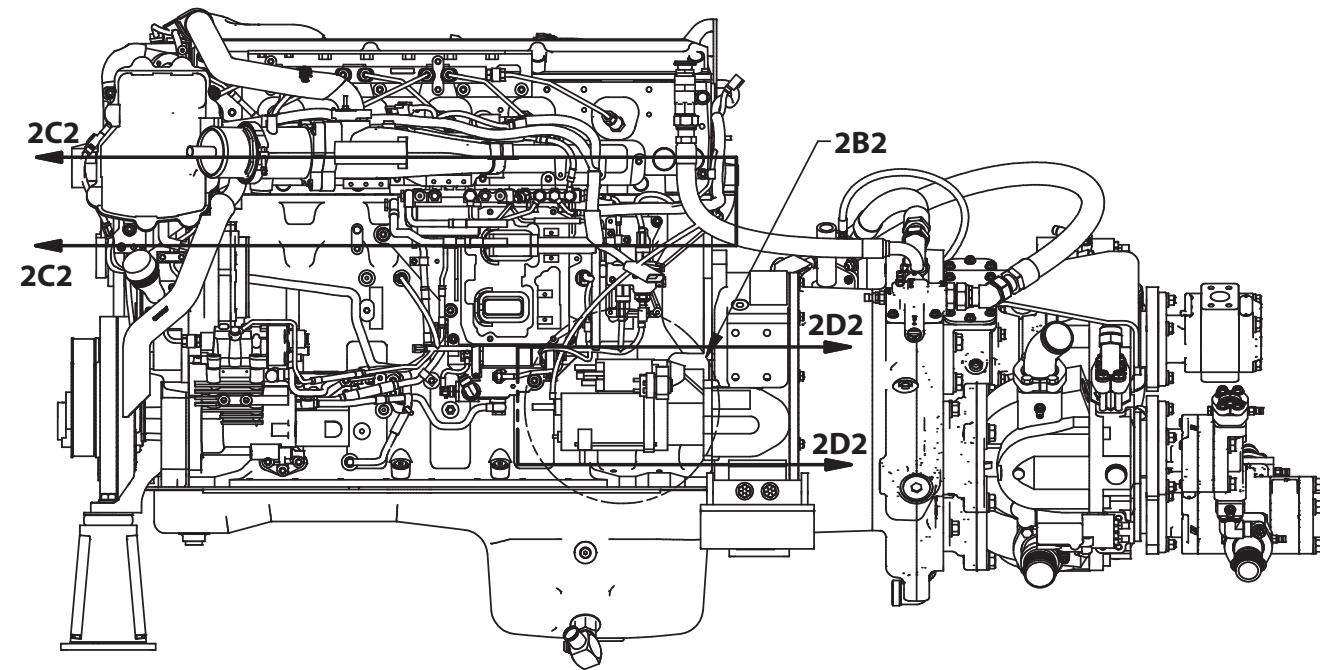

RH SIDE VIEW

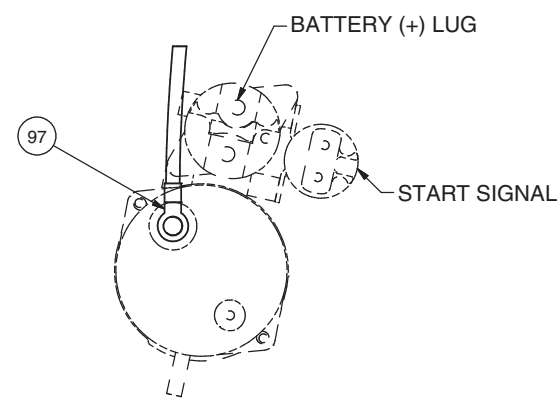

SECTION 2D2-2D2
STARTER WIRING DETAIL
ITEMS REMOVED FOR CLARITY

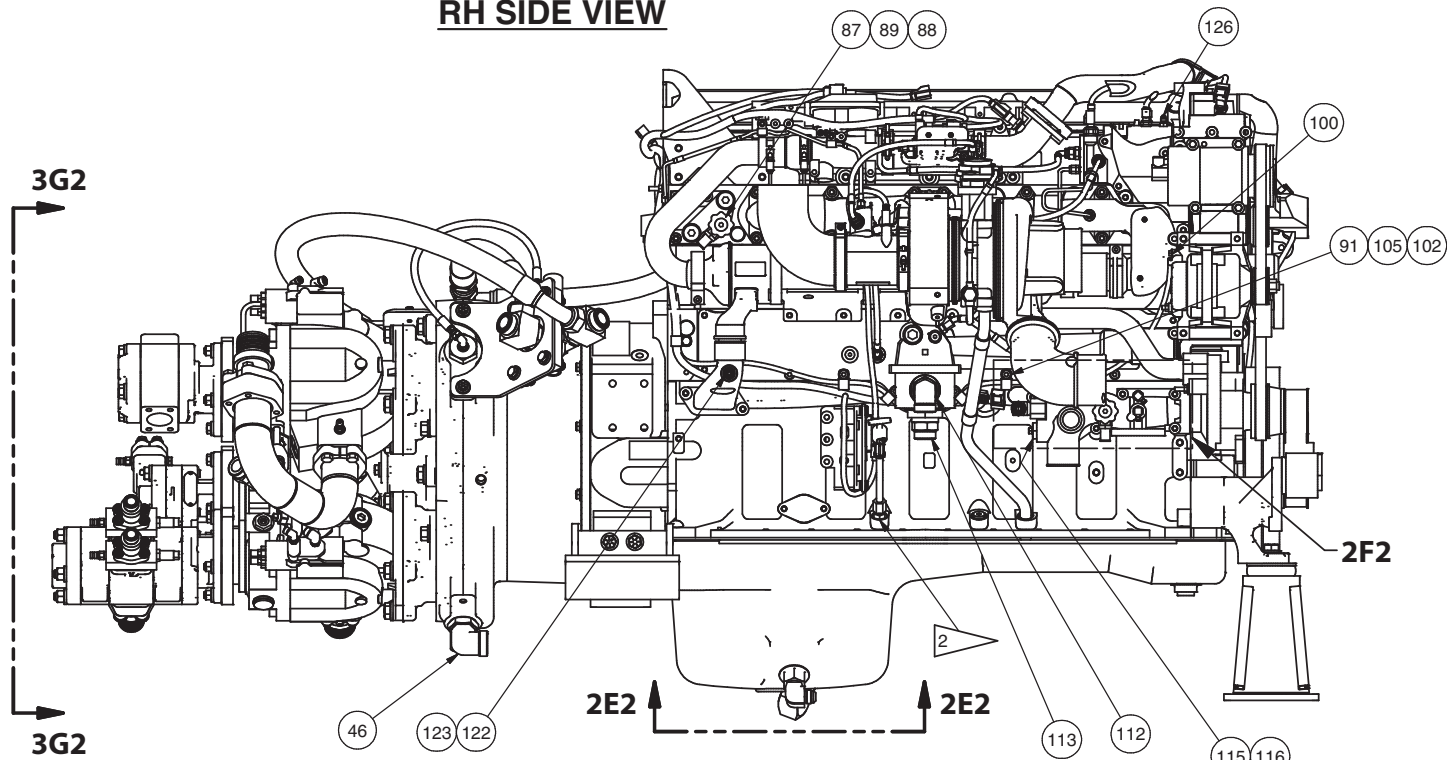

LH SIDE VIEW

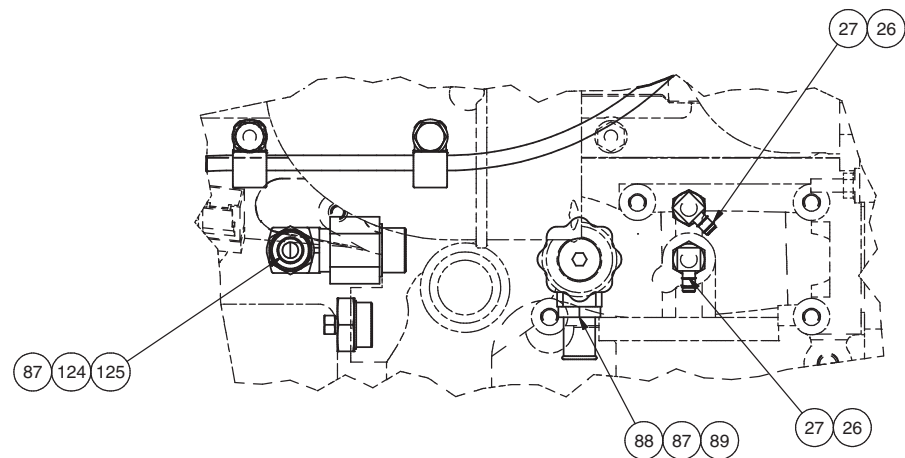

DETAIL 2F2
CAB HEATER COOLANT PORTS

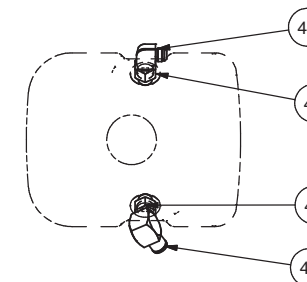

VIEW 2E2-2E2

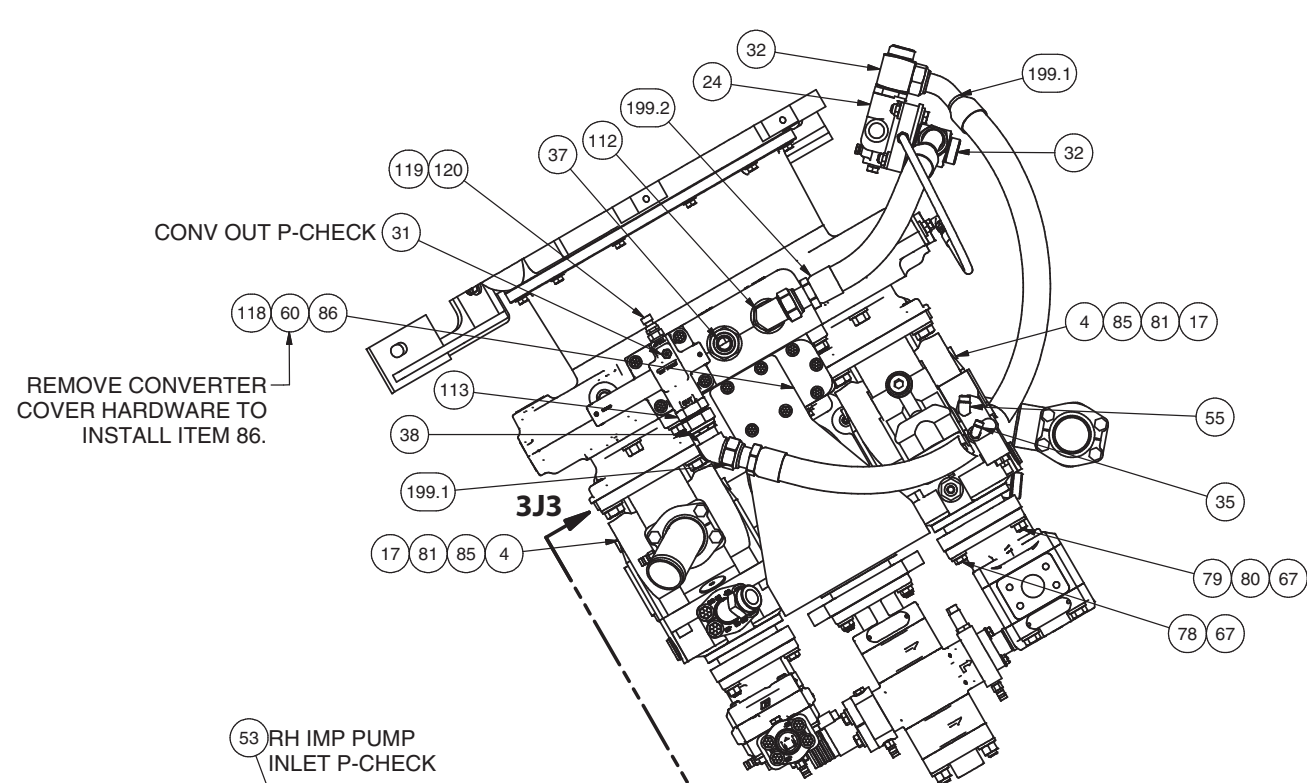

SECTION 3H3-3H3

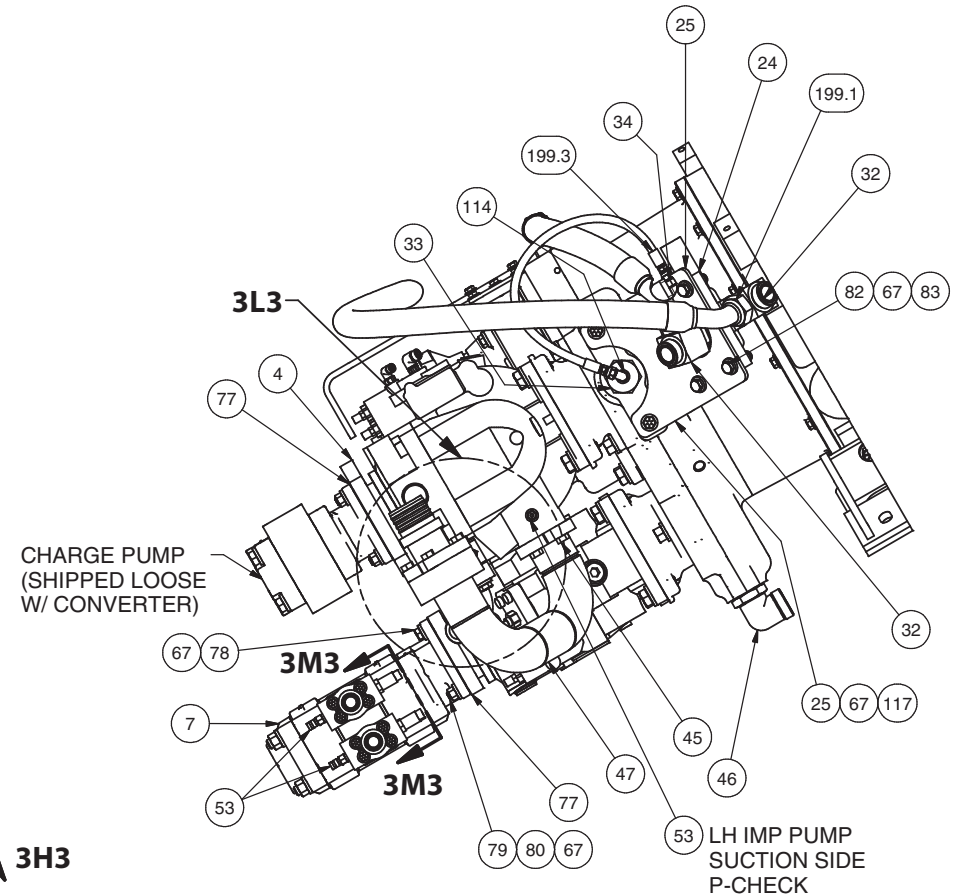

**SECTION 3K3-3K3
RH IMP PUMP FITTING INSTL**

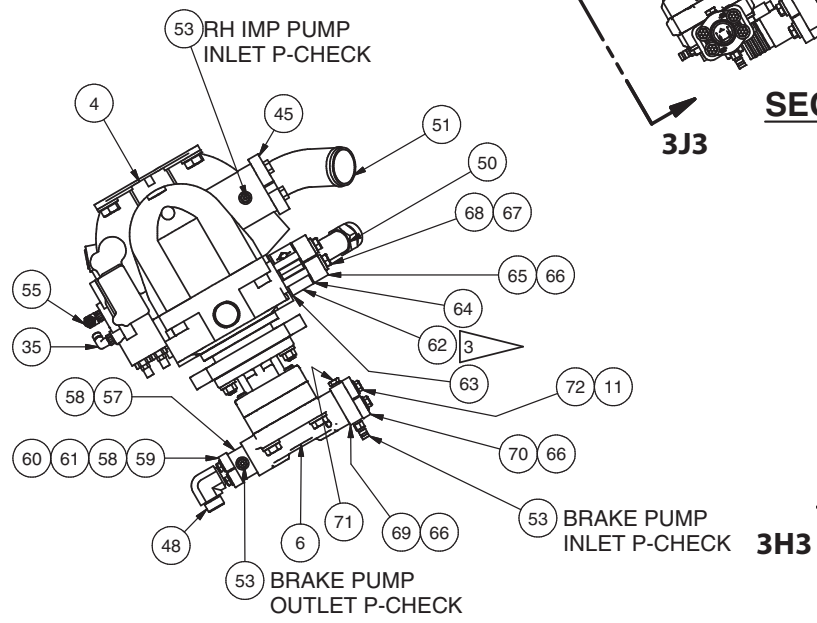

**SECTION 3J3-3J3
RH IMP/BRAKE FITTING INSTL**

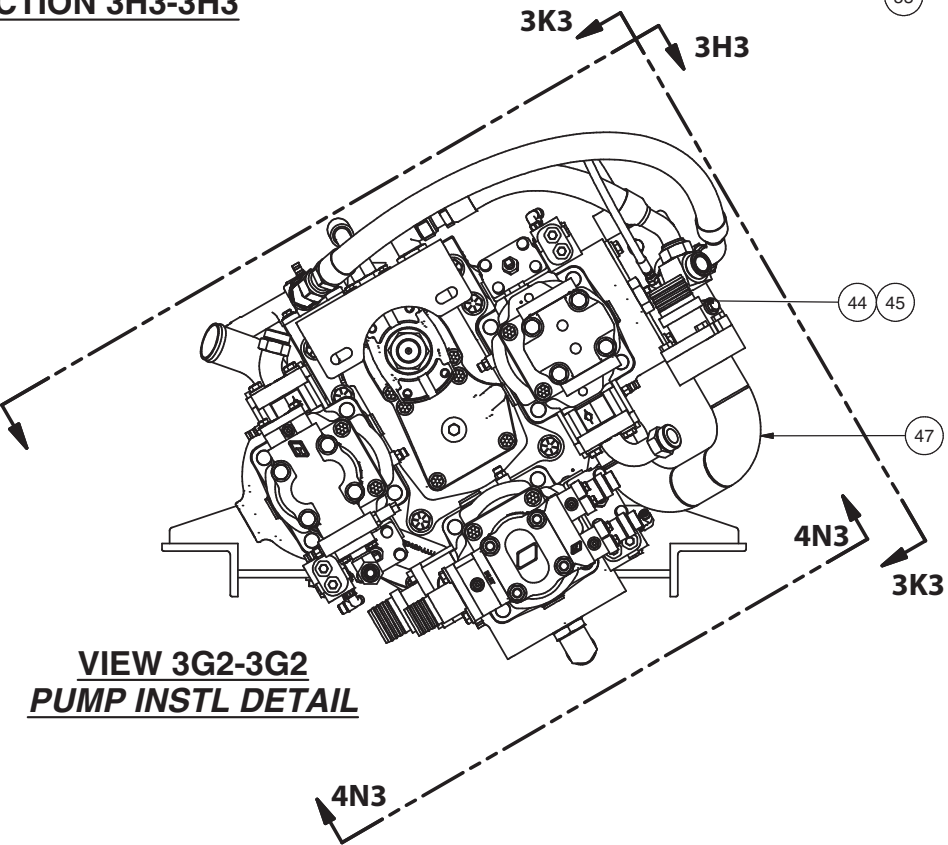

**VIEW 3G2-3G2
PUMP INSTL DETAIL**

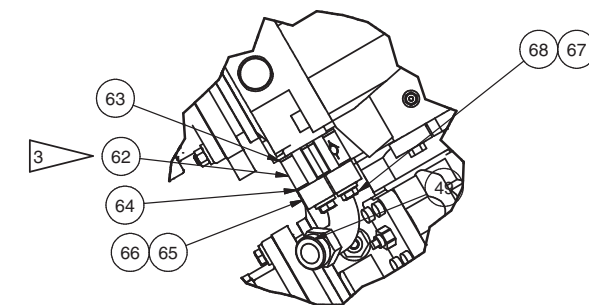

**DETAIL 3L3
ITEMS REMOVED
FOR CLARITY**

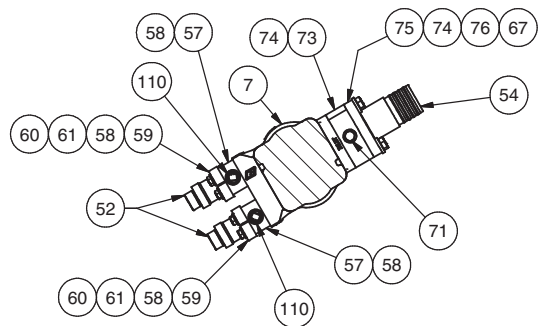

**SECTION 3M3-3M3
FAN PUMP FITTING INSTL**

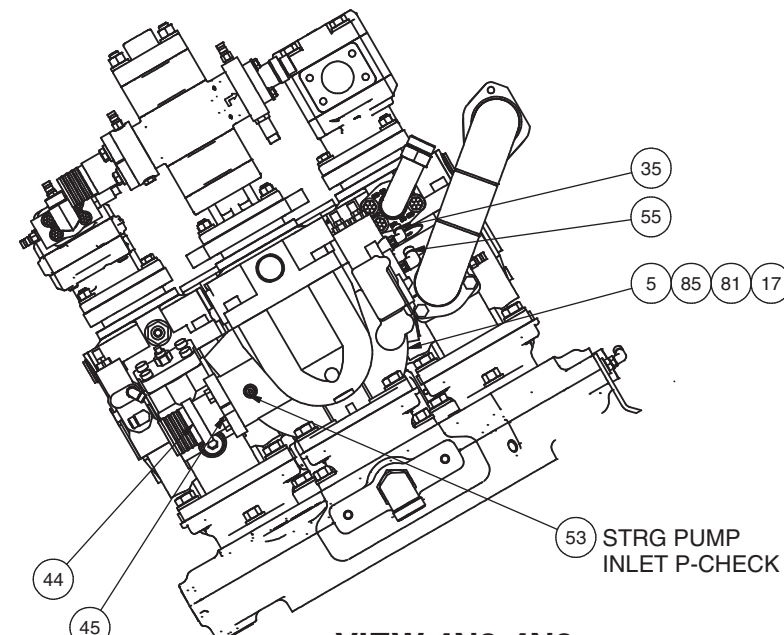
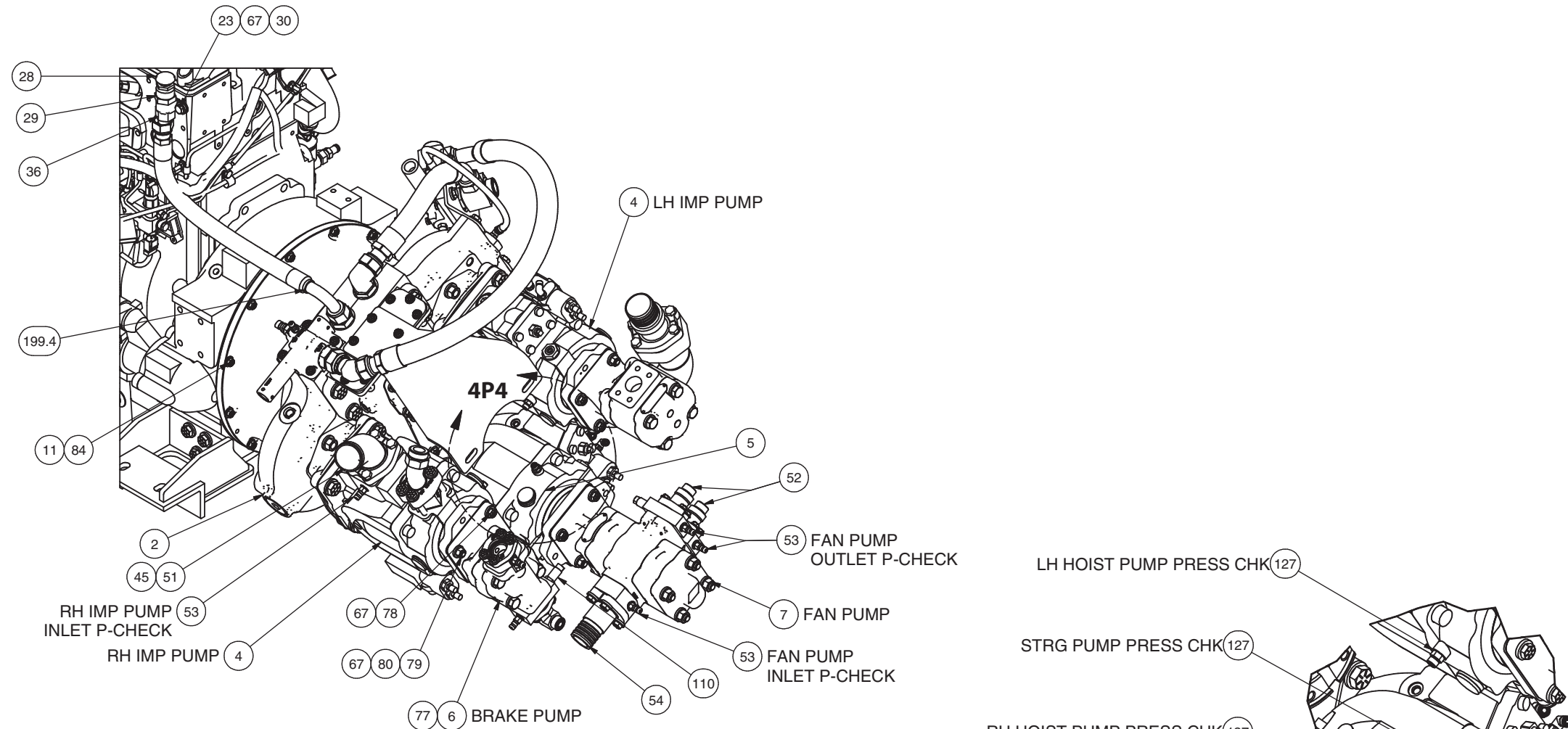

VIEW 4N3-4N3
STRG PUMP FITTING INSTL

DETAIL 4P4
SOME PARTS REMOVED FOR CLARITY