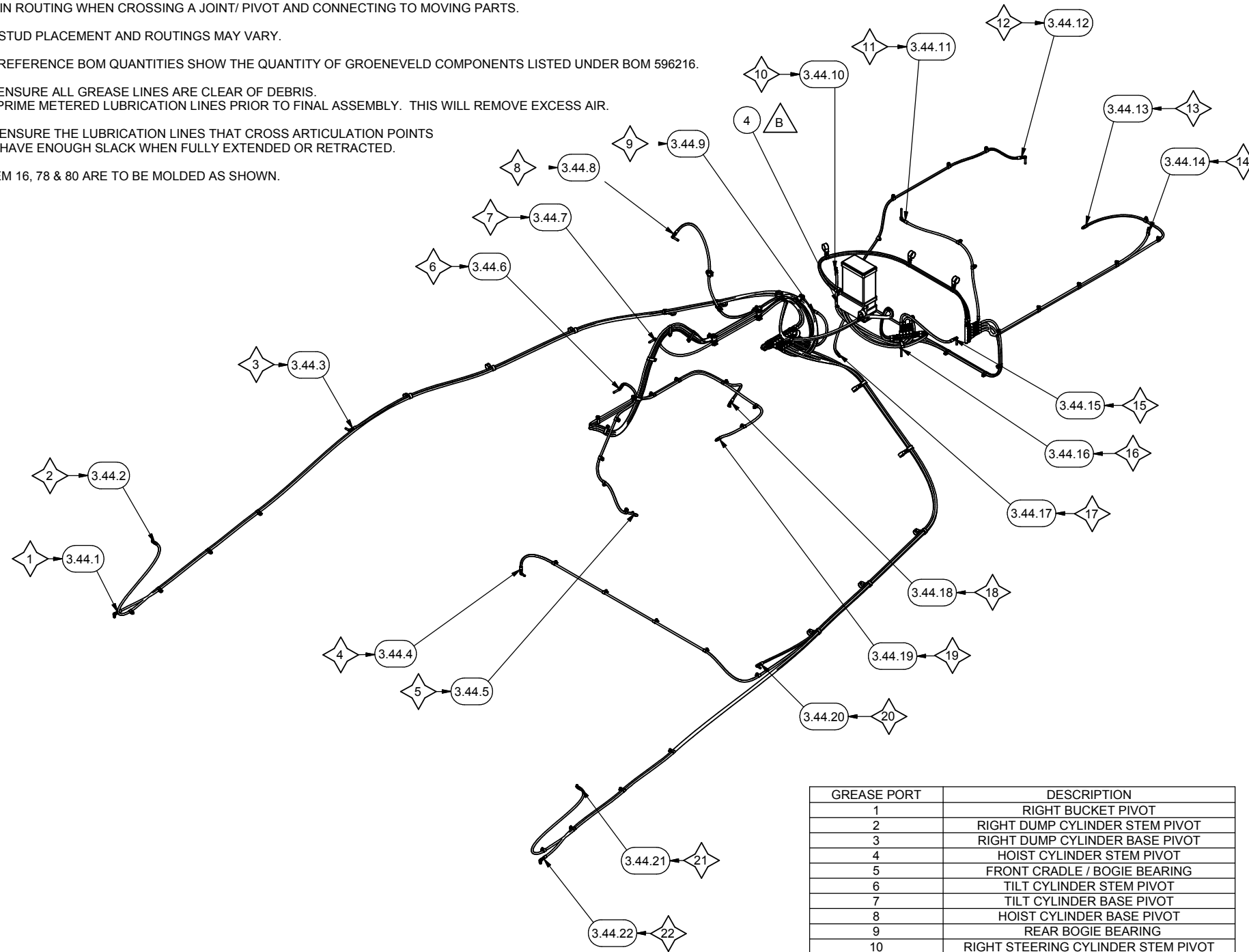

Auto Lube System

Automatic Lube System

Item	Part No.	Qty	Description	Item	Part No.	Qty	Description
	596094		Automatic Lube System				
				3.44	596252	1	.. Hose Kit, Auto Lube System
1	596215	1	. Schem	3.44.1	230673	1	... Hose Assembly
2	596216	1	. Kit, Lube Sys	3.44.2	596527	1	... Hose Assembly
3	596217	1	. Auto Lube Sys	3.44.3	230672	1	... Hose Assembly
3.1	592689	1	.. Pump & Reservoir Assembly	3.44.4	596526	1	... Hose Assembly
3.2	596207	1	.. Distribution Block, 4 Port	3.44.5	230879	1	... Hose Assembly
3.3	596208	1	.. Distribution Block, 5 Port	3.44.6	233718	1	... Hose Assembly
3.4	592591	2	.. Distribution Block, 8 Port	3.44.7	233137	1	... Hose Assembly
3.5	209750	25	.. Fitting	3.44.8	22074	1	... Hose Assembly
3.6	10783	2	.. Nipple, Pipe	3.44.9	232691	1	... Hose Assembly
3.7	209425	2	.. Fitting	3.44.10	250265	1	... Hose Assembly
3.8	209406	2	.. Fitting	3.44.11	244609	1	... Hose Assembly
3.9	209405	3	.. Fitting	3.44.12	229557	1	... Hose Assembly
3.10	R1931720	3	.. Fitting	3.44.13	233001	1	... Hose Assembly
3.11	212300	7	.. Fitting	3.44.14	233136	1	... Hose Assembly
3.12	229551	12	.. Fitting	3.44.15	13142	1	... Hose Assembly
3.13	592616	2	.. Tube Assembly	3.44.16	19986	1	... Hose Assembly
3.14	251172	4	.. Fitting	3.44.17	24979	1	... Hose Assembly
3.15	592554	REF 2	.. Plug, Twin Metering	3.44.18	246134	1	... Hose Assembly
3.16	592526	REF 6	.. Metering Unit No. 6	3.44.19	230109	1	... Hose Assembly
3.17	592525	REF 4	.. Metering Unit No. 4	3.44.20	233718	1	... Hose Assembly
3.18	592524	REF 2	.. Metering Unit No. 3	3.44.21	596525	1	... Hose Assembly
3.19	592523	REF 2	.. Metering Unit No. 2	3.44.22	217498	1	... Hose Assembly
3.20	592527	REF 2	.. Metering Unit No. 8	3.44.23	589529	1	... Hose Assembly
3.21	17059W	2	.. Fitting	3.44.24	589529	1	... Hose Assembly
3.22	593613	2	.. Fitting	3.44.25	589547	1	... Hose Assembly
3.23	229666	2	.. Fitting	3.44.26	227475	1	... Hose Assembly
3.24	592583	REF 1	.. Pressure Switch	3.44.27	243138	1	... Hose Assembly
3.25	209579	24	.. Clamp	3.44.28	14461	1	... Hose Assembly
3.26	209696	24	.. Clamp	3.45	209790	2	.. Fitting
3.27	227398	3	.. Clamp	4	596676	1	. Wiring Harness
3.28	R13805003	10	.. Clip, Insulated		243578	2	.. Fuse, 10 amp
3.29	596311	6	.. Clamp		591378	2	.. Fuse, 3.15 amp
3.30	209700	10	.. Clamp				
3.31	R2528352	5	.. Clip, Insulated				
3.32	596410	REF 2	.. Metering Unit No. 0				
3.33	R13811017	4	.. Capscrew				
3.34	Y73G-0440	2	.. Capscrew				
3.35	16338W	4	.. Capscrew				
3.36	Y25G-0512	16	.. Capscrew				
3.37	221767W	50	.. Hard Washer				
3.38	R13802914	20	.. Hard Washer				
3.39	R13811191	50	.. Locknut				
3.40	221705W	16	.. Hex Nut				
3.41	231251	7	.. Clamp, Hydra-Zorb				
3.42	231249	2	.. Clamp, Hydra-Zorb				
3.43	231248	1	.. Clamp, Hydra-Zorb				

NOTES:

- A. ITEM 20 NOT SHOWN. USES ITEM 20 WHERE NECESSARY. CORDURA WRAP IS USED FOR SINGLE OR BUNDLED LINES IN HIGH ABRASION AREAS. THE USE OF CORDURA WRAP MAY CHANGE CLAMPS CALLED OUT AND CLAMP QUANTITIES.
 - B. CORDURA WRAP SHALL BE USED IN AREA'S WHERE ABRASION IS HIGH & WORKING SECTION OF HOSE.
 - C. MINIMUM BEND RADIUS OF TUBING IS 2 INCH. GENEROUS LOOPS SHOULD BE ALLOWED IN ROUTING WHEN CROSSING A JOINT/ PIVOT AND CONNECTING TO MOVING PARTS.
 - D. STUD PLACEMENT AND ROUTINGS MAY VARY.
 - E. REFERENCE BOM QUANTITIES SHOW THE QUANTITY OF GROENEVELD COMPONENTS LISTED UNDER BOM 596216.
 - F. ENSURE ALL GREASE LINES ARE CLEAR OF DEBRIS. PRIME METERED LUBRICATION LINES PRIOR TO FINAL ASSEMBLY. THIS WILL REMOVE EXCESS AIR.
 - G. ENSURE THE LUBRICATION LINES THAT CROSS ARTICULATION POINTS HAVE ENOUGH SLACK WHEN FULLY EXTENDED OR RETRACTED.
- ITEM 16, 78 & 80 ARE TO BE MOLDED AS SHOWN.



VIEW LOCATION KEY:

FIRST NUMBER IS THE SHEET THAT THE DETAIL/SECTION IS LOCATED ON
 LETTER IS THE ALPHABETIC DESIGNATION OF THE DETAIL/SECTION
 LAST NUMBER IS THE SHEET THAT THE DETAIL/SECTION IS TAKEN FROM
 EX: 2C1 = DETAIL/SECTION IS LOCATED ON SHEET "2", DESIGNATED AS "C", TAKEN FROM A VIEW ON SHEET "1"

GREASE PORT	DESCRIPTION
1	RIGHT BUCKET PIVOT
2	RIGHT DUMP CYLINDER STEM PIVOT
3	RIGHT DUMP CYLINDER BASE PIVOT
4	HOIST CYLINDER STEM PIVOT
5	FRONT CRADLE / BOGIE BEARING
6	TILT CYLINDER STEM PIVOT
7	TILT CYLINDER BASE PIVOT
8	HOIST CYLINDER BASE PIVOT
9	REAR BOGIE BEARING
10	RIGHT STEERING CYLINDER STEM PIVOT
11	TOP SWIVEL BOX PIVOT
12	RIGHT STEERING CYLINDER BASE PIVOT
13	REAR AXLE PINION BEARING
14	LEFT STEERING CYLINDER BASE PIVOT
15	LEFT STEERING CYLINDER STEM PIVOT
16	BOTTOM SWIVEL BOX PIVOT
17	SWIVEL BOX MAIN BEARING
18	CRADLE REAR BEARING
19	FRONT AXLE PINION BEARING
20	LEFT DUMP CYLINDER BASE PIVOT
21	LEFT DUMP CYLINDER STEM PIVOT
22	LEFT BUCKET PIVOT

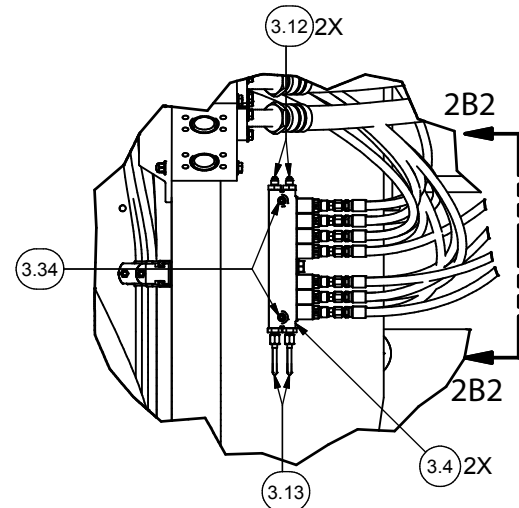

DETAIL 2A2

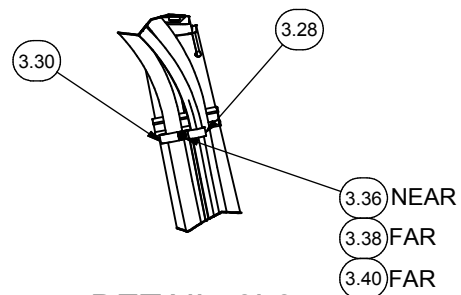

**DETAIL 2L2
SUGGESTED ASSEMBLY
OF HOSE CLAMPS**

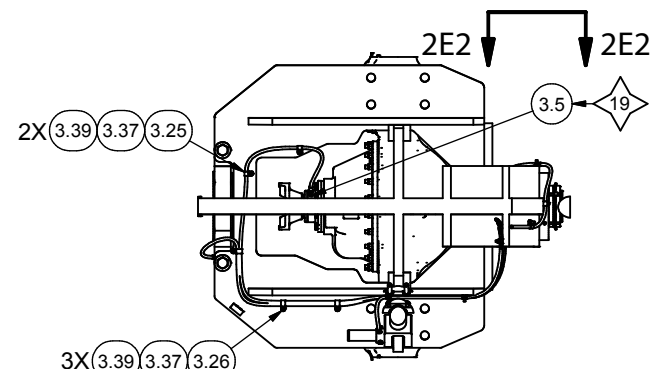

SECTION 2D2-2D2

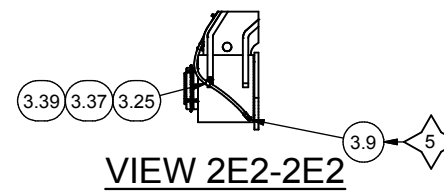
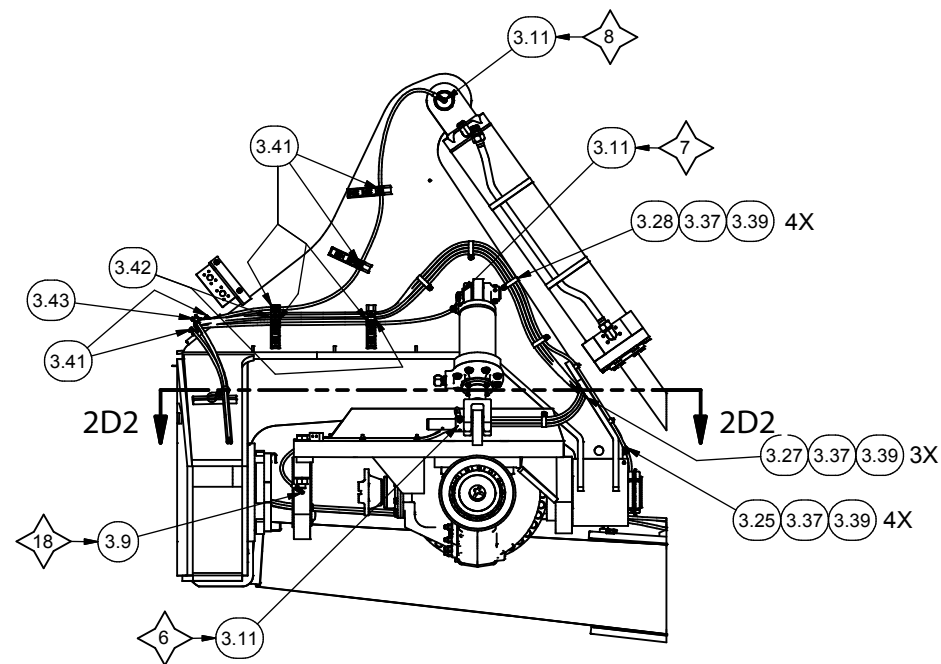
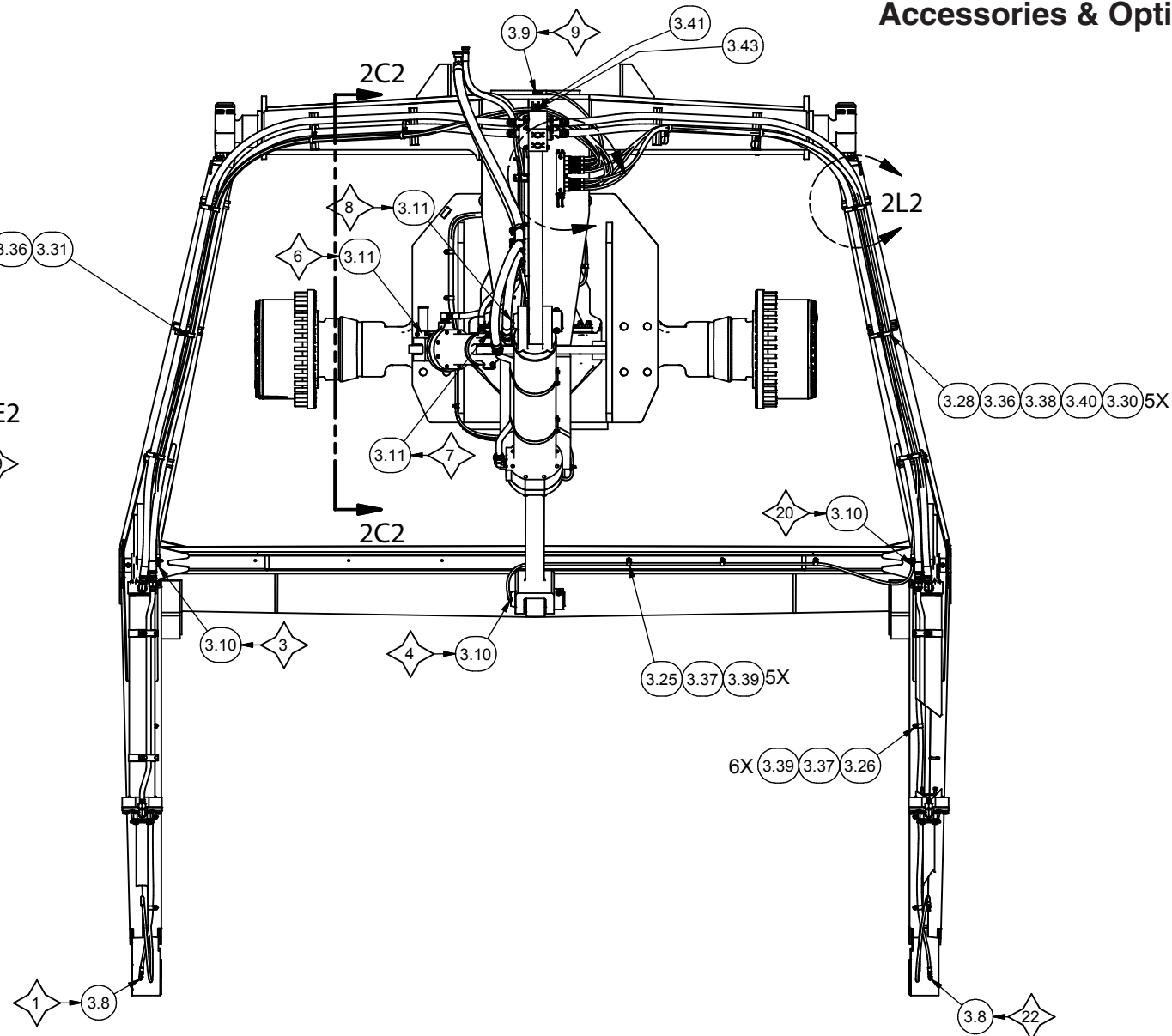

VIEW 2E2-2E2

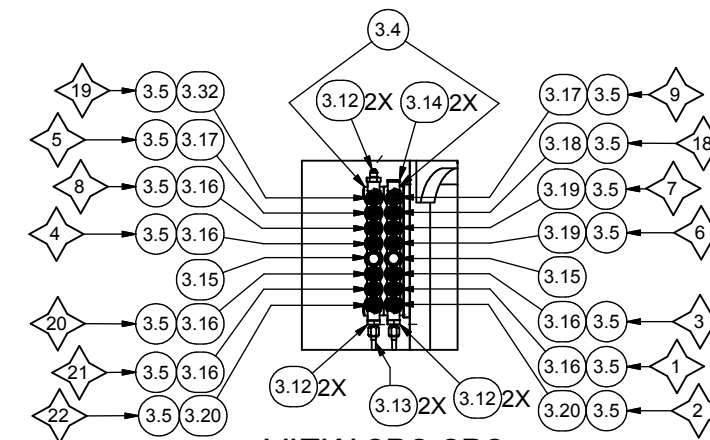

**VIEW 2B2-2B2
HOSES REMOVED FOR CLARITY**

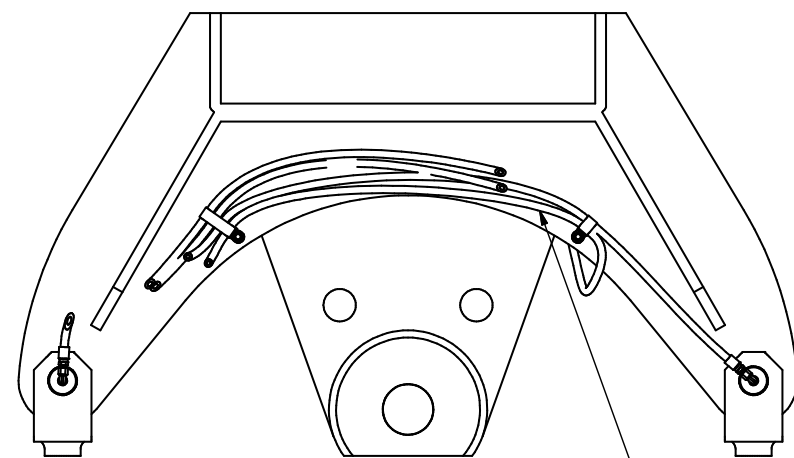
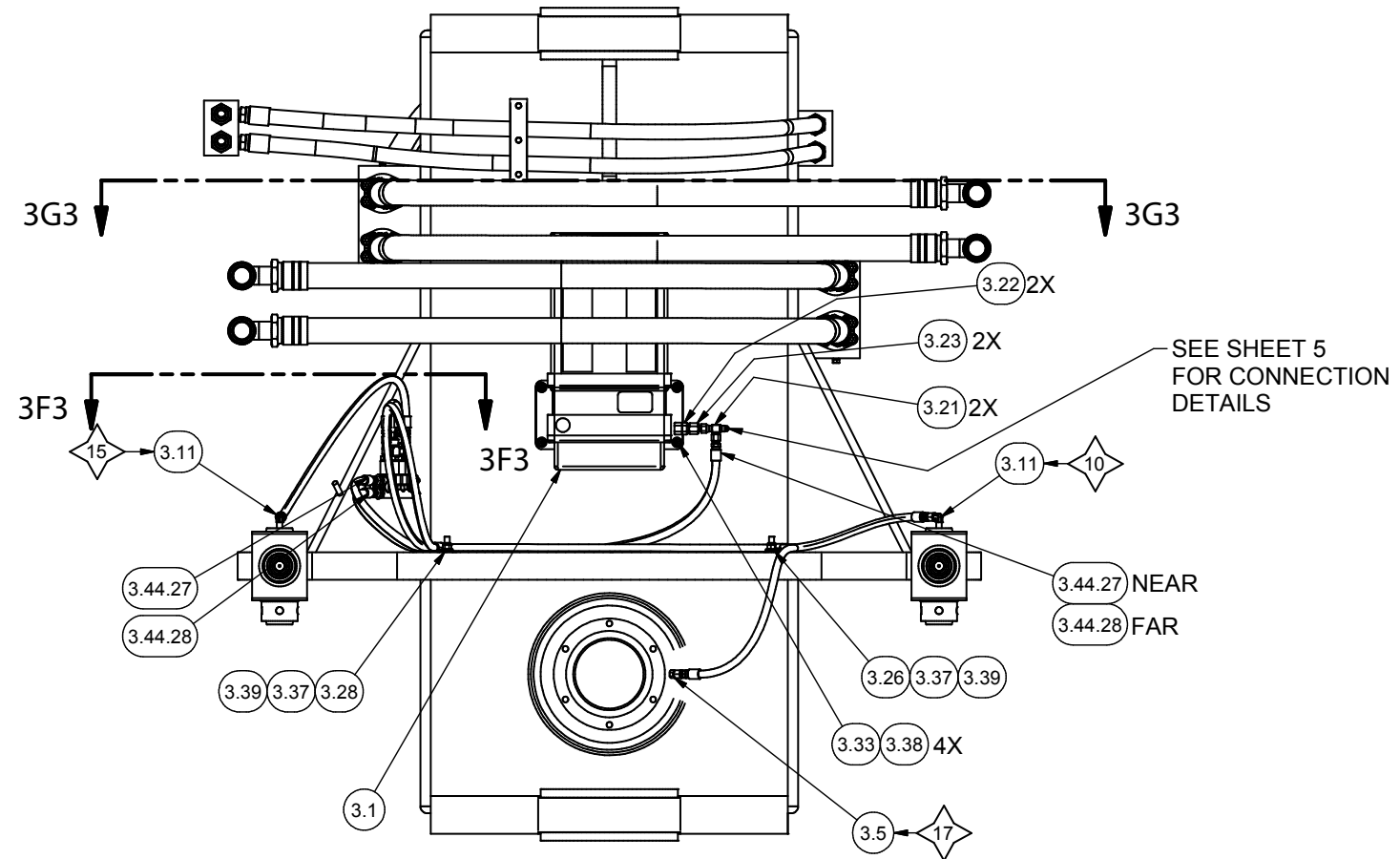

SECTION 3G3-3G3
SOME PARTS REMOVED FOR CLARITY — LAYOUT HOSES AS SHOWN

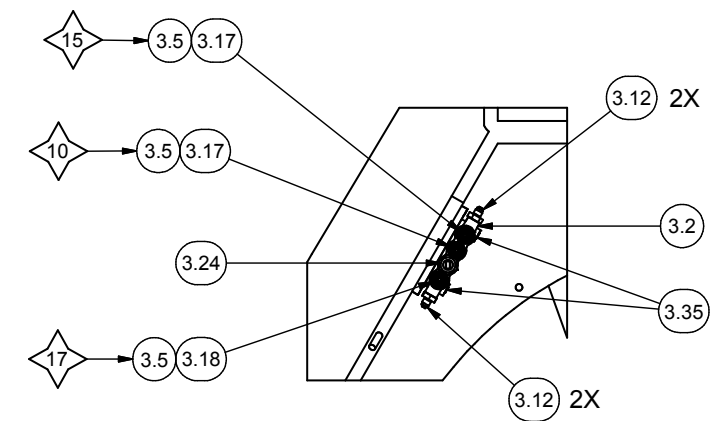

SECTION 3F3-3F3
HOSES REMOVED FOR CLARITY

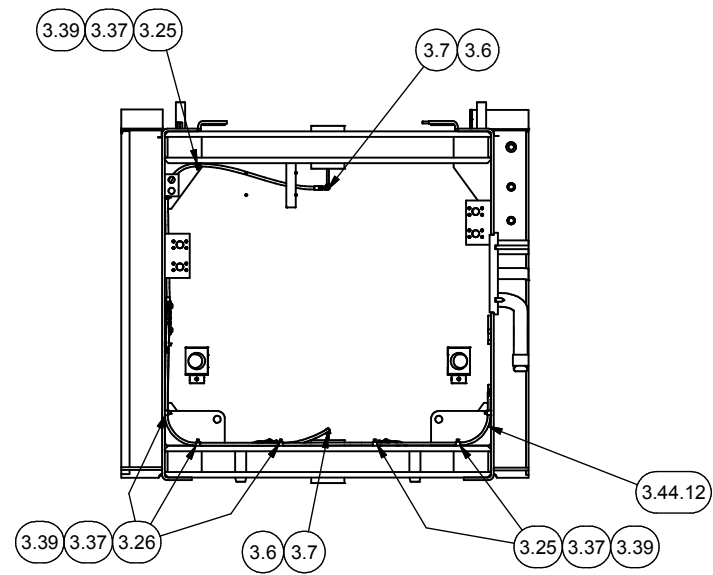

SECTION 4M4-4M4

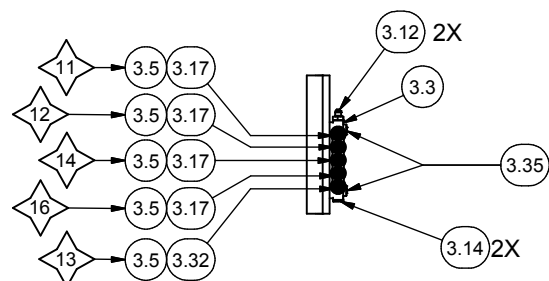
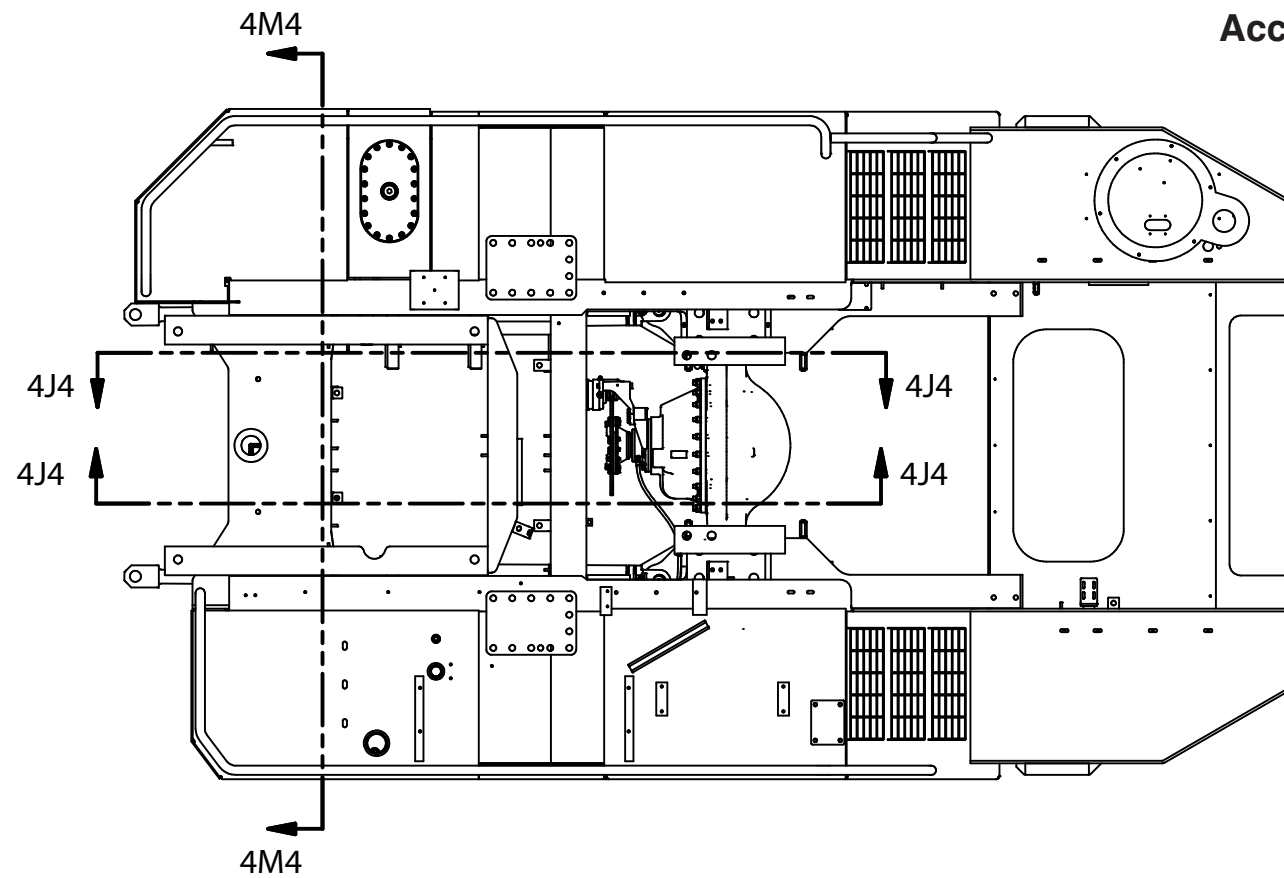

SECTION 4K4-4K4

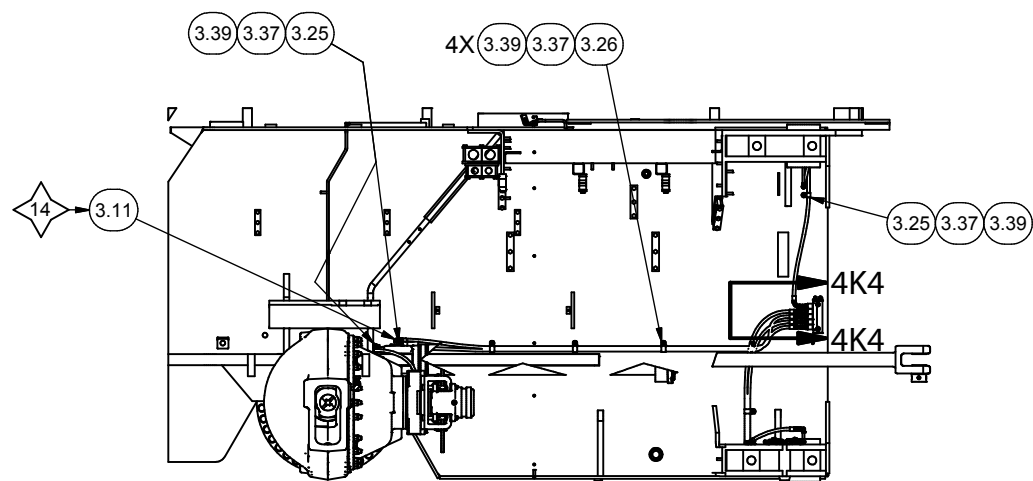

SECTION 4J4-4J4

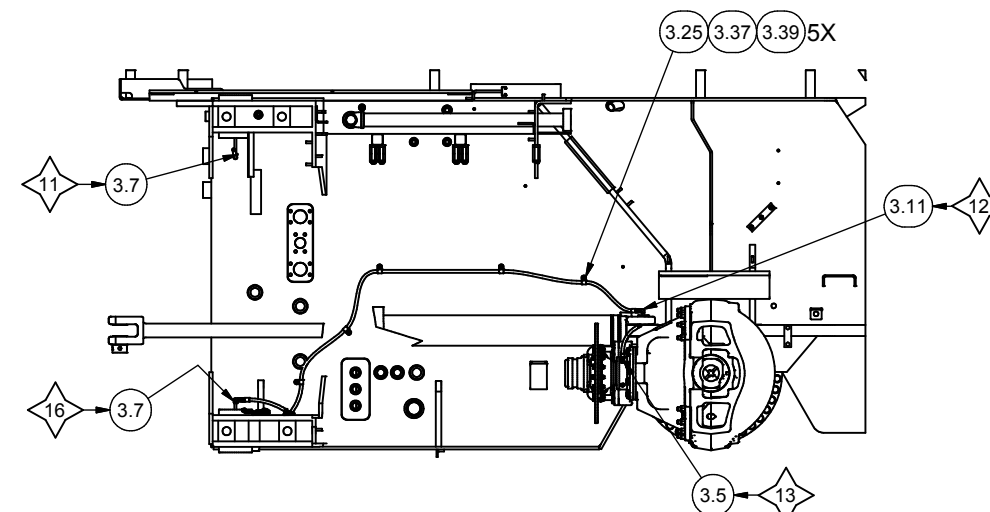

SECTION 4H4-4H4

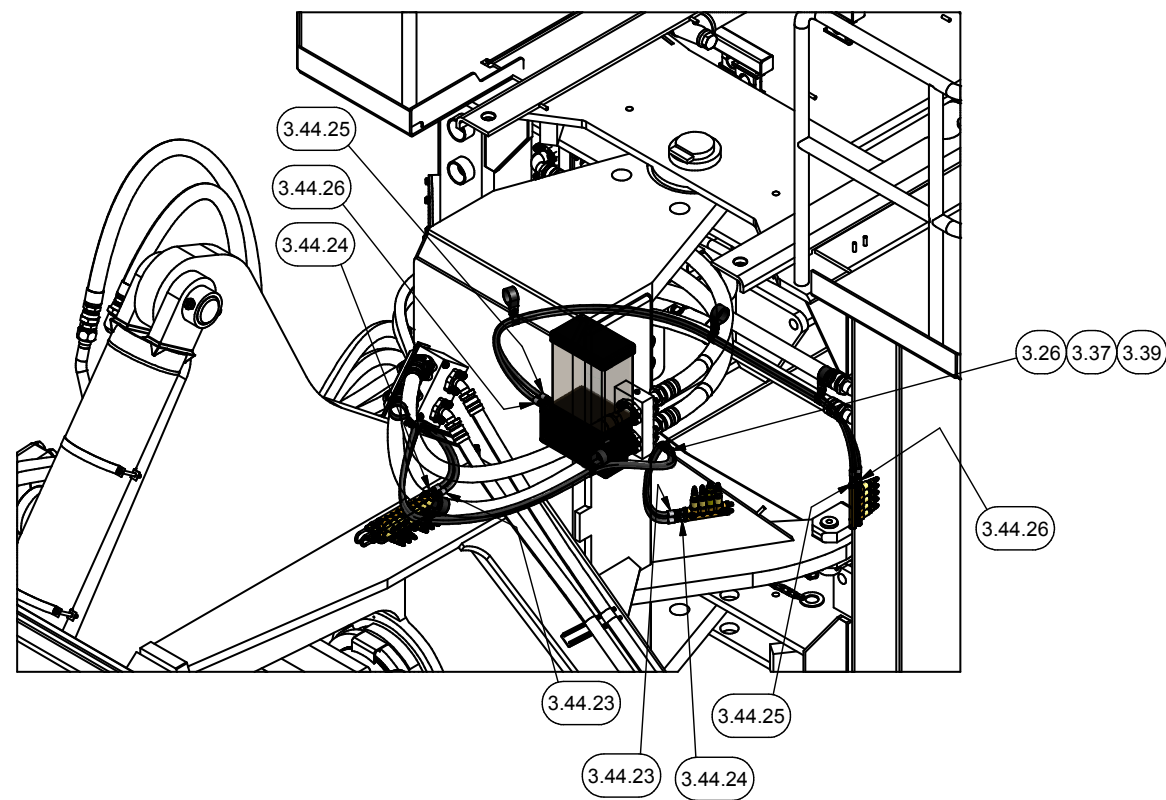

LINES THAT CROSS BETWEEN THE CHASSIS AND THE SWIVEL BOX
ARE CLAMPED TO HYDRAULIC LINES

