

---

Panel Assembly, Circuit Breaker

## Panel Assembly, Circuit Breaker

Item	Part No.	Qty	Description	Item	Part No.	Qty	Description
	<b>594393</b>		<b>Panel Assembly, Circuit Breaker</b>				
1	586637	1	. Panel Weldment, LH	23	232238	3	. End Plate
2	246930	2	. Latch, Compression	24	241761	6	. End Stop
3	223062	1	. Circuit Breaker, 2 Amp	25	232239	15	. Jumper
4	223065	2	. Circuit Breaker, 5 Amp	26	* 228922	3	. Terminal Ring
5	229306	7	. Circuit Breaker, 10 Amp	27	* 228923	1	. Terminal Ring
6	223067	5	. Circuit Breaker, 15 Amp	28	* 219383	2'	. Wire
7	223377	3	. Circuit Breaker, 20 Amp	29	NA - - - - -	0	. Diode
8	223069	1	. Circuit Breaker, 30 Amp	30	* 905113	2	. Diode Assembly
9	587084	1	. Circuit Breaker, 7.5 Amp	31	Y09G-(0632)04	2	. Capscrew
10	229301	2	. Relay	32	224191	10	. Nut
11	587032	1	. Decal, CB Panel	33	00103338	4	. Flat Washer
12	22636	6	. Jumper, Terminal	34	Y09G-(1024)08	10	. Capscrew
13	NA - - - - -	0	. Relay Socket	35	* 238656	1	. Card, Marker
14	NA - - - - -	0	. Relay	36	242949	4	. Terminal, Fuse
15	NA - - - - -	0	. Relay Socket	37	592459	4	. Fuse, 6A
16	NA - - - - -	0	. Relay	38	243578	2	. Fuse, 10A
17	232237	12	. Terminal Block	39	249389	6	. Resistor
18	239317	87	. Terminal Block				
20	584444	3	. Rail				
					* Items Not Shown		
					NA Not Applicable		

# Panel Assembly, Circuit Breaker

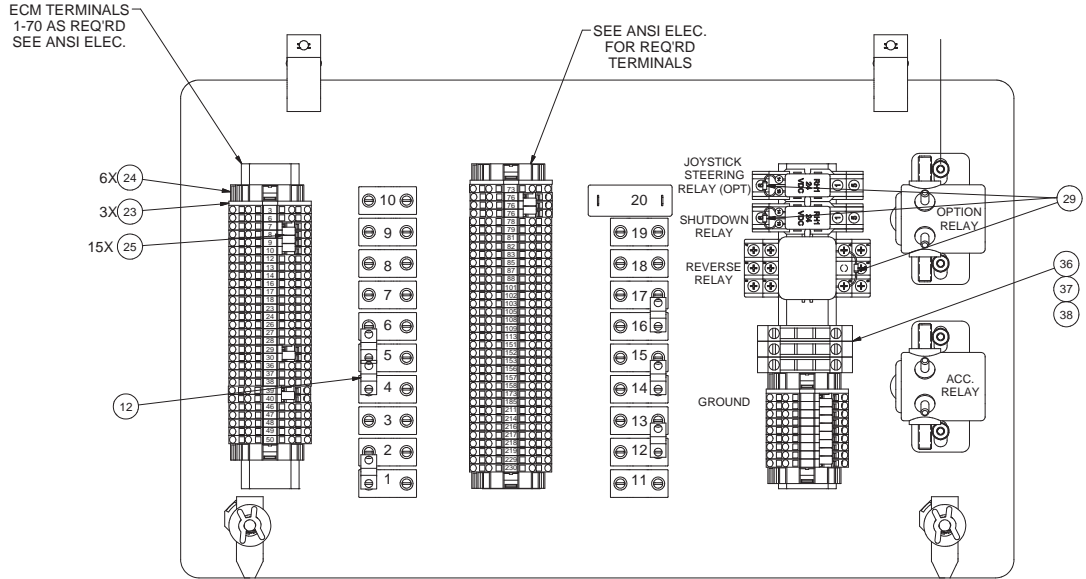

AS INSTALLED WITH PANEL OPEN

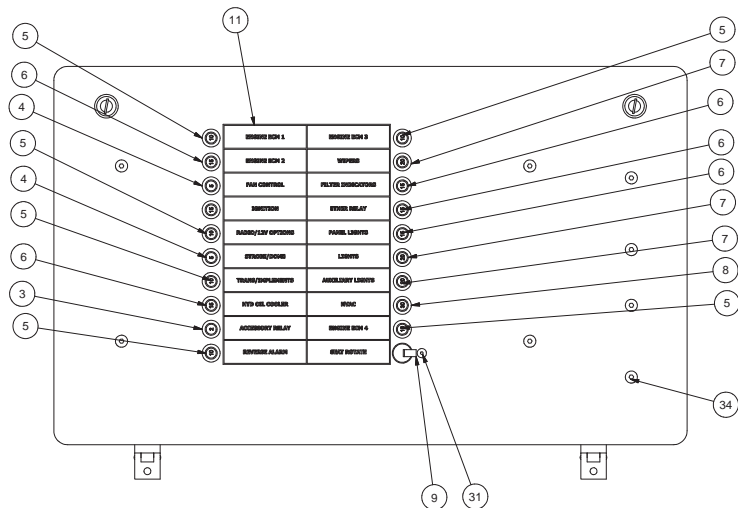
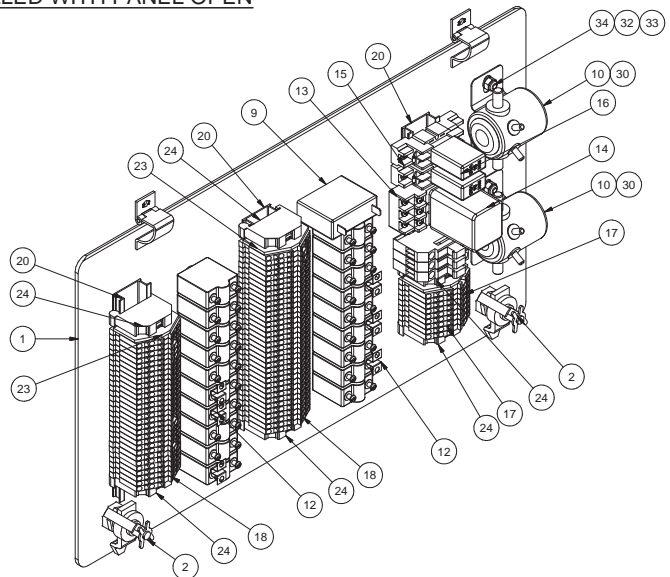

---

**Intentionally Left Blank**