

---

Electric System, Chassis

## Electrical System, Chassis

Item	Part No.	Qty	Description	Item	Part No.	Qty	Description
	<b>594296</b>		<b>Elect System Chassis - Cat</b>				
1	* 595187	1	. Installation, Electrical	18	R13808119	1	. Clip, Insul
2	* 595189	1	. Installation, Elect	19	16597W	2	. Capscrew
3	* 595659	1	. Installation, Elect	20	R13811191	2	. Locknut
4	* 595368	1	. Installation, Elect - Chassis	21	593600	2	. Bracket, Offset
5	595501	1	. Kit, Cable	22	18600W	2	. Capscrew
10	595326	3	. Mount, Tack	23	R2528352	2	. Clip, Insul
12	2311550	1	. Clip - Harness, Mounting (Deutsch)	24	296418W	2	. Hard Washer
13	R13803059	1	. Clip, Insul	25	Y09C-M0820	2	. Capscrew
14	R13808094	1	. Clip, Insul	26	302400W	2	. Locknut
15	R13803034	4	. Clip, Insul				
16	133469W	2	. Capscrew				
17	Y09C-M0816	5	. Capscrew				
							* See Separate Coverage

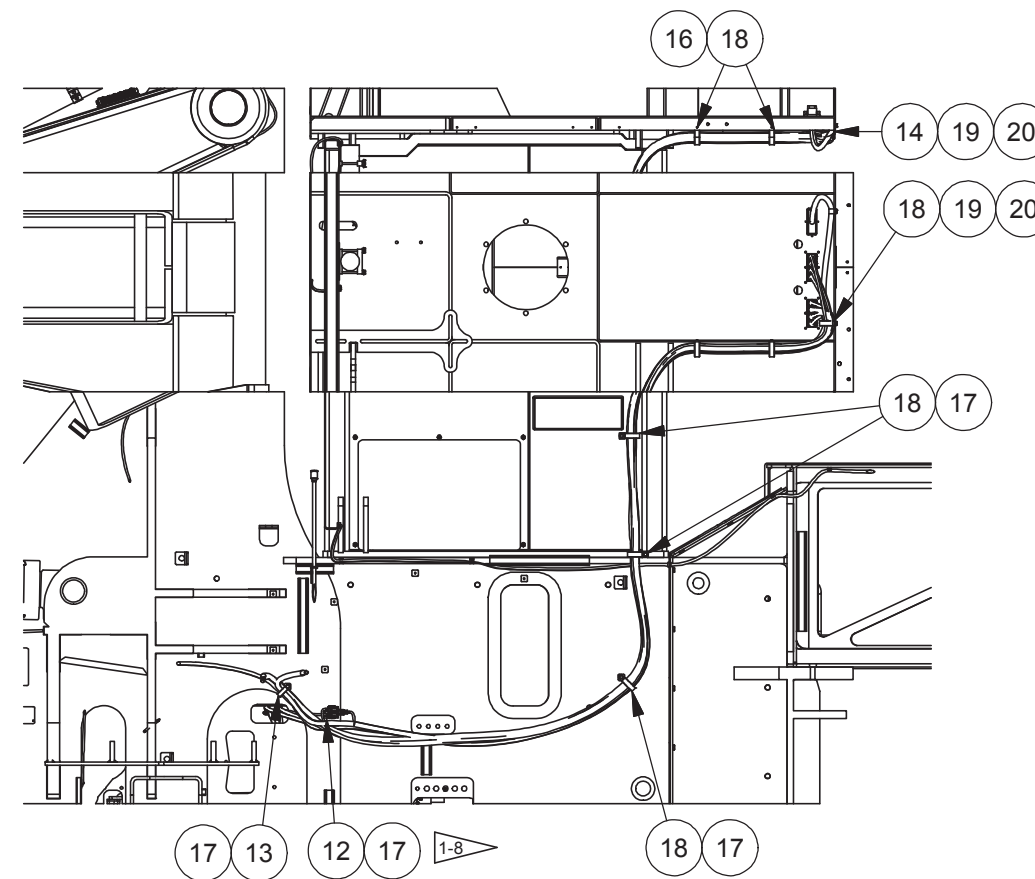
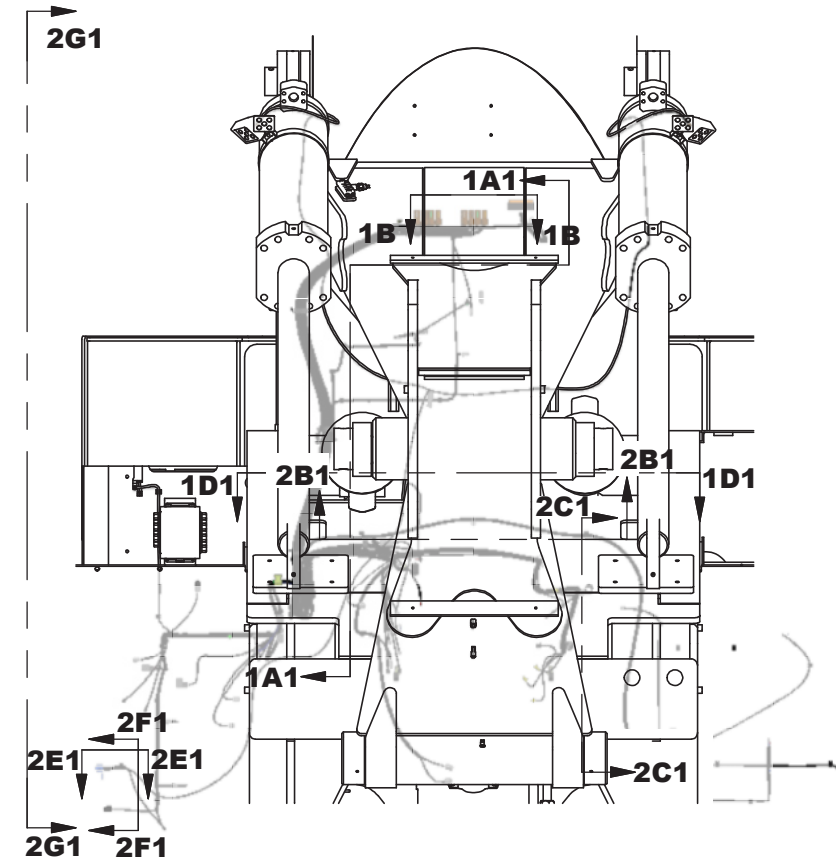
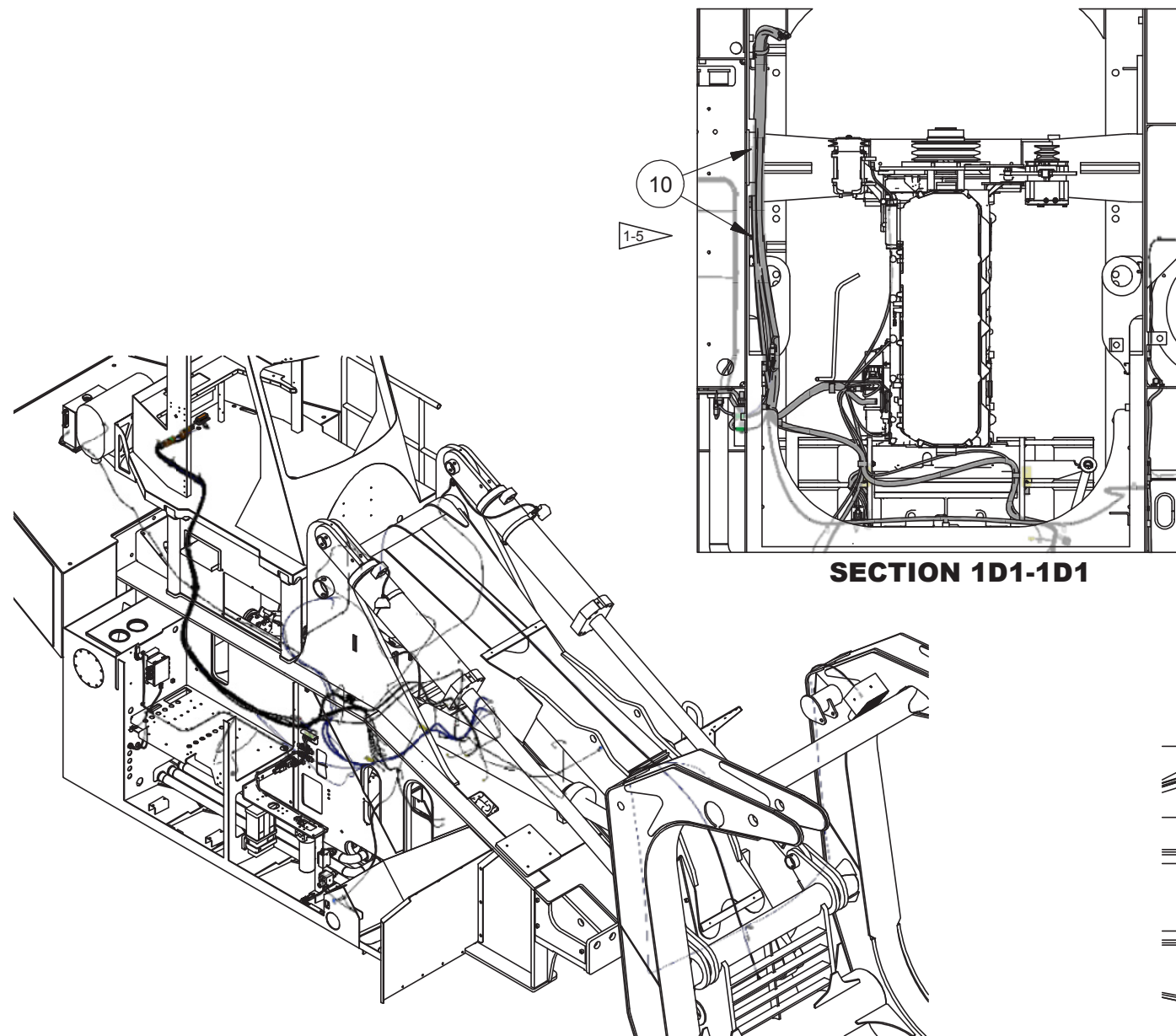

**SECTION 1A1-1A1**  
MAIN TRUNK

**NOTES:**

- 1-1 ROUTE HARNESS ACROSS TILTING HINGE SO THAT ENOUGH SLACK IS LEFT TO OPEN THE CAB 90°.
- 1-2 HARNESSES NOT SHOWN ARE:  
A) PRESSURE SWITCH HARNESS AND PUMP HARNESS IN LUBE SYSTEM. PRESSURE SWITCH HARNESS ROUTES WITH STAIRWAY LIGHTS.  
B) REMOTE FUEL FILTER HARNESS FOR CAT ENGINES IN POWER UNIT INSTALLATION; ROUTES WITH RH BAY 2 HARNESS.  
C) CARRIAGE LIGHT HARNESS IN CARRIAGE LIGHT INSTALLATION; ROUTES WITH HYDRAULIC HOSES.
- 1-3 MOUNT INSULATED CLAMPS USING EXISTING HARDWARE.
- 1-4 CABLE TIE TACK MOUNTS REQUIRE SPECIAL TOOL FOR PROPER INSTALLATION. REFER TO PIECE PART DOCS TAB FOR INSTALLATION INSTRUCTIONS.
- 1-5 PLACE CABLE TIE TACK MOUNTS IN APPROXIMATE LOCATIONS SHOWN.
- 1-6 CHASSIS GROUND CONNECTS TO ENGINE GROUND, DISCONNECT GROUND, AND CAB GROUND. CHASSIS GROUND LOCATED ON RH ENGINE MOUNT
- 1-7 CAB POSITIVE, DISCONNECT GROUND, AND STARTER CABLES ROUTE UNDER ENGINE
- 1-8 J1939 SPLITTER ON ECM MOUNTS TO CHASSIS WALL
- 1-9 BATTERY CABLES ARE SHOWN ON PAGE 3

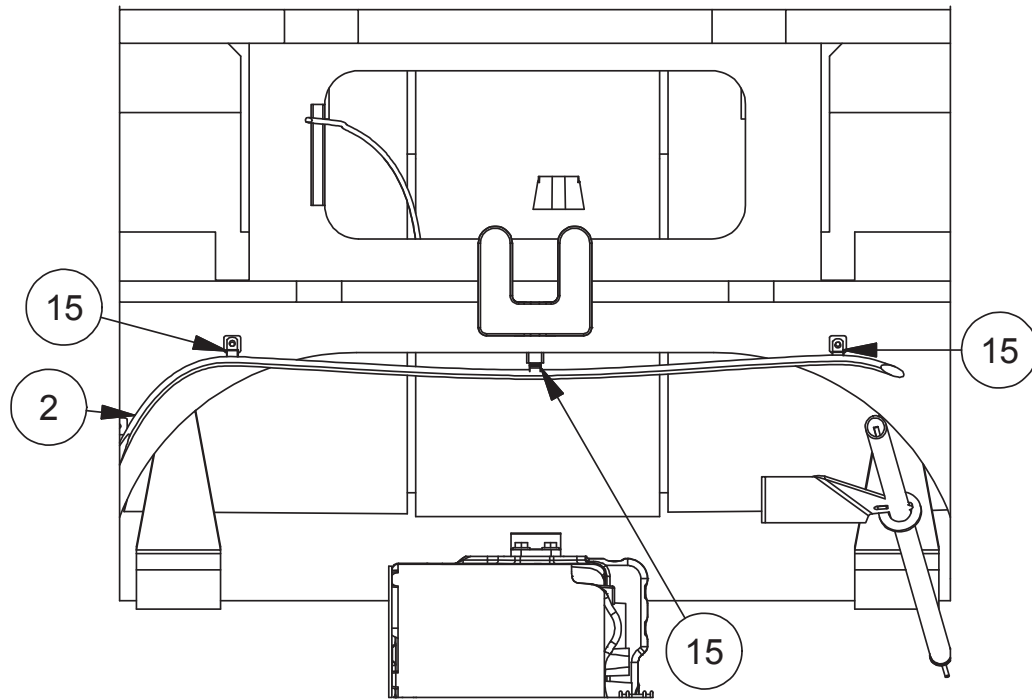

**SECTION 2B1-2B1**  
LH BAY HARNESS INSTALLATION

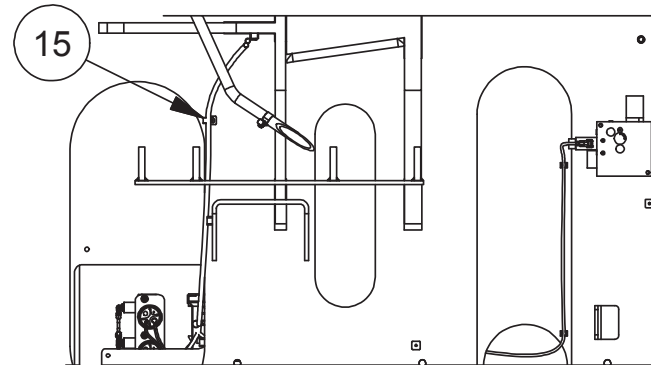

**SECTION 2C1-2C1**  
LH BAY HARNESS INSTALLATION

LUBE PUMP HARNESS ROUTES TO CLIP. PRESSURE SWITCH ROUTES WITH STAIRWAY LIGHT HARNESS TO DISTRIBUTION BLOCK ON BOOM.

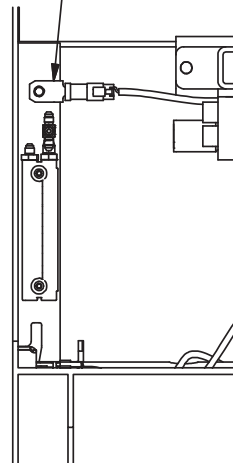

**SECTION 2E1-2E1**  
RH BAY STAIRWAY  
AND LUBE HARNESSES

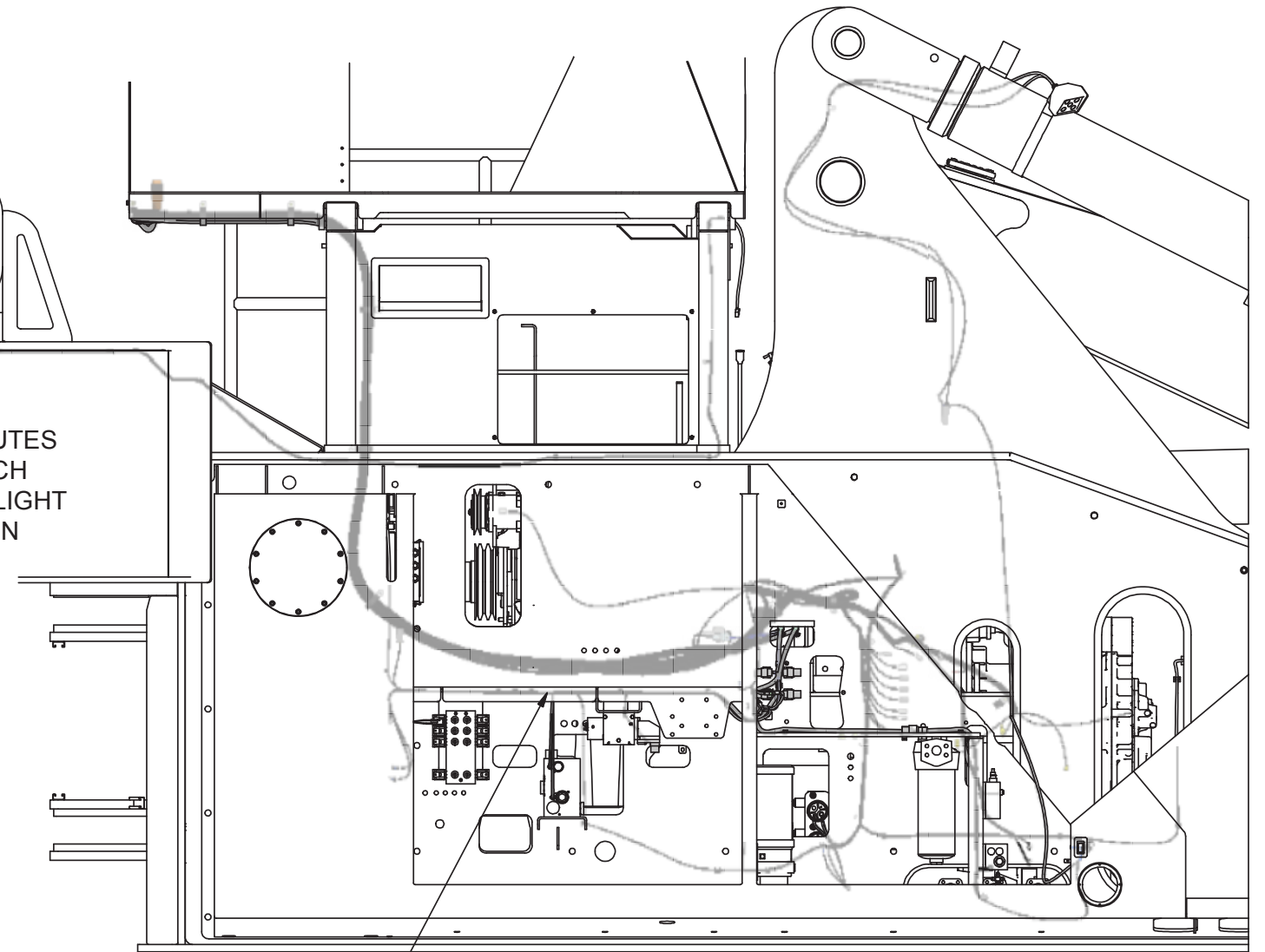

**VIEW 2G1-2G1**

STAIRWAY LIGHT HARNESS:  
RED WIRE CONNECTS TO CENTER SWITCH TERMINAL  
(2) BLACK WIRE CONNECTS TO RH BAY HARNESS GROUND WIRE (BLACK)

RH BAY HARNESS:  
BROWN WIRES CONNECTS TO OUTSIDE SWITCH TERMINALS  
(1 AND 3.) BLACK WIRE CONNECTS TO STAIRWAY LIGHT HARNESS GROUND WIRE (BLACK)

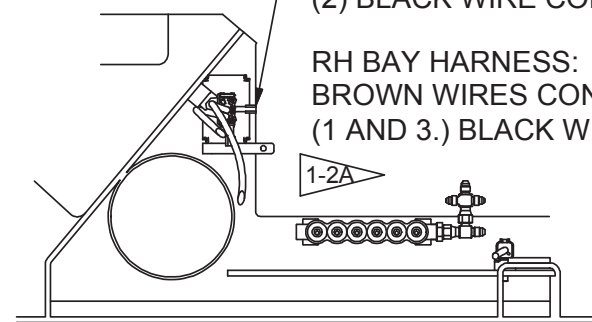

**SECTION 2F1-2F1**  
RH BAY STAIRWAY LIGHT INSTALL

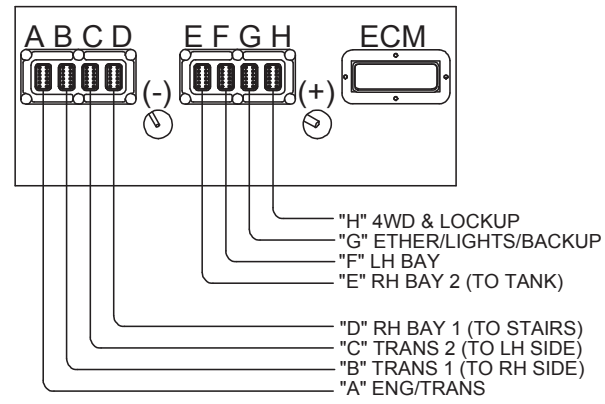

**SECTION 1B-1B**  
LOOKING FROM INSIDE CAB

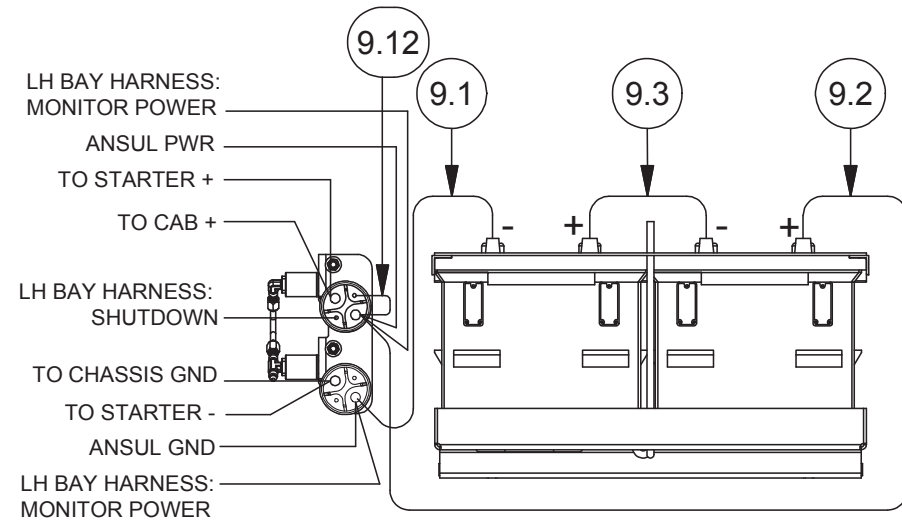

**BATTERY CONNECTIONS**

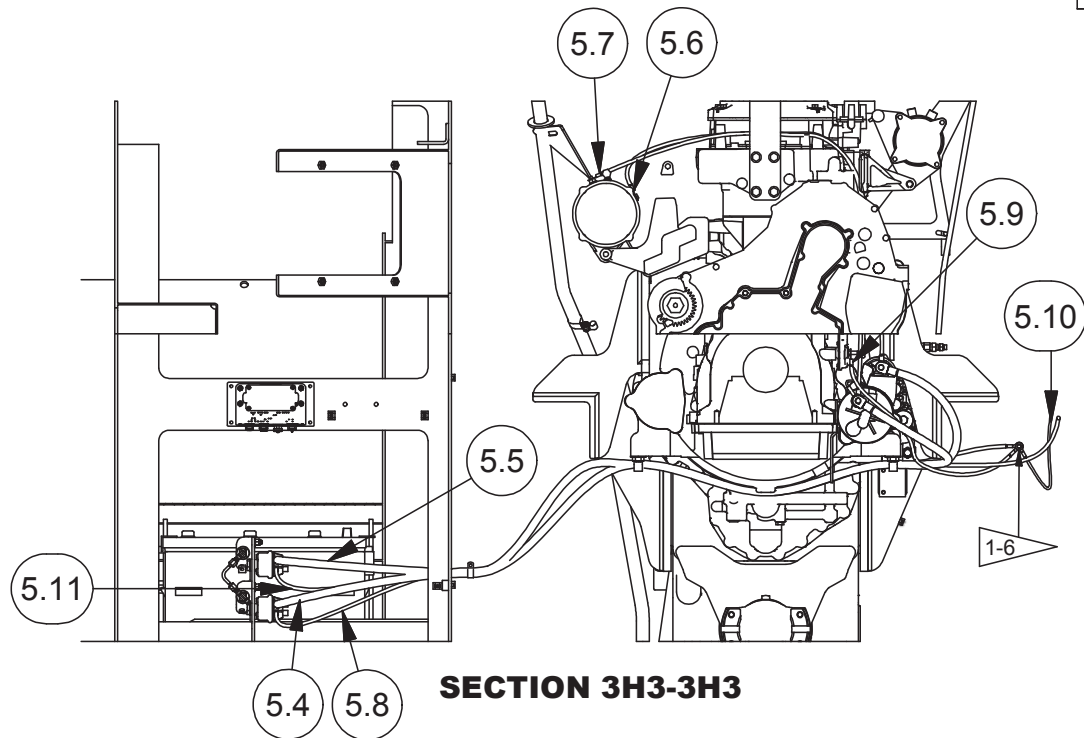
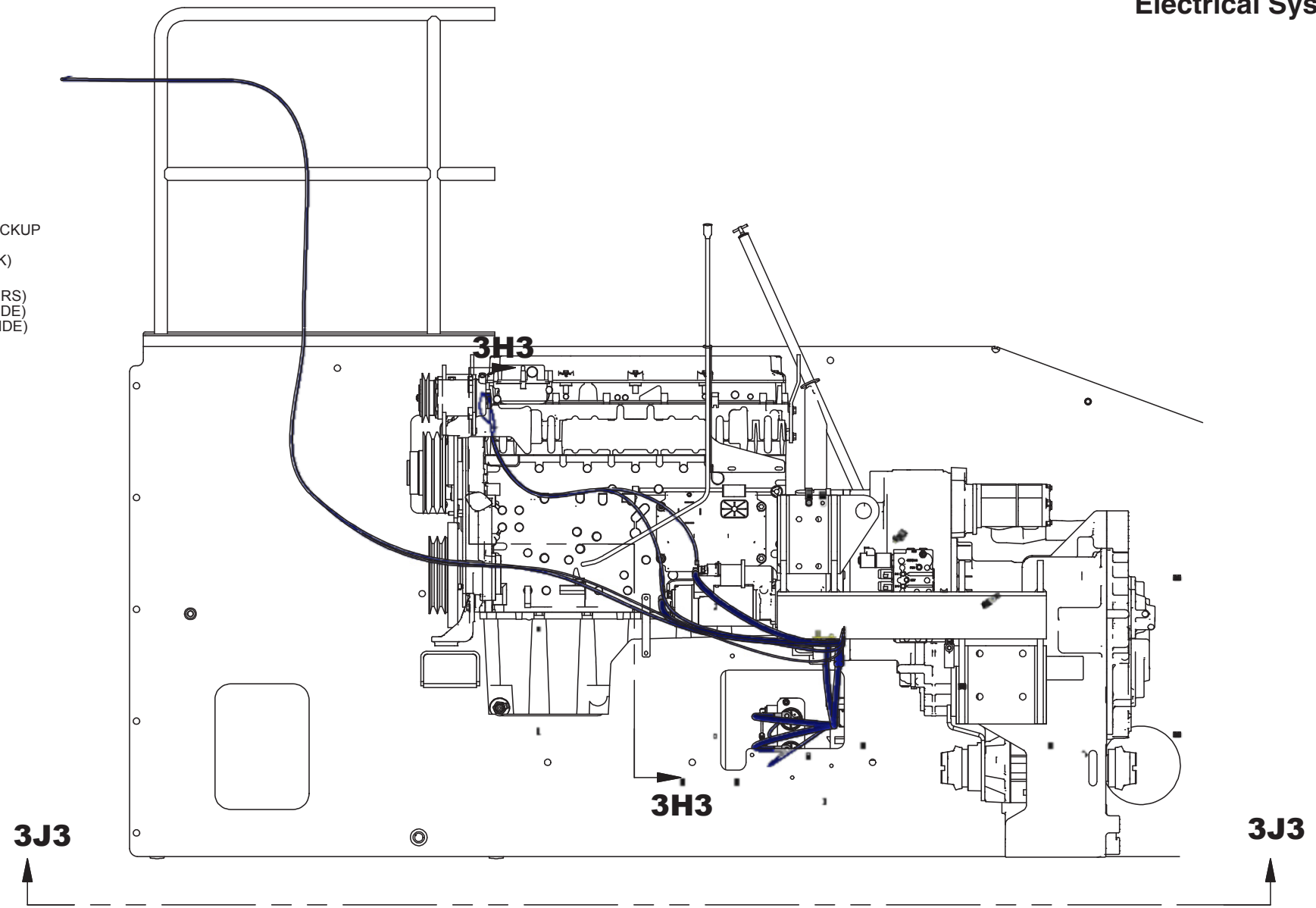

**SECTION 3H3-3H3**

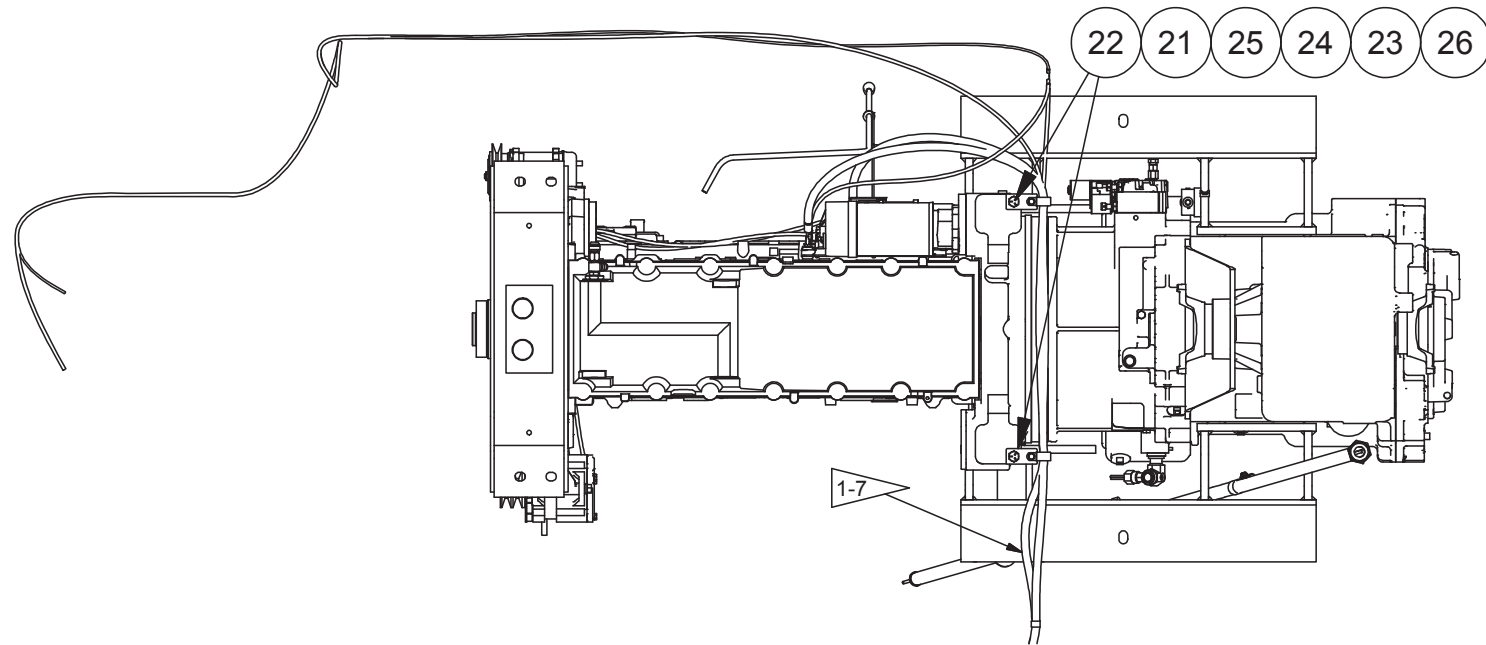

**VIEW 3J3-3J3**

B