

---

Dump Cylinder Installation

## Hydraulic System - Dump Cylinder

Item	Part No.	Qty	Description	Item	Part No.	Qty	Description
	<b>586100</b>		<b>Installation, Cylinder - Dump</b>				
1	* 586035	1	. Assembly, Cylinder	10	R13811196	2	. Locknut
2	225129	2	. Fitting	11	230681W	2	. Capscrew
3	586056	4	. Clamp Weldment	13	541598	2	. Pin
4	R13811191	4	. Locknut	14	R13811085	2	. Capscrew
5	R13801813	4	. Capscrew	15	R13811193	2	. Nut, Esna
6	586108	1	. Tube Assembly, LH	16	00191758	4	. Fitting, Lube
7	209715	2	. Fitting	17	586106	4	. Shim
8	209442	2	. Fitting	19	529808	2	. Pin
9	586107	1	. Tube Assembly, RH	20	* 586035	1	. Assembly, Cylinder

\* See Separate Coverage

**DUMP CYLINDER ANCHOR LUG SETTING:**

AFTER THE BUCKET STOPS HAVE BEEN SET, (SEE ASS'Y, BUCKET & LIFT ARM; FOR INFORMATION) POSITION THE BUCKET & H-FRAME ON THE GROUND WITH THE CUTTING LIP SUPPORTED AS SHOWN;

ASSEMBLE THE BUCKET DUMP CYLINDER ANCHOR LUG TO THE DUMP CYLINDER USING THE INDICATED HARDWARE;

CONNECT THE APPROPRIATE DUMP CYLINDER STEM EYE TO THE ASSOCIATED SIDE OF THE BUCKET AND FRAME ASSEMBLY, USING THE INDICATED HARDWARE. SET THE CYLINDER DOWN SO THAT THE ANCHOR LUG IS RESTING ON THE H-FRAME;

- 1 EXTEND THE DUMP CYLINDER STEM, 1/4" FROM THE FULLY COLLAPSED POSITION, TO ESTABLISH THE ANCHOR LUG POSITION;
- 2 VISUALLY VERIFY ALIGNMENT. DIMENSION SHOWN IS FOR REFERENCE. DUMP CYLINDER IS TO BE ON CENTER OF DUMP CYLINDER POCKET.
- ONCE ON CENTER, SUBSTANTIALLY TACK WELD THE LUG(S) INTO POSITION, AND MOVE, (OR REMOVE) THE DUMP CYLINDER TO FACILITATE WELDING PER WELD NOTE;
- 3 VERIFY CLEARANCE ON STEM EYE IN DUMP CYLINDER CONNECTION POCKET. 1/8" PER SIDE IS NOMINAL, USE ITEM 17 AS REQUIRED TO REDUCE EXCESSIVE CLEARANCE;
- 4 CYLINDER CAN LAY AT AN ANGLE UP TO 7° BETWEEN FRAME AND BUCKET ANCHORS.

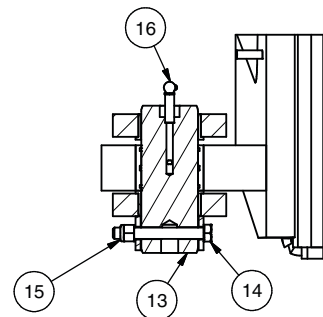

**SECTION D-D  
TYP, BOTH SIDES**

BUCKET ROLL BACK STOPS TO BE PROPERLY SET BEFORE SETTING DUMP CYLINDER ANCHOR LUGS.; REFER TO BUCKET & LIFT ARM INSTL FOR INFORMATION; SEE M/S

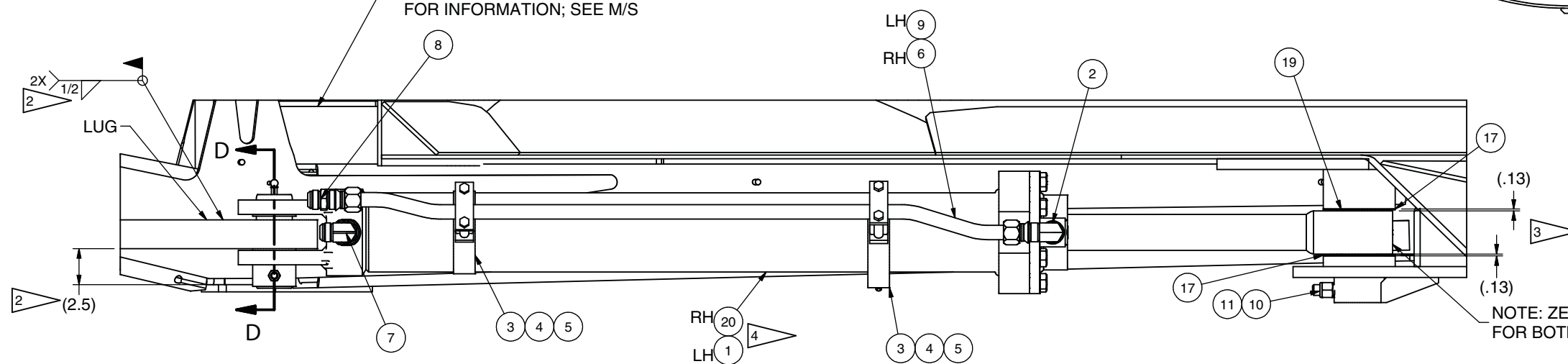

**SECTION A-A  
RH CYLINDER SHOWN  
LH IS MIRROR IMAGE  
TUBE LAYS TOWARDS THE BUCKET**

PLACE BLOCKING UNDER CUTTING LIP TO FULLY SEAT THE BUCKET AGAINST THE BUCKET ROLL BACK STOPS.

NOTE: ZERK LOCATED ON BOTTOM SIDE FOR BOTH MANUAL & AUTOMATIC LUBRICATION