

---

Panel Group-Circuit Breaker

## Panel Group, Circuit Breaker

Item	Part No.	Qty	Description	Item	Part No.	Qty	Description
	<b>584442</b>		<b>Panel Group, Circuit Breaker</b>				
1	584445	1	. Plate, Circuit Breaker	26	Y25G-(0832)066		. Capscrew
2	Y26G-(1032)082		. Capscrew	29	232903	2	. Power Converter
3	R10547	1	. Buzzer	30	00103338	18	. Washer
4	22636	14	. Jumper, Terminal	31	R13809543	8	. Locknut
5	245598	1	. Relay, Flasher	32	Y25G-(1024)128		. Capscrew
6	217208	1	. Connector	33	238891	3	. Relay
7	Y25G-0408	2	. Capscrew	34	232908	3	. Relay
8	584931	2	. Decal	35	232909	3	. Relay Socket
9	584932	2	. Decal	36	255240	1	. Adapter, Usb
10	584933	2	. Decal	37	251615	1	. Outlet, Power
11	223067	7	. Circuit Breaker	38	248649	1	. Receptacle
12	229306	5	. Circuit Breaker	39	219288	3	. Plate, Seal
13	223065	5	. Circuit Breaker	40	246914	6	. Pin
14	223063	1	. Circuit Breaker	41	243476	1	. Cover, Dust
15	584934	2	. Rail	42	247674	8	. Washer
16	254954	1	. Solenoid	43	R13811438	6	. Washer
17	232237	142	. Terminal Block	44	247672	4	. Machine Screw
18	241761	6	. End Stop	45	236770	4	. Nut, Esna
19	232238	6	. End Plate	46	235842	3	. Clamp, Holddown
20	22632	3	. Relay Socket	47	232910	3	. Relay Spring
21	241759	18	. Jumper	49	255265	1	. Resistor
22	236926	22	. Jumper, Horizontal	50	238933	1	. Card, Marker
23	R13802619	6	. Washer	51	235618	1	. Card, Marker
24	R13811189	4	. Locknut	52	239175	1	. Card, Marker
25	585159	1	. Rail	53	239176	1	. Card, Marker

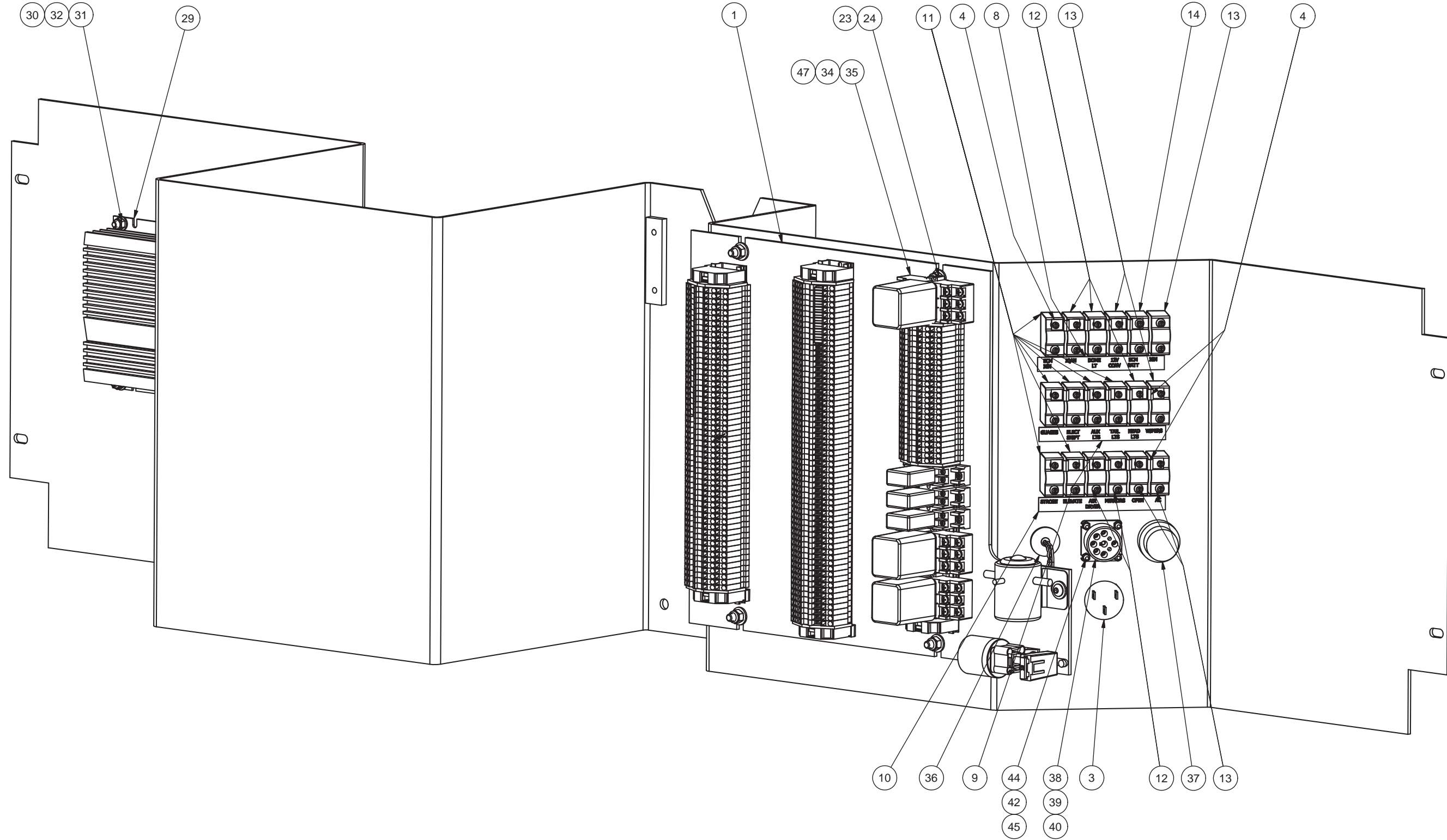

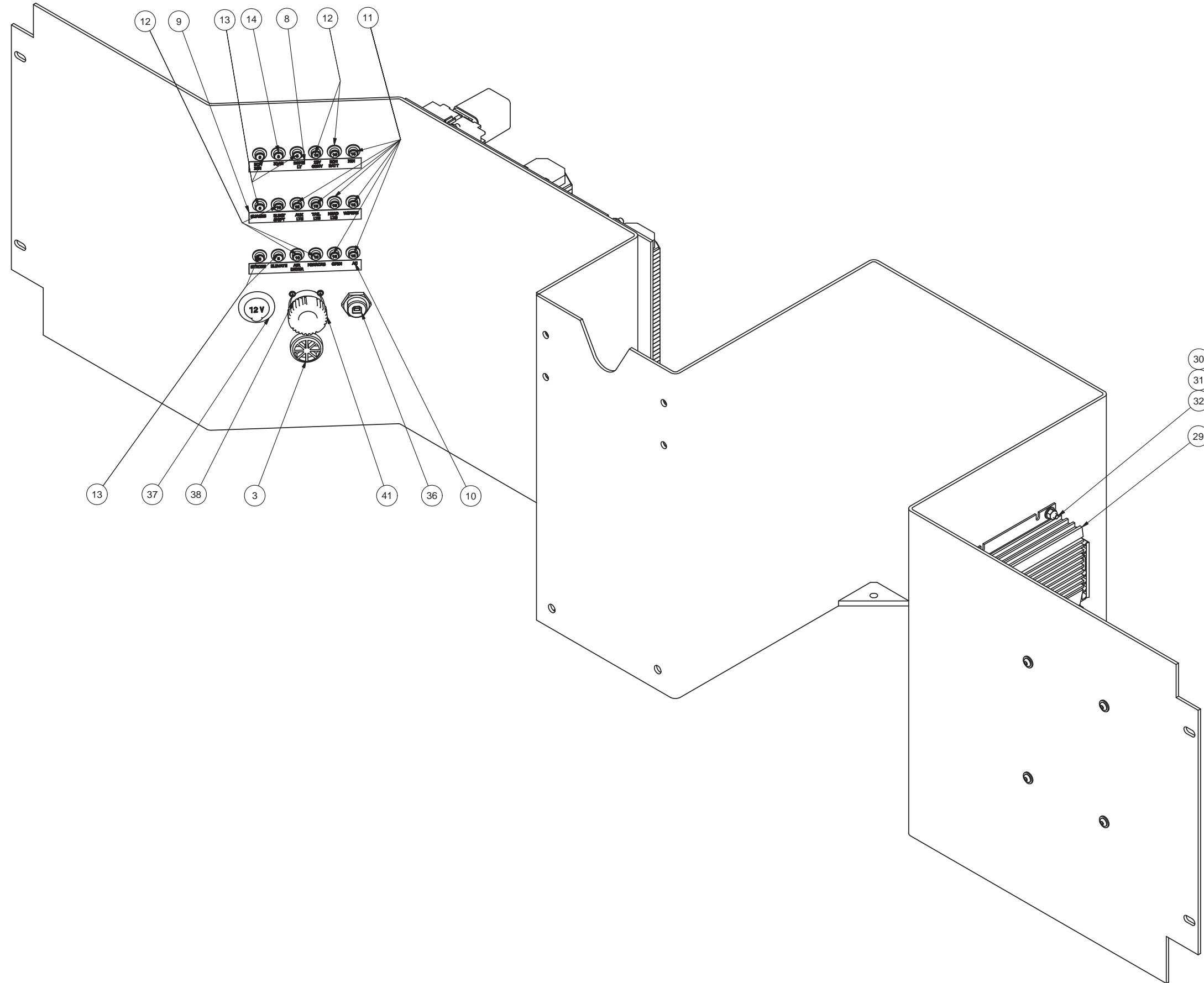

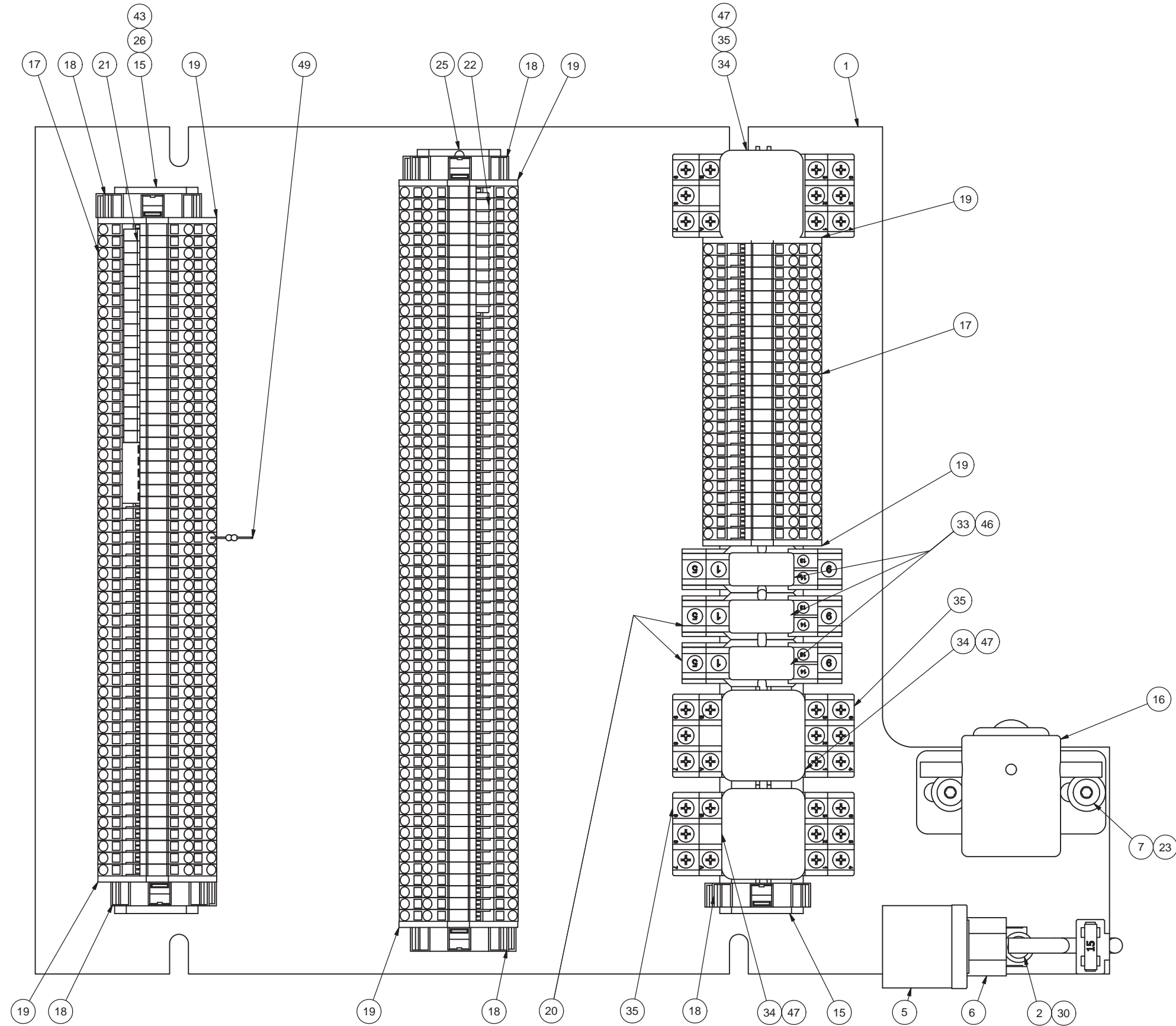

SEE ANSI ELECTRICAL SCHEMATIC FOR INSTALLATION LOCATIONS FOR JUMPERS ITEMS 21 & 22, IQAN RESISTOR ITEM 49 AND TERMINAL LABELS ITEMS 50-53 (NOT SHOWN).