

Power Unit

Power Unit

Item	Part No.	Qty	Description	Item	Part No.	Qty	Description
580679 Power Unit							
1	* 249545	1	. Engine	63	240733	1	. Breather, Air
2	* 581376	1	. Radiator	64	240734	1	. Check Valve
3	* 248962	1	. Converter	65	209714	2	. Fitting
4	570775	1	. Ring Gear Assembly	66	211693	3	. Fitting, Ff
	237315	96	. Washer, Bellville	67	11767	4	. Kit, Split Flange
	237316	24	. Nut		200604	4	. Lockwasher
	570735	1	. Ring Gear		209537	2	. Clamp Half
	570776	24	. Stud		222379	4	. Capscrew
5	234183	1	. Alternator	69	23390	3	. Kit, Split Flange
7	529449	1	. Wire Assembly, Grnd		200604	4	. Lockwasher
8	581113	1	. Wire Harness, Engine ECM		201621	4	. Capscrew
9	581137	1	. Wire Harness		203523	1	. O-Ring
10	578953	1	. Wire Harness, OEM		209539	2	. Clamp Half
11	578954	1	. Wire Harness, Engine Access	70	201615	12	. Capscrew
13	250372	1	. Fan, 40	71	201568	12	. Lockwasher
14	247024	1	. Pulley, Alternator	74	r13811086	6	. Capscrew
15	581062	1	. Air Scoop Weldment	75	202947	2	. Hose Clamp
16	* 245931	2	. Pump, Hydraulic	76	243488	4	. Connector
17	* 245520	1	. Pump, Hydraulic	77	243489	8	. Clamp
18	539968	1	. Sleeve, Pump	78	209483	1	. Fitting, Ff
19	* 581086	1	. Condenser Installation	79	211791	5'	. Hose, Radiator
20	581203	2	. Bracket Weldment, Tank	80	232881	8	. T-Bolt Clamp
21	505499	4	. Gasket	81	579333	1	. Tube Weldment, Lower Rad
22	581206	2	. Bracket	82	581020	1	. Tube, Alum
23	225829	6'	. Hose, Bulk	83	581021	1	. Tube, Alum
24	247072	2	. Fitting	84	580504	2	. Engine Mt Weldment, Rear
25	580421	1	. Engine Mt Weldment	85	250494	1	. Hose Assembly
26	R13811148	2	. Capscrew	86	250495	1	. Hose Assembly
27	R13811457	4	. Flat Washer	87	R13811123	6	. Capscrew
28	224194	2	. Nut, Esna	88	209791	4	. Fitting, Ff
29	R13811075	12	. Capscrew	89	230338	2	. Capscrew
30	R13811451	8	. Flat Washer	90	R2529808	4	. Spacer
31	R13812516	4	. Lockwasher	91	219383	8'	. Wire
32	R13811122	6	. Capscrew	92	219392	7'	. Loom, Auto
33	R13042	10	. Flat Washer	93	209578	8	. Clamp
34	R13809066	2	. Lockwasher	94	R1939857	6	. Bracket
35	203274	2	. Shutoff Valve	95	579536	1	. Bar, Mtg
36	12930006	2	. Fitting	96	236805	10	. Capscrew
37	230776	2	. Capscrew	97	R13801005	10	. Lockwasher
38	R13806980	4	. Flat Washer	98	234177	2	. Capscrew
39	237567	12	. Nut, Esna	99	223871	2	. Lockwasher
40	249309	1	. Compressor	100	219404	2'	. Wire
42	249450	2	. Hose Assembly	101	228776	3	. Terminal Ring
43	R13801909	1	. Capscrew	102	203341	1	. Terminal Ring
44	223587	1	. Nut, Esna	103	243553	1	. Fitting
45	R13090	1	. Capscrew	104	200247	3	. Terminal Ring
46	578732	1	. Fitting	105	219435	2'	. Wire
47	R13811036	4	. Capscrew	106	219408	1'	. Wire
48	R13801813	4	. Capscrew	107	229301	1	. Relay
49	234588	8	. Capscrew	108	209589	2	. Clamp
50	R13811077	4	. Capscrew	109	579526	1	. Fitting
51	00120396	14	. Flat Washer	110	229449	1	. Kit, Split Flange
52	233477	8	. Lockwasher	112	221314	2	. Stud, Weld
53	R13812665	8	. Hard Washer	113	209490	1	. Fitting
54	223794	1	. Fitting	114	239938	2	. Fitting
55	221186	1	. Fitting	115	220095	1	. Fitting
56	203519	1	. O-Ring	116	211560	1	. Fitting
57	201635	5	. Capscrew	117	223436	1	. Fitting
58	230596	2	. Capscrew	118	248624	1	. Fitting
59	223909	4	. Lockwasher	119	581283	1	. Angle, LH
60	14857	4	. Fitting, Ff	120	581282	1	. Angle, RH
61	11740	1	. Kit, Split Flange	121	209752	1	. Fitting
	201615	4	. Capscrew	122	224202	4	. Nut, Esna
	203446	1	. O-Ring	123	214130	2	. Fitting
	209536	2	. Clamp Half	124	203056	1	. Draincock
62	217657	1	. Fitting, Ff	125	209068	1	. Fitting

Power Unit (continued)

Item	Part No.	Qty	Description	Item	Part No.	Qty	Description
126	250496	1	. Hose Assembly				
127	209413	1	. Fitting				
128	26838	1	. Fitting				
129	209406	2	. Fitting				
131	579242	2	. Bracket				
132	579325	2	. Lifting Eye				
133	* 580644	1	. Engine Oil Fill				
134	* 580646	1	. Dipstick & Hsg Assembly				
136	* 248990	1	. Pump				
137	250404	1	. Outlet, Water Connector				
138	581158	1	. Shim				
139	247230	1	. Belt, Serpentine				
140	209619	1	. Fitting				
141	210011	1	. Fitting				
142	210084	1	. Fitting				

* See Separate Coverage

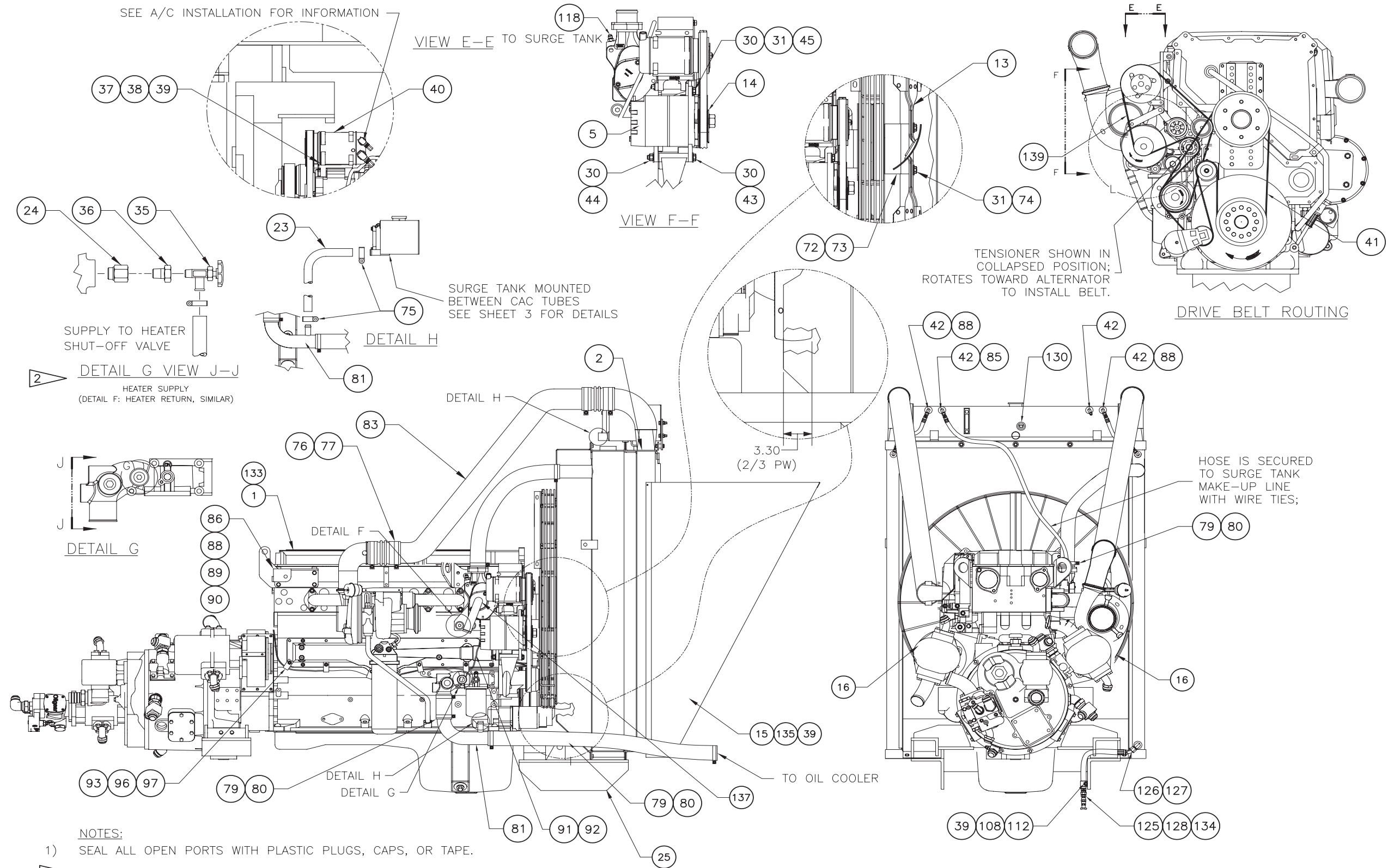

NOTES:

- 1) SEAL ALL OPEN PORTS WITH PLASTIC PLUGS, CAPS, OR TAPE.
- 2) REFER TO THE UNIT MASTER SHEET FOR THE CAB HEATER/AIR CONDITIONER PARTS LIST FOR CONTINUATION OF PLUMBING.
- 3) **CAUTION:** NO LINES OTHER THAN THE VENT LINES ARE TO BE PLUMBED TO THE TOP TANK OR ENGINE VENT PORTS. THESE LINES ARE NOT TO RISE ABOVE THE RADIATOR VENT PORTS OR HAVE ANY LOOPS THAT COULD TRAP AIR.
- 4) INSTALL PUMP (ITEM 15) WITH CASE DRAIN ORIENTED UP
- 5) FOR CLARITY, SUPPORTS, FITTINGS AND CONNECTIONS ARE NOT SHOWN IN ALL VIEWS;

