

Power Unit

## Power Unit

Item	Part No.	Qty	Description	Item	Part No.	Qty	Description
	<b>580464</b>		<b>Power Unit</b>				
1	* 249705	1	. Engine	57	201635	6	. Capscrew
2	* 246855	1	. Radiator W/Cac	58	230596	3	. Capscrew
3	* 239794	1	. Converter	60	14857	1	. Fitting, Ff
4	570775	1	. Ring Gear Assembly	61	11767	4	. Kit, Split Flange
	237315	96	.. Washer, Bellville		209537	2	.. Clamp Half
	237316	24	.. Nut		222379	4	.. Capscrew
	570735	1	.. Ring Gear	62	217657	1	. Fitting, Ff
	570776	24	.. Stud	63	14274	3	. Fitting
5	* 234183	1	. Alternator	64	210011	1	. Fitting
6	239979	1	. Bracket, Adapter	65	210084	2	. Fitting
7	529449	1	. Wire Assembly,Grnd	66	211693	3	. Fitting, Ff
8	581113	1	. Wire Harness	75	202947	2	. Hose Clamp
9	581137	1	. Wire Harness	76	243488	4	. Connector
10	578953	1	. Wire Harness,Oem	77	243489	8	. Clamp
11	578954	1	. Wire Harness	78	580509	1	. Tube Weldment
13	246987	1	. Fan, 40	79	211791	5'	. Hose, Radiator
14	247024	1	. Pulley, Alternator	80	232881	8	. T-Bolt Clamp
15	580587	1	. Air Scoop Weldment	81	579333	1	. Tube Weldment,Lower Rad
16	* 245289	1	. Pump, Tandem	82	580389	1	. Tube,Alum
17	* 245520	1	. Pump, Hydraulic	83	580390	1	. Tube,Alum
18	539968	2	. Sleeve Rework,Pump	84	580504	2	. Engine Mt Weldment,Rear
21	505499	3	. Gasket	87	R13811123	6	. Capscrew
23	206320	6'	. Hose, Bulk	91	219383	8'	. Wire
24	247072	2	. Fitting	92	219392	7'	. Loom, Auto
25	580421	1	. Engine Mt Weldment	93	209578	8	. Clamp
26	R13811148	2	. Capscrew	96	236805	10	. Capscrew
27	R13811457	4	. Flat Washer	97	R13801005	10	. Lockwasher
28	224194	2	. Nut, Esna	98	234177	2	. Capscrew
29	R13811075	12	. Capscrew	99	223871	2	. Lockwasher
30	R13811451	8	. Flat Washer	100	219404	2'	. Wire
31	R13812516	20	. Lockwasher	101	228776	3	. Terminal Ring
32	R13811122	6	. Capscrew	102	203341	1	. Terminal Ring
33	R13042	10	. Flat Washer	104	200247	3	. Terminal Ring
34	R13809066	16	. Lockwasher	105	219435	2'	. Wire
35	203274	2	. Shutoff Valve	106	219408	1'	. Wire
36	12930006	2	. Fitting	107	229301	1	. Relay
37	R13811037	4	. Capscrew	111	23390	2	. Kit, Split Flange
38	R13806980	4	. Flat Washer		201621	4	.. Capscrew
39	R13802575	4	. Lockwasher		203523	1	.. O-Ring
40	249309	1	. Compressor		209539	2	.. Clamp Half
43	R13801909	1	. Capscrew	114	239938	2	. Fitting
44	223587	1	. Nut, Esna	115	220095	1	. Fitting
45	R13090	1	. Capscrew	117	223436	1	. Fitting
46	209420	1	. Fitting	118	248624	1	. Fitting
47	R13811033	8	. Capscrew	119	580395	1	. Angle,Lh
48	234588	4	. Capscrew	120	580396	1	. Angle,Rh
49	233477	4	. Lockwasher	121	209752	1	. Fitting
50	R13812665	4	. Hard Washer	129	209406	4	. Fitting
51	00120396	14	. Flat Washer	131	* 248990	1	. Pump
52	209805	1	. Fitting	132	226184	1	. Gasket
53	209490	1	. Fitting	133	579242	2	. Bracket
54	223794	1	. Fitting	134	579325	2	. Lifting Eye
55	221186	1	. Fitting	135	* 580644	1	. Engine Oil Fill
56	203528	1	. O-Ring	136	* 580976	1	. Dipstick & Hsg Assembly

\* See Separate Coverage

**NOTES:**

- 1) SEAL ALL OPEN PORTS WITH PLASTIC PLUGS, CAPS, OR TAPE.
- 2) REFER TO THE UNIT MASTER SHEET FOR THE CAB HEATER/AIR CONDITIONER PARTS LIST FOR CONTINUATION OF PLUMBING.
- 3) CAUTION: NO LINES OTHER THAN THE VENT LINES ARE TO BE PLUMBED TO THE TOP TANK OR ENGINE VENT PORTS. THESE LINES ARE NOT TO RISE ABOVE THE RADIATOR VENT PORTS OR HAVE ANY LOOPS THAT COULD TRAP AIR.
- 4) INSTALL PUMP (ITEM 131) WITH CASE DRAIN ORIENTED UP
- 5) FOR CLARITY, SUPPORTS, FITTINGS AND CONNECTIONS ARE NOT SHOWN IN ALL VIEWS;

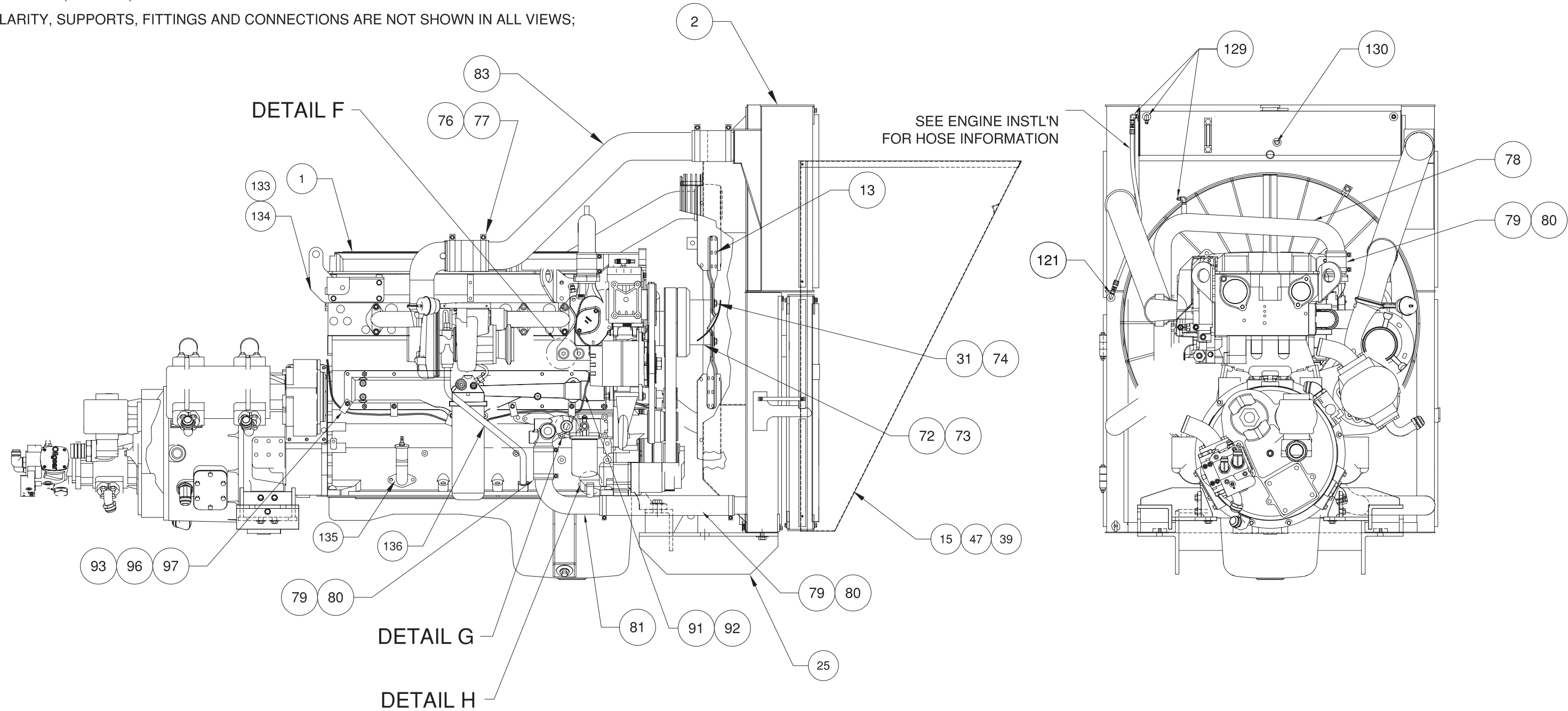

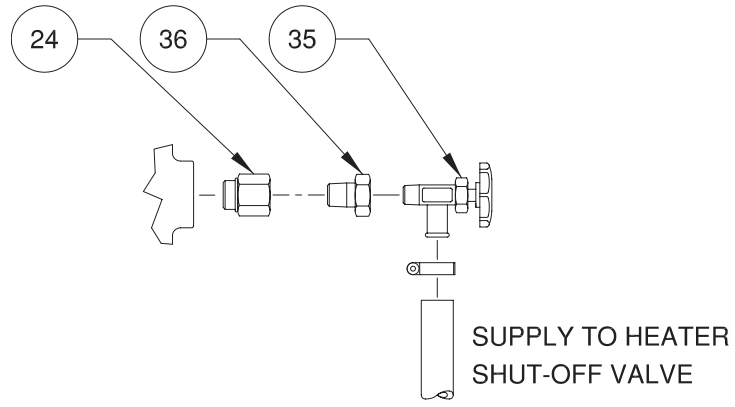

**2** **DETAIL G VIEW J-J**  
HEATER SUPPLY  
(DETAIL F: HEATER RETURN, SIMILAR)

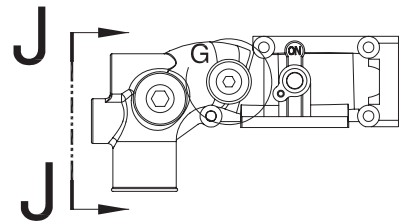

**DETAIL G**

