

Power Unit

Power Unit

Item	Part No.	Qty	Description	Item	Part No.	Qty	Description
	580051		Power Unit				
1	* 246810	1	. Engine	61	11740	1	. Kit, Split Flange
2	* 578949	1	. Radiator Assembly		134328W	4	.. Capscrew
3	* 248962	1	. Converter		201568	4	.. Lockwasher
4	570775	1	. Ring Gear Assembly		203446	1	.. O-Ring
	237315	96	.. Washer, Bellville		209536	2	.. Clamp Half
	237316	24	.. Nut	62	217657	1	. Fitting
	570735	1	.. Ring Gear	63	209997	1	. Fitting
	570776	24	.. Stud	64	225057	1	. Fitting
5	* 234183	1	. Alternator	65	209714	2	. Fitting
6	a 249708	2	. Gasket	66	211693	1	. Fitting
7	529449	1	. Wire Assembly	67	229450	2	. Kit, Split Flange
8	578951	1	. Wire Harness		00103325	4	.. Washer
9	578952	1	. Wire Harness		203516	1	.. O-Ring
10	578953	1	. Wire Harness		234893	4	.. Capscrew
11	578954	1	. Wire Harness		236974	2	.. Clamp Half
12	246908	1	. Sensor, Tempiture	68	201458	1	. Fitting
13	246987	1	. Fan, 40	69	12721	1	. Kit, Split Flange
14	247024	1	. Pulley, Alternator		200604	4	.. Washer
15	* 247026	1	. Pump		203519	1	.. O-Ring
16	*a 247027	1	. Pump		209538	2	.. Clamp Half
17	* 247028	1	. Pump		222379	4	.. Capscrew
18	a 539968	2	. Sleeve, Pump	70	134328W	12	. Capscrew
19	240144	1	. Adapter, Pump	71	201568	12	. Lockwasher
20	240145	1	. Sleeve Assembly	72	247256	1	. Spacer
21	505499	3	. Gasket	73	247257	1	. Spacer
22	27360	1	. Gasket	74	R13811086	6	. Capscrew
23	206320	6'	. Hose, Bulk	75	202947	2	. Hose Clamp
24	247072	2	. Fitting	76	243488	4	. Connector
25	579082	1	. Engine Mount	77	243489	8	. Clamp
26	221657W	2	. Capscrew	78	580509	1	. Tube
27	R13811457	4	. Washer	79	211791	5'	. Hose, Radiator
28	224194	2	. Nut, Esna	80	232881	8	. T-Bolt Clamp
29	200454W	12	. Capscrew	81	579333	1	. Tube, Lower Rad
30	R13811451	8	. Washer	82	579243	1	. Tube, Charge Air
31	R13812516	20	. Lockwasher	83	579244	1	. Tube, Charge Air
32	Y17C-1028	6	. Capscrew	84	579135	1	. Engine Mount, LH Rear
33	R13042	10	. Washer	85	579136	1	. Engine Mount, RH Rear
34	R13809066	16	. Lockwasher	86	579242	2	. Bracket
35	203274	2	. Shutoff Valve	87	Y17C-1032	6	. Capscrew
36	12930006	2	. Fitting	88	579325	2	. Lifting Eye
37	249393	2	. Mount, Isolator	89	293647W	8	. CAPSCREW
41	247230	1	. Belt, Serpentine	90	233477	8	. Lockwasher
43	R13801909	1	. Capscrew	91	219383	8'	. Wire
44	223587	1	. Nut, Esna	92	219392	7'	. Loom, Auto
45	221560W	1	. Capscrew	93	209578	8	. Clamp
46	578732	1	. Fitting	94	R1939857	6	. Bracket
47	a 223784	2	. Fitting	95	579536	1	. Bar, Mounting
48	209112	1	. Fitting	96	236805	10	. Capscrew
49	Y17C-1024	4	. Capscrew	97	R13801005	10	. Lockwasher
50	R13811077	4	. Capscrew	98	224120W	2	. Capscrew
51	00120396	14	. Washer	99	223871	2	. Lockwasher
52	R13811042	2	. Capscrew	100	219404	2'	. Wire
53	205128	2	. Lockwasher	101	228776	3	. Terminal Ring
54	580488	1	. Fitting	102	203341	1	. Terminal Ring
55	221186	1	. Fitting	103	243553	1	. Fitting
56	203519	1	. O-Ring	104	200247	3	. Terminal Ring
57	200454W	6	. Capscrew	105	219435	2'	. Wire
58	R13811082	3	. Capscrew	106	219408	1'	. Wire
59	223909	4	. Lockwasher	107	229301	1	. Relay
60	14857	1	. Fitting	108	579554	1	. Fitting
				109	579526	1	. Fitting

Power Unit

Item	Part No.	Qty	Description	Item	Part No.	Qty	Description
110	229449	1	. Kit, Split Flange				
	200604	4	.. Washer	117	223436	1	. Fitting
	203446	1	.. O-Ring	118	248624	1	. Fitting
	225328	2	.. Clamp Half	119	580049	1	. Angle, RH
	230961	4	.. Capscrew	120	580050	1	. Angle, LH
111	23390	2	. Kit, Split Flange	121	209752	1	. Fitting
	200604	4	.. Washer	122	224202	4	. Nut, Esna
	201621	4	.. Capscrew	123	214130	2	. Fitting
	203523	1	.. O-Ring	124	558406	1	. Bracket
	209539	2	.. Clamp Half	125	00102637	2	. Hex Nut
112	a 209715	2	. Fitting	126	218092	1	. Rod End
113	223929	1	. Fitting	127	R1935313	1	. Spacer
114	239938	2	. Fitting	128	00114505	2	. Jam Nut
115	220095	1	. Fitting	129	209406	4	. Fitting
116	211560	1	. Fitting	130	246916	1	. Sensor, Coolant Level

* See Separate Coverage

a If PVG130 to PVM130 Refit Kit is installed, see 582160 in Hydraulic System Section

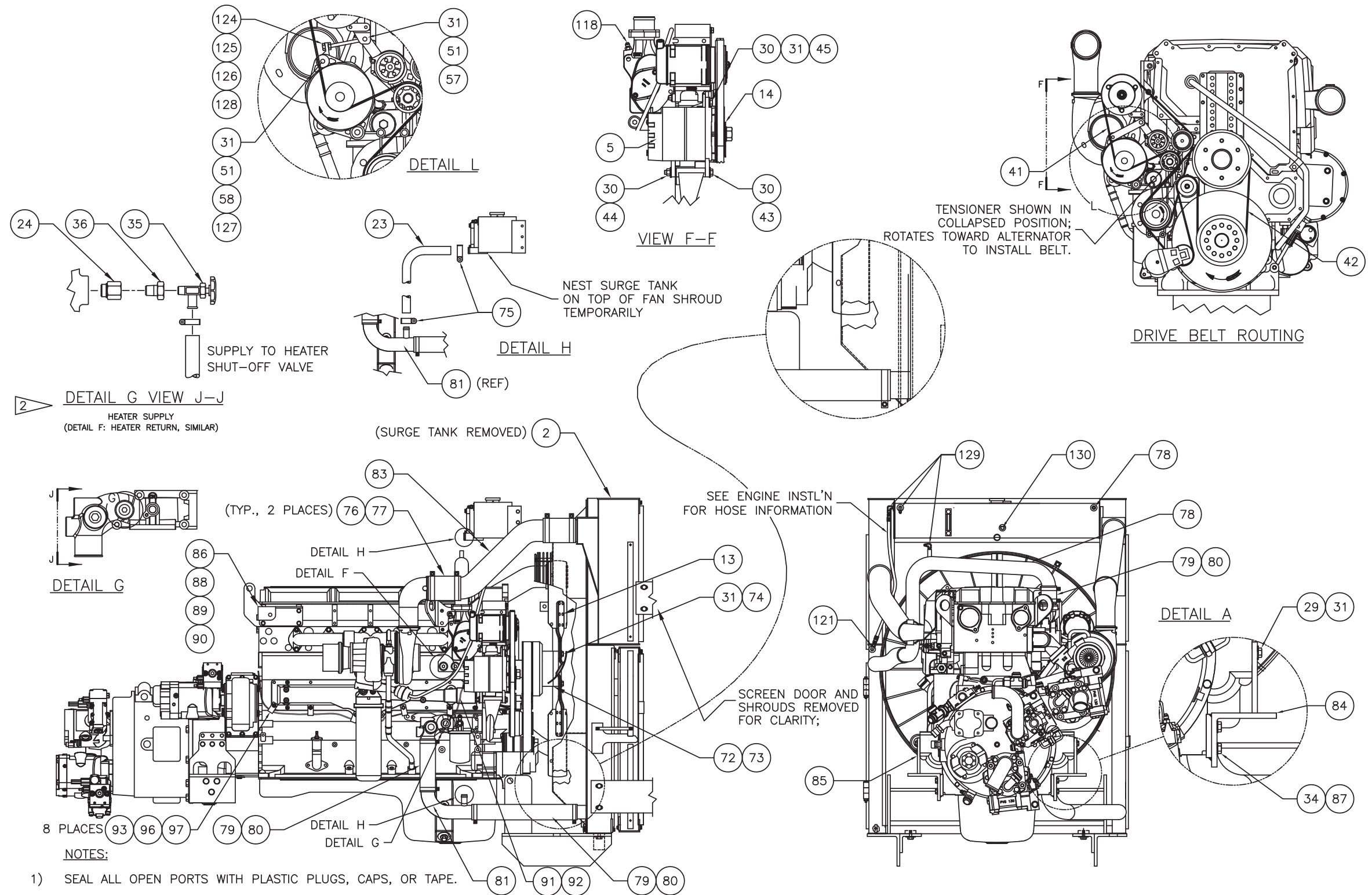

2 **DETAIL G VIEW J-J**
HEATER SUPPLY
(DETAIL F: HEATER RETURN, SIMILAR)

DETAIL H
NEST SURGE TANK
ON TOP OF FAN SHROUD
TEMPORARILY

TENSIONER SHOWN IN
COLLAPSED POSITION;
ROTATES TOWARD ALTERNATOR
TO INSTALL BELT.

DRIVE BELT ROUTING

SEE ENGINE INSTL'N
FOR HOSE INFORMATION

SCREEN DOOR AND
SHROUDS REMOVED
FOR CLARITY;

NOTES:

- 1) SEAL ALL OPEN PORTS WITH PLASTIC PLUGS, CAPS, OR TAPE.
- 2) REFER TO THE UNIT MASTER SHEET FOR THE CAB HEATER/AIR CONDITIONER PARTS LIST FOR CONTINUATION OF PLUMBING.
- 3) **CAUTION:** NO LINES OTHER THAN THE VENT LINES ARE TO BE PLUMBED TO THE TOP TANK OR ENGINE VENT PORTS. THESE LINES ARE NOT TO RISE ABOVE THE RADIATOR VENT PORTS OR HAVE ANY LOOPS THAT COULD TRAP AIR.
- 4) INSTALL PUMP (ITEM 15) WITH CASE DRAIN ORIENTED UP
- 5) FOR CLARITY, SUPPORTS, FITTINGS AND CONNECTIONS ARE NOT SHOWN IN ALL VIEWS;

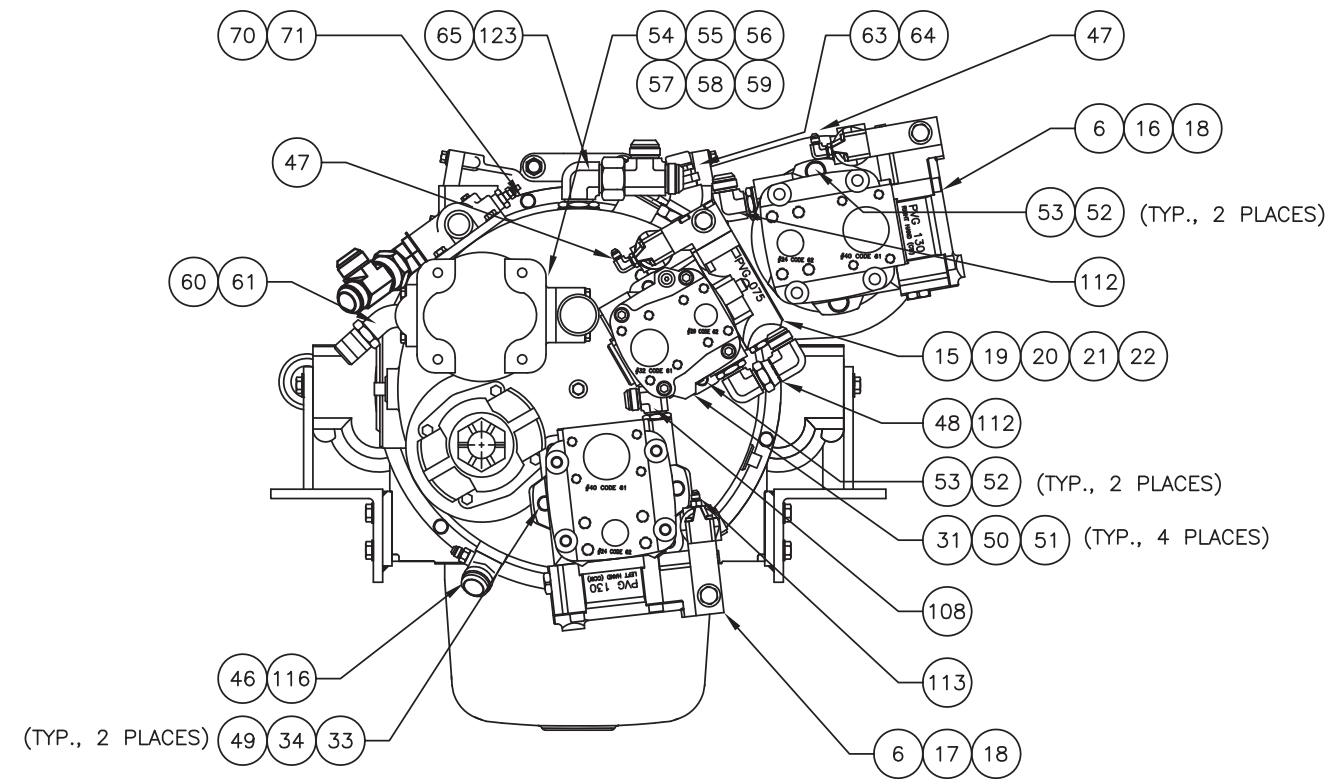

VIEW G-G

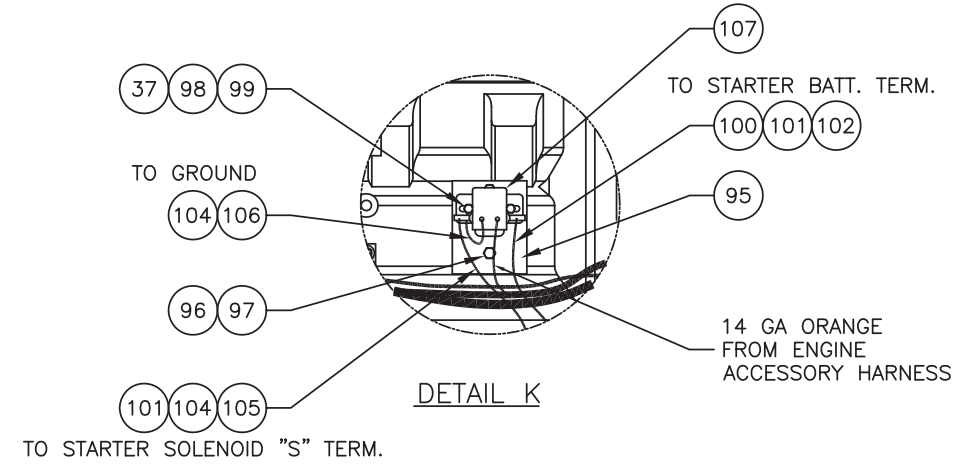
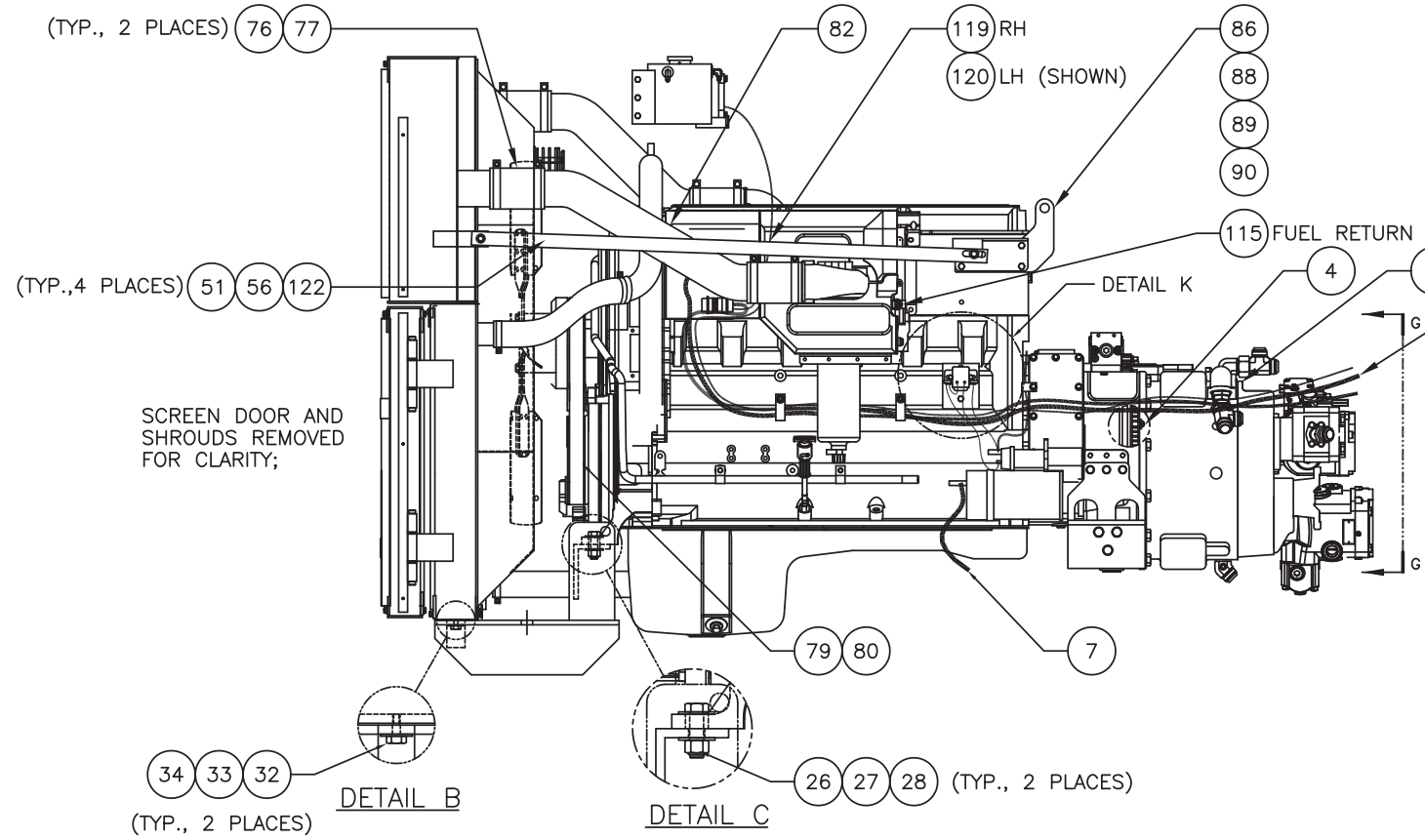

DETAIL K

