

Power Unit

Power Unit

Item	Part No.	Qty	Description	Item	Part No.	Qty	Description
	575082		Power Pack				
1	* 241503	1	. Engine	59G	240325	4	.. Capscrew
2	568177	2	. Engine Mount, Front	59H	203703	2	.. Washer
3	223692	8	. Capscrew	59I	240403	2	.. Capscrew
4	223694	8	. Lockwasher	60	210769	1	. Fitting
5	568172	1	. Engine Mount, Rear	61	14857	1	. Fitting
6	Y17C-1236	2	. Capscrew	62	225129	2	. Fitting
7	00103346	8	. Flat Washer	63	* 240176	1	. Pump, Front Section
8	223188	6	. Locknut	64	11740	2	. Kit, Split Flange
9	232417	1	. Fan		134328W	4	.. Capscrew
16	568883	1	. Bracket		201568	4	.. Lockwasher
17	224653	1	. Spring		203446	1	.. O-Ring
18	224253	1	. Cable, Pivot		209536	2	.. Clamp Half
19	00103362	1	. Cotter Pin	65	225661	2	. Kit, Split Flange
20	575270	1	. Bracket		200607	4	.. Lockwasher
21	226959	1	. Kit, Cable Clamp		203528	1	.. O-Ring
22	19122	1	. Fitting		229082	4	.. Capscrew
23	209411	1	. Fitting		230769	2	.. Clamp Half
24	215689	1	. Hose Assembly	66	560221	2	. Fitting
25	Y17C-0624	3	. Capscrew	67	209500	1	. Fitting
26	223654	3	. Locknut	68	209490	1	. Fitting
27	209413	3	. Fitting	69	* 568550	1	. Radiator Assembly
28	212225	1	. Hose Assembly	70	562104	2	. Pad
29	209589	3	. Clamp	71	00103325	2	. Lockwasher
30	203274	2	. Shutoff Valve	72	00106267	2	. Flat Washer
31	209505	1	. Fitting	73	Y17C-1032	1	. Capscrew
32	215391	1	. Fitting	74	562100	1	. Shroud, Radiator
33	217494	1	. Fitting	75	556710	2	. Stop, Axle
34	208928	1	. Hose Assembly	76	221569W	6	. Capscrew
35	236395	1	. Cable	77	523605	2	. Connector Assembly, Rad Top
36	236412	2	. Oil Press Sender	78	506669	2	. Gasket
37	236410	1	. Sender, Oil Temp	79	223909	4	. Lockwasher
38	557037	3	. Spacer, Fan	80	211791	5'	. Hose, Radiator
39	* 235291	1	. Converter	81	225369	4	. T-Bolt Clamp
40	134328W	12	. Capscrew	82	223872	4	. Tie Strap
41	201568	12	. Lockwasher	83	207848	1	. Hose Assembly
42	209714	1	. Fitting	84	209921	1	. Fitting
43	209167	1	. Fitting	85	212194	1	. Fitting
44	209401	1	. Fitting	86	211807	3'	. Hose, Radiator
45	209997	1	. Fitting	87	207146	4	. T-Bolt Clamp
46	225057	1	. Fitting	88	557055	1	. Tube, Coolant Fill
47	223794	1	. Fitting	89	211398	1	. Draincock
48	203519	1	. O-Ring	90	209512	2	. Fitting
49	222379	8	. Capscrew	91	225829	5'	. Hose, Radiator
50	200604	14	. Lockwasher	92	201431	2	. Hose Clamp
51	00112595	2	. Capscrew	93	236411	1	. Sender, Water Temp
52	221186	1	. Fitting	94	216102	1	. Alarmstat
53	209805	1	. Fitting	95	00144046	1	. Bushing, Reducer
54	11767	1	. Kit, Split Flange	96	* 234183	1	. Alternator
	200604	4	.. Washer	97	221560W	2	. Capscrew
	203516	1	.. O-Ring	99	529449	1	. Wire Assembly, Ground
	209537	2	.. Clamp Half	100	568927	1	. Wire Assembly, Ground
	222379	4	.. Capscrew	101	222663	1	. Pressure Stat
55	* 237947	1	. Pump	102	568938	1	. Wiring Harness, 24V Engine
56	539968	2	. Sleeve, Pump	103	228784	1	. Sensor, Magnetic Speed
57	505499	2	. Gasket	108	234497	4	. Vibration Dampener
58	239790	1	. Pump	109	557376	8	. Flat Washer
	245973	1	.. Seal Kit	110	00271618	4	. Capscrew
59	574806	1	. Kit, Pump Mounting	138	570775	1	. Ring Gear Assembly
59A	240311	1	.. Dowel	139	570735	1	.. Ring Gear
59B	240324	1	.. Coupling	140	570776	24	.. Stud
59C	*a 240312	1	.. Gasket	141	237315	96	.. Washer, Bellville
59D	*a 240313	A/R	.. Shim	142	237316	24	.. Nut
59E	*a 226184	1	.. Gasket	143	-----	1	. Backing Plate - See Converter 3-2
59F	574802	1	.. Plate, Mounting				

* See Separate Coverage

*a Included in 240313 Kit, Pump Mounting

A/R As Required

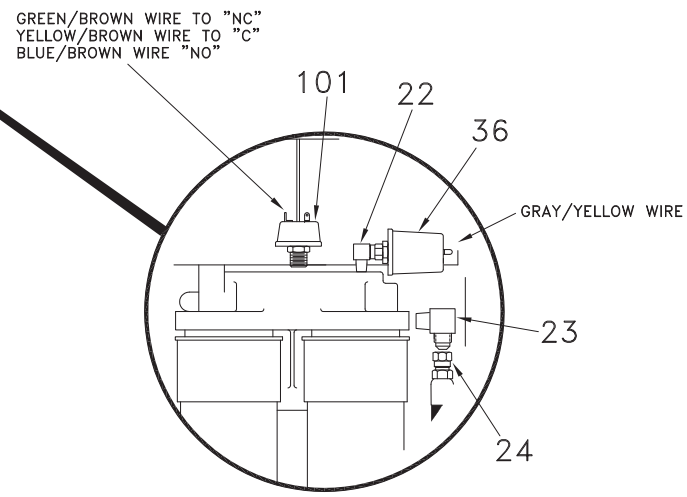
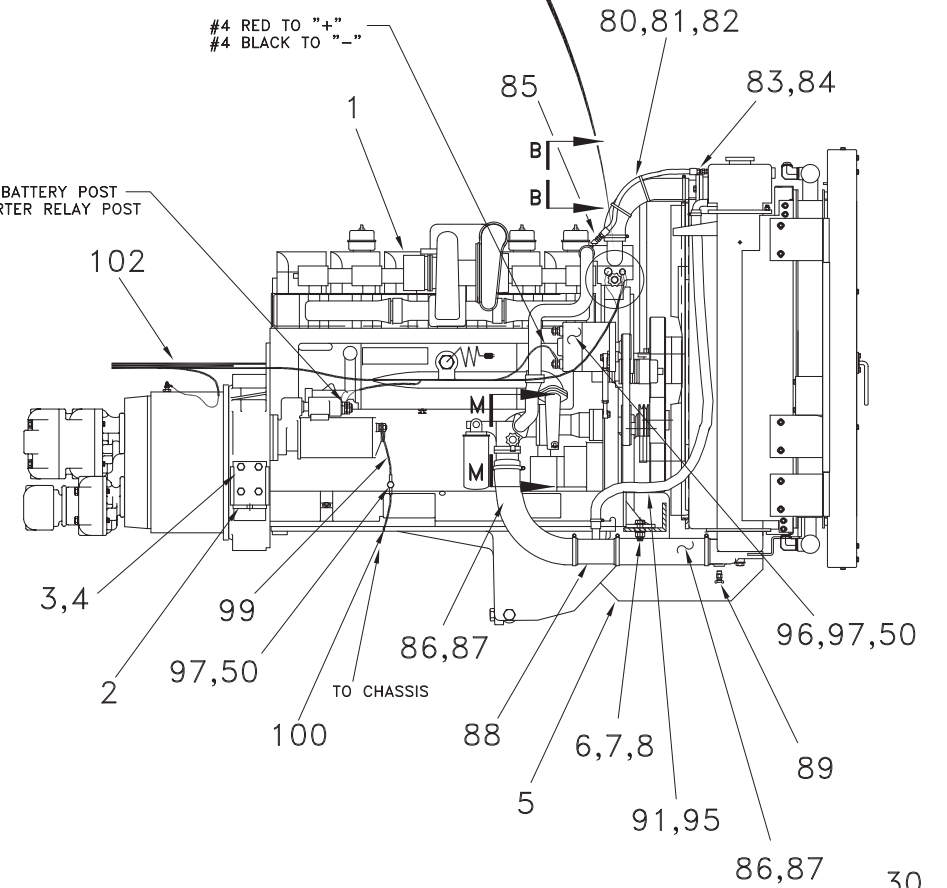
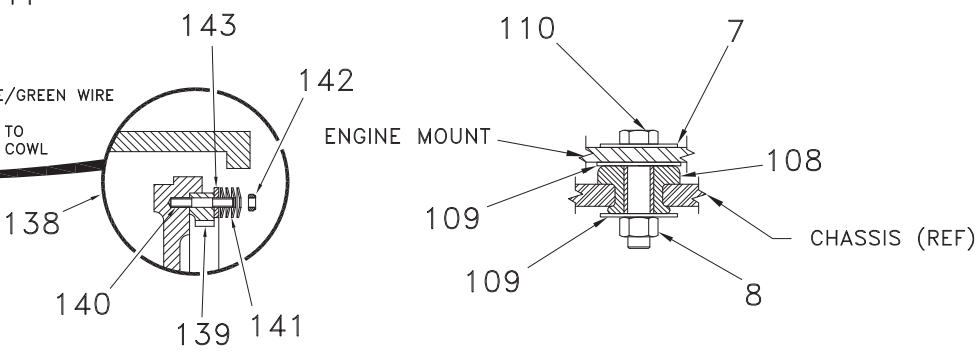
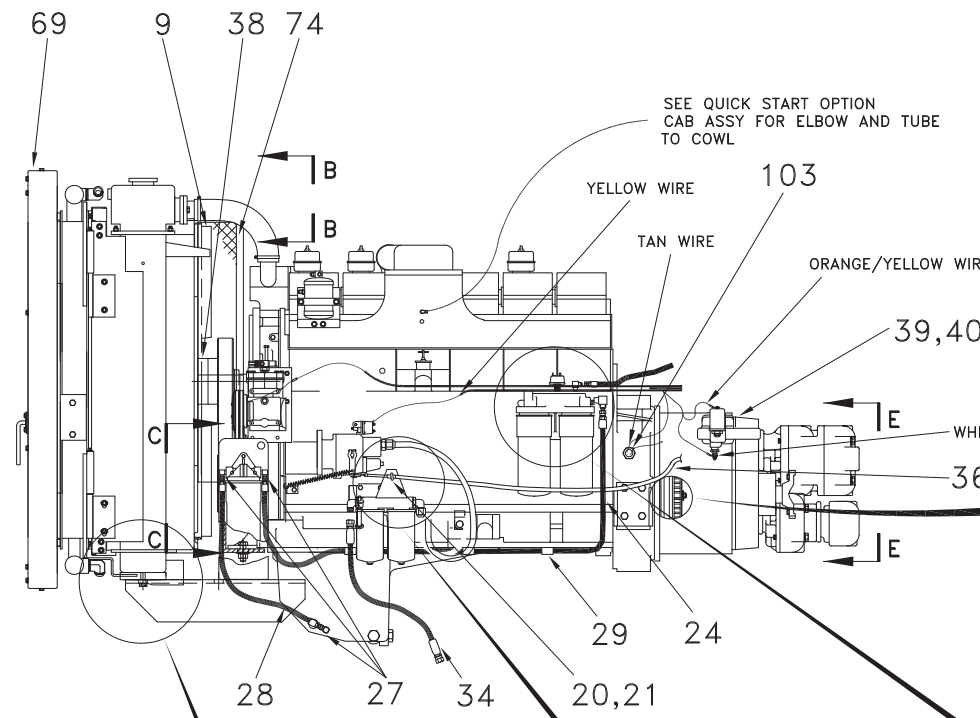
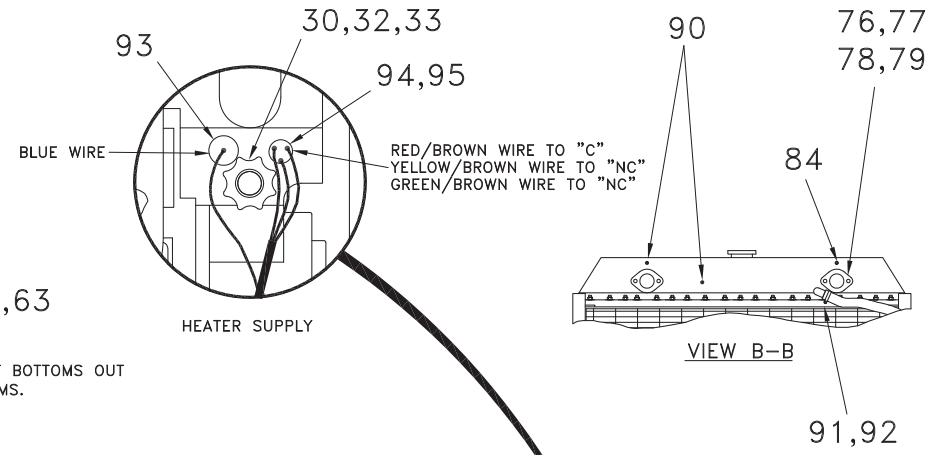
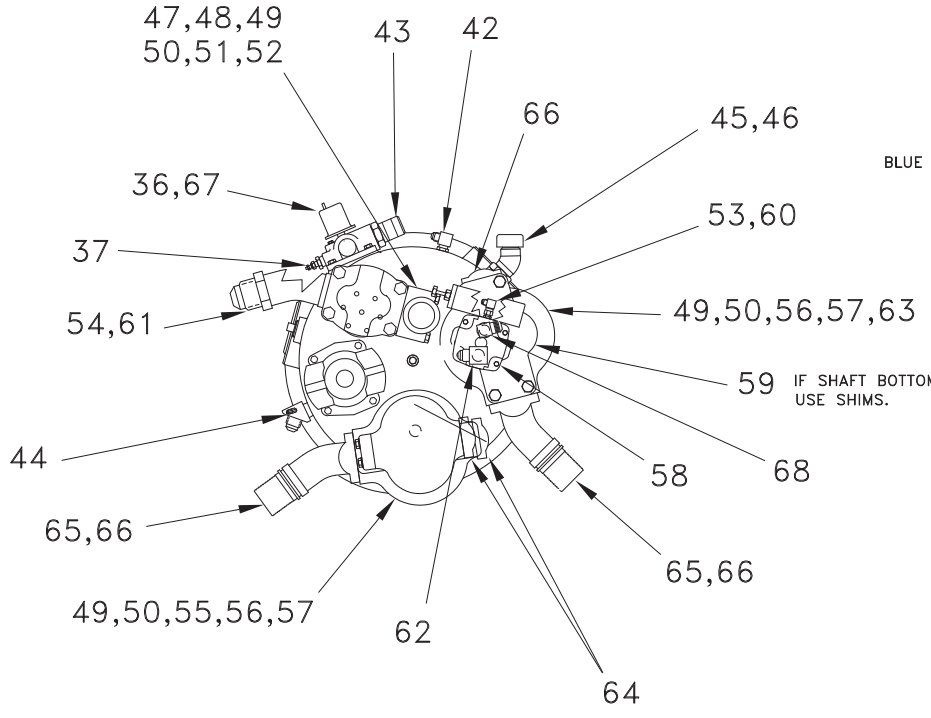
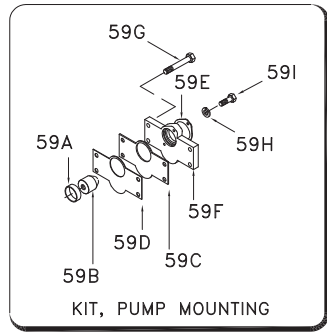
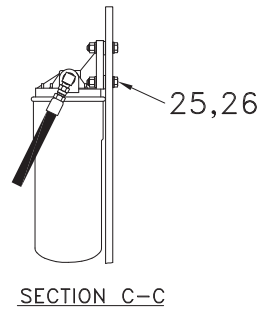

- RING GEAR INSTALLATION PRODEURE**
- REMOVE ALL BURRS FROM FLYWHEEL MOUNTING FACE AND PILOT BORE, AND CLEAN WITH SOLVENT. CHECK ENGINE CRANKSHAFT "END PLAY". INDICATOR READING MUST BE THE SAME BEFORE AND AFTER THE TORQUE CONVERTER IS MOUNTED TO THE ENGINE.
 - INSTALL (3) STUDS (ITEM 140) EQUALLY SPACED. TORQUE TO 33-36 LB-FT [4.6 - 5.0 KG-M].
 - INSTALL RING GEAR (ITEM 139) BY TAPPING LIGHTLY INTO PLACE.
 - INSTALL REMAINING STUDS, TORQUE TO 33-36 LB-FT [4.6 - 5.0 KG-M].
 - LUBRICATE STUD THREADS, BELLEVILLE WASHERS AND NUTS WITH SAE #10 OIL.
 - INSTALL BACKING RING (ITEM 143), BELLEVILLE WASHERS (ITEM 141), AND ELASTIC STOP NUTS (ITEM 142) AS SHOWN. TORQUE NUTS 45 LB-FT [6.2 KG-M].

