

DATE: June 1, 2010

BULLETIN NO. _____ PMB1007

PAGE: 1 of 1

MODEL(S): CHD100 – Serial Numbers 103240 thru 103288

SECTION: _____ 8-1 (Frames & Attachments)

ATTENTION: PARTS AND SERVICE MANAGERS

SUBJECT: NEW SERVICE KITS FOR CHD100 SWIVEL BOX & BOGIE AXLE CRADLE

When reinstalling or replacing a swivel box for WAGNER model **CHD100**, ASC strongly recommends that you purchase Kit Part No. **586227** to reduce the potential of a second and expensive tear-down caused by the failure to replace these key components. ASC also offers Kit Part No. **586228** designed for servicing the Bogie Axle Cradle. Both kits have been specially priced at considerably less than the price of the individual components.

Kit Part No. 586227
Swivel Box Service Kit

Includes all the necessary bearings, o-rings, bushings, and thrust washers required to properly reinstall the swivel box (see Figure 1).

Fits **CHD100** Serial Numbers **103240** thru **103288** except **103275** and **103281**.

Kit Part No. 586228
Bogie Axle Cradle Bearing & Seal Kit

Includes all the bearings and o-rings required for proper reinstallation (see Figure 1).

Fits **CHD100** Serial Numbers **103240** thru **103288** except **103242** and **103250**.

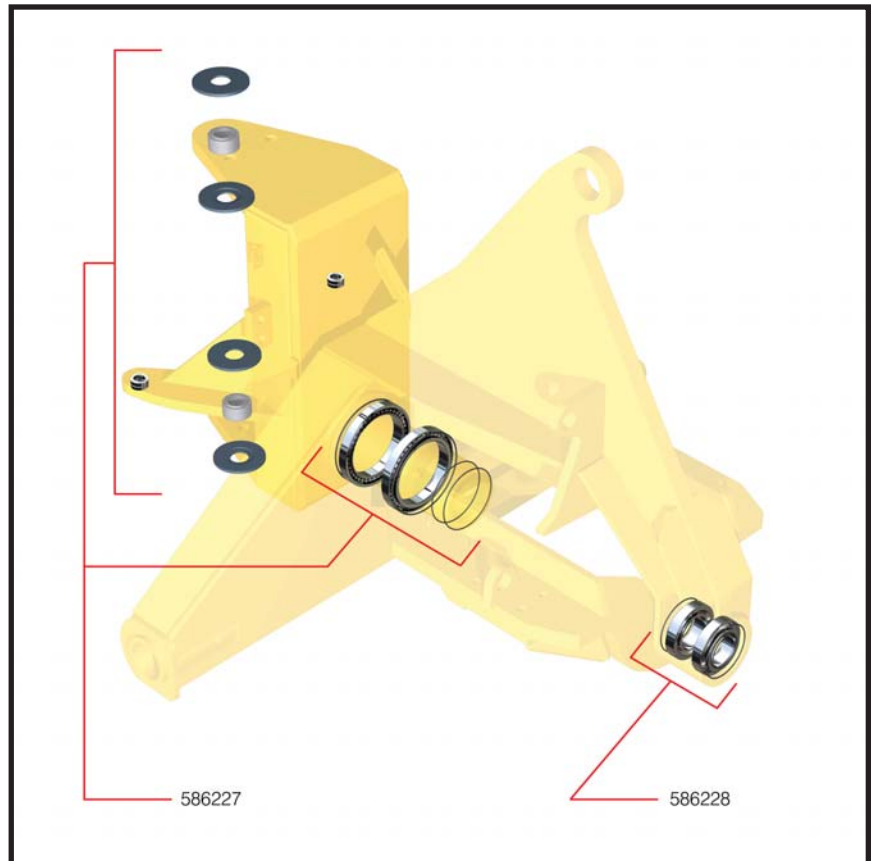

Figure 1. Service Kits

For more information, please contact the ASC Service Parts Department at 503-625-2560.