

DATE: May 31, 2000

BULLETIN NO. \_\_\_\_\_ PMB0002

PAGE: 1 of 3

MODEL(S): \_\_\_\_\_ All

ATTENTION: PARTS AND SERVICE MANAGERS

SECTION: \_\_\_\_\_ 7-2 (Cab & Cowl)

SUBJECT: INSTRUMENT PANEL SWITCH COMPONENTS

It has been brought to our attention that there has been some confusion over the replacement components for various instrument panel switches. This bulletin lists the most commonly used switch components in most Allied machines (refer to Figure 1 below, Table 1 on page 3 and Table 2 on page 3). Please note that because of the variety of switches, the illustrations are generic and are meant to be used for reference purposes only.

Lens/Symbol (Please Refer to Table 1 on Page 2)

Part No.	Description
236502	Lamp, Pilot (24V) (Incl. Qty. 2 of Light Socket, P/N 234508)

Part No.	Description
R4510235	Lamp (12V)
236901	Lamp (24V)

Part No.	Description
234737	Housing, Socket (With Double-Spring Contact, Not Illust.)
234738	Housing, Socket

Part No.	Description
234505	Frame, End Piece

Part No.	Description
234508	Socket, Light 24V (Incl. Lamp, P/N 236901)
237187	Socket, Light 12V (Incl. Lamp, P/N R4510235)

Part No.	Description
234740	Frame, Mounting (3-Bank)
236485	Frame, Mounting (6-Bank, Not Illust.)

Part No.	Description
236501	Frame, Intermediary Piece

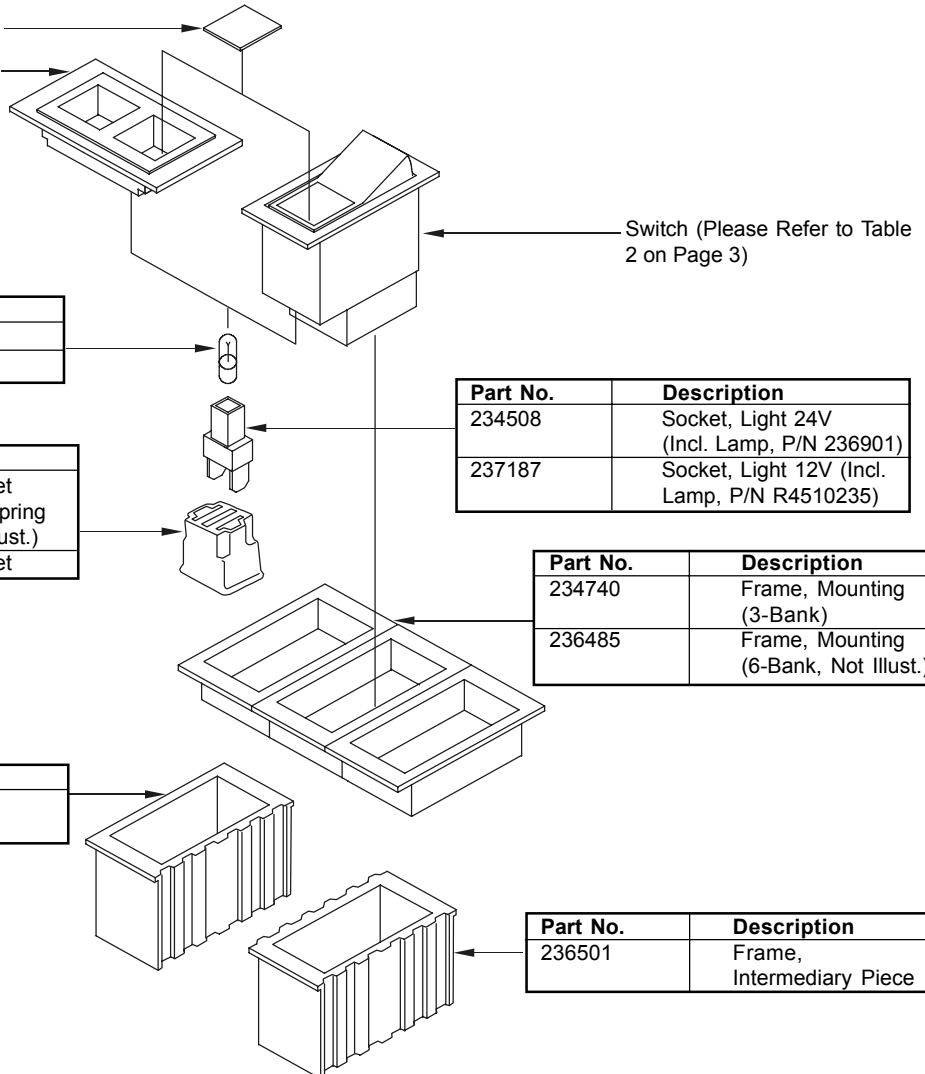

Figure 1

<b>Part No.</b>	<b>Description</b>
234507	Symbol, Fan
234741	Symbol, Side Lamp
234742	Symbol, Rear Lamp
234743	Symbol, Rotary Beacon (Green)
234846	Symbol, Cooling
236121	Symbol, Wiper (Normal Mounting)
236486	Symbol, Light Front
236487	Symbol, Washer (180° Mounting)
236503	Lens, Red
236504	Lens, Green
236507	Lens, Rotary Beacon (Yellow/White)
237346	Lens, Yellow
237494	Symbol, Out-Of-Gear (Red)
237495	Symbol, Out-Of-Gear (Yellow/Black)
237683	Symbol, Dome Light
238213	Symbol, Horn
240964	Symbol, Switch
243472	Symbol, Window Controls
R11172	Symbol, Washer (Normal Mounting)
R11173	Symbol, Wiper (180° Mounting)
R11174	Symbol, Light
R11175	Symbol, Side Marker Lamps
R11177	Symbol, Interior Light
R11178	Symbol, Instrument Lighting
R13674	Symbol, Dif-Lok
R14499	Symbol, Declutch
R15512	Symbol, Ether Start
R4510243	Symbol, Declutch

Table 1: Symbols and Lenses

<b>Part No.</b>	<b>Description</b>
234506	Switch, 2-Speed, 24V
234735	Switch, 24V
234736	Switch, 24V
234739	Switch, Dimmer
234745	Switch, 24V
234975	Switch, 2-Speed, 12/24V
236488	Switch, On/Off/On, 24V
236489	Switch, Wiper, 24V
236920	Switch, Wiper, 24V
237681	Switch, Momentary, 24V
237688	Switch, 24V
243249	Switch, Rocker, 24V
R13656	Switch, 24V
R13800	Switch, 24V
R16617	Switch, 3-Way, 12/24V
R4510152	Switch, Light, 12V
R4510187	Switch, Light, 12V
R4610069	Switch, Wiper, 12V
R4610070	Switch, Washer, 12V

Table 2: Switches

NOTE: These switches, with the exception of the Dimmer Switch (P/N 234739) come with either Light Socket Assembly 234508 (24V) or 237187 (12V). Refer to Figure 1 on page 1.