

Long Reach KPR Paper Roll Clamp



Engineered specifically for kraft paper, the Long Reach KPR paper roll clamp provides strength and durability along with design options for your application.

- Perfect for a variety of paper types: newsprint, tissues, uncoated form and printing stocks, packaging, gypsum wallboard facing, and more.
- Fixed or positionable short-arm versions are available. Fixed arm models provide ease of handling for rolls of uniform diameter. Positionable arm models maintain thin arm profiles at all roll diameters.
- 45° short-arm positioning method.
- Exclusive pad protectors shield pad outer surfaces from abrasion, while maintaining a thin, smooth surface to protect adjacent rolls.
- Sure-grip contact pads protect rolls from costly imprints.
- Up-front hydraulics lower the effective thickness of the clamp, while allowing easy access to components while the clamp is still attached to truck.
- Uses large diameter pivot pins with the added protection of heavy-duty, lubricated steel bushings.

KPR Series Coated Paper Roll Clamps

42" Diameter Kraft Paper Rolls, 2 Functions

Model Number	Capacity (lb @ Roll Dia.)	Roll Range (in)	Short Arm	Truck Size (lb) ¹	Weight (lb)	Lost Load AET (in)	HCG (in)	VCG (in)	Rotation Speed	Mount Class
KPR-25RN-F1242	2,500	12-42	Fixed	4,000	985	4.6	6.3	15.4	6.5 ²	II or III
KPR-48RN-F1242	4,800			6,000	995			15.6		

45" Diameter Kraft Paper Rolls, 2 Functions

KPR-25RN-F1645	2,500	16-45	Fixed	4,000	1,005	4.6	6.5	16.1	6.5 ²	II or III
KPR-48RN-F1645	4,800			6,000	1,015		6.6	16.3		
KPR-48RN-P1045	4,800	10-45	Pos. ⁴	6000	1,370		9.0	15.0		
KPR-55RN-F2045	5,500	20-45	Fixed	7,000	1,340	7.5	9.1	15.2	6.5 ²	II or III
KPR-55RN-P1045	5,500	10-45	Pos. ⁴	7,000	1,370		9.0	15.0		

51" Diameter Kraft Paper Rolls, 2 Functions

KPR-20RN-F1651	2,000	16-51	Fixed	3,000	1,030	4.6	7.1	16.1	6.5 ²	II or III
KPR-35RN-F1651	3,500			5,000	1,050			16.3		
KPR-48RN-F2051	4,800	20-51	Fixed	6,000	1,375	7.5	9.7	15.0	6.5 ²	II or III
KPR-48RN-P1051		10-51	Pos. ⁴		1,410		9.6	14.9		
KPR-55RN-F2051	5,500	20-51	Fixed	7,000	1,375	7.5	9.7	15.0	6.5 ²	II or III
KPR-55RN-P1051		10-51	Pos. ⁴		1,410		9.6	14.9		
KPR-77RN-F2451	7,700	24-51	Fixed	10,000	1,860	7.6	9.5	16.7	5.0 ³	III or IV
KPR-77RN-P1051		10-51	Pos. ⁴		1,905			16.2		
KPR-90RN-F1751	9,000	17-5 1	Fixed	12,000	2,750	8.0	8.9	18.0	4.0 ³	III or IV
KPR-90RN-P1551		15-5 1	Pos. ⁴		2,830			17.8		
KPR-12RN-F1551	12,000	15-51	Fixed	15,500		Consult Factory			4.0 ³	IV
KPR-12RN-P1051		10-51	Pos. ⁴							

60" Diameter Kraft Paper Rolls, 2 Functions

KPR-50RN-F2460	5,000	24-60	Fixed	7,000	1,440	7.5	10.5	15.7	6.5 ²	II or III
KPR-50RN-P1060		10-60	Pos. ⁴		1,465			15.4		
KPR-75RN-F2660	7,500	26-60	Fixed	10,000	1,940	7.6	10.2	16.9	5.0 ²	III or IV
KPR-75RN-P1060		10-60	Pos. ⁴		1,985			16.6		
KPR-80RN-F2460	8,000	24-60	Fixed	12,000	2,810	8.0	10.8	17.6	4.0 ²	III or IV
KPR-80RN-P1060		10-60	Pos. ⁴		2,845			17.3		
KPR-90RN-F2460	9,000	24-60	Fixed	13,500	2,975	8.0	10.5	18.4	4.0 ³	IV
KPR-90RN-P1060		10-60	Pos. ⁴		3,010			18.2		
KPR-12RN-F2460	12,000	24-60	Fixed	15,500	3,245	8.4	11.2	19.5	4.0 ³	IV
KPR-12RN-P1060		10-60	Pos. ⁴		3,315			18.9		

¹ Estimated truck size to achieve clamp's rated capacity. Consult the lift truck manufacturer for actual net working capacity.

² Rotation speed rpm @ 12 gpm

³ Rotation speed rpm @ 24 gpm

⁴ Positionable

60" Diameter Kraft Paper Rolls, 2 Functions

Model Number	Capacity (lb @ Roll Dia.)	Roll Range (in)	Short Arm	Truck Size (lb) ¹	Weight (lb)	Lost Load AET (in)	HCG (in)	VCG (in)	Rotation Speed	Mount Class
KPR-50RN-F2460	5,000	24-60	Fixed	7,000	1,440	7.5	10.5	15.7	6.5 ²	II or III
KPR-50RN-P1060		10-60	Pos. ⁴		1,465			15.4		
KPR-75RN-F2660	7,500	26-60	Fixed	10,000	1,940	7.6	10.2	16.9	5.0 ²	III or IV
KPR-75RN-P1060		10-60	Pos. ⁴		1,985			16.6		
KPR-80RN-F2460	8,000	24-60	Fixed	12,000	2,810	8.0	10.8	17.6	4.0 ²	III or IV
KPR-80RN-P1060		10-60	Pos. ⁴		2,845			17.3		
KPR-90RN-F2460	9,000	24-60	Fixed	13,500	2,975	8.0	10.5	18.4	4.0 ³	IV
KPR-90RN-P1060		10-60	Pos. ⁴		3,010			18.2		
KPR-12RN-F2460	12,000	24-60	Fixed	15,500	3,245	8.4	11.2	19.5	4.0 ³	IV
KPR-12RN-P1060		10-60	Pos. ⁴		3,315			18.9		

65" Diameter Kraft Paper Rolls, 2 Functions

KPR-75RN-F3065	7,500	30-65	Fixed	10,000	2,010	7.6	11.2	18.3	5.0 ²	III or IV
KPR-75RN-P1565		15-65	Pos. ⁴		2,060			17.8		
KPR-90RN-F3065	9,000	30-65	Fixed	13,500	3,115	8.0	10.5	19.1	4.0 ³	IV
KPR-90RN-P1765		17-65	Pos. ⁴		3,135			18.6		
KPR-11RN-F3265	11,000	32-65	Fixed	15,500		Consult Factory			4.0 ³	IV
KPR-11RN-P1765		17-65	Pos. ⁴							

72" Diameter Kraft Paper Rolls, 2 Functions

KPR-60RN-F3072	6,000	30-72	Fixed	10,000	2,095	7.6	12.1	16.8	5.0 ²	III or IV
KPR-60RN-P1272		12-72	Pos. ⁴		2,140			16.3		
KPR-70RN-F3072	7,000	30-72	Fixed	12,000	2,095	7.6	12.1	16.8	5.0 ²	III or IV
KPR-70RN-P1272		12-72	Pos. ⁴		2,140			16.3		
KPR-85RN-F3272	8,500	32-72	Fixed	13,500	3,130	8.0	12.3	18.9	4.0 ³	IV
KPR-85RN-P1672		16-72	Pos. ⁴		3,190			18.0		
KPR-11RN-F3272	11,000	32-72	Fixed	15,500	3,790	8.4	13.6	20.7	4.0 ³	IV
KPR-11RN-P1672		16-72	Pos. ⁴		3,863			20.2		

84" Diameter Kraft Paper Rolls, 2 Functions

KPR-70RN-F4284	7,000	42-84	Fixed	13,500	3,765	8.4	13.8	19.2	4.0 ³	III or IV
KPR-70RN-P2884		28-84	Pos. ⁴		3,805			18.5		
KPR-95RN-F5084	9,500	50-84	Fixed	15,500	3,795	8.4	14.0	19.3	4.0 ³	IV
KPR-95RN-P2884		28-84	Pos. ⁴		3,835			18.4		

Capacity

Mounting Class	Truck Rating (lb)
II	2,000-5,500
III	6,000-10,000
IV	10,000-15,500

Match attachment capacity to truck rating for most productive operation. Attachment capacity is a structural rating only that includes the general type of paper for which each model of each series is designated. Net truck capacity, with the attachment, must be obtained from the lift truck manufacturer.

Recommended Hydraulic Supply

Model Number	Flow (gpm)	Max psi
KPR-20 - 80	12	2,250
KPR-70 (84" diameter model)	24	2,250
KPR-85/90/95/11/12	24	2,250

Hydraulic flow less than minimum may reduce operating speed and/or cause irregular arm movement. Higher flow may result in heat build-up, erratic operation and shortened hydraulic system life.

Paper Handling Options from Long Reach

CPR Series Coated Paper Roll Clamps

- The strength and durability needed to handle coated paper
- Fixed short-arm models easily handle uniform roll diameters
- Positionable short-arm models for a wide range of roll diameters
- 0° mounting; heavy-duty 360° continuous rotation
- Position-controlled short arm movement

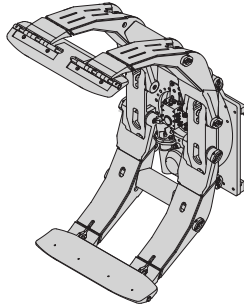

KTR Series Tissue Paper Roll Clamps

- Flared arms and All-Grip pads avoid “bruising” soft tissue rolls
- Fixed short-arm models easily handle uniform roll diameters
- Positionable short-arm models for a wide range of roll diameters
- Up to 84" roll diameters; larger diameters available
- Position-controlled short arm movement

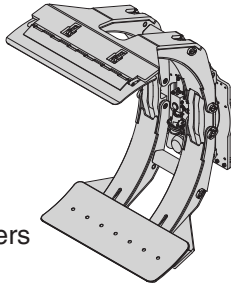

SQ Sliding Arm Paper Roll Clamps

- For break-out in warehouses, trucks, and railcars
- Thin-arm profile over a wide range of roll diameters
- Ideal for use in confined areas, for tunneling and “T” loading
- Rotating and non-rotating models available

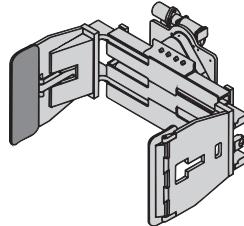

Twin Pack™ Paper Roll Clamps

- Handles 1 or 2 rolls side-by-side
- Clean, grease-free handling — no lube arm slides
- Features ARPAD™ (Automatic Roll Positioning Arm Design)
- Internal sideshift improves maneuverability

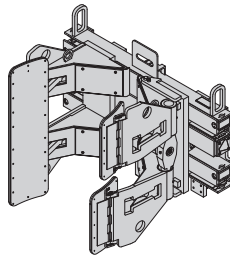

Quad Pack™ Paper Roll Clamps

- Handle 1, 2 or 4 rolls at a time with equal length split arms
- Clean, grease-free handling — no-lube arm slides
- Features ARPAD™ (Automatic Roll Positioning Arm Design)
- Internal sideshift improves maneuverability

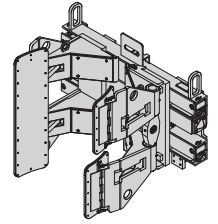

All-In-One Pulp/Paper Clamps

- Interchangeable, slip-on arms for versatility
- Quad and Twin Pack configurations
- Handles pulp bales with pulp bale arms
- Clean, grease-free handling — no-lube arm slides

Broke Paper Clamps

- Firmly grips and holds broke paper on forks while traveling
- Allows excellent operator visibility
- Arms extend fully out of the way to allow normal use of forks
- Quick-change lower hooks included

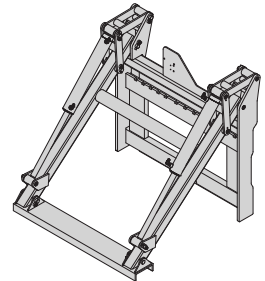

RHC-65 Series Roll Head Clamps (Grappler)

- Positive lever arm clamping force applied to roll
- Adjustable roll ranges and clamping force
- Automatic latch and unlatch
- Flattened, expanded metal pad surface for sure grip

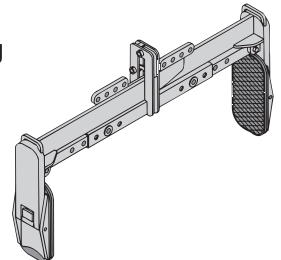

Choose Long Reach for serviceability, value, and custom design

Multi-Pallet Handlers
Fork Positioners
Integral Carriages
Paper Roll Clamps
Lateral Clamps

Carton Clamps
Push-Pulls
Rotators
Custom Design

21433 SW Oregon Street
Sherwood, Oregon 97140-9799 USA
Toll free: (800) 285-7000
Phone: (503) 625-2560
Fax: (503) 625-7269
Email: marketing@alliedsystems.com
www.alliedsystems.com/Longreach

LONG REACH[®]
A Division of Allied Systems Company

87-665 2/18