

Hydraulic Quick Connect Kit Installation

Installation Instructions

The hydraulic quick connect kit 2527912 allows users to easily connect or disconnect lift truck attachment hoses. The coupler is bi-directional, and so may be placed in-line facing either direction.

1. Turn off lift truck. Relieve pressure in the hydraulic circuit to the attachment by cycling the lever back and forth several times.

DANGER

Injection hazard.

Infection and gangrene will result when hydraulic oil penetrates the skin. See a doctor immediately to prevent loss of limb or death.

Use a piece of cardboard to check for hydraulic leaks. Wear personal protective equipment, such as gloves and safety glasses, whenever servicing or checking a hydraulic system.

2. Unscrew hoses from whatever fitting is in use between the truck and the attachment.

3. Locate the quick connect assembly where it will be easily accessible. Screw the fittings (Item 3 or 4) into the coupler (Item 1) and the nipple (Item 2) to suit application.

Note: #6 (Item 3) and #8 (Item 4) O-ring to JIC male-to-male adapters are provided. Only one set will be used.

4. Screw the hose ends onto the quick connect fittings.
5. To connect, pull back on the coupler sleeve and push the nipple into it, then release the sleeve. There will be a click when the connection is made.
6. Before placing the attachment in operation, inspect all hoses and fittings for leaks and to ensure hoses are not kinked or pinched between the truck carriage and attachment.
7. After completing the installation, turn on the truck and operate the attachment without a load for several cycles to remove any air in the hydraulic system. Test the attachment with a load to make sure the attachment operates correctly.
8. To disconnect, turn off the lift truck and relieve hydraulic pressure by cycling the lever back and forth several times. Pull back on the coupler sleeve and separate the nipple and coupler.

If there is any residual pressure in the nipple, the connection will be slightly harder to break. Push the coupler and nipple together before pulling back on the coupler sleeve.

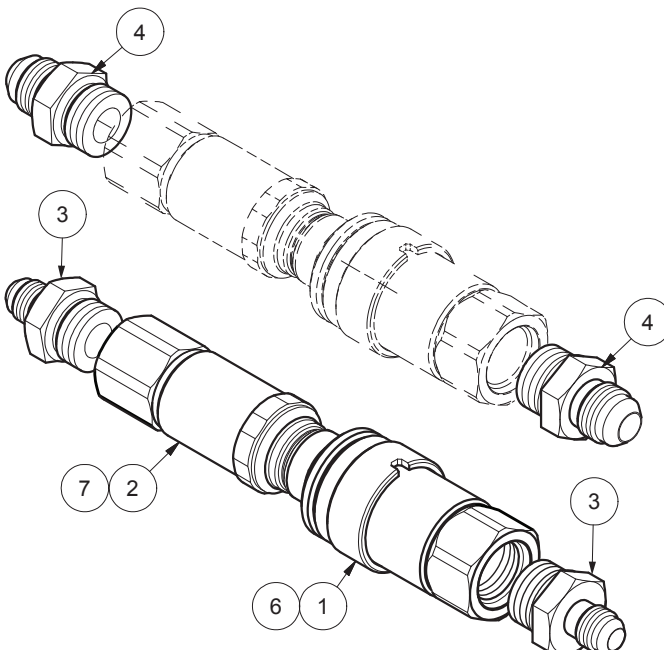

Item	Part No.	Qty	Description
	2527912		Kit, Hydraulic Quick Connect
1	2527957	2	. Coupler, Hydraulic
2	2527958	2	. Nipple, Hydraulic
3	R14253	4	. Fitting #6
4	209806	4	. Fitting #8
6	2533843	2	. Dust Plug
7	2533844	2	. Dust Cap