

Pin Kit Assembly Procedures Class 2 & 3

Hanger Retrofit

- 1) All pin kits are supplied with sufficient parts to retrofit the old style hangers as shown in Figure 1. These pin kits are also designed for the new style hooks, but the insert and washer are not required, as shown in Figure 2.
- 2) Remove old pin kit from the hanger and discard all parts.
- 3) It is recommended to use a small amount of grease at the base of the knob to ease the turning action. Grease may also be used to lubricate the spring. (Clear or white grease is suggested for cleanliness and appearance.)
- 4) Insert pin, with the spring and washer (when required), through the hanger hole so that the top of the pin protrudes well above the top of the hole.
- 5) Place the retrofit insert over the pin when required, and then hold pin in place.
- 6) The knob is then placed on the end of the pin as it will be squeezed into place with the vice grips as shown in Figure 3. The end of the knob should reach the groove inscribed on the pin, as shown in Figure 4.
- 7) As an alternative, a pole or rod may be used to support the pin while tapping the knob in place with a small hammer.

NOTE: ONCE THE FORKS HAVE BEEN ASSEMBLED

ON TO THE CARRIAGE, ENSURE THAT THE PIN KIT IS WORKING PROPERLY BY:

1. Sliding the forks over the notches, with the knob in the raised position.
2. Ensuring that the forks will not move along the carriage when the knob is lowered.

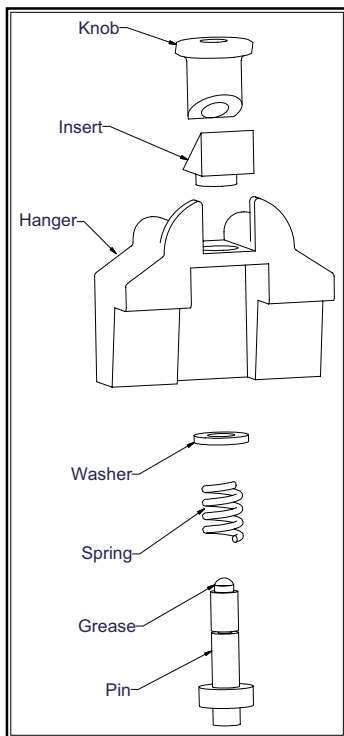

Figure 1

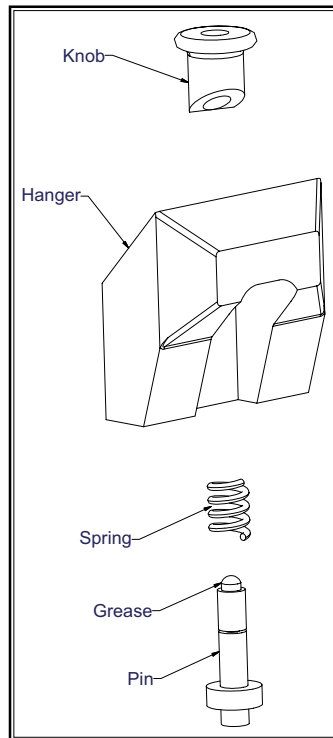

Figure 2

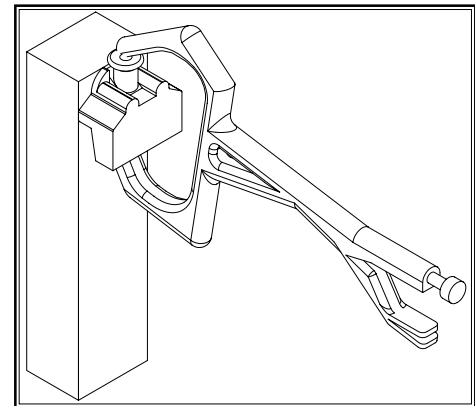

Figure 3

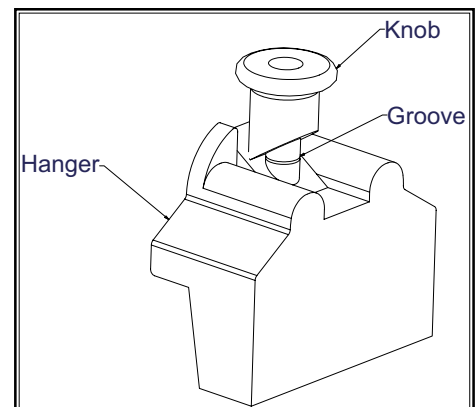

Figure 4