

Sideshifting Integral Carriages

- Popular, durable Ball-O-Matic® top linear ball bearing & hardened steel heel rollers
- Wide range of widths and capacities available
- Additional sideshift stroke available
- Utilizes your truck's forks

Hook Type, Sideshifting, 1 Function

Model Number	Capacity @ 24" LC (lb)	Fork Bar Class	Fork Spread ¹ (in)	Additional Lost Load ² (in)	Total Shift (in)
TNSA055A38			0-38		
TNSA055A42	5,500	II	0-42	3.4	8
TNSA055A46			0-46		
TNSA055A50			0-50		
TNSA100B44			0-44		
TNSA100B50	10,000	III	0-50	3.4	8
TNSA100B56			0-56		
TNSA100B62			0-62		
TNSA155C48			0-48		
TNSA155C60	15,500	IV	0-60	5.0	12
TNSA155C72			0-72		
TNSA155C84			0-84		
TNSA177C48			0-48		
TNSA177C60	17,700	IV	0-60	Consult Factory	12
TNSA177C72			0-72		
TNSA177C84			0-84		
TNSA250F60			0-60		
TNSA250F72	25,000	V	0-72	Consult Factory	12
TNSA250F84			0-84		
TNSA250F96			0-96		

Pin Type, Sideshifting, 1 Function

Model Number	Capacity @ 24" LC (lb)	Fork Spread ¹ (in)	Total Shift (in)
TNSA100P60	10,000	2-60	10
TNSA155P72	15,500	2-72	12
TNSA180P80	18,000	2-80	12
TNSA225P80	22,500	2-80	12
TNSA250P80	25,000	2-80	12
TNSA300P80	30,000	3-80	12
TNSA360P80	36,000	3-80	12

¹ Fork spread is from inside of fully closed forks to outside of fully opened forks. Inside may change based on lift truck.

² Additional lost load dimension is an estimate of the thickness of the integral unit added to the thickness of a standard truck carriage.

³ Prices do not include carriage rollers and attaching pieces.

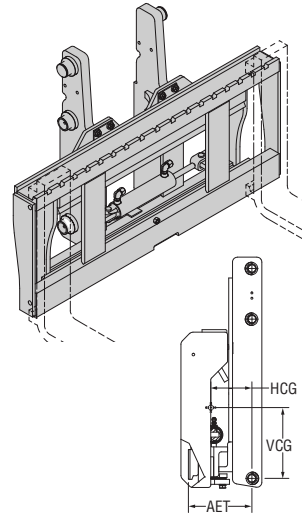

! Important Notes

- Horizontal and vertical center of gravity dimensions will be determined and provided at the time of order. These dimensions are dependent on the specific forklift and mast into which the integral unit will be installed.
- Sideshift cylinder is unhoisted. Installation requires hoses to cylinder ports located near center of carriage. Other hoses options are available.

